



PHOTOGRAPHIC INTERPRETATION REPORT

APPROVED FOR RELEASE -
HISTORICAL COLLECTION
DIVISION DATE: 06-18-2012

BORISOV ARMY BARRACKS NOVOSADY NOVOSADY, USSR BELORUSSIAN MD



CIA



DIA

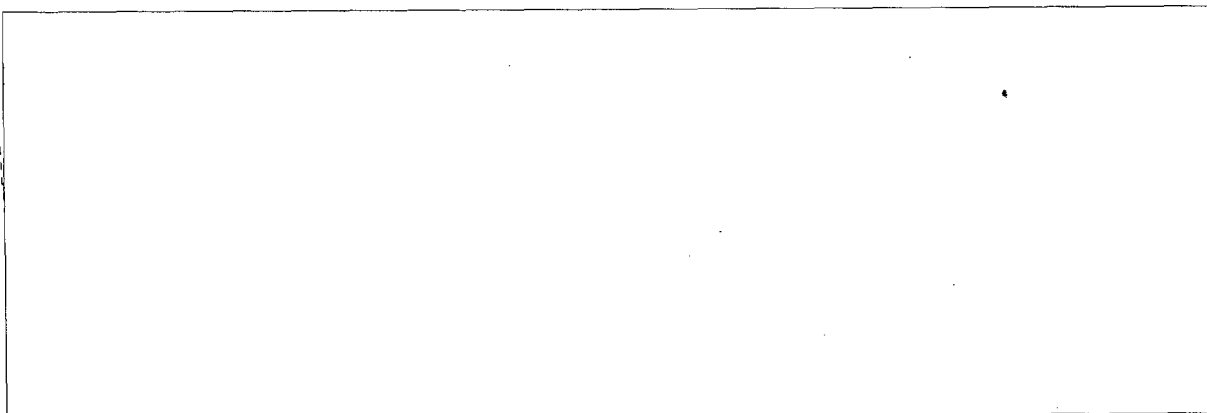

NATIONAL PHOTOGRAPHIC INTERPRETATION CENTER

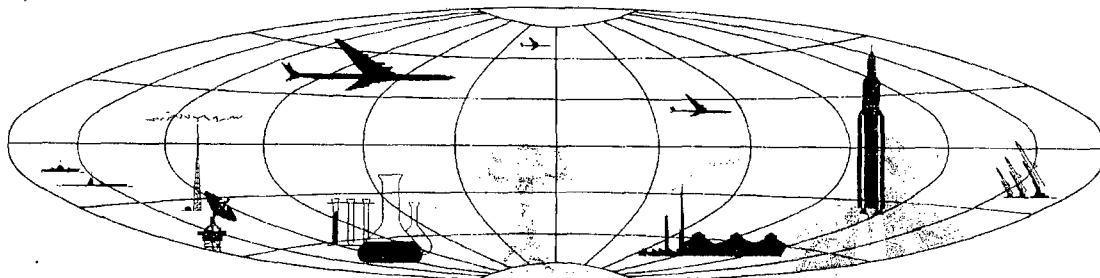

PREFACE

This report is one in a series on Soviet Ground Force and logistic installations being prepared for a DIA/CIA Panel. The series is being coordinated, published and disseminated by NPIC. The photographic analysis is being performed by the NPIC Photographic Analysis Group, the CIA Photographic Intelligence Division (NPIC), and the Production Center IPIC (DIA). The photographic analysis for this particular report was performed by the NPIC Photographic Analysis Group.

In the interest of uniformity, the titles and letter designators for the facilities observed at these installations are identical with those appearing in the project requirement. When a specific facility is not observed both its title and letter designator are omitted in the report.

Titles and letter designators for the various facilities are as follows: (A) railroad service, (B) road service, (C) landing strips, (D) administrative and troop housing areas, (E) storage areas, (F) ammunition storage areas, (G) POL storage areas, (H) other buildings and facilities, (J) equipment storage/maintenance areas, (K) athletic fields, (L) small arms firing ranges, (M) driver training areas, (N) tank/assault gun firing ranges, (P) flat trajectory firing ranges, (Q) artillery emplacements (batteries), (R) infantry or combined arms field training area or courses, (S) special training facilities, (T) unidentified facilities or tracking activity.

NPIC/R-288/64

BORISOV ARMY BARRACKS NOVOSADY
(54-15N 28-43E)
NOVOSADY, MINSKAYA OBLAST, USSR
BELORUSSIAN MD

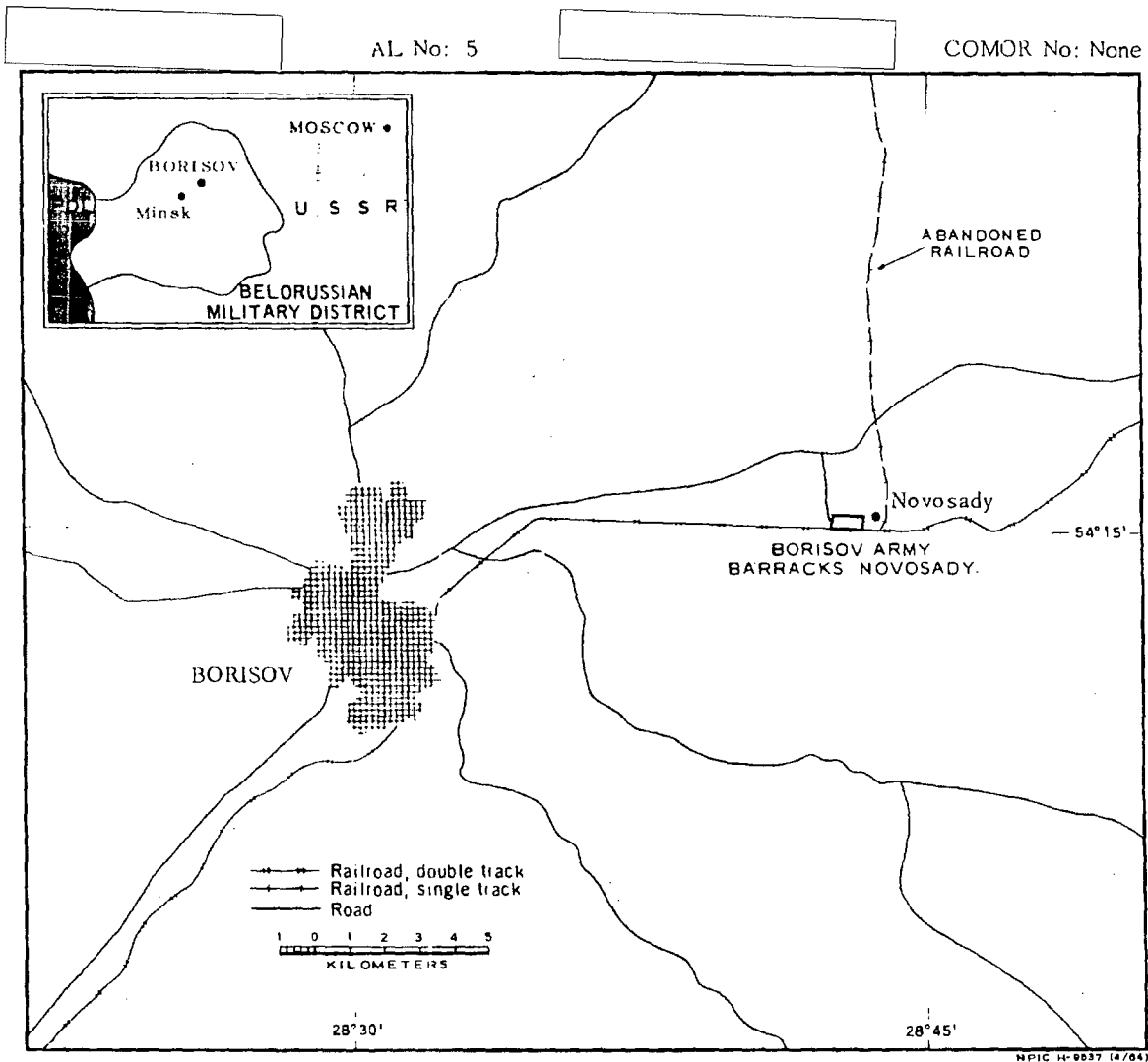

FIGURE 1. LOCATION OF BORISOV ARMY BARRACKS NOVOSADY.

SUMMARY

Borisov Army Barracks Novosady (AL-5) is located 13 kilometers (km) east of Borisov (54-15N 28-30E), and just west of Novosady (54-15N 28-44E). The installation is served by all-weather road connections with the Minsk-Moscow Highway and is adjacent to the Minsk-Moscow rail line (Figure 1).

The installation includes a 17-acre secured area with four administration buildings, eight barracks, 17 support buildings and two storage buildings. An additional area covering approximately four acres contains one administration building, nine barracks, and five support build-

ings and is located on the west side of the secured area. A possibly associated storage area containing seven storage buildings is located just east of the main installation.

The area was covered by TALENT photography in 1956 and eight KEYHOLE missions between August 1961 and February 1964. Comparative analysis revealed the same general level of usage between August 1961 and February 1964, with reduced usage during the winter months. Significant changes since 1956 include the addition of six barracks, and two support buildings.

DESCRIPTION OF INSTALLATION

Railroad Service

The adjacent Moscow-Minsk rail line does not appear to provide direct rail service to the installation.

Road Service

A probable all-weather secondary road leads to the Moscow-Minsk Highway.

Administrative and Troop Housing Area

One administration building, nine barracks and five support buildings are located in area D1 (Figure 3). Four medium-sized barracks-type buildings were added to the area between 1956 and 1963.

Four administration buildings, eight barracks, 17 support buildings and two storage

buildings are located in area D2 (Figure 3). Two large barracks were added between 1956 and 1963.

Track activity within the main installation and adjoining areas indicates probable occupancy of all buildings. The level of track activity has remained constant.

General Storage Area

Seven general storage buildings are located in area E1.

Equipment Storage/Maintenance Areas

Small scale and marginal quality of available photography preclude identification of any building in this installation as vehicle storage/maintenance.

NPIC/R-288/64



NPIC H-9038 (4/64)

FIGURE 2. BORISOV ARMY BARRACKS, NOVOSADY, USSR, AUGUST 1963.

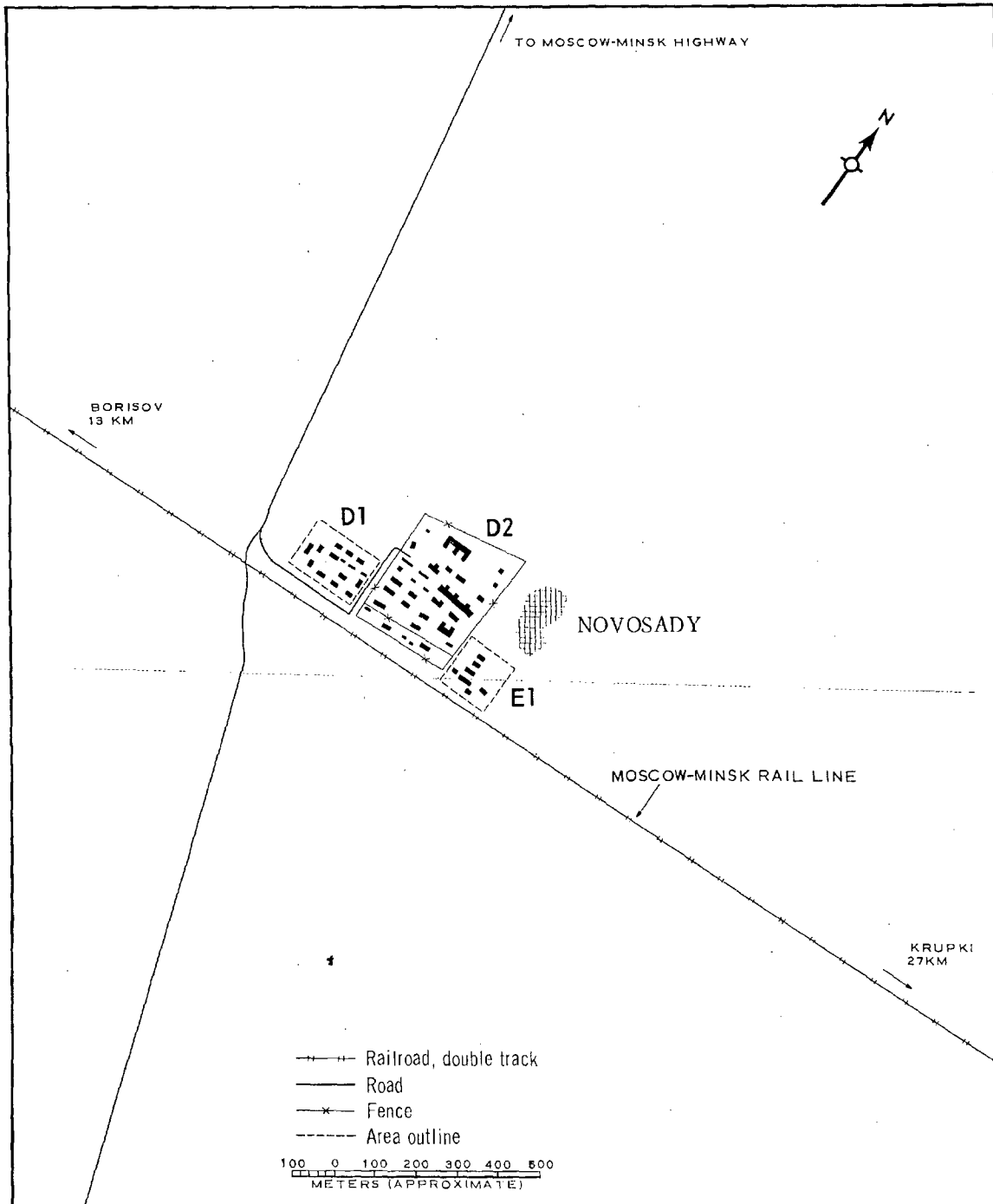
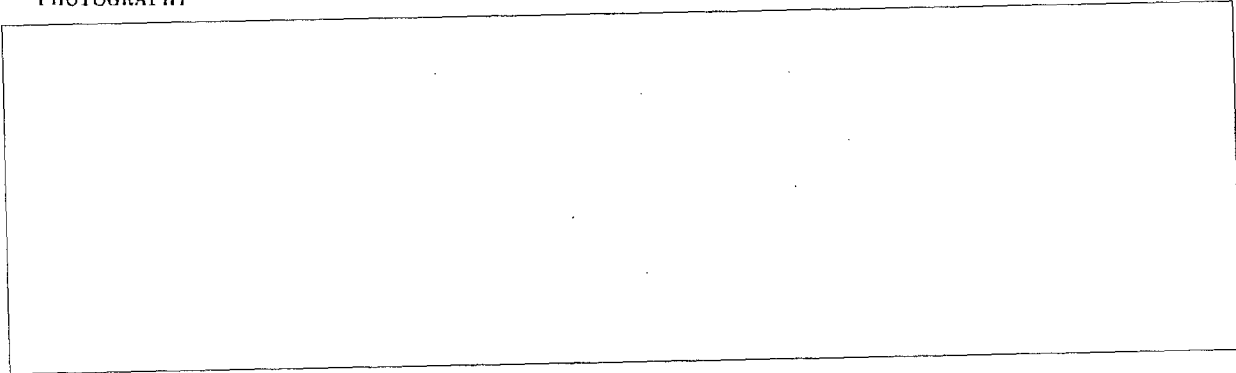

FIGURE 3. BORISOV ARMY BARRACKS NOVOSADY, FEBRUARY 1964. Sketch compiled from [redacted] NPIC H-9844 14/64 February 1964.

NPIC/R-288/64

REFERENCES

PHOTOGRAPHY



MAPS OR CHARTS

US Air Target Chart. Series 200, Sheet 168-15III, 2d ed, Nov 62 (SECRET)

DOCUMENTS

DIA. PC 225/1-1-63, *Installation List, Soviet Ground Forces*, Oct 63

REQUIREMENT

C-RR4-81,111 (partial answer)

NPIC PROJECT

N-236/64

~~TOP SECRET~~

~~TOP SECRET~~