

HR70-14

NPIC/R-983/64

December 1964

~~TOP SECRET~~

TCS-9045/64

Copy 108

6 Pages



PHOTOGRAPHIC INTERPRETATION REPORT

APPROVED FOR  
RELEASE - HISTORICAL  
COLLECTION DIVISION  
DATE: 06-18-2012

# SOVIET MILITARY ORDER OF BATTLE KIYEV MD



CIA



DIA

Handle Via **TALENT - KEYHOLE** Control Only

WARNING

This document contains classified information affecting the national security of the United States within the meaning of the espionage laws U. S. Code Title 18, Sections 793 and 794. The law prohibits its transmission or the revelation of its contents in any manner to an unauthorized person, as well as its use in any manner prejudicial to the safety or interest of the United States or for the benefit of any foreign government to the detriment of the United States. It is to be seen only by personnel especially indoctrinated and authorized to receive TALENT-KEYHOLE information. Its security must be maintained in accordance with KEYHOLE and TALENT regulations.

NATIONAL PHOTOGRAPHIC INTERPRETATION CENTER

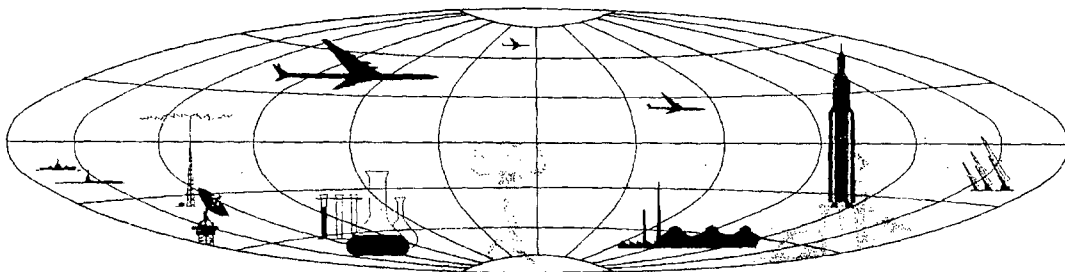

~~TOP SECRET~~

GROUP 1  
Excluded from automatic  
downgrading and declassification

~~TOP SECRET RUFF~~

Handle Via  
TALENT-KEYHOLE  
Control System Only

TCS-9045/64  
NPIC/R-983/64

## PREFACE

This report is one in a series on Soviet Ground Force and logistic installations being prepared for a DIA/CIA Panel. The series is being coordinated, published and disseminated by NPIC. The photographic analysis is being performed by the NPIC Photographic Analysis Group, the CIA Photographic Intelligence Division (NPIC), and the Production Center 1P1c (DIA). The photographic analysis for this particular report was performed by the NPIC Photographic Analysis Group.

In the interest of uniformity, the titles and letter designators for the facilities observed at these installations are identical with those appearing in the project requirement. When a specific facility is not observed both its title and letter designator are omitted in the report.

Titles and letter designators for the various facilities are as follows: (A) railroad service, (B) road service, (C) landing strips, (D) administrative and troop housing areas, (E) storage areas, (F) ammunition storage areas, (G) POL storage areas, (H) other buildings and facilities, (J) equipment storage/maintenance areas, (K) athletic fields, (L) small arms firing ranges, (M) driver training areas, (N) tank/assault gun firing ranges, (P) flat trajectory firing ranges, (Q) artillery emplacements (batteries), (R) infantry or combined arms field training area or courses, (S) special training facilities, (T) unidentified facilities or tracking activity.

- 1 -

~~TOP SECRET RUFF~~

Handle Via  
TALENT-KEYHOLE  
Control System Only

KONOTOP ARMY BARRACKS  
(51-14N 033-12E)  
KONOTOP, SUMSKAYA OBLAST, USSR  
KIYEV MD

AL No:

COMOR No:

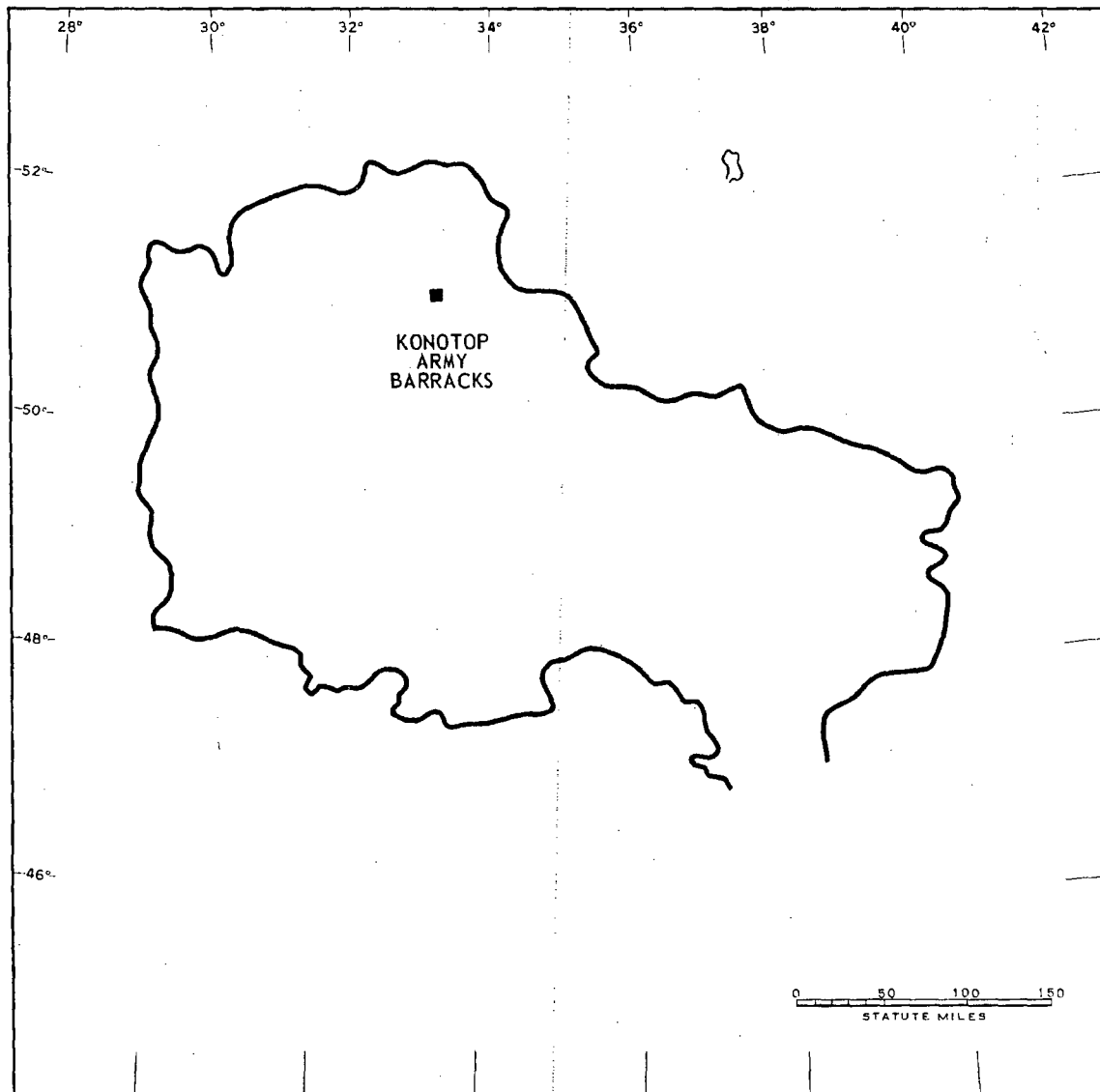

FIGURE 1. LOCATION OF KONOTOP ARMY BARRACKS.

NPIC J-4951 (11/64)



FIGURE 2. KONOTOP ARMY BARRACKS, USSR, JUNE 1964.

NPIC J-4902 (11/64)

SUMMARY

Konotop Army Barracks is located in the northeast section of Konotop on the east side of the Krolevets-Konotop Rail Line (Figure 1).

This secured installation covers approximately 255 acres and contains 2 administration buildings, 3 large multistory barracks, 32 large storage buildings, 35 support buildings, a small-arms firing range, 2 motor pools (each containing 2 vehicle maintenance buildings), and a pos-

sibly associated athletic field (Figures 2 and 3).

The area was covered by 6 KEYHOLE missions between December 1961 and June 1964. Comparative analysis revealed the same general level of usage throughout this period; however, winter missions revealed track activity only in the administrative and troop housing area. No significant changes in facilities were noted.

DESCRIPTION OF INSTALLATION

Railroad Service

Although no trackside docks are apparent, a section in the western part of the installation may possibly be used as a loading zone.

cured area adjacent to the rail line and 2.3 kilometers (km) south of the installation (not shown on sketch).

Road Service

The installation is served by urban streets.

Equipment Storage/Maintenance Areas

Area J1 contains a 75- by 185-foot vehicle maintenance building, a 30- by 60-foot vehicle maintenance building, and a 225- by 390-foot motor park.

Administrative and Troop Housing Area

Area D contains 2 administration buildings, 3 large multistory barracks, 2 large storage buildings, and 28 support buildings. Track activity throughout the area indicates probable occupancy of all buildings.

Area J2 contains a 50- by 300-foot vehicle maintenance building, a 35- by 70-foot vehicle maintenance building, and a 300- by 525-foot motor park.

General Storage Area

Area E contains 30 large storage buildings and 7 smaller support buildings. Heavy tracking throughout the area indicates probable utilization of all buildings. No track activity was noted on winter coverage.

Athletic Field

A possibly associated athletic field (K) is located on the southwestern side of the railroad tracks.

POL Storage Area

Nine small POL tanks are located in a se-

Small-Arms Firing Range

Area L is a 330- by 65-foot small-arms firing range. The range is revetted on 3 sides. Scarring indicates continued use.

~~TOP SECRET RUFF~~

TCS-9045/64  
NPIC/R-983/64

Handle Via  
TALENT-KEYHOLE  
Control System Only

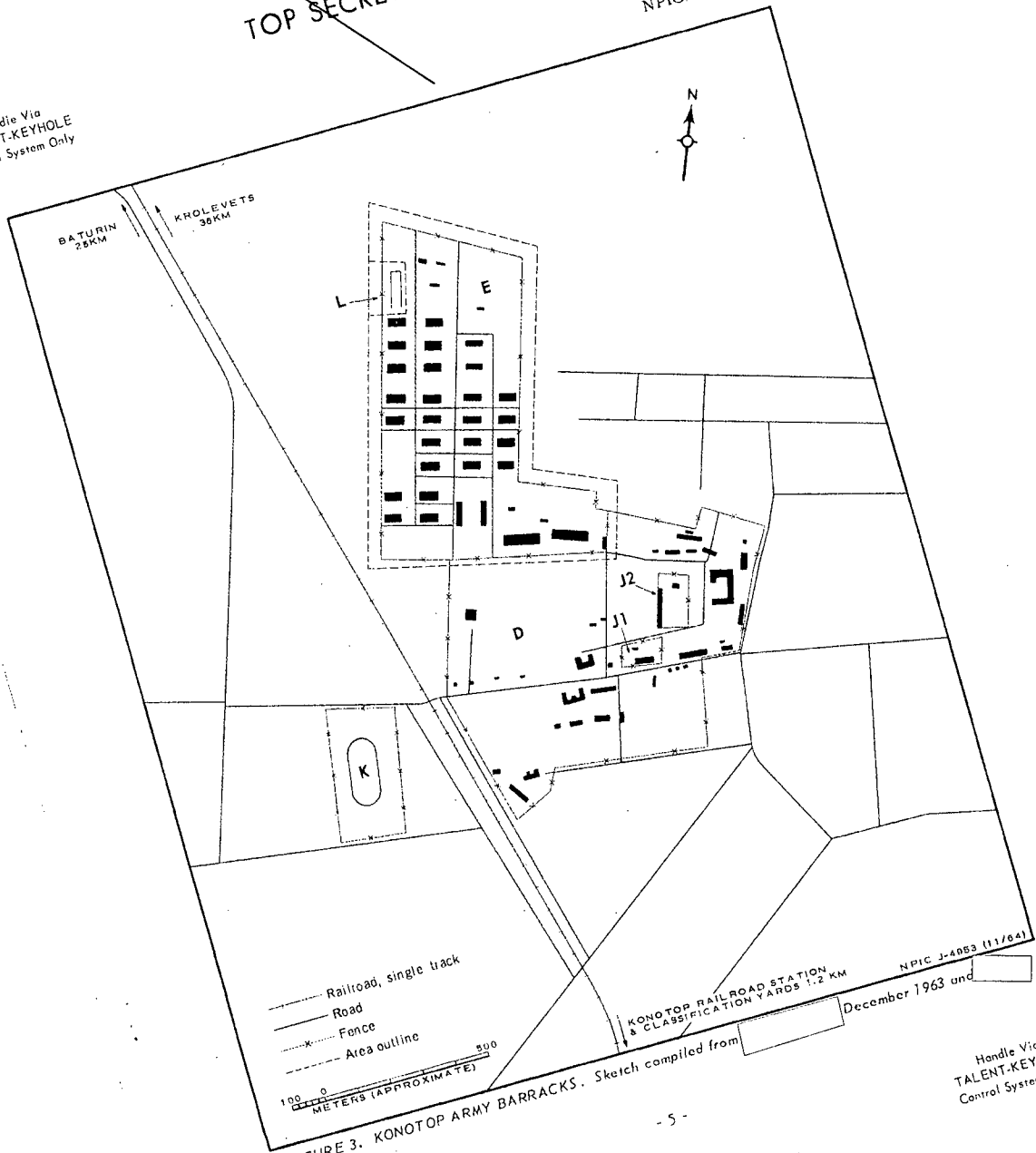

FIGURE 3. KONOTOP ARMY BARRACKS. Sketch compiled from [redacted] December 1963 and [redacted] June 1964.

NPIC J-4053 (11/84)

Handle Via  
TALENT-KEYHOLE  
Control System Only

~~TOP SECRET RUFF~~

~~TOP SECRET RUFF~~

Handle Via  
TALENT-KEYHOLE  
Control System Only

TCS-9045/64  
NPIC/R-983/64

REFERENCES

PHOTOGRAPHY

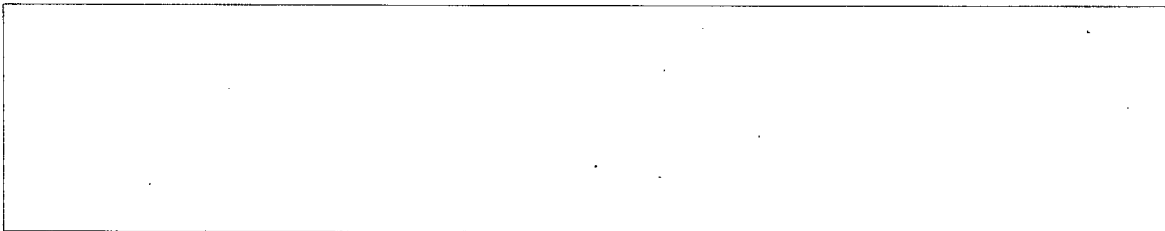

MAPS OR CHARTS

US Air Target Chart, Series 200, Sheet 0233-5HL, 2d ed, Jun 62 (SECRET)

REQUIREMENT

C-RR4-81,614 (partial answer)

NPIC PROJECT

11627/64

- 6 -

~~TOP SECRET RUFF~~

Handle Via  
TALENT-KEYHOLE  
Control System Only

~~TOP SECRET~~

~~TOP SECRET~~