

~~TOP SECRET~~



IMAGERY
ANALYSIS
DIVISION

PIR

PHOTOGRAPHIC INTELLIGENCE REPORT

APPROVED FOR RELEASE -
HISTORICAL COLLECTION
DIVISION - HR70-14
DATE: 05-10-2012

VITAL RECORDS COPY

PROBABLE SCUD MISSILE UNIT

AT MARY NORTH AIRFIELD, USSR

CIA/PIR 67046

DATE 48
COPY AUGUST 1965
PAGES 4

~~TOP SECRET~~

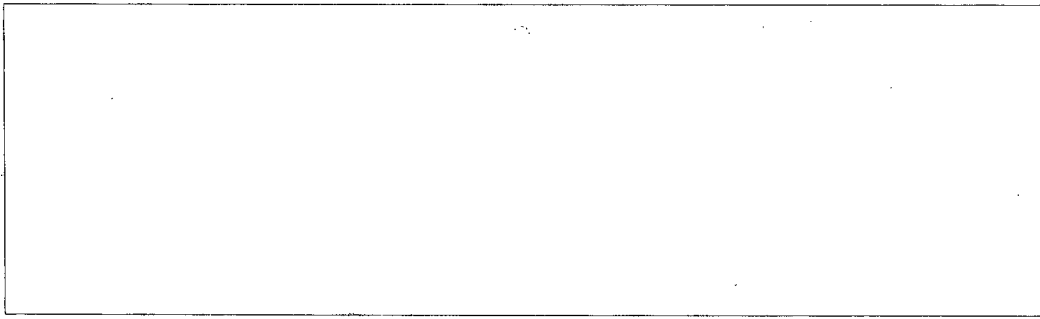

CIA IMAGERY ANALYSIS DIVISION

PROBABLE SCUD MISSILE UNIT
AT MARY NORTH AIRFIELD, USSR

A probable SCUD missile unit is located immediately east of Mary North Airfield at 37 39N-061 50E in the Turkestan Military District.

The unit is located in a probably double secured installation that contains the following buildings (numbers are keyed to Figure 1):

1. storage building 170 by 40 feet
2. support building 20 by 10 feet
3. support building 35 by 15 feet
4. support building 25 by 20 feet
5. vehicle/equipment shed 250 by 35 feet
6. storage building 110 by 45 feet
7. vehicle/equipment shed 210 by 45 feet
8. support building 35 by 35 feet
9. support building 60 by 40 feet
10. support building 45 by 25 feet
11. support building 35 by 35 feet
12. support building approx. 35 by 35 feet
13. vehicle/equipment shed 260 by 60 feet
14. vehicle/equipment shed 400 by 45 feet
15. equipment shed 135 by 50 feet
16. vehicle/equipment shed 260 by 40 feet
17. support building 25 by 25 feet

~~TOP SECRET RUFF~~

CIA/PIR-67046

CIA IMAGERY ANALYSIS DIVISION

(a) The following vehicles/pieces of equipment were observed:

- 3 probable SCUD transporters
- 2 probable MAZ 200V tractor trailers
- 4 probable van trucks
- 20 cargo trucks
- 5 probable generator trailers
- 2 cranes
- 1 suspect crane

(b) Four pointed shadows are protruding from an equipment shed (annotation 15). This shed is large enough to accommodate SCUD transporter-erector-launchers. Four additional shadows are observed protruding from a vehicle/equipment shed (annotation 14).

A probable related POL storage area, located immediately to the north, is secured and contains 7 possible horizontal POL tanks, 2 possible buried POL tanks and one support building (annotation 17).

- 2 -

~~TOP SECRET RUFF~~

TOP SECRET RUFF

PROBABLE SCUD MISSILE UNIT AT MARY NORTH AIRFIELD

CIA/PIR-67046

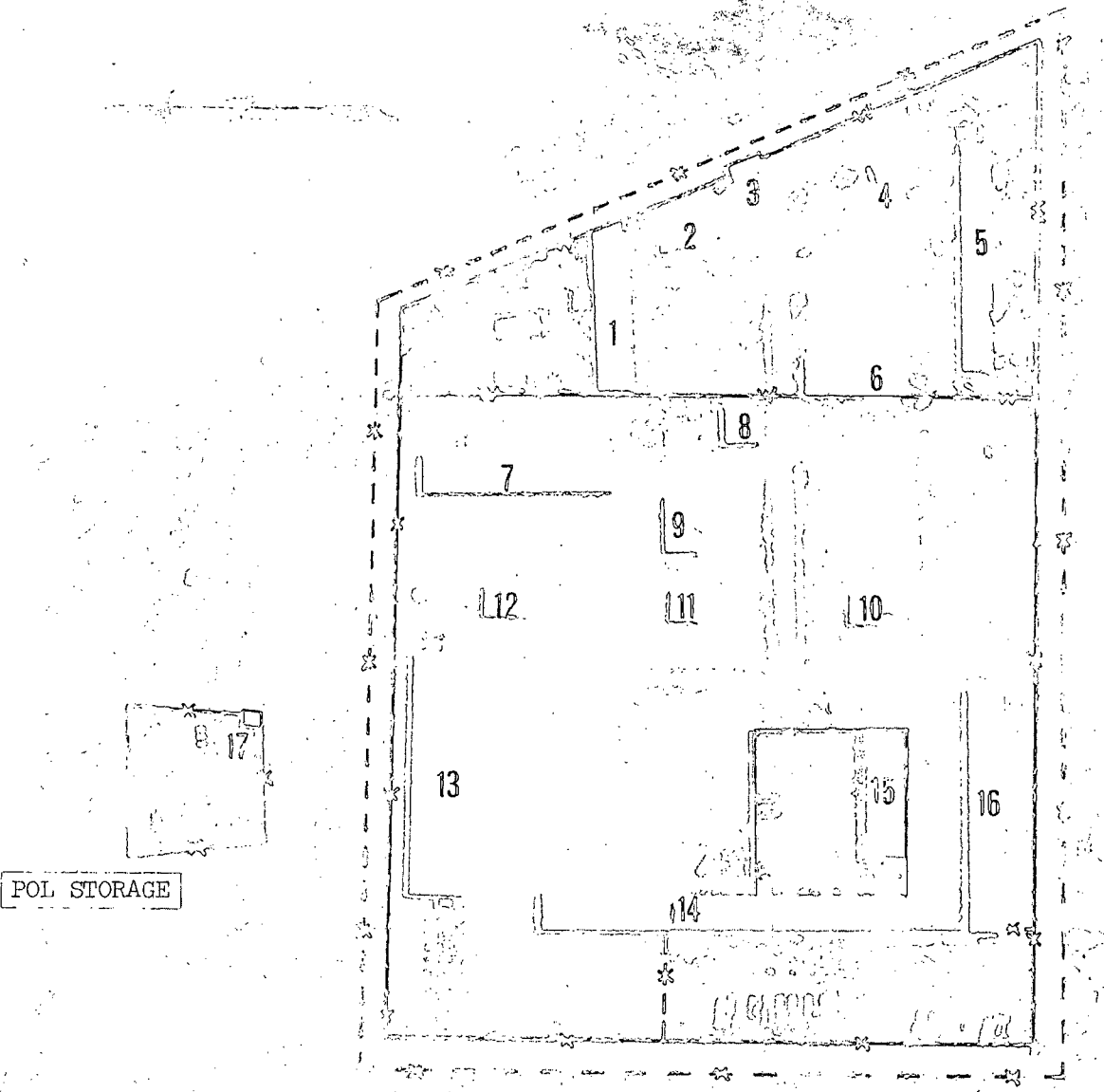

POL STORAGE

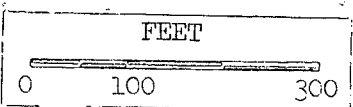

- *— Fence
- ...*... Possible fence
- w— Wall

MAY, 1964

TOP SECRET RUFF

FIGURE I

~~TOP SECRET RUFF~~

CIA/PIR-67046

CIA IMAGERY ANALYSIS DIVISION

REFERENCES

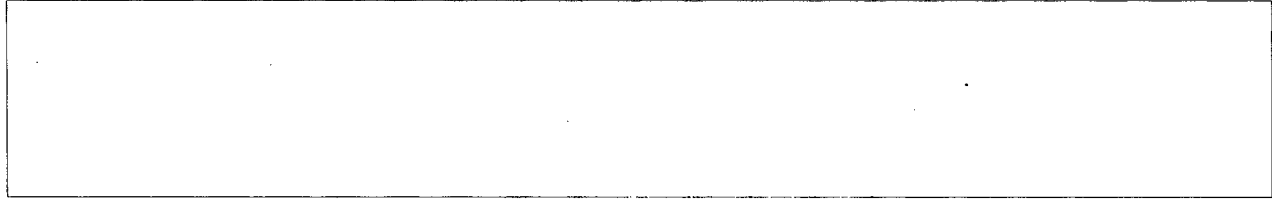

CHART

U.S. Air Target Chart, Series 100, Sheet 0337-9997-A, 1st Edition,
October 55, (CONFIDENTIAL)

REQUIREMENT

CIA. C-RR5-82,837

CIA/IAD PROJECT

30173-6

- 3 -

~~TOP SECRET RUFF~~

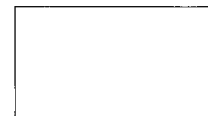

~~TOP SECRET~~

~~TOP SECRET~~