

Next 14 Page(s) In Document Exempt

ILLEGIB

GUIDED MISSILE AND ASTRONAUTICS INTELLIGENCE COMMITTEE

*APIC*

# MINICARD COPY

1 December 1962 ✓

MEMORANDUM FOR: Holders of GMAIC-Deployment Working Group Report, Soviet Surface-to-Surface Missile Deployment [redacted] dated 1 January 1962

SUBJECT: Listings of GMAIC Evaluations on Soviet Surface-to-Surface Missile Deployment Locations (Fourth Revision)

1. This memorandum and the attached tables supercede those published on 1 October 1962 and disseminated under control number [redacted] (Third Revision). The report dated 1 October 1962 should be destroyed in accordance with the existing instructions for handling [redacted] material.

2. [redacted] photography of [redacted] revealed continued construction activity at the seventeen confirmed ICBM complexes. Unidentified construction activity and the extension of service roads indicate expansion at some of these complexes. Construction progress has been noted at the existing sites and newly identified sites have been observed under construction at Kozelsk, Svobodnyy, Teykovo, Yedrovo, and Yurya.

3. In the report dated 1 October 1962, ICBM site configurations were categorized to reflect the differences in site signature. In review, ICBM site configurations are as follows:

**TYPE I** - First generation soft site with a single rail-served pad similar to Launch Complex A or B, Tyura Tam. To date, this type has only been observed at Plesetsk.

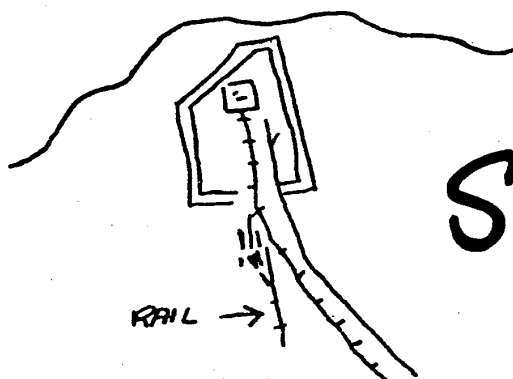

# S-9716

*COB*  
*16 Oct 63*  
*(1962-12-01)*

A 0000714

[redacted]

(FOURTH REVISION)  
Copy 64 of 100 Copies  
Page 1 of 22 Pages

0000417

TOP SECRET

25X1

**TYPE II - Second generation soft site with two road-served pads similar to launch Complex C, Tyura Tam. This type was first observed at Yurya and subsequently at 11 other locations. There are two basic configurations of this type.\***

Mod. a

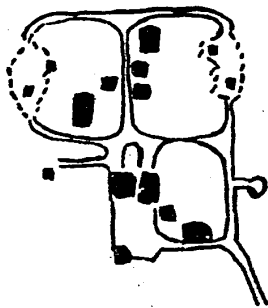

Mod. b

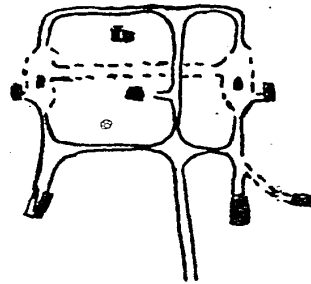

**TYPE III- A hardened ICBM launch site observed at Launch Complex D, Tyura Tam and eight confirmed ICBM complexes. Each site consists of two launchers (probably silo type) and a control bunker. The degree of hardening cannot be determined from available evidence. The excavations during construction are about 200 feet wide and 500 feet long.**

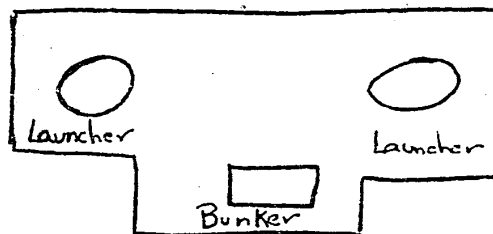

\* The NSA and USAF members of GMAIC believe that there are three configurations of this type. They assert that the TYPE IV site described below is another modification of the TYPE II site.

A 0000714

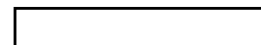

25X1

**TYPE IV** - A soft configuration consisting of two road-served launch pads. This configuration was first observed at TYUMEN and subsequently at three other confirmed ICBM complexes. It differs from Type II sites as follows: (1) the pad separation is 820 feet instead of 980 feet; (2) the ready building is 820 feet from the pad and is smaller (115 x 130 feet); and (3) there is a "plus sign" pattern to the rear of the pad area at most of the sites under construction which may possibly be related to guidance.

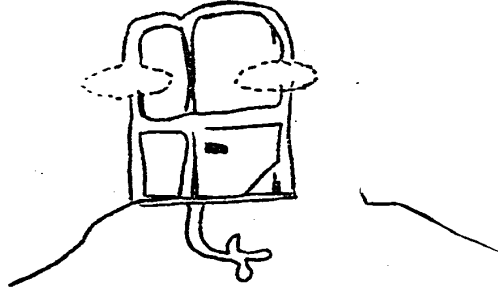

25X1D

4. A total of 137 soft MRBM/IRBM sites (548 launch pads) have been identified on [redacted] photography through Mission [redacted]. Based upon an analysis of all evidence on these locations, it appears that site construction has been completed on approximately 90-95 percent of the total. Twenty hardened MRBM/IRBM sites (40 launchers) have been confirmed to date and additional suspect areas are under study.

25X1

5. It should be noted that all suspect locations are subject to continuous review. When a suspect location has sufficient evidence to warrant an assessment of possible or higher, it will be included in the GMAIC-DWG Report, Soviet Surface-to-Surface Missile Deployment [redacted] dated 1 January 1962. 25X1  
When a location has been evaluated as negative, by the working group, all evidence including [redacted] photography will continue to be reviewed for deception, new construction, and unrecognized configurations. The evaluations assigned are based on the latest data and are subject to change as new evidence is made available. Accordingly, these listings will be revised periodically to reflect additions and changes in evaluations.

25X1

6. Although some of the locations listed in Table 4 may have some functional relationship to the Soviet missile program, the assessments are limited to launching facilities. Only major differences in assessment are indicated in footnotes on the bottom of the pages.

25X1A



Chairman

**Attachments:**

- Table 1. Summary of Evaluations
- Table 2. Summary Evaluations of ICBM Deployment Locations
- Table 3. Summary Evaluations of MRBM/IRBM Deployment Locations
- Table 4. Alphabetical Listing of Locations Considered in Detail

A 0000714



25X1

(FOURTH REVISION)

25X1

TABLE 1

1 December 1962

SUMMARY OF EVALUATIONS

	<u>ICBM</u>	<u>MRBM/IRBM</u>
CONFIRMED	17	78
PROBABLE	0	0
POSSIBLE	0	1
UNDETERMINED	3	12
DOUBTFUL	3	6
NEGATIVE	184	108
CONFIRMED R&D		3**
TOTAL	208	208

\* Tyura Tam Test Range

\*\* Kapustin Yar, Chelkar and Makat

NOTE: The above figures represent all the locations evaluated by the DWG and listed in Table 4. The 17 ICBM complexes identified to date consist of support facilities and from two to eight launch sites. ( See Table 2). Soft MRBM/IRBM complexes identified to date consist of support facilities and two launch sites with four pads each. A hardened site consists of a support facility, two probable silos and a control bunker. At two locations, Taybola and Pervomaysk, there are two sites forming a complex. The remainder of the hardened sites are associated with known soft MRBM/IRBM sites and are considered part of those complexes. ( See Table 3).

A 0000714

(Fourth Revision)

Copy 64 of 100 Copies  
Page 4 of 22 Pages

25X1

TOP SECRET

25X1

25X1

TOP SECRET [redacted] Approved For Release 2003/09/02 : CIA-RDP78T05439A000200390072-2  
TABLE 2

1 December 1962

SUMMARY EVALUATION OF ICBM DEPLOYMENT LOCATIONS

LOCATION	NO. OF SITES OBSERVED TO DATE	NO OF PADS/LAUNCHERS	DATE OF LATEST PHOTOGRAPHY/MISSION	SITE CONSTRUCTION STATUS WHEN LAST OBSERVED*
1) DROYANAYA	2	4	[redacted]	One Type II (Mod. b) site in late stage of construction. One probable TYPE III site under construction.
2) GLADKAYA	2	4	[redacted]	Two type IV sites-both in mid-stage of construction.
3) ITATKA	2	4	[redacted]	Two type II (Mod. b) sites- one complete and one in mid-stage of construction.
4) KOSTROMA	5	10	[redacted]	Four Type II (Mod. a) sites- two complete and two in mid-stage of construction. One Type III site under construction.
5) KOZELSK	4	8	[redacted]	Four Type IV sites- two in mid-stage, one in an early stage, and one in an undetermined stage of construction.
6) NOVOSELOVSKA	3	6	[redacted]	One Type II (Mod. b) site in mid-stage of construction Two Type III sites under construction.
7) OMSK	2	4	[redacted]	Two Type III sites under construction- one very early stage.
8) PERM	3	6	[redacted]	Three Type II (Mod. b) sites - one complete, one in late stage of construction and one in an early stage of construction.

25X1

25X1

25X1

Foreign Relations  
Copy 4 of 10  
Page 2 of 2 pages

TOP SECRET [redacted]

25X1D

TOP SECRET [REDACTED]

25X1

LOCATION	NO. OF SITES OBSERVED TO DATE	NO. OF PADS/LAUNCHERS	DATE OF LATEST PHOTOGRAPHY [REDACTED]	MISSION	SITE CONSTRUCTION STATUS WHEN LAST OBSERVED
9) PLESETSK	8	14	[REDACTED]	[REDACTED]	Three Type I sites (a total of four pads) complete. Two Type II (one Mod. a and one Mod. b) sites complete. One Type III site under construction. Two Type IV sites both in mid-stage of construction.
10) SHADRINSK	2	4	[REDACTED]	[REDACTED]	Two Type III sites under construction.
11) SVOBODNY	4	8	[REDACTED]	[REDACTED]	Four Type II (Mod. b) sites - three complete and one in an early stage of construction.
12) IEYKOVO	4	8	[REDACTED]	[REDACTED]	Four Type II (Mod. b) sites - two complete, one in mid stage, and one in an early stage of construction.
13) TYUMEN	3	6	[REDACTED]	[REDACTED]	Three Type IV sites - two in mid-stage and one in an early stage of construction.
14) VERKHNYAYA SALDA	7	14	[REDACTED]	[REDACTED]	Five Type II (two Mod. a and three Mod. b) sites - four complete and one in mid-stage of construction. Two Type III sites under construction.

25X1

25X1D

TOP SECRET [REDACTED]

25X1

(Fourth Revision)  
 Copy 64 of 100 Copies  
 Page 5 of 22 Pages

TOP SECRET

Approved For Release 2003/09/02 : CIA-RDP78T05439A000200390072-2

25X1

LOCATION	NO. OF SITES OBSERVED TO DATE	NO. OF PADS/ LAUNCHERS	DATE OF LATEST PHOTOGRAPHY/MISSION	SITE CONSTRUCTION STATUS WHEN LAST OBSERVED	
15) YEDROVO	4	8		Four Type II (Mod. b) sites. Status of construction cannot be determined at this time.	
16) YOSHKAR-OLA	4	8		Four Type II (Mod. b) sites- one complete, one in late stage, one in mid-stage, and one in an early stage of construction.	
17) YURYA	8	16		Five Type II (two Mod. a and three Mod. b) sites- five complete. One probable Type II (Mod. undetermined) under construction. Two Type III sites under construction.	
<b>SUB TOTALS</b>	<u>67</u>	<u>132</u>			
TYURA TAM	7	14			Launch Complex A-two pads complete. Launch Complex B-one pad complete. Launch Complex C -three pads complete. Launch Complex D - two launchers complete and two under construction. Launch Complex E - Estimate two pads /launchers probably complete but not discernable on available photography. Launch Complex F&G- at least one pad or launcher estimated under construction at each complex. No evidence of pads/launchers on available photography.
<b>TOTALS</b>	<b>74</b>	<b>146</b>			

25X1

25X1D

25X1B



A 0000714  
(Fourth Revision)  
Copy 4 of 100 Copies  
Page 7 of 22 Pages

TOP SECRET

25X1

Approved For Release 2003/09/02 : CIA-RDP78T05439A000200390072-2



TABLE 3

1 December 1962

SUMMARY EVALUATION OF MRBM/IRBM DEPLOYMENT LOCATIONS

25X1

<u>SOFT SITES</u> <u>LOCATION</u>	<u>NO. OF SITES</u>	<u>NO. OF PADS</u>	<u>DATE OF LATEST PHOTOGRAPHY</u> / <u>MISSION</u>
AKHTYRKA LAUNCH COMPLEX	2	8	[redacted]
ALUKSNE LAUNCH COMPLEX	2	8	
ANASTASYEVKA LAUNCH COMPLEX	2	8	
BALTA LAUNCH COMPLEX	2	8	
BARANO-ORENBURGSKOYE LAUNCH COMPLEX	2	8	
BELOKOROVICHI LAUNCH COMPLEX	2	8	
BERDICHEV LAUNCH SITE	1	4	
BORKOVICHI LAUNCH SITE	1	4	
BREST LAUNCH COMPLEX	2	8	
BRODY LAUNCH COMPLEX	2	8	
DERAZHNYA LAUNCH COMPLEX	2	8	
DISNA LAUNCH COMPLEX	2	8	
DOLINA LAUNCH COMPLEX	2	8	
DROGOBYCH LAUNCH COMPLEX	2	8	
DUNAYEVTSY LAUNCH COMPLEX	2	8	
DYATLOVO LAUNCH COMPLEX	2	8	
GODYKHA LAUNCH COMPLEX	2	8	
GOMEL LAUNCH COMPLEX	2	8	
GRANOV LAUNCH SITE (IRBM)	1	4	
GRESK LAUNCH COMPLEX	2	8	
GUSEV LAUNCH COMPLEX	2	8	
GVARDEYSK LAUNCH SITE	1	4	
JELGAVA LAUNCH COMPLEX	2	8	
JONAVA LAUNCH COMPLEX	2	8	

A 000071-

[redacted]  
(Fourth Revision)

Copy 64 of 100 Copies  
Page 8 of 22 Pages

25X1D  
25X1

25X1

<u>LOCATION</u>	<u>NO. OF SITES</u>	<u>NO. OF PADS</u>	<u>DATE OF LATEST PHOTOGRAPHY</u> / <input type="checkbox"/>	<u>MISSILE</u> <input type="checkbox"/> <u>TYPE</u> <input type="checkbox"/>
KIVERTSY LAUNCH COMPLEX	2	8		
KOROSTEN LAUNCH COMPLEX	2	8		
KOZHANOVICHI LAUNCH COMPLEX	2	8		
*KRASKINO LAUNCH SITE (IRBM)	1	4		
*KROLOVETS LAUNCH COMPLEX (IRBM)	2	8		
KURGANCHA LAUNCH COMPLEX	2	8		
*LEBEDIN LAUNCH COMPLEX (IRBM)	2	8		
LIDA LAUNCH COMPLEX	2	8		
LIPNIKI LAUNCH SITE	1	4		
LUTSK LAUNCH COMPLEX*	2	8		
MARINA GORKA LAUNCH SITE	1	4		
MAYKOP LAUNCH SITE	1	4		
MOLOSKOVITSY LAUNCH COMPLEX	2	8		
MUKACHEVO LAUNCH COMPLEX	2	8		
NADVORNAYA LAUNCH COMPLEX	2	8		
*NIGRANDE LAUNCH SITE (IRBM)	1	4		
*NOVOSYSOYEVKA LAUNCH SITE (IRBM)	1	4		
OSTROG LAUNCH COMPLEX	2	8		
OSTROV LAUNCH COMPLEX	2	8		
PAPLAKA LAUNCH COMPLEX	2	8		
PETRIKOV LAUNCH COMPLEX	2	8		
PINSK LAUNCH COMPLEX	2	8		
POLOTSK LAUNCH COMPLEX	2	8		
POSTAVY LAUNCH COMPLEX	2	8		
PRUZHANY LAUNCH COMPLEX	2	8		
RAGNIT LAUNCH COMPLEX	2	8		
RAKVERE LAUNCH COMPLEX	2	8		

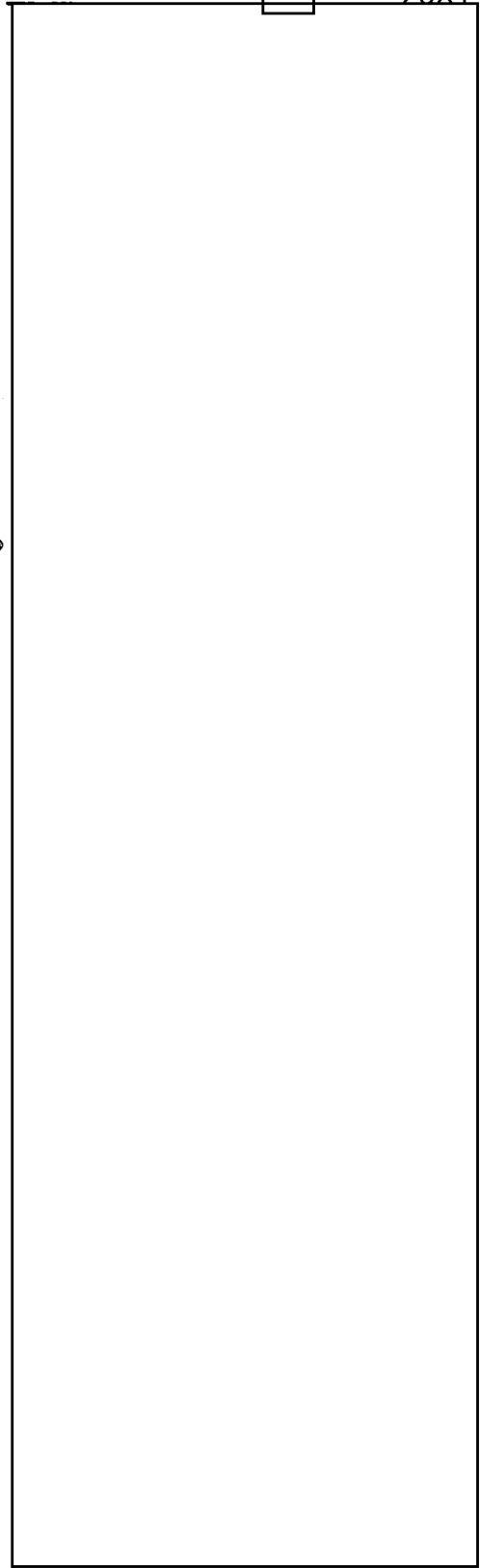

25X1D

A 0000714

25X1

(Fourth Revision)

Copy 4 of 100 Copies

Page 2 of 22 Pages

25X1

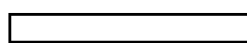

LOCATION

Approved For Release 2003/09/02 : CIA-RDP78T05439A000200390072-2 DATE OF LATEST

SITES PADS PHOTOGRAPHY/MISSION

RISTI LAUNCH COMPLEX	2	8
ROZHDESTVENKA LAUNCH SITE	1	4
RUZHANY LAUNCH COMPLEX	2	8
* SARY OZEK LAUNCH SITE (IRBM)	1	4
SATEIKIAI LAUNCH COMPLEX	2	8
SKALA PODOLSKAYA LAUNCH COMPLEX	2	8
SLONIM LAUNCH COMPLEX	2	8
*SMORGON LAUNCH COMPLEX (IRBM)	2	8
SOKAL LAUNCH COMPLEX	2	8
SOVETSK LAUNCH COMPLEX	2	8
SUCHAN LAUNCH COMPLEX	2	8
TAURAGE LAUNCH COMPLEX	2	8
TORVA LAUNCH COMPLEX	2	8
TROSTYANETS LAUNCH SITE	1	4
UGOLNYYE KOPI LAUNCH SITE	1	4
UKMERBE LAUNCH COMPLEX	2	8
UMAN LAUNCH COMPLEX	2	8
URECH'YE LAUNCH SITE	1	4
USOVO LAUNCH COMPLEX	2	8
VORU LAUNCH COMPLEX	2	8
VSELYUB LAUNCH COMPLEX	2	8
*YELSK LAUNCH COMPLEX	2	8
ZAGARE LAUNCH COMPLEX	2	8
ZHMERINKA LAUNCH COMPLEX	2	8
ZNAMENSK LAUNCH COMPLEX	2	8
SUB-TOTALS	137	548

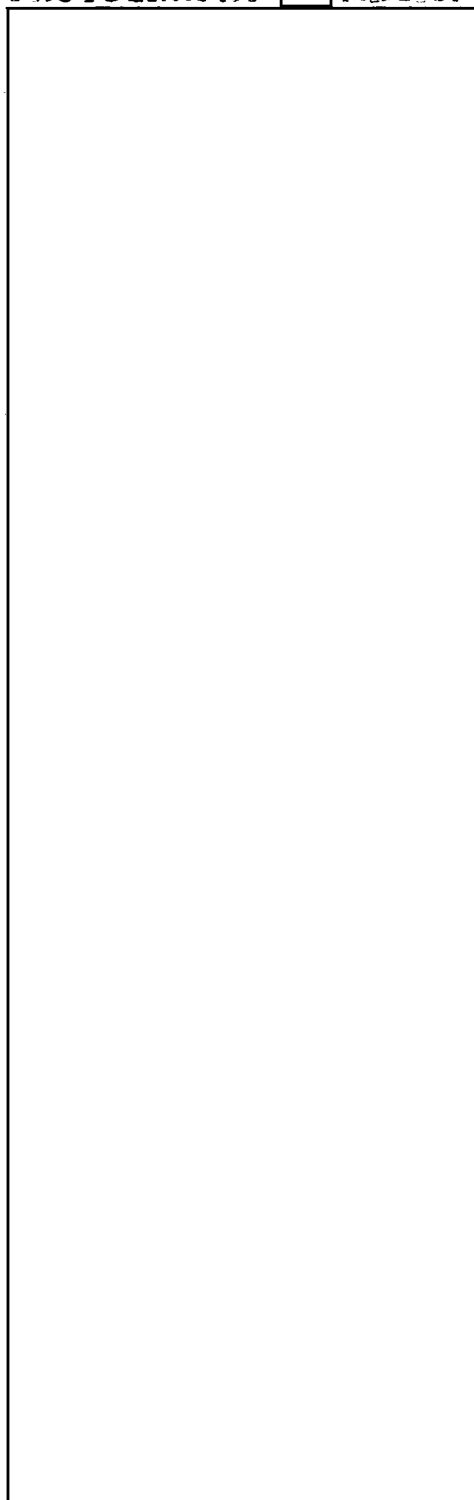

25X1D

\*

A 0000714

25X1

Power Revision  
Copy 64 of 100 Copies  
Page 10 of 22 Pages

25X1

25X1

HARDENED SITES

TOP SECRET [REDACTED]

25X1

Approved For Release 2003/09/02 : CIA-RDP78T05439A000200390072-2

<u>LOCATION</u>	<u>NO. OF SITES</u>	<u>NO. OF LAUNCHERS</u>
BELOKOROVICH	1	2
BRODY	1	2
DERAZHNYA	1	2
DOLINA	1	2
DROBOBYCH	1	2
GRANOV	1	2
JELGAVA	1	2
LUTSK	1	2
MOLOSKOVITSY	1	2
NADVORNYA	1	2
NIGRANDE	1	2
*PERVOMAYSK # 1	1	2
*PERVOMAYSK # 2	1	2
SATEIKIAI	1	2
SMORGON	1	2
SOKAL	1	2
*TAYBOLA # 1	1	2
*TAYBOLA # 2	1	2
ZAGARE	1	2
ZHMERINKA	1	2
<b>GRAND TOTALS</b>	<b>157</b>	<b>588</b>

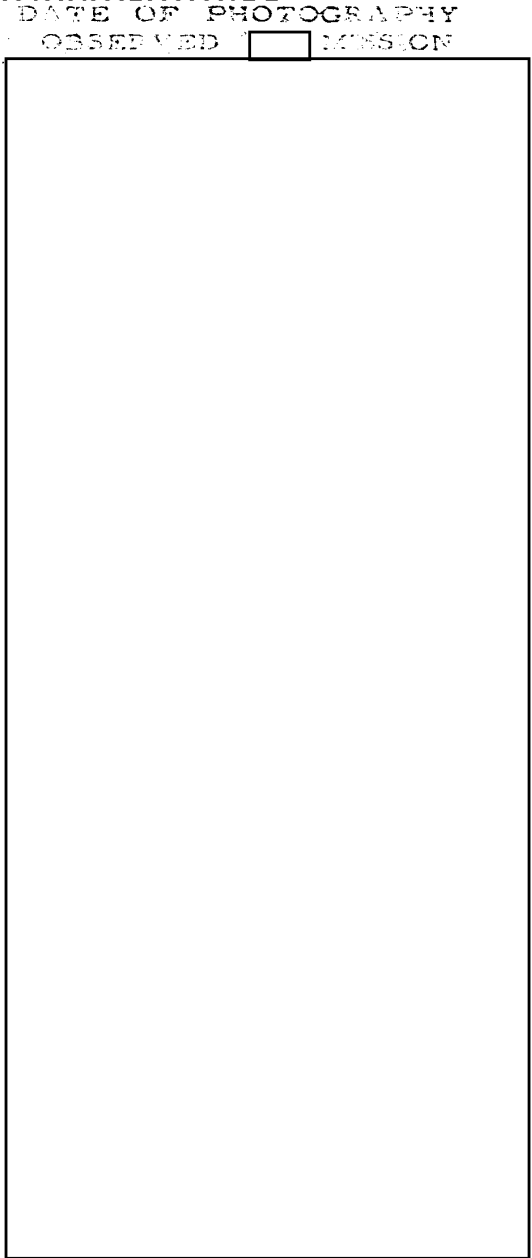

25X1

25X1D

\* Sites Not Located Near Soft MRBM/IRBM Sites

A 0000714

[REDACTED]

(Fourth Revision)

Copy 04 of 10 Copies

Page 11 of 22 Pages

25X1

TOP SECRET [REDACTED]

25X1

ALPHABETICAL LISTING OF LOCATIONS CONSIDERED IN DETAIL

<u>PLACE NAME</u>	<u>EVALUATION</u>	
	<u>ICBM</u>	<u>MRBM/IRBM</u>
AKHTYRKA	Negative	Confirmed
AKMOLINSK	Negative	Negative
ALMA ATA	Negative	Negative
ALSUNGA (See KULDIGA Area)		
ALUKSNE	Negative	Confirmed
ALYKEL	Negative	Negative
ANADYR ( See UGOL'NYYE KOPI )		
ANASTASYEVKA	Negative	Confirmed
ARAL'SK	Negative	Negative
ARKHANGEL'SK	Negative	Negative
ASANOVSHCHINA (See OSTROV)		
AY PETRI	Negative	Negative
<sup>1</sup> BALAKLAVA	Negative	Negative
BALTA	Negative	Confirmed
BARANO-ORENBURGSKOYE	Negative	Confirmed
<sup>2</sup> BAUTINO	Negative	Negative
BELAYA TSERKOV'	Negative	Negative
BELOKOROVICHI	Negative	Confirmed
BERDICHEV	Negative	Confirmed
BEREGOVO (See MUKACHEVO)		
BERESTECHKO (See BRODY)		
BEREZOVKA (SARATOV -ENGELS Area)	Negative	Negative
BEREZOVKA (See DYATLOVO )		

1/ Confirmed cruise missile facility.

2/ ASM Test Range

A 0000714

(Fourth Revision)

COPY 64 of 100 Copies

Page 12 of 22 Pages

<u>PLACE NAME</u>	<u>ICBM</u>	<u>MRBM/IRBM</u>
BERINGOVSKIY	Negative	Negative
BORKHOV (See GOMEL)		
BORKOVICH	Negative	Confirmed
BORSHCHEV (See SKALA PODOL'SKAYA)		
BREST	Negative	Confirmed
BRODY	Negative	Confirmed
*BULZHINO	Negative	Undetermined
BYTEN (See SLONIM)		
*CHAADAYEVKA	Undetermined	Undetermined
CHAPAYEVKA	Negative	Negative
CHAPAYEVSK	Negative	Negative
CHELKAR	Negative	Confirmed R&D
CHEREPOVETS	Negative	Negative
CHITA (See DROVYANAYA)		
CHKALOV (See ORENBURG)		
DAUGAVPILS	Negative	Negative
DELYATIN	Negative	Negative
DERAZHNYA	Negative	Confirmed
DISNA	Negative	Confirmed
DOBROVODY (See UMAN)		
DOLINA	Negative	Confirmed
DOLON'	Negative	Negative
DONOK	Negative	Negative
DROGOBYCH	Negative	Confirmed
DROVYANAYA	Confirmed	Negative
DUBROVO	Negative	Undetermined
DUNAYEVTSY	Negative	Confirmed

A 0000714

25X1

(Fourth Revision)

Copy 64 of 100 Copies  
Page 12 of 22 Pages

<u>PLACE NAME</u>	<u>ICBM</u>	<u>MRBM/IRBM</u>
DUNDAGA (See KULDIGA Area)		
DURBE (See PAPLAKA)		
DYATLOVO	Negative	Confirmed
ENGEL'S (See SARATOV/ENGELS Area)		
FEDODOSIYA <sup>1</sup>	Negative	Negative
FRUNZE	Negative	Negative
GLADKAYA	Confirmed	Negative
GLAZOV	Negative	Negative
GNIVAN ( See ZHMERINKA)		
GODYKHA	Negative	Confirmed
GOMEL	Negative	Confirmed
GORODOK (L'VOV Area)	Negative	Undetermined
GRANOV	Negative	Confirmed
GRESK	Negative	Confirmed
GROBINA (See PAPLAKA)		
GRODEKOVO (See BARANO-ORENBURGSKOYE)		
GUSEV	Negative	Confirmed
GVARDEYSK	Negative	Confirmed
HIUMAA ISLAND	Negative	Negative
IECAVA (See JELGAVA)		
IRKUTSK	Negative	Negative
ITATKA	Confirmed	Negative
IUL'TIN	Negative	Negative
IVANOVO (See PINSK)		
JELGAVA	Negative	Confirmed
JONAVA	Negative	Confirmed

<sup>1</sup> / Possible cruise missile facility

A 0000714

[REDACTED]  
 (Fourth Revision)

Copy *64* of ~~100~~ Copies

PLACE NAME Approved For Release 2003/09/02 : CIA-RDP87T05439A000200390072-2

**KAMENETS PODOL'SKIY ( See DUNAYEV TSY)**

KAMYSHIN	Negative	Negative
KANDAGACH	Doubtful	Doubtful
KANDALAKSHA	Negative	Doubtful
KAPUSTIN YAR	Negative	Confirmed R&D
KARABABAU (See SARY OZEK)		
KARANGIT <sup>1</sup>	Negative	Negative
KARKARALINSK	Negative	Negative
KARMELAVA (See JONAVA)		
KEDAINAI	Negative	Negative
KHAAP SALU (See RISTI)		
KHABAROVSK (See ANASTASYEVKA)		
KHASHURI	Negative	Negative
KHVALINSK	Negative	Negative
KHYROV	Negative	Undetermined
KIEV	Negative	Negative
KILDIN ISLAND <sup>2</sup>	Negative	Negative
KINESHMA	Negative	Negative
KIRENSK	Doubtful	Negative
KIVERTSY	Negative	Confirmed
KLAIPEDA	Negative	Doubtful
KLESOV ( See SARNY)		
KOLGOMPYA	Negative	Negative
KONKOVICHI (See PETRIKOV)		
KOROSTEN	Negative	Confirmed
KOSE ( See TALLINN)		
KOSTROMA	Confirmed	Negative
KOZELSK	Confirmed	Negative

1/ Possible cruise missile facility.

2/ Confirmed cruise missile facility.

A 0000714

25X1



Approved For Release 2003/09/02 : CIA-RDP78T05439A000200390072-2

PLACE NAME	EVALUATION	IRBM
KOZHANOVICHI	Negative	Confirmed
KOZYANY (See POSTAVY)		
*KRASKINO	Negative	Confirmed
KRASNOARMEYSKOYE (See SARATOV/ENGELS Area)		
KRASNOYARSK (See GLADKAYA)		
KRASNOZNAMENSK (See RAGNIT)		
*KREMOVO	Negative	Negative
KRISTANOPOL (See SOKAL)		
KROLEVETS	Negative	Confirmed
KRUPA (See RUZHANY) *		
*KULDIGA AREA	Negative	Negative
KUNGUR (See PERM)		
KURDZHIPS KAYA (See MAYKOP)		
KURGANCHA	Negative	Confirmed
KURITICHI (See POTRIKOV)		
KURMENI (See MARCIANA/MADONA)		
KYSHTYM	Negative	Negative
LEBEDIN	Negative	Confirmed
LIDA	Negative	Confirmed
LIPNIKI	Negative	Confirmed
LUTSK	Negative	Confirmed
L'VOV	Negative	Negative
LYALICHI (See KREMOVO)		
MAKAT	Negative	Confirmed R&D
MALAYA SAZANKA	Negative	Negative
MANKOVKA (See UMAN)		
MARCIANA/MADONA AREA	Negative	Undetermined

A 0000714

25X1

(Fourth Revision)  
 Copy 17 of 100 Copies  
 Page 16 of 22 Pages

PLACE NAME

Approved For Release 2003/09/02 : CIA-RDP78T05439A000200390072-2

25X1

MARINA GORKA	Negative	Confirmed
MAYKOP	Negative	Confirmed
MEDENITSA (See DROGOBYCH)		
MEDVED	Negative	Negative
MOLODETSKOYE (See UMAN)		
MOLOSKOVITSY	Negative	Confirmed
MONTYGINO	Negative	Negative
MOTOL ( See PINSK)		
MOZHAYSK	Negative	Negative
MUKACHEVO	Negative	Confirmed
* MURMANSK	Negative	Doubtful
NADVORNAYA	Negative	Confirmed
NENOKSA <sup>1</sup>	Negative	Negative
NIGRANDE	Negative	Confirmed
NIZHNYAYA SALDA (See VERKHNYAYA SALDA)		
NIZHNYAYA TURA (See VERKHNYAYA SALDA)		
NORIL'SK	Negative	Negative
NOVAYA MEZINOVKA	Negative	Negative
NOVITSKOYE ( See SUCHAN)		
NOVOLITOVSK ( See SUCHAN)		
NOVOSIBIRSK	Confirmed	Negative
NOVOSYSOYEVKA	Negative	Confirmed
NOVOVES (See NADVORNAYA)		
* NYANDOMA	Undetermined	Undetermined
OBOZERSKAYA	Negative	Negative
*OLEN'YA AREA <sup>2</sup>	Negative	Undetermined

1/ Possible cruise missile facility.

2/ For MRBM/IRBM- 4 Undetermined, 1 possible

A 6660714

25X1

Fourth Revision  
 Copy 4 of 100 Copies  
 Page 11 of 22 Pages

PLACE NAME

ICBM

MRBM/IRBM

OLEVSK ( See BELOKOROVICHI)		
OL'GOPOL ( See BALTA)		
OMSK	Confirmed	Negative
ORENBURG	Negative	Negative
OSTROG	Negative	Confirmed
OSTROV	Negative	Confirmed
OTAR	Negative	Negative
OVRUCH ( See USOVO and LIPNIKI)		
PAPLAKA	Negative	Confirmed
PARYSHCHE ( See NADVORNAYA)		
PERM	Confirmed	Negative
PERVOMAYSK	Negative	Confirmed
PETRIKOV	Negative	Confirmed
PEVEK	Negative	Negative
PILTENE (See KULDIGA Area)		
PINSK	Negative	Confirmed
PLESETSK	Confirmed	Negative
POCHINOK	Negative	Negative
PODPOLOZ'YE	Negative	Undetermined
POLOTSK	Negative	Confirmed
POLTAVA	Negative	Negative
POLYARNYY URAL	Negative	Negative
POSTAVY	Negative	Confirmed
PROKHORY (See SPASSK DAL'NIY)		
PROVIDENYA	Negative	Doubtful
PRUSHANY	Negative	Confirmed
RAGNET	Negative	Confirmed
RAKVERE	Negative	Confirmed

A 0000714

(Fourth Revision)

PLACE NAME

Approved For Release 2003/09/02 : CIA-RDP78T05439A000200390072-2

ICBM MBBM/IRBM

RISTI ( KHAAP SALU)	Negative	Confirmed
ROZHDESTVENKA	Negative	Confirmed
RUSKI ( See ALUKSNE)		
RUZHANY	Negative	Confirmed
SAAREMAA ISLAND	Negative	Negative
SALANTAI ( See SATEIKIAI)		
SALEKHARD	Negative	Negative
SAMLAND PENINSULA	Negative	Negative
SARATOV- ENGELS AREA	Negative	Negative
SARNY	Negative	Doubtful
SAROVA	Negative	Negative
SARY OZEK	Negative	Confirmed
SARY SHAGAN	Negative	Negative
SATEIKIAI	Negative	Confirmed
SEMIPALATINSK	Negative	Negative
SERGACH	Negative	Negative
SEVASTOPOL'	Negative	Negative
SEVERNYY SUCHAN ( See SUCHAN)		
SHADRINSK	Confirmed	Negative
SHAGAN ( See DOLON)		
SHEPETOVKA ( See OSTROG)		
*SHESTOVO	Negative	Undetermined
SHEVELEVO ( See OSTROV)		
SHIKHANY	Negative	Negative
SHISHCHITSY (See GRESK)		
SIMUNA ( See RAKVERE)		
SKALA PODOL'SKAYA	Negative	Confirmed
SLAVSK ( See SOVETSK)		
*SLAVYANKA ( See KRASKINO)		

// ABM R&amp;D facility.

A 0000714

25X1

(Fourth Revision)

Copy 64 of 100 Copies  
Page 14 of 22 Pages

TOP SECRET [REDACTED]

25X1

PLACE NAME Approved For Release 2003/09/02 : CIA-RDP78T05439A000200390072-2 ICBM MRBM/IRBM

## SLITERE ( See KULDIGA Area)

-SLONIM	Negative	Confirmed
SMORGON	Negative	Confirmed
SOFIYA ALEXSEYEVKA ( See BARANO-ORENBURGSKOYE)		
SOKAL	Negative	Confirmed
SOLY ( See SMORGON)		
SOVETSK	Negative	Confirmed
SOVETSKAYA GAVAN AREA <sup>1</sup>	Negative	Negative
SPASSK-DAL'NY	Negative	Negative
*STALINABAD	Negative	Negative
SUCHAN	Negative	Confirmed
SUDAK	Negative	Negative
SUROVATIKHA	Negative	Negative
*SVALYAVA AREA	Negative	Possible
SVERDLOVSK	Negative	Negative
SVOBODNY	Confirmed	Negative
TALLINN	Negative	Negative
TAMBOV	Negative	Negative
TASHARA	Negative	Negative
TASHKENT	Negative	Negative
TAURAGE	Negative	Confirmed
TAYBOLA	Negative	Confirmed
TEYKOVO	Confirmed	Negative
TIKSI	Negative	Negative
TOMSK (See ITATKA)		
TOROPETS	Negative	Negative
TORVA	Negative	Confirmed
TROSTYANETS	Negative	Confirmed

1/ MRBM firings confirmed - no fixed sites in  photography

25X1

A 0000713

( Fourth Revision)

Copy 64 of 100 Copies

25X1

PLACE NAME	EVALUATION	
	ICBM	MRBM/IRBM
TUAPSE	Negative	Negative
TUKUMS	Negative	Negative
TYUMEN	Confirmed	Negative
TYURA TAM	Confirmed R&D	Negative
UFA	Doubtful	Negative
UGOL'NYYE KOPI <sup>1</sup>	Negative	Confirmed
UKMERGE	Negative	Confirmed
UKRAINA	Negative	Negative
ULAN UDE	Negative	Negative
UMAN <sup>2</sup>	Negative	Confirmed
URECH'YE	Negative	Confirmed
USOVO	Negative	Confirmed
USSURISK VOZDVIZHENKA	Negative	Negative
UST'-UKHTA	Negative	Negative
UZHGOROD	Negative	Undetermined
VAKIE MAARJA (See RAKVERE)		
VALDAY	Negative	Negative
VERKHNYAYA SALDA	Confirmed	Negative
VEPRIAI (See UKMERGE)		
VIESVILLE ( See RAGNIT)		
VINNIKI (See L'VOV)		
*VINNITSA ( See ZHMERINKA)		
VLADIVOSTOK	Negative	Negative
VOLKOVYSK	Negative	Negative
*VOLODARSK	Undetermined	Undetermined
VOLOGDA/SOKOL	Negative	Negative

<sup>1</sup> / Referred to as Ugolnyy in some documents. Since Beringovskiy was formerly known as Ugolnyy, the DWG has selected Ugolnyy Kopi as the correct place name for this MRBM/IRBM site.

A 0000714

Fourth Revision  
 Copy 64 of 100 Copies  
 Page 1 of 22 Pages

PLACE NAME

25X1

\*VOLOVERS (See SVALYAVA)

VORKUTA

Negative

Negative

VORU

Negative

Confirmed

VSELYUB

Negative

Confirmed

YAKUTSK

Negative

Negative

YASVA ( See VERKHNYAYA SALDA)

YATSUKI ( See DYATLOVO)

YEDROVO

Confirmed

Negative

YEKATERINOVKA ( See SUCHAN)

YELSK

Negative

Confirmed

YEVPARATORIYA I

Negative

Negative

YOSHKAR-OLA

Confirmed

Negative

YURYA

Confirmed

Negative

YURYUZAN

Negative

Negative

ZAGARE

Negative

Confirmed

ZELKI (See DISNA)

ZHEREBKOVO ( See BALTA)

ZHIMERINKA

Negative

Confirmed

ZHITOMIR ( See GODYKHA)

ZNAMENSK

Negative

Confirmed

25X1D

1/ Space tracking facility

[Redacted]

A 0000714

[Redacted]

Fourth Revision  
Copy 64 of 100 Copies  
Page 22 of 22 Pages

25X

25X