

ILLEGIB

Approved For Release 2000/09/06 : CIA-RDP78T05439A000200420047-6

Approved For Release 2000/09/06 : CIA-RDP78T05439A000200420047-6

Declass Review, NIMA/DoD

TCS 4648/63-KH  
M/EB 463/63  
30 October 1963  
Copy   /  

25X1A

MEMORANDUM FOR: Chief, Military-Economics Division, ORR

ATTENTION: Mr. [REDACTED]

THROUGH: Chief, Requirements Branch, Reconnaissance Group, CGS

FROM: Chief, CIA/PID (NPIC)

SUBJECT: Air Frame/Engine Research and Development Facilities in Moscow, USSR

REFERENCE: (a) Requirement RR/105/63  
(b) CIA/PID Project C 643-63

1. This memorandum is a partial response to your requirement dated 15 May 1963 requesting mensuration of buildings in air frame/engine research and development facilities in the USSR.

25X1D

2. (a) Mikoyan OKB-155 (Moscow). A line drawing delineating the major buildings in this installation was prepared utilizing the most recent coverage of the area [REDACTED]. Approximately 10-15 small buildings could not be delineated due to the small scale of the photography. All measurements were approximate due to the small scale and obliquity of the photography. The following buildings were delineated (see figure 1): Items (1) one building, 400 by 100 feet; (2) two buildings, a- 225 by 80 feet, b- 130 by 80 feet; (3) one building, a- 240 by 160 feet, b- 640 by 130 feet; (4) one building, 240 by 100 feet; (5) one building, a- 570 by 360 feet, b- 220 by 90 feet; (6) one building, 510 by 360 feet; (7) one building, a- 110 by 90 feet, b- 470 by 220 feet; (8) one building, 270 by 70 feet; (9) one building, 440 by 80 feet; (10) one building, 280 by 100 feet overall; (11) one building, 600 by 430 feet; (12) one building, 220 by 80 feet; (13) one building, 450 by 450 feet overall; (14) one building, 740 by 50 feet; and (15) one building, 850 by 70 feet overall.

25X1D

(b) Tsiam (Old Tsagi). A line drawing of this installation was prepared utilizing [REDACTED] photography. All buildings in the installation were shown. KEYHOLE coverage of the area was also examined. Due to the small scale and poor quality of the KEYHOLE coverage its use was limited. Building 26 (figure 2) appeared for the first time on Mission [REDACTED].

25X1D

The following buildings were delineated (see figure 2): Items (1) one building, a- 400 by 100 feet, b- 230 by 75 feet, c- 245 by 120 feet, d- 400 by 55 feet, e- 60 by 110 feet, shaded section probable 3 stories, remainder of building probable one story; (2) one building, 130 by 25 feet, probable one story; (3) one building, 85 by 45 feet, probable one story;

SUBJECT: Air Frame/Engine Research and Development  
Facilities in Moscow, USSR

TCS 4648/63-KH  
M/EB 463/63

(4) one building, 145 by 60 feet, probable one story; (5) one building, 85 by 45 feet, probable one story; (6) one building, 90 by 40 feet, probable one story; (7) one building, 180 by 45 feet, b- 90 by 45 feet, probable one story; (8) one building, a- 330 by 70 feet, b-105 by 35 feet, c- 350 by 60 feet, probable one story; (9) one building, 135 by 65 feet, probable one story; (10) one building, 175 by 35 feet, probable one story; (11) one building, 225 by 75 feet, probable one story; (12) one building, 160 by 30 feet, probable one story; (13) one building, a- 175 by 55 feet, b- 105 by 55 feet, probable one story; (14) one building, a- 145 by 75 feet, b- 245 by 105 feet, probable one story; (15) one building, 160 by 40 feet, probable three stories; (16) one building, 160 by 55 feet, probable one story; (17) one building, a- 60 by 25 feet, b- 130 by 55 feet, probable one story; (18) one building, a- 260 by 50 feet, b- two wings 165 by 40 feet, three stories; (19) three buildings, 125 by 45 feet, probable one story; (20) one building, 145 by 45 feet, probable one story; (21) one building, a- 200 by 70 feet, probable three stories, b- two wings 75 by 60 feet, probable one story; (22) one building, a- 230 by 70 feet, b- 215 by 60 feet, c- 300 by 120 feet, probable one story; (23) one building, 65 by 30 feet, probable one story; (24) one building, a- 35 by 20 feet, b- 105 by 40 feet, c- 45 by 35 feet, probable one story; (25) one building, 560 by 50 feet, probable three stories; (26) one building, a- 270 by 50 feet, b- two wings 50 by 50 feet, probable three stories; (27) one building, a- 75 by 40 feet, b- 195 by 50 feet, c- 60 by 30 feet, probable four stories; (28) four buildings, 125 by 40 feet, probable one story; (29) one building, 125 by 45 feet, probable one story; (30) one building, a- 225 by 40 feet, b- two wings 50 by 40 feet, probable three stories; (31) one building, 125 by 45 feet, probable three stories; and (32) one building, 385 by 40 feet, probable three stories.

25X1D (c) Moscow Aviation Institute. A line drawing of this installation  
25X1D was prepared utilizing [redacted] photography and KEYHOLE Missions [redacted]  
25X1D [redacted]. Due to the small scale and obliquity of the  
photography all measurements are approximate. Several small buildings in the  
northern sector of the installation could not be delineated due to the poor  
quality of the photography. The following buildings were delineated (see figure  
3): Items (1) one building, 110 by 110 feet; (2) one building, 90 by 100 feet;  
(3) one building, 75 by 65 feet; (4) one building, a- 450 by 95 feet, b- three  
wings 220 by 90 feet; (5) one building, 150 by 80 feet; (6) one building, a- 115  
by 60 feet, b- 145 by 60 feet; (7) one building, 65 by 50 feet; (8) one building,  
140 by 70 feet; (9) one building, 125 by 70 feet; (10) one building, a- 360 by  
65 feet, b- two wings 75 by 60 feet; (11) one building, 120 by 90 feet; (12) one  
building, a- 430 by 80 feet, b- two wings 120 by 80 feet; (13) eleven buildings,  
180 by 60 feet; (14) one building, 180 by 50 feet; (15) one building, 180 by 45

SUBJECT: Air Frame/Engine Research and Development  
Facilities in Moscow, USSR

TCS 4648/63-KH  
M/EB 463/63

feet; (16) one building, 165 by 90 feet; (17) one building, a- 285 by 70 feet, b- 270 by 70 feet, c- 420 by 60 feet, d- 70 by 120 feet; (18) one building, a- two wings 165 by 90 feet, b- 250 by 85 feet; (19) one building, 300 by 90 feet; (20) one building, a- 90 by 110 feet, b- 150 by 45 feet, c- 195 by 45 feet, d- two wings 90 by 45 feet; (21) one building, a- 330 by 45 feet, b- 400 by 40 feet, c- 400 by 40 feet, d- 400 by 60 feet, e- three sections 135 by 25 feet each, f- 590 by 80 feet; (22) one building, 195 by 90 feet; (23) one building, a- 145 by 100 feet, b- 390 by 70 feet; (24) one building, a- 270 by 70 feet, b- 100 by 70 feet; (25) one building, a- 390 by 50 feet, b- two wings 60 by 15 feet; (26) one building, 215 by 50 feet; (27) one building, a- 280 by 65 feet, b- two wings 75 by 60 feet; and (28) one building, a- 400 by 80 feet, b- 190 by 80 feet.

3. The photo analysts on this project are [REDACTED] and they may be contacted on extension 2078 for any further information.

4. Additional portions of this project will be forwarded as they are completed.

25X1A

25X1A

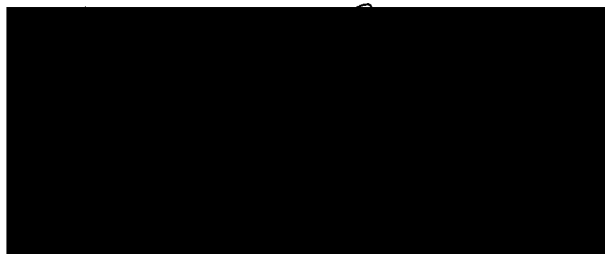

Enclosures:

- 1 - Three (3) line drawings  
(CIA/PID/MEB-P-242/63 thru P-244/63)

UNRECTIFIED DRAWING

TOP SECRET RUFF

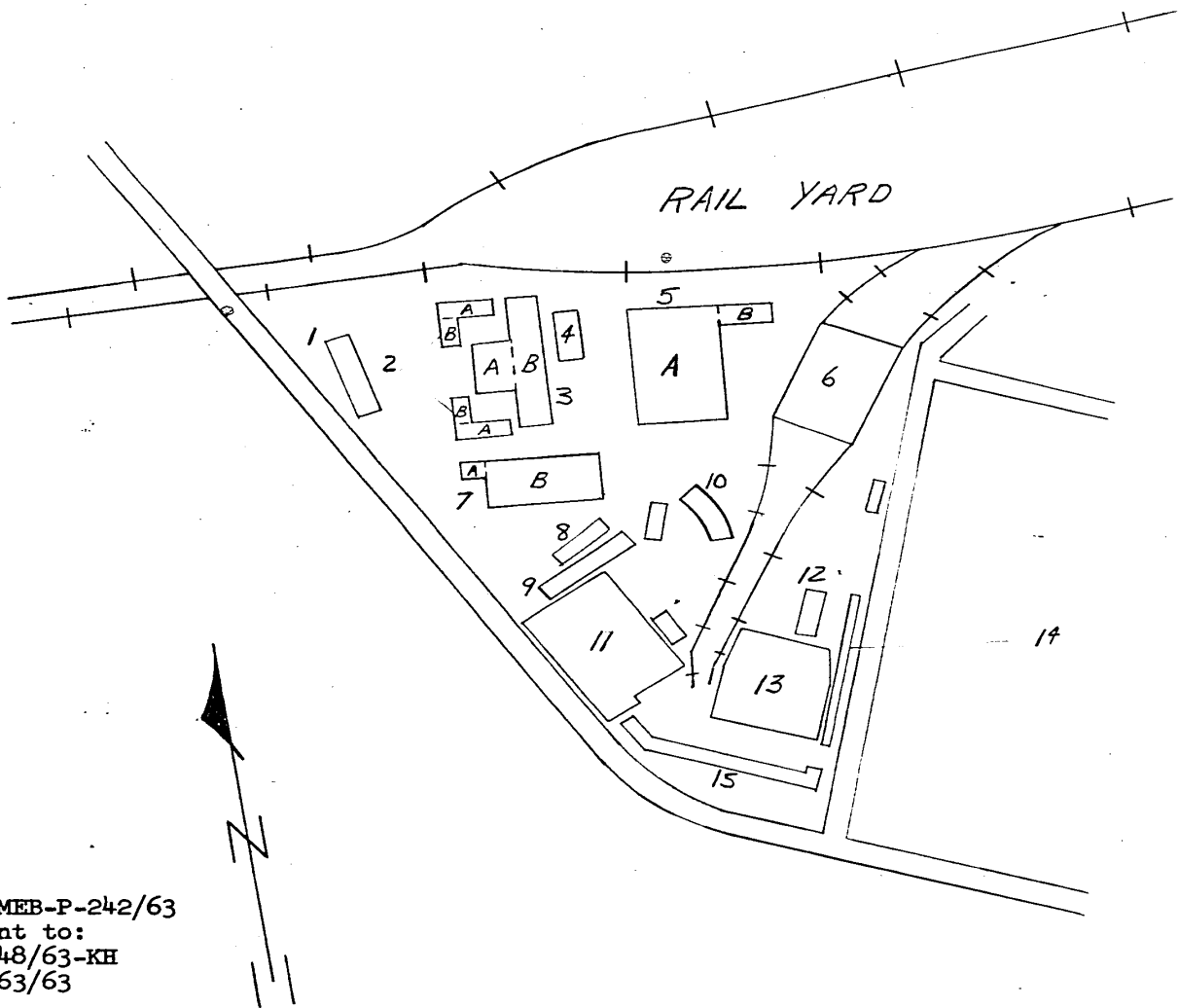

CIA/PID/MEB-P-242/63  
Attachment to:  
TCS 4648/63-KH  
M/EB 463/63

TOP SECRET RUFF

FIGURE 2

No 10 TSIAM

SHADED AREAS - MULTI-STORY

TOP SECRET RUFF

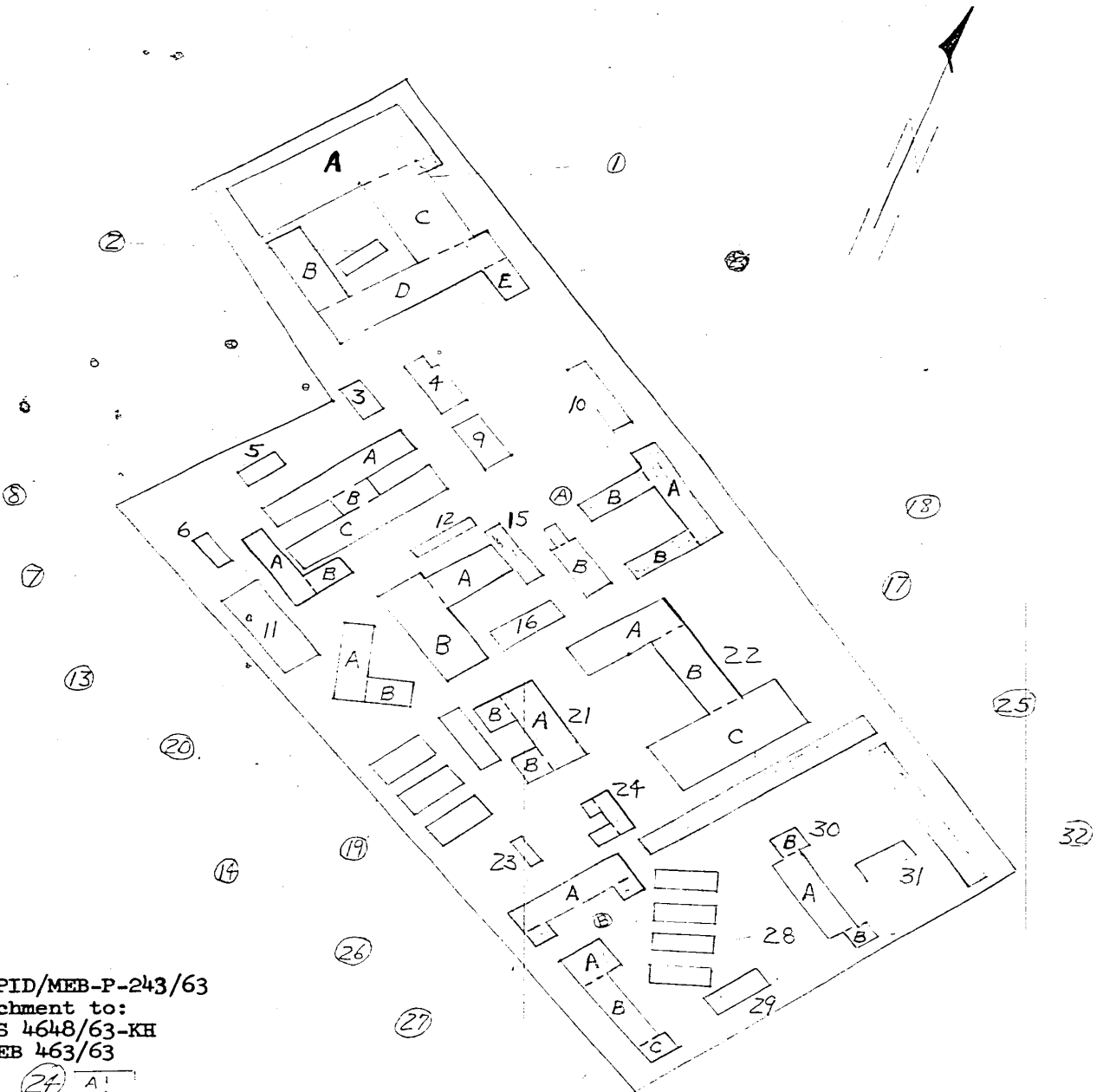

CIA/PID/MEB-P-243/63  
 Attachment to:  
 TCS 4648/63-KH  
 M/EB 463/63

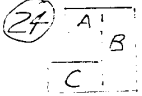

TOP SECRET RUFF

No. 11 - MOSCOW AIRFIELD 11.51110E

UNRECTIFIED DRAWING

TOP SECRET RUFF

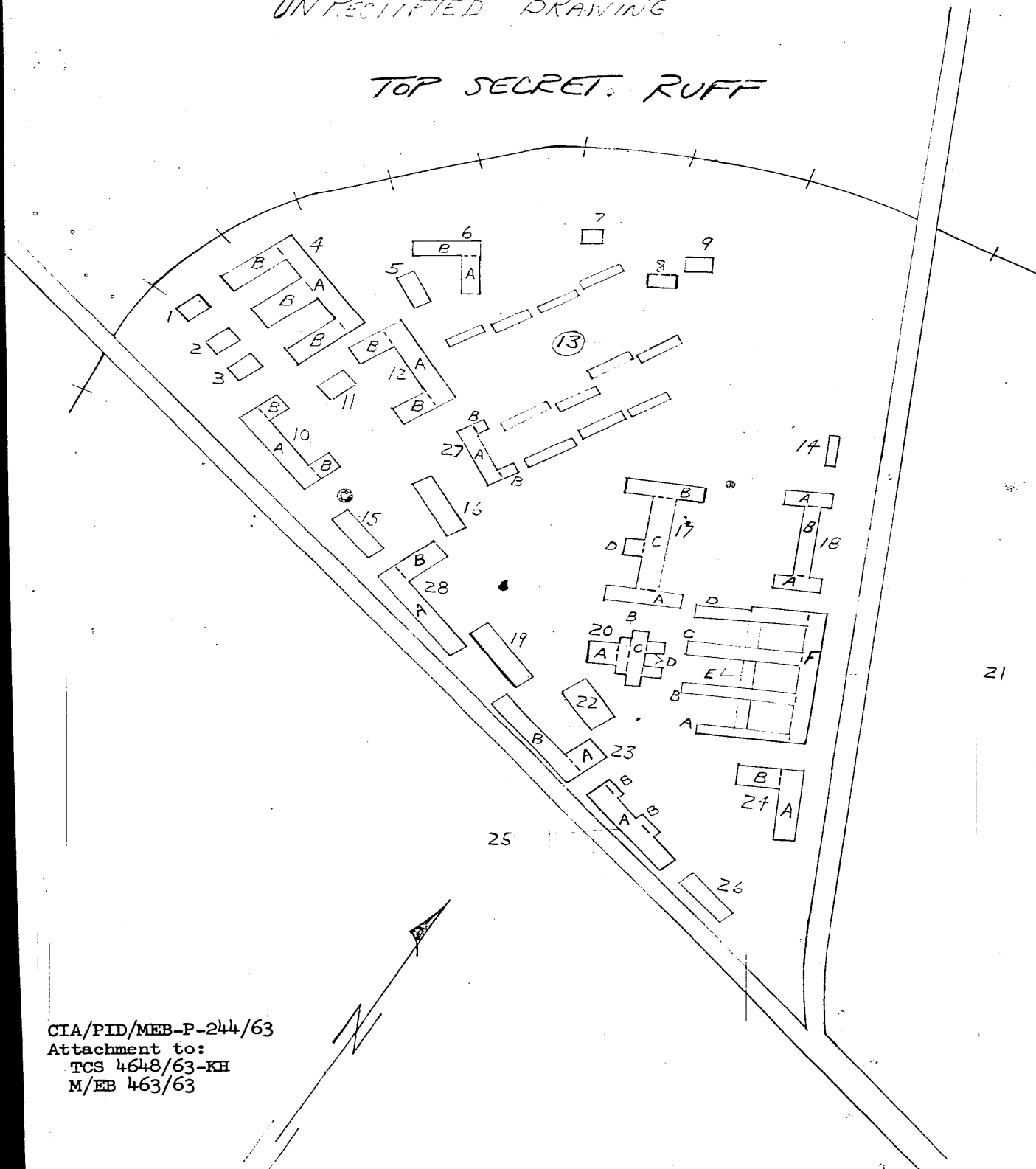

CIA/PID/MEB-P-244/63  
 Attachment to:  
 TCS 4648/63-KH  
 M/EB 463/63

TOP SECRET RUFF