

ILLEGIB

Approved For Release 2000/08/23 : CIA-RDP78T05439A000300280020-0

Approved For Release 2000/08/23 : CIA-RDP78T05439A000300280020-0

~~TOP SECRET RUFF~~

DECLASSIFICATION REVIEW by NIMA/DOD 3/21/00

TCS 1672/64-KH
M/EB 177/64
6 April 1964
Copy 1

MEMORANDUM FOR: Chief, Defensive Systems Division, OSI
ATTENTION: [REDACTED] 25X1A
THROUGH: Chief, Requirements Branch, Reconnaissance Group, CGS
FROM: Chief, CIA/PID (NPIC)
SUBJECT: Mensural Data on the Curved Building at Leningrad Probable
AMM Complex Northeast from [REDACTED] 25X1D
REFERENCES: (a) Requirement C-SI-4-81,202
(b) CIA/PID Project C 540-64

1. This memorandum is in response to your requirement dated 20 March 1964 requesting detailed mensural data on the curved building at the Leningrad northeast probable AMM complex derived from [REDACTED] 25X1D
[REDACTED] 25X1D A preliminary response to this requirement was provided to your office by telephone on 23 March at 0830.

2. Attached herewith find one line drawing with the pertinent information requested as provided by TID/NPIC.

The following qualifying information should be considered when applying any of the mensural data shown on the attached line drawing.

- (a) All building lengths and widths are [REDACTED] 25X1D
feet whichever is greater.
- (b) Door opening widths are [REDACTED] 25X1D
- (c) Door opening heights are [REDACTED] 25X1D
- (d) Building heights are [REDACTED]

25X1D

25X1B

8-12266

~~TOP SECRET RUFF~~

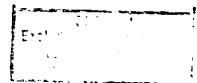

TOP SECRET RUFF

SUBJECT: Mensural Data on the Curved Building at
Leningrad Probable AMM Complex north-
east from [REDACTED]

TCS 1672/64-KH
M/EB 177/64

25X1D

25X1A

3. The photo analyst on this project is [REDACTED] who may be contacted on extension 2705 should you have any further questions concerning this project.

4. This project is considered to be complete.

[REDACTED]
25X1A

Enclosure:

- 1 - One (1) line drawing
(CIA/PID/MEB-P-343/64)

TOP SECRET RUFF

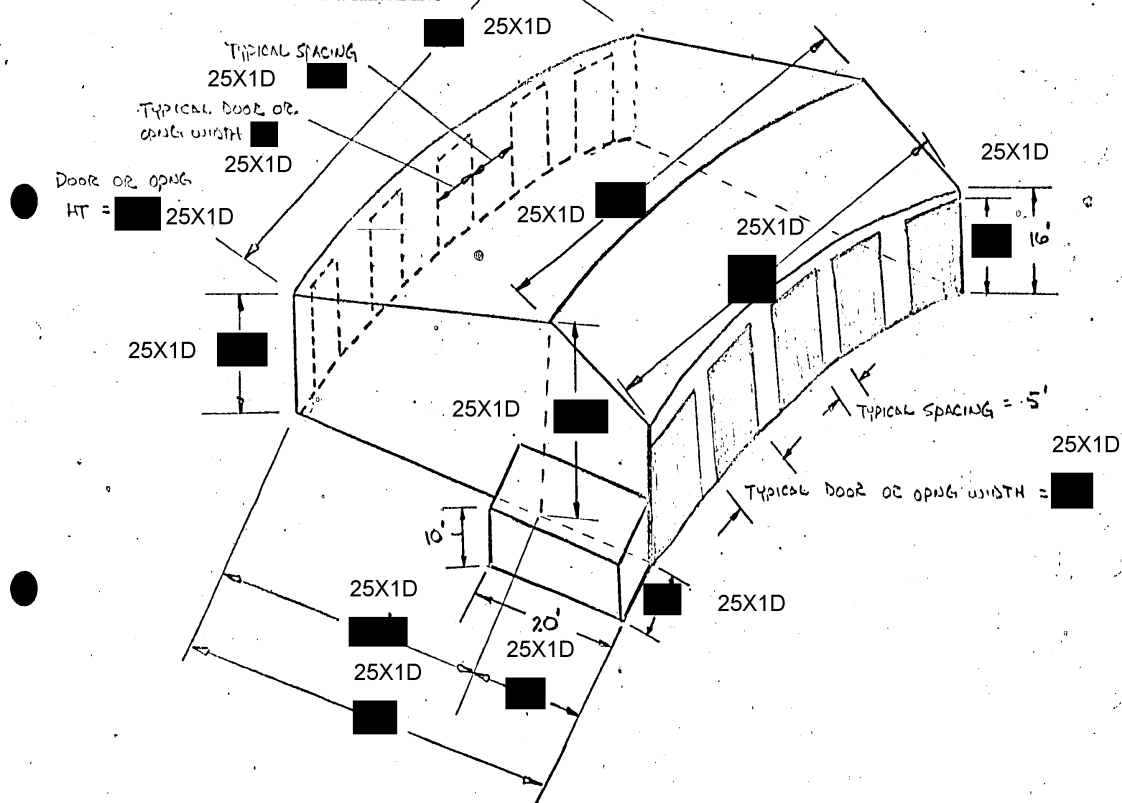

DISTANCES ARE CHORD LENGTHS NOT ARC LENGTHS

TOP SECRET RUFF