

FORM 470A

U. S. Official: Only

CONFIDENTIAL

~~CONFIDENTIAL~~

CENTRAL INTELLIGENCE AGENCY

INFORMATION REPORT

50X1-HUM

COUNTRY Czechoslovakia

SUBJECT 'Aero' Airplane Producing Factory

DATE DISTR. 27 May 1954

NO. OF PAGES 2

NO. OF ENCLS. 4

SUPP. TO
REPORT NO.

50X1-HUM

THIS DOCUMENT CONTAINS INFORMATION AFFECTING THE NATIONAL DEFENSE OF THE UNITED STATES, WITHIN THE MEANING OF TITLE 18, SECTIONS 793 AND 794, OF THE U.S. CODE, AS AMENDED. ITS TRANSMISSION OR REVELATION OF ITS CONTENTS TO OR RECEIPT BY AN UNAUTHORIZED PERSON IS PROHIBITED BY LAW. THE REPRODUCTION OF THIS REPORT IS PROHIBITED.

THIS IS UNEVALUATED INFORMATION

1. "Location of 'Aero' Factory: the factory is situated on the southern side of Fucik Street. The eastern side of the factory borders on Na Cerne Street. West of the factory is the automobile enterprise, Automobilove Zavody Klementa Gottwalda Narodni Podnik. South of the factory is an empty area. The northern side of the factory has a 3 meter high wall; the other sides are fenced by wire, 280 cm high.
2. "The factory employs 3000 workers, 40% of whom are women. No brigadiers [sic] or political prisoners can be employed here.
3. "Equipment: in the workshops where the material is prepared [sic], is the following equipment:
 - 2 new belt saw-mills for duralumin
 - 2 old belt saw-mills for steel
 - 1 big scissors for cutting duralumin and iron sheets (material is cut to 7mm.)
 - 10 vertical drilling machines
 - 1 small milling machine
 - 6 old vertical milling machines
4. "In the 'Trharna' checking workshop are two machines. The large one is used for checking material which goes into production of the fuselage and wings (occasionally); and the small one is used to check material going into production of ailerons and rudders.
5. "The tempering workshop has two tempering tanks about 5 meters deep. The temperature of the bath is 500° Centigrade. The object being tempered is always submerged for

CONFIDENTIAL

SECURITY INFORMATION

DISTRIBUTION	STATE	ARMY	NAVY	AIR	FBI	ORR: EV		
--------------	-------	------	------	-----	-----	---------	--	--

This report is for the use within the USA of the Intelligence components of the Departments or Agencies indicated above. It is not to be transmitted overseas without the concurrence of the originating office through the Assistant Director of the Office of Collection and Dissemination, CIA.

50X1-HUM

US OFFICIALS ONLY
CONFIDENTIAL

50X1-HUM

- 2 -

30 minutes, and is tempered 35 kg for [per ?] 1 mm. [sic]. All parts used in construction of the fuselage must be tempered here.

6. "The duralumin used at this factory is imported from the USSR.
7. "Airplane bodies produced at 'Aero' are always produced in a series. Each series produces 140 pieces for the fuselage [text reads "...of the bodies"].
8. "Production problems: the machinery is obsolete; the steel used in the knives of the milling and drilling machines is of poor quality; (the knives are not well tempered); there is a lack of good ball-bearings, and electric motors burned out frequently.
9. "In the summer of 53, [redacted] there was a shortage of duralumin. 50X1-HUM
10. "Completed airplane bodies, without wings, are checked by a special commission of the MNO (Ministerstvo Narodni Obrany). After this check, the fuselage is stamped and transported, by soldiers, to an unknown destination.
11. "The Five Year Plan was fulfilled 90% by this factory (according to the official factory publication).
12. [redacted] " general worker earns 700 crowns a month: these workers are mostly women. 50X1-HUM
13. [redacted] 50X1-HUM
14. "During the check of materials in the 'Trharna' section, Soviet Officers are usually present.
15. "In the gatekeepers' house there are always two members of the factory guard, armed with pistols. During the day a military guard, of two soldiers, constantly patrols the factory ground, armed with rifles.
16. "The morale of the workers is very poor because of the production problems, low salaries, and loss of confidence in Communist leadership.
17. "About half the workers eat in the factory mess hall. The food is poor.
18. "Most workers live in private residences .
19. "Political education is given once a week for 10 minutes after the shift ends. Once a month there is a compulsory workers meeting for Communists and non-Communists. Noone was interested in political education."

- end -

ENCLOSURE (A): Sketch of Layout of "Aero" National Enterprises with Legend 50X1-HUM
 (B): Sketch of Layout of Workshop No 4 with Legend
 (C): Sketch of Layout of Workshop No 6 with Legend
 (D): Sketch Showing Products of "Narezavarna" Shop with Legend

US OFFICIALS ONLY
CONFIDENTIAL

"Aero" National Enterprises

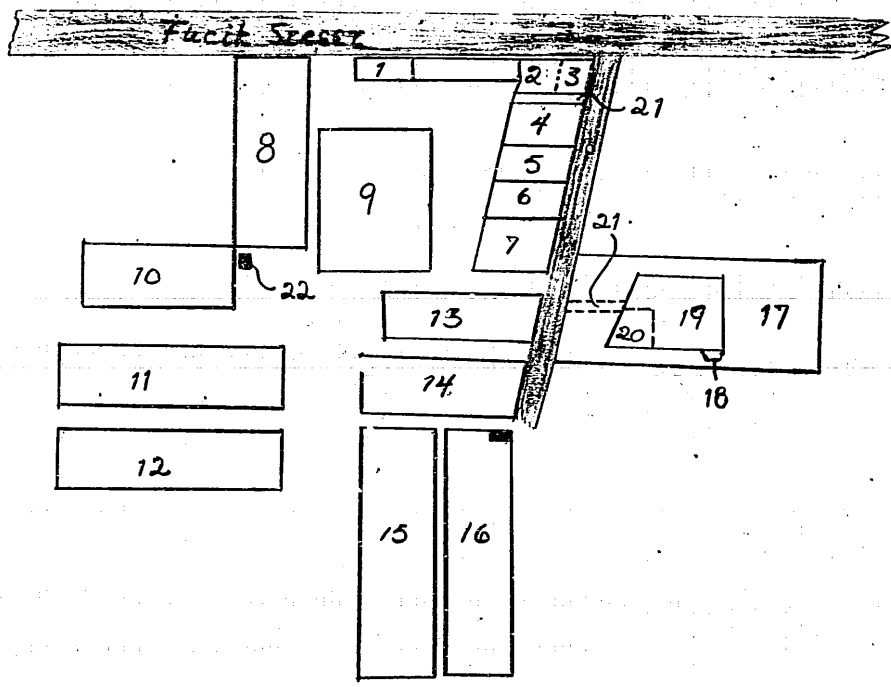

Enclosure A
 Page -1-
 NORTH ↑
 SKETCH OF LAYOUT OF "AERO" NATIONAL ENTERPRISES WITH LEGEND
 CONFIDENTIAL/US OFFICIALS

CONFIDENTIAL/US OFFICIALS ONLY

US OFFICIALS ONLY
CONFIDENTIAL



LETTER, ENCLOSURE A: 'AERO' NATIONAL ENTERPRISE, PRAGUE-VYSOCANY
Page -2-

50X1-HUM

1. Military guard-house. Day and night there is a ten man guard stationed here, composed of Czechoslovak Regular Army soldiers, mostly infantry men.
2. Personnel Office, and Workers Council Office.
3. Main gate-keepers' house. There are always two gate-keepers, members of the STB, on duty here.
4. Four-story building. 1st floor: cutting and preparation of iron and duralumin, (sheets); 2nd floor: cutting of duralumin sheets by saw-mills; 3rd and 4th floors: bookkeeping and administrative offices, technical drawer's office, manager's office.
5. Electrical oxygenation of duralumin sheets.
6. Central transformer station for the whole enterprise.
7. Tempering workshop.
8. Building for assembly of MIG 15 bodies, (just the spare parts for the fuselage are assembled here). There are relatively few workers in this building.
9. One-story building: purpose unknown. The northern part of the building houses the medical center.
10. Administration building; ground floor has workers' mess hall.
11. One-story building, purpose unknown.
12. Main material depot.
13. Building for the assembly of airplane bodies. Building is 7 meters high.
14. Assembly building, same as above.
- 15-16. Workshops, purpose unknown.
17. Here the duralumin of plane bodies is checked, as is that of the aerofoils (wings). There is one large, and one small, checking machine for this purpose.
18. Entrance (and exit?) gates for trucks.
19. Factory Guard.
20. Yard of private house.
21. Entrance (and exit?) gates for trucks.
22. Unused chimney of factory, 30 meters high.

US OFFICIALS ONLY
CONFIDENTIAL

Page -1-

Enclosure B

CONFIDENTIAL/IS OFFICIALS ONLY

Workshop No. 4 - "ASCO" NATIONAL

CYBER PRESS

50X1-HUM

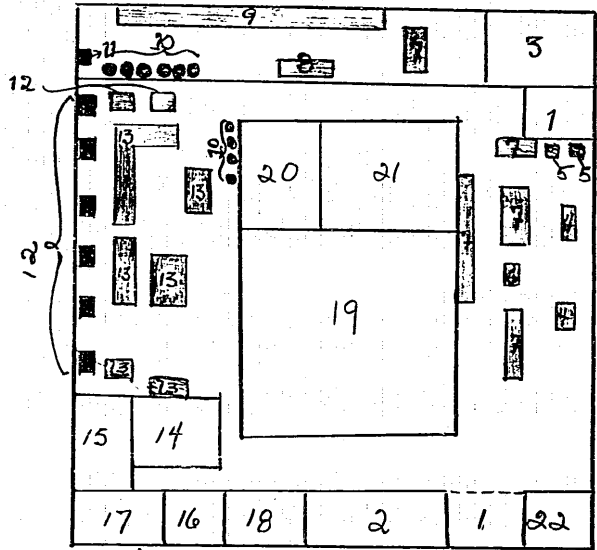

CONFIDENTIAL/IS OFFICIALS ONLY

US OFFICIALS ONLY
CONFIDENTIAL



ENCLOSURE B

Page -2-

LEGEND, WORKSHOP NUMBER 4, PREPARATION OF MATERIALS, ('AERO' NATIONAL ENTERPRISE)

1. Stairs
2. Empty space
3. Office of the District Working Chief (usekovy)
4. Belt saw-mill for duralumin (2 pieces)
5. Belt saw-mill for steel (2 pieces)
6. Saw mill
7. Working tables, for preparation of materials
8. Scissors for cutting iron and duralumin sheets
9. Working table
10. Drilling machines
11. Small milling machine
12. Vertical milling machine
13. Tables for preparation of materials
14. Checking station
15. Office of the Technical Workshop Chief
16. Women's dressing room
17. Wash rooms
18. Technical office
19. Small depot
20. Models depot
21. Dressing room for men
22. Lift

50X1-HUM

US OFFICIALS ONLY
CONFIDENTIAL

ENCLOSURE C

CONFIDENTIAL/US OFFICIALS ONLY

Page -1-

WORKSHOP No. 6. "AERO" NATIONAL
ENTERPRISES

50X1-HUM

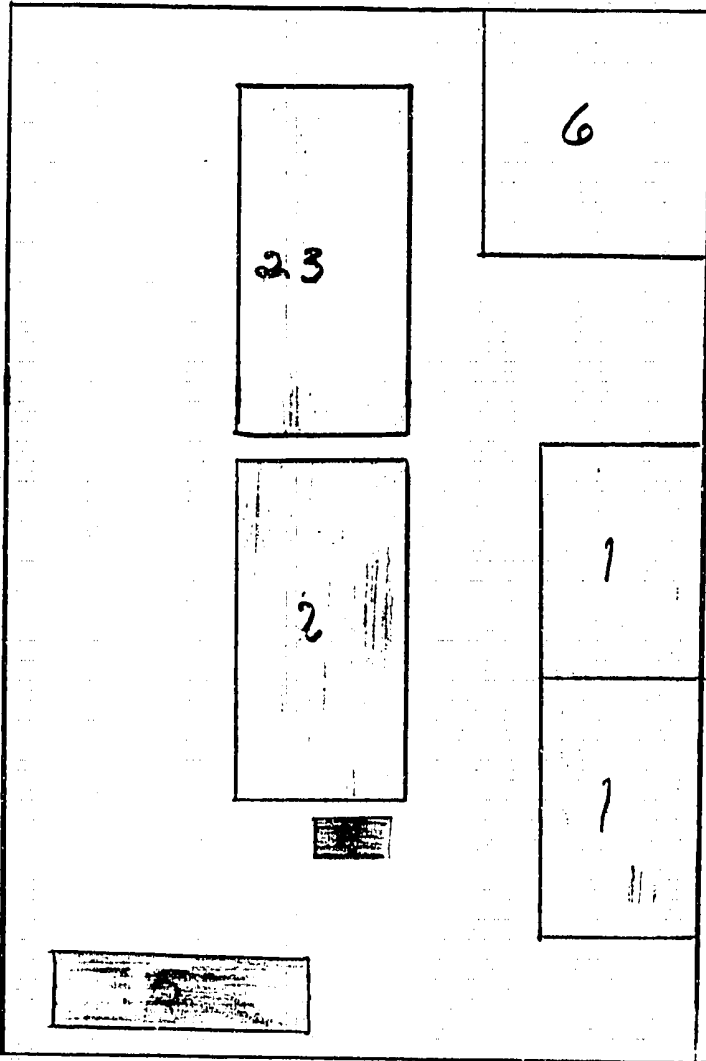

CONFIDENTIAL/US OFFICIALS ONLY

US OFFICIALS ONLY
CONFIDENTIAL



ENCLOSURE C.

Page -2-

LEGEND, TEMPERING WORKSHOP, NUMBER 6, ('AERO' NATIONAL ENTERPRISES)

50X1-HUM

1. Tempering tanks
2. Cooling tank for tempered material
3. Washing tank for tempered material
4. Working tables
5. Blackboard equipped with different electrical measuring apparatus [sic].
6. Room, purpose unknown.

US OFFICIALS ONLY
CONFIDENTIAL

ENCLOSURE D

CONFIDENTIAL/US OFFICIALS ONLY



Page -1-

PRODUCTS OF "NAREZAVARNA" SHOP

50X1-HUM

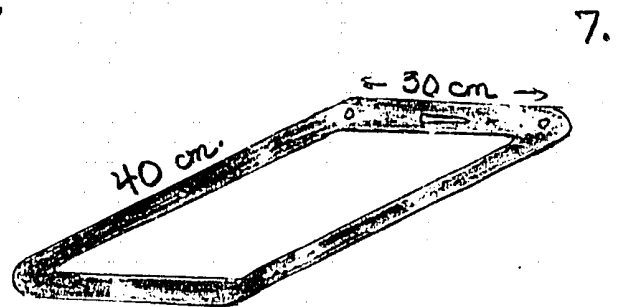
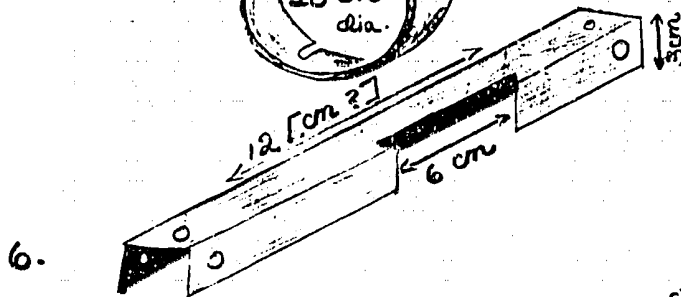
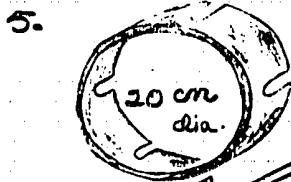
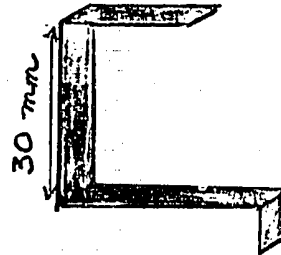
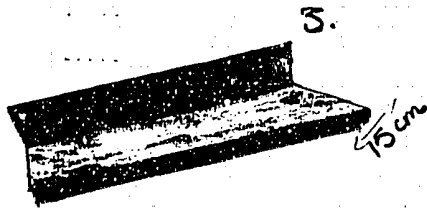
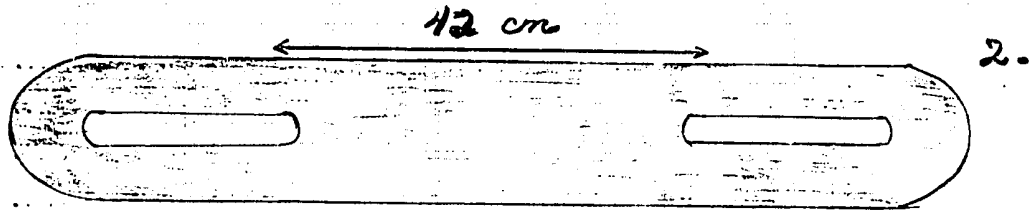
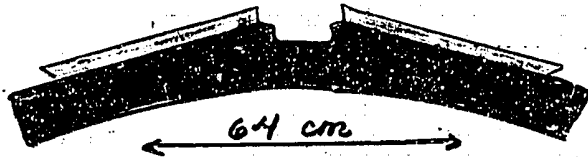

"AERO" NATIONAL ENTERPRISES

CONFIDENTIAL/US OFFICIALS ONLY

US OFFICIALS ONLY
CONFIDENTIAL



ENCLOSURE D

Page -2-

LEGEND, 'NAREZAVAFNA' WORKSHOP PRODUCTS, WITH DIMENSIONS. ('AERO' NATIONAL ENTERPRISES)

This workshop was engaged in the preparation and cutting of materials. Products of the shop are shown on enclosure. Dimensions are given, where known. The number of pieces, of each product, produced \angle per day? / is given below:

Product number

- 1..... 140 pieces
- 2..... 140 pieces
- 3..... 700 pieces
- 4..... 1100 pieces
- 5..... 140 pieces
- 6..... 140 pieces
- 7..... 140 pieces

50X1-HUM

Products number 1, 5, and 7 went to the pressing workshop; products number 2, 3, 4, and 6, went to the tempering workshop, and, thereafter, to the assembly building.

US OFFICIALS ONLY
CONFIDENTIAL