

CENTRAL INTELLIGENCE AGENCY

INFORMATION REPORT

This Document contains information affecting the National Defense of the United States, within the meaning of Title 18, Sections 793 and 794, of the U.S. Code, as amended. Its transmission or revelation of its contents to or receipt by an unauthorized person is prohibited by law. The reproduction of this form is prohibited.

SECRET
SECURITY INFORMATION

25X1

COUNTRY Bulgaria
SUBJECT The Port of Varna

REPORT

DATE DISTR. 25 May 1953

NO. OF PAGES 5

DATE OF INFO.

REQUIREMENT

25X1

PLACE ACQUIRED

REFERENCES

25X1

This is UNEVALUATED Information

THE SOURCE EVALUATIONS IN THIS REPORT ARE DEFINITIVE.
THE APPRAISAL OF CONTENT IS TENTATIVE.
(FOR KEY SEE REVERSE)

25X1

1. The sketch on pages 3 and 4, based on a drawing of the port of Varna shows the following installations:

1. Varna railway station.
2. Railway Administration building and dining room.
3. Building containing the following administrative offices:
 - a. Coastal construction and repair unit under command of the Navy;
 - b. Port Administrative offices; and
 - c. Customs offices.
4. Merchant Marine Administrative offices.
5. Offices of the Motorized Militia.
6. "Traffic Affairs" administrative offices.
7. Port administrative offices.
8. Living quarters of port administrative officials.
9. Living quarters of port administrative officials.
- 10, 11, 17, 19, 20, and 38. Warehouses for cereals, cotton, tobacco, and cement.

25 YEAR
RE-REVIEW

SECRET

STATE	X	ARMY	X	NAVY	X	AIR	X	FBI		AEC					
-------	---	------	---	------	---	-----	---	-----	--	-----	--	--	--	--	--

(Note: Washington Distribution Indicated By "X"; Field Distribution By "#".)

119

SECRET

-2-

25X1

12. Garage for the various types of vehicles used in connection with loading and unloading operations.
13. Repair shop for automotive vehicles.
14. Customs warehouse.
15. Customs warehouse.
16. Customs warehouse.
17. See No. 10 above.
18. Fire station.
19. See No. 10 above.
20. See No. 10 above.
21. Garage for the various types of vehicles used in connection with loading and unloading operations.
22. Military warehouse.
23. Military warehouse.
24. Warehouse earmarked for the storing of military supplies from the USSR.
25. Warehouse for wood products.
26. KORBSO (formerly NEPTUN) State Ship-Building Yards where smaller ships such as 300-ton trawlers are being constructed.
27. Warehouse for wood products.
28. KORBSO State Ship-Building Yards, for constructing small ships.
29. KORBSO State Ship-Building Yards, for constructing small ships.
30. Administrative offices and refrigerated warehouse of the State-operated fishing industry of Varna.
31. DOSO (Dobrovolna Organizatsiya za Sudeystvie na Otbranata; Voluntary Organization to Facilitate the Defense) boathouses.
32. DOSO boathouses.
33. Newly built quay about 200 to 250 meters long.
34. Quarters used by "the platoon guarding the port boundary."
35. Refrigerated warehouse.
36. Warehouse for "valuable materials."
37. Warehouse for "valuable materials."
38. See No. 10 above.
39. Lavatory.
40. Observation post.
41. Open air coal dump for use by the Merchant Marine.
42. Canning factory.
43. Zora Vegetable Oil Processing Plant.
44. KORBSO State Shipyards for the construction of ocean-going ships of up to 3,000 tons.
45. KORBSO State Shipyards' technical school.
46. Warehouse earmarked for the storing of military supplies from the USSR.
47. Warehouse earmarked for the storing of military supplies from the USSR.
48. Warehouse earmarked for the storing of military supplies from the USSR.
49. Barracks of the Militia guard platoon.
50. KORBSO State Shipyards for constructing ocean-going ships of up to 3,000 tons.
51. KORBSO State Shipyards for constructing ocean-going ships of up to 3,000 tons.
52. KORBSO State Shipyards for constructing ocean-going ships of up to 3,000 tons.
53. KORBSO State Shipyards for constructing ocean-going ships of up to 3,000 tons.
54. Barracks of the "Transpetrol" guards.
- 55, 60, and 61. Observation points on the military quay and the breakwaters manned by the Navy.
56. Barracks of the Naval Forces.
57. Barracks of the Naval Forces.
58. Barracks of the Naval Forces.
59. Barracks of the Naval Forces.
60. Barracks of the "Transpetrol" guards.
61. Space earmarked for antiaircraft batteries.
62. Earthworks.
63. See No. 55 above.
64. See No. 55 above.
65. Naval signal point.

SECRET

SECRET

PORT OF VARNA

-3-

25X1

(Not drawn to scale) -

25X1

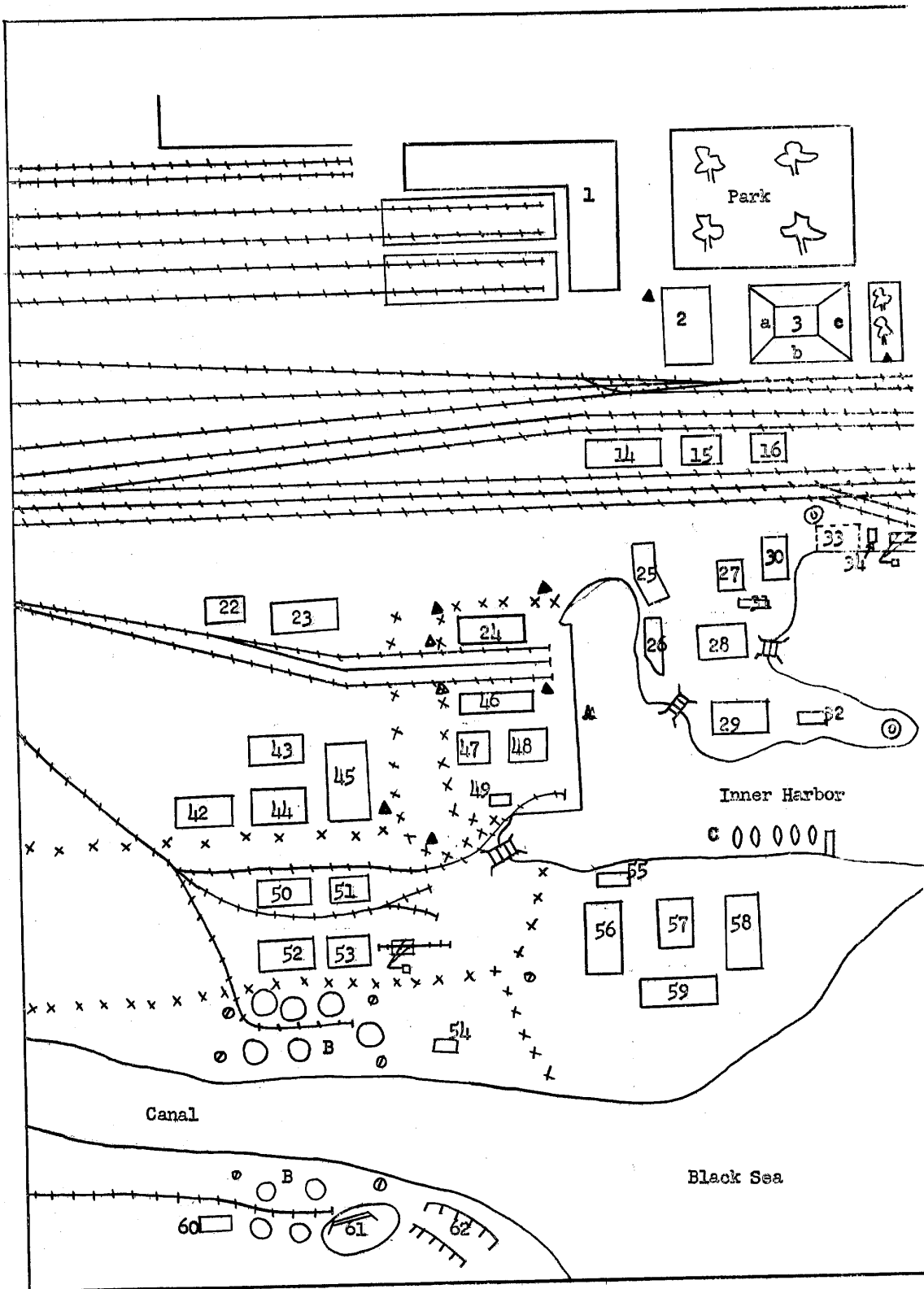

SECRET

SECRET

PORT OF VARNA (Continued)

-4-

25X1

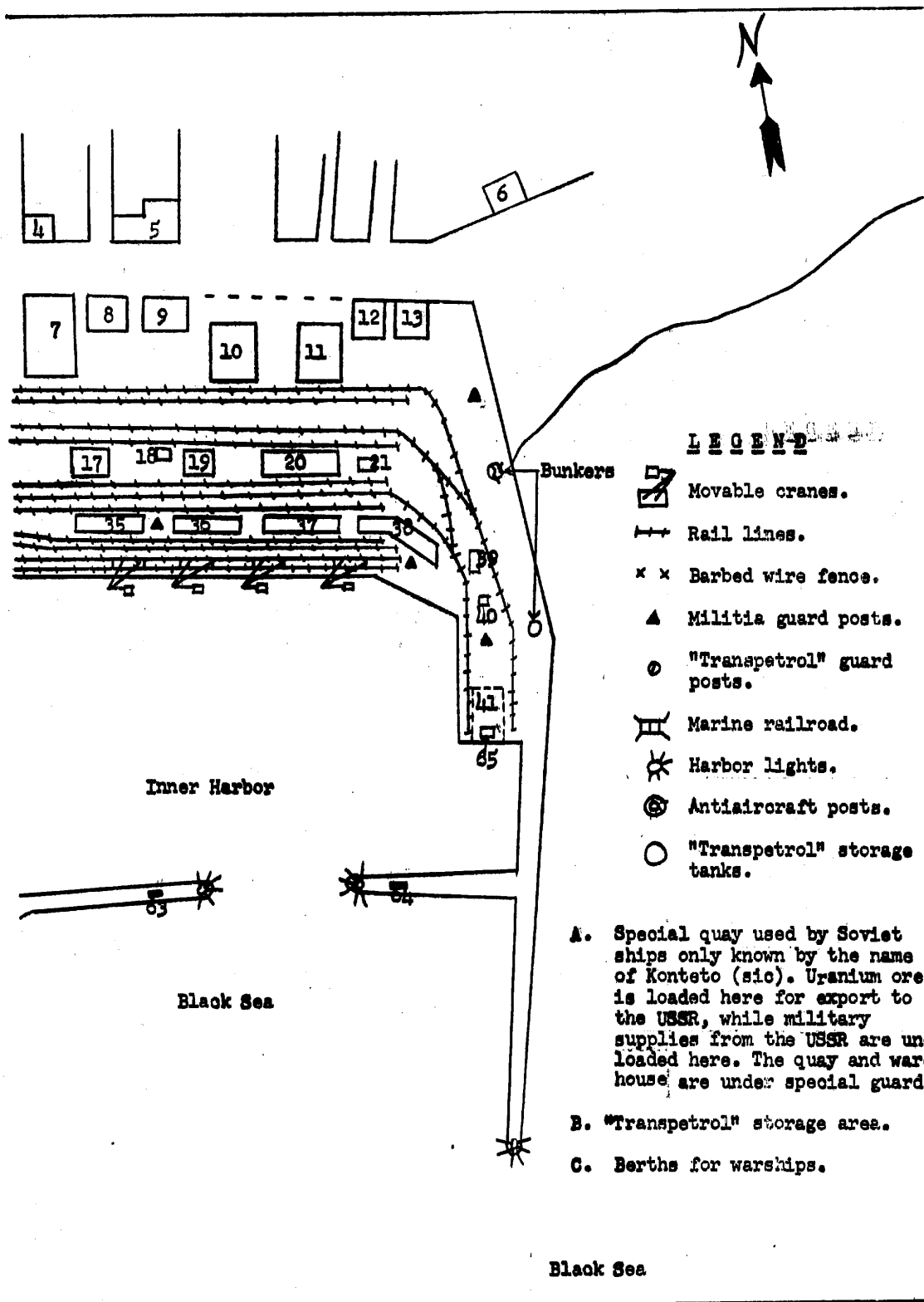

SECRET

SECRET

-5-

25X1

2. The following Soviet ships are the only ones which transport uranium ore from Varna to the USSR:

- a. The KARL MARX;
- b. The MARSHAL TOLBUKHIN;
- c. The MEKHANIK GERASIMOV; and
- d. The BEREZINA.

Both the KARL MARX and the MARSHAL TOLBUKHIN carry about 200 railroad cars of ore.

SECRET

CENTRAL INTELLIGENCE AGENCY

INFORMATION REPORT

This Document contains information affecting the National Defense of the United States, within the meaning of Title 18, Sections 793 and 794, of the U.S. Code, as amended. Its transmission or revelation of its contents to or receipt by an unauthorized person is prohibited by law. The reproduction of this form is prohibited.

SECRET
SECURITY INFORMATION

25X1

COUNTRY	Bulgaria	REPORT	
SUBJECT	1. Construction in Dimitrovgrad. 2. Construction in Varna. 3. Railroad Freight Car Factory in Varna	DATE DISTR.	25 May 1953
		NO. OF PAGES	2
DATE OF INFO.		REQUIREMENT NO.	RD
PLACE ACQUIRED		REFERENCES	25X1

This is UNEVALUATED Information

THE SOURCE EVALUATIONS IN THIS REPORT ARE DEFINITIVE.
THE APPRAISAL OF CONTENT IS TENTATIVE.
(FOR KEY SEE REVERSE)

25X1

Construction in Dimitrovgrad

1. A 3-story concrete building, 60 by 20 meters in size, is under construction approximately 300 meters northwest of the Dimitrovgrad railroad station. The third floor was in the process of completion in July 1952. Forty laborers, in groups of four or five, were working on the building which was to house the National Bank.
2. Approximately 30 meters east of the Bank building described in the paragraph above, a concrete building 50 by 20 meters in size is under construction. This is to be the new high school. As of July 1952, the second floor was almost completed. the building would have three floors and would be completed during September 1952. Approximately 25 laborers were working on the structure.
3. Workers' quarters were being erected in the Tolbukhin Quarter of Dimitrovgrad, about one kilometer east of the railroad station. These buildings are 60 to 80 by 20 meters in size and are 3- and 4-stories high.

25X1

25 YEAR
RE-REVIEW

SECRET

STATE	<input checked="" type="checkbox"/>	ARMY	<input checked="" type="checkbox"/>	NAVY	<input checked="" type="checkbox"/>	AIR	<input checked="" type="checkbox"/>	FBI	<input checked="" type="checkbox"/>	AEC						
-------	-------------------------------------	------	-------------------------------------	------	-------------------------------------	-----	-------------------------------------	-----	-------------------------------------	-----	--	--	--	--	--	--

(Note: Washington Distribution Indicated By "X", Field Distribution By "#")

SECRET

-2-

25X1

4. An "L" shaped building which will house the State Security was under construction approximately 50 meters east of the railroad station. [redacted] 25X1
[redacted] in July 1952, the second floor was almost completed.
5. [redacted] "many workers" were employed in constructing a sewage system which links many parts of Dimitrovgrad. 25X1
6. [redacted] the State Construction Section in Dimitrovgrad employed about 2,500 laborers on various construction projects. [redacted] "political prisoners" were also used as laborers; however, it is not clear if the prisoners were included in [redacted] the total number of laborers. 25X1

Construction in Varna

7. [redacted] living quarters for workers and officials have been built in the Tolbukhin Quarter of Varna. [redacted] this was part of the Social Welfare program for the city [redacted]

Railroad Freight Car Factory in Varna

25X1

8. A railroad freight car factory is located in the Koralovag sector of Varna, which is approximately two kilometers southwest of the city center. [redacted]

25X1

SECRET

CENTRAL INTELLIGENCE AGENCY

INFORMATION REPORT

This Document contains information affecting the National Defense of the United States, within the meaning of Title 18, Sections 793 and 794, of the U.S. Code, as amended. Its transmission or revelation of its contents to or receipt by an unauthorized person is prohibited by law. The reproduction of this form is prohibited.

SECRET
SECURITY INFORMATION

25X1

COUNTRY	Bulgaria	REPORT	
SUBJECT	Miscellaneous Military Information from the Varna Area	DATE DISTR.	28 May 1953
DATE OF INFO.		NO. OF PAGES	3
PLACE ACQUIRED		REQUIREMENT NO.	RD
		REFERENCES	25X1

This is UNEVALUATED Information

THE SOURCE EVALUATIONS IN THIS REPORT ARE DEFINITIVE.
THE APPRAISAL OF CONTENT IS TENTATIVE.
(FOR KEY SEE REVERSE)

25X1

The Admiral Nakhimov Naval Academy in Varna

1. During the latter part of 1951, the Admiral Nakhimov Naval Academy was opened in Varna. The school program covered primary school, junior high school (pro-gimnaziya), and high school (gimnaziya) education as well as specialization in the following three major naval specialization branches:
 - a. Marine Branch, for training marine officers;
 - b. Line Branch, for training naval and merchant marine line officers; and

SECRET

STATE	ARMY	X	NAVY	X	AIR	X	FBI		AEC						
-------	------	---	------	---	-----	---	-----	--	-----	--	--	--	--	--	--

(Note: Washington Distribution Indicated By "X"; Field Distribution By "#".)

25 YEAR REVIEW

SECRET

- 2 -

25X1

- c. Technical Branch, for training Navy and Merchant Marine technicians; enrollment starts at the age of seven and the course lasts 12 years.
2. The Naval Academy in Varna occupies the following three buildings:
 - a. The former boys school building, used by primary school students (shown as Figure 8 on the sketch [redacted] included as an appendix on page 3);
 - b. The former German school building, shown as Figure 7 on the attached sketch, located at 21 Petko Karavelov Street; and
 - c. The old Naval School building, shown as Figure 6 on the attached sketch, used by the senior class.
3. The uniforms worn by the students are the same as those worn by the Bulgarian Navy enlisted personnel, with the exception of the lettering on the caps of the students, which read "Admiral Nakhimov Naval Academy." The students also wear a black rectangular strip with the Bulgarian letter "N", made of a yellow metal, on their shoulder straps.¹

25X1

The 8 Rifle Regiment

4. In 1951, the 8 Rifle Regiment was transferred from Varna to Dolni Chiflik (N 42-59, E 27-42). The barracks formerly occupied by 8 Rifle Regiment now house an unidentified Marine (Morska Pekhota) unit, which guards the Black Sea coast.

Airfields in the Varna Area

5. [redacted] a civilian airfield is located approximately 10 kilometers northeast of Varna, in the vicinity of Aksakovo village (N 43-15, E 27-48).²
6. A naval airfield is located 8-10 kilometers southwest of Varna, along the southern shore of Lake Varna. [redacted] three or four "Arado" class planes taking off daily from this field and flying over Varna and the Black Sea.³

25X1

25X1

Fortifications in the Varna Area

7. In 1951, Trudovak units constructed earthen trenches north of Varna, about 200-300 meters in from the coast line. These trenches, which are about 1.5 meters deep and 70-80 centimeters wide, extended as far as Point Ekrene (N 43-20, E 28-03), approximately midway between Varna and Balchik. In some places as many as three or four trenches paralleled each other. The trenches are constructed in a zig-zag line and include brick machine gun emplacements every 40-50 meters. No trenches were constructed at those points where the coast line was high above the water.
[redacted]
8. Earthen trenches of the same type as those described in Para. 7 above start at the Transpetrol storage tanks on the southern bank of the canal connecting the Black Sea and Lake Varna, and extend along the coast to Point Galata (N 43-10, E 22-57).
9. [redacted] in 1952 Trudovak units were constructing tunnels in the heights overlooking the Chayka Naval airfield, located along the southern shore of Lake Varna.
10. In 1952, the underground air raid shelters, built in Varna's Marine Park in 1943, were being enlarged, walls and ceilings were constructed of concrete, and electricity was installed by the State Construction Unit. The shelters are about 200 meters long, two meters wide, and two meters high. Above the shelter there is a natural rock-bed which is 15-20 meters thick. At present, 15-20 workers are employed in renovating this shelter.

25X1

25X1

Recall to Military Service

11. In the spring of 1952, some Bulgarians of the classes of 1922 to 1926, who had served in the Trudovaks, were recalled for a 2-3 month period of reserve military training. They were recalled for training in new Soviet weapons.

SECRET

CENTRAL INTELLIGENCE AGENCY

INFORMATION REPORT

This Document contains information affecting the National Defense of the United States, within the meaning of Title 18, Sections 793 and 794, of the U.S. Code, as amended. Its transmission or revelation of its contents to or receipt by an unauthorized person is prohibited by law. The reproduction of this form is prohibited.

SECRET
SECURITY INFORMATION

25X1

COUNTRY Bulgaria

REPORT

SUBJECT The Varna Prison

DATE DISTR. 15 June 1953

NO. OF PAGES 3

DATE OF INFO.

REQUIREMENT NO. RD 25X1

PLACE ACQUIRED

REFERENCES

This is UNEVALUATED Information

THE SOURCE EVALUATIONS IN THIS REPORT ARE DEFINITIVE.
THE APPRAISAL OF CONTENT IS TENTATIVE.
(FOR KEY SEE REVERSE)

25X1

1. [redacted] sketch of the Varna Prison which is contained on pages 2 and 3 of this report. The key is below.

2. [redacted] three members of the prison staff: Angel Tsonkov (nicknamed Chapaev), Director of the prison, [redacted]

Petūr (lmu), a guard, [redacted] and Ivan (lmu) also known as Bay Ivan, a guard [redacted]

Key:

- | | |
|---|---|
| 1. Main entrance. | 22. Cell for three prisoners. |
| 2. Militia stations. | 23. Guard room. |
| 3. Entrance. | 24. Single cells. |
| 4. Office of the Secretary of the Prison Director. | 25. Lavatory. |
| 5. Office of the Prison Director. | 26. Lavatory. |
| 6. Stairway. | 27. Barber shop. |
| 7. Prison office. | 28. Cells for twenty prisoners. |
| 8. Lavatory. | 29. Stairway. |
| 9. Prison office. | 30. Lavatory. |
| 10. Prison office. | 31. Entrance. |
| 11. Prison office. | 32. Cell for female prisoners and garden (dimensions and exact location of the cell not known). |
| 12. Prison office. | 33. Walk used by arrested prisoners who are still under investigation. |
| 13. Guard room. | 34. Walks used by the prisoners. |
| 14. Visiting room. | 35. Volley ball court. |
| 15. Room in which prisoners may meet their lawyers. | 36. Militia guard posts. |
| 16. Visiting room. | 37. Observation towers. |
| 17. Visiting room. | 38. Area in the prison courtyard in which a number of buildings are located [redacted] |
| 18. Entrance. | |
| 19. Entrance. | |
| 20. Guard post. | |
| 21. Cell for three prisoners. | |

SECRET

25X1

STATE	X	ARMY	X	NAVY	X	AIR	X	FBI		AEC									
-------	---	------	---	------	---	-----	---	-----	--	-----	--	--	--	--	--	--	--	--	--

(Note: Washington Distribution Indicated By "X"; Field Distribution By "#".)

25 YEAR

RE-REVI Sanitized Copy Approved for Release 2009/12/10 : CIA-RDP80-00810A001300130002-1

SECRET

The Varna Prison

-2-

25X1

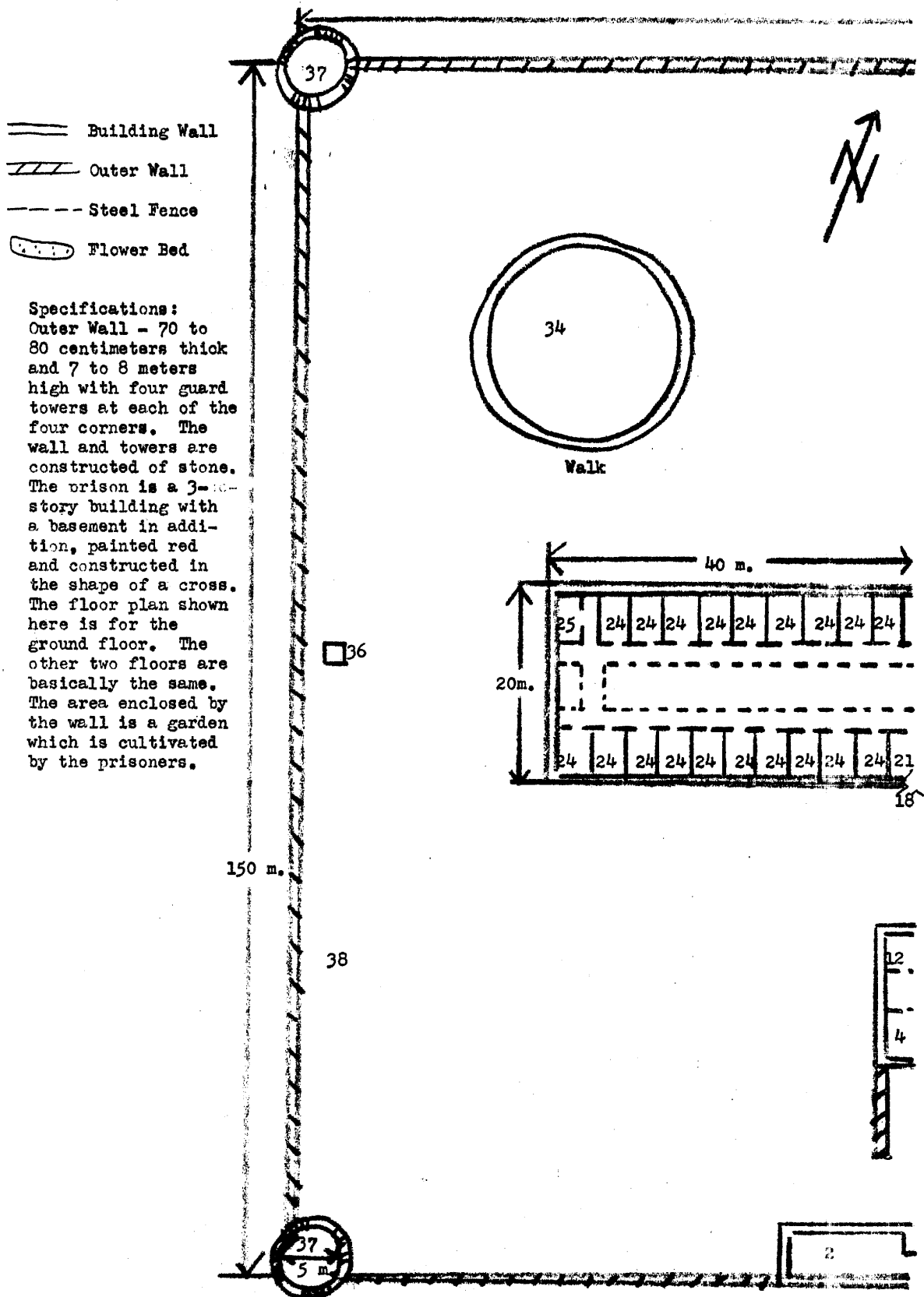

SECRET

The Varna Prison

-3-

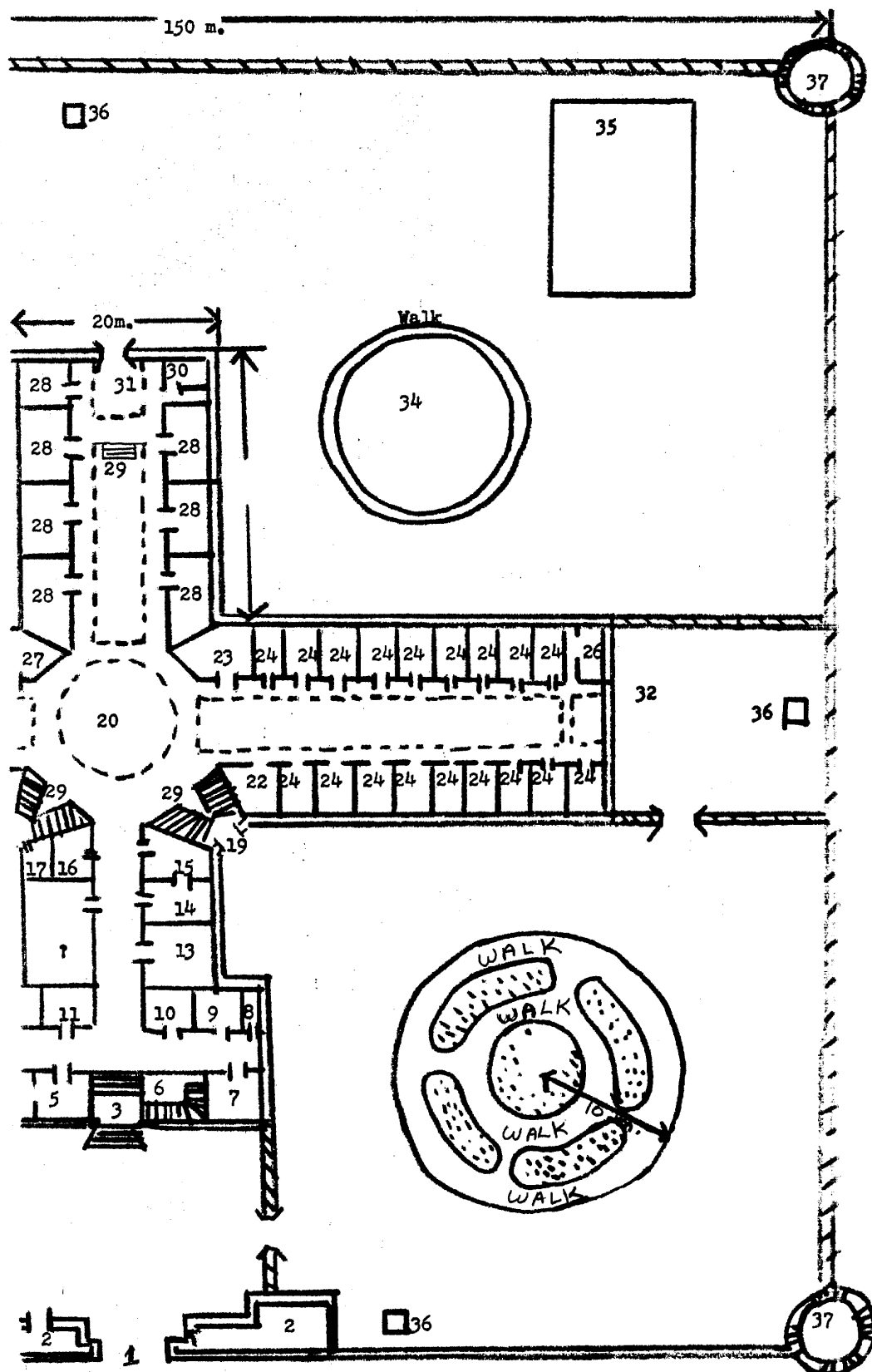

SECRET

CENTRAL INTELLIGENCE AGENCY

INFORMATION REPORT

This Document contains information affecting the National Defense of the United States, within the meaning of Title 18, Sections 793 and 794, of the U.S. Code, as amended. Its transmission or revelation of its contents to or receipt by an unauthorized person is prohibited by law. The reproduction of this form is prohibited.

SECRET
SECURITY INFORMATION

25X1

COUNTRY	Bulgaria	REPORT	
SUBJECT	The Belene Forced Labor Camp: Description and Sketch	DATE DISTR.	5 June 1953
DATE OF INFO.		NO. OF PAGES	5
PLACE ACQUIRED		REFERENCE NO.	RD
		REFERENCES	25X1

This is UNEVALUATED Information

THE SOURCE EVALUATIONS IN THIS REPORT ARE DEFINITIVE.
THE APPRAISAL OF CONTENT IS TENTATIVE.
(FOR KEY SEE REVERSE)

25X1

1. The Belene Forced Labor Camp is located partly on Persin and partly on Shturcheto Islands in the Danube River, in the immediate vicinity of the village of Belene, Svishtov Okoliya. A third island, Berezina¹, is also a part of the camp, although there are no buildings on it. Berezina Island is wooded and the camp inmates are used for felling its timber.

2. During the period June 1951-January 1952, an estimated 4,000 persons were held prisoners in the Belene Forced Labor Camp. Of these, about 400 were former officers. The following prominent persons were interned in the camp

25X1

- a. General (fnu) Kirilov, former Commanding General of the 11 Division² prior to 1944;
- b. (fnu) Khadzhi-Atanasov, an Agrarian Union (Petkov faction) Party deputy to the National Assembly representing Varna; and
- c. Georgi Mirkov, a well-known lawyer from Sofia.

3. The day was divided into the following periods:

- a. 3:00 a.m. - 4:00 a.m.: reveille and breakfast of bread and hot water;
- b. 4:00 a.m. - 12:00 noon: roll-call, assignment to work project, and work;
- c. 12:00 noon - 3:00 p.m.: noon meal and rest period;
- d. 3:00 p.m. - 6:00 p.m.: return to the work project (in winter);
- e. 6:00 p.m. - 7:00 p.m.: evening roll-call (in winter);

SECRET

STATE	X	ARMY	X	NAVY	X	AIR	X	FBI		AEC					
-------	---	------	---	------	---	-----	---	-----	--	-----	--	--	--	--	--

(Note: Washington Distribution Indicated By "X"; Field Distribution By "#".)

25 YEAR

RE-RE Sanitized Copy Approved for Release 2009/12/10 : CIA-RDP80-00810A001300130002-1

SECRET

25X1

-2-

- f. 3:00 p.m. - 9:00 p.m.: return to work project (in summer); and
- g. 9:00 p.m.: evening roll-call (in summer).

4. Every 10 to 15 days as well as whenever work was halted due to inclement weather, lectures on world politics and on Communism are given to the prisoners.

5. [redacted] the following persons were on the staff at the camp, [redacted]

25X1

- a. (fnu) Kitkov, Administrative Chief³;
- b. (fnu) Manasiev, in charge of the Supply Depot;
- c. Boris Angelov, in charge of the political education of the prisoners; and
- d. Senior First Lieutenant (fnu) Nikolov, Commanding Officer of the Camp's Guard Unit.

6. [redacted] at Belene, the various sections of the camp contained the following numbers of inmates:

25X1

- I - 2000
- II - 2000
- III - 600
- IV - 250
- V - 150 women

7. A freehand sketch of the Belene Forced Labor Camp, [redacted] is contained on pages 4 and 5 of this report.⁴ The key is as follows:

25X1

- 1. Four stations with observation towers of the Camp Guard Unit.
- 2. Four guard posts.
- 3. Headquarters of the Camp Guard Unit.
- 4. Belene Village.
- 5. Belene Village.
- 6. Pontoon bridge approximately 250 meters in length.
- 7. Causeway about 250 centimeters in elevation. Construction was begun in December 1951 [redacted]
- 8. Camp Post Office.
- 9. Machine shop and tractor repair shop.
- 10. Tailor shop.
- 11. Carpenter shop.
- 12. Camp Headquarters.
- 13. Mess Halls, Laundry rooms, and Washrooms.
- 14. Mess Halls, Laundry rooms, and Washrooms.
- 15. Dormitory.
- 16. Dormitory.
- 17. Dormitory.
- 18. Dormitory.
- 19. Dormitory for tubercular inmates.
- 20. Sawmill.
- 21. Food warehouse.
- 22. Food warehouse.
- 23. Warehouse for storing the civilian clothing of prisoners.
- 24. Chicken house.
- 25. Chicken house.
- 26. Cattle barn.
- 27. Cattle barn.
- 28. Chicken house.
- 29. Vegetable garden storeroom.
- 30. Dairy.
- 31. Dairy.
- 32. Dormitory.
- 33. Dormitory.

25X1

SECRET

SECRET

25X1

-3-

- 34. Pigpen holding about 2000 pigs.
- 35. Mill.
- 36. Corncrib for the corn which is used for feeding the pigs.
- 37. Dormitory for female prisoners.
- 38. Dairy.

 Swamp.

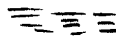

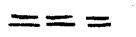

 Meadow.

 Wooded Area.

 Vegetable Garden.

 Levee under construction.

 Well.

1.  Comment: The Deutsche Heereskarte 1:100,000 map shows Berezina Island as belonging to Rumania and names the island "Insula Berezina Mare". However, inasmuch as the publication of this map is prior to the end of World War II, it is possible that the island was ceded to Bulgaria subsequent to the publication of the map. 25X1
2.  Comment: Probably the 11 Infantry Division is meant. 25X1
3.  Comment: Probably Major Nikola Kurtev, also known as Kitov, is meant.
4. 

SECRET

CONFIDENTIAL

25X1

Sketch of Belene Forced Labor Camp

-4-

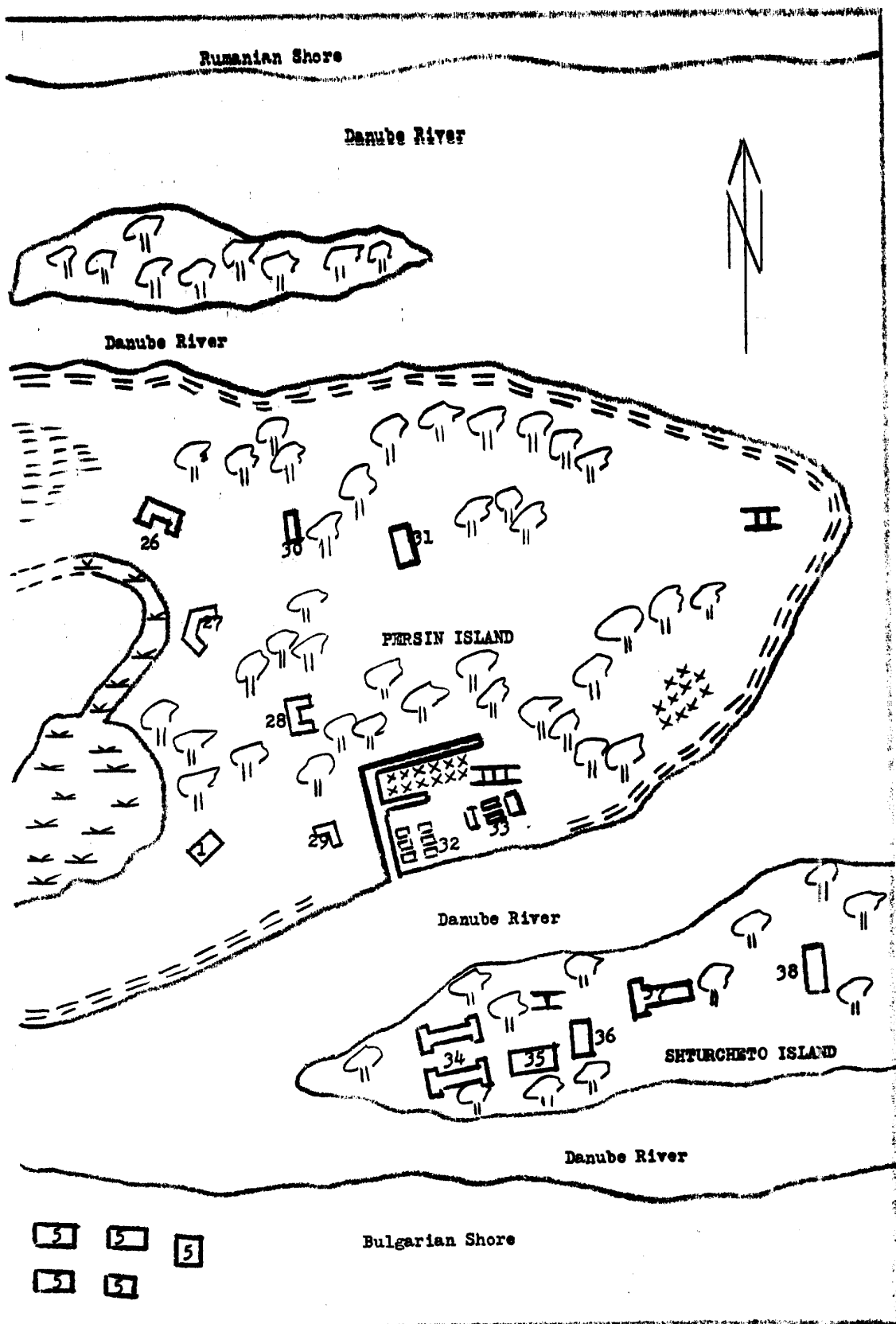

CONFIDENTIAL

CONFIDENTIAL

Sketch of Belene Forced Labor Camp

-5-

25X1

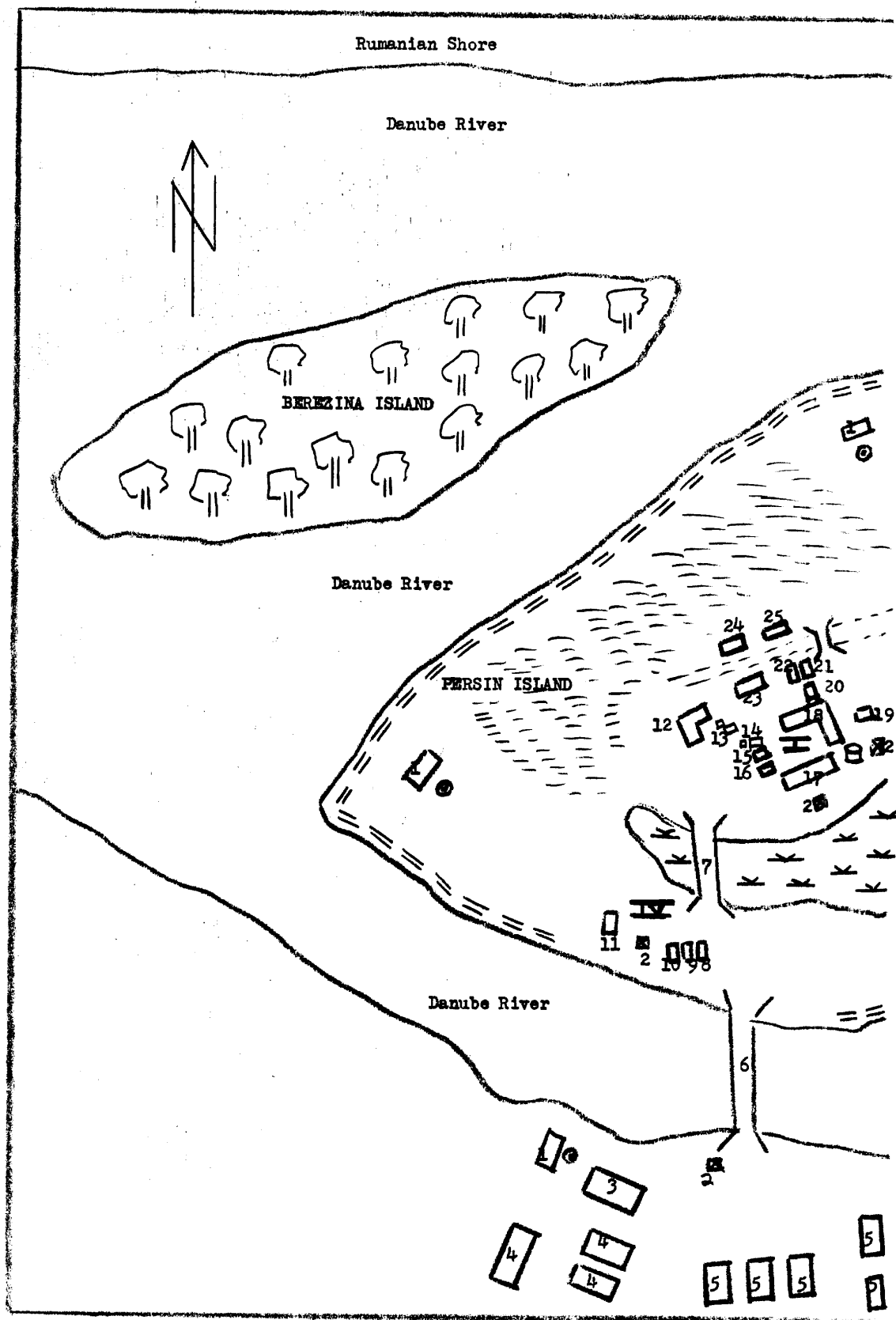

CONFIDENTIAL