

13

~~C-O-N-F-I-D-E-N-T-I-A-L~~

SEE BOTTOM OF PAGE FOR SPECIAL CONTROLS, IF ANY

INFORMATION REPORT

This material contains information affecting the National Defense of the United States within the meaning of the Espionage Laws, Title 18, U.S.C. Secs. 793 and 794, the transmission or revelation of which in any manner to an unauthorized person is prohibited by law. 25X1

PREPARED AND DISSEMINATED BY
CENTRAL INTELLIGENCE AGENCY

COUNTRY
Hungary ARMY review completed.

SUBJECT
Information Concerning AVH Personnel and Installations
USAF review completed.

DATE DISTRIBUTED
21 FEB 1957

NO. OF PAGES
10

NO. OF ENCLS.

SUPPLEMENT TO REPORT # 25X1

25X1

THIS IS UNEVALUATED INFORMATION

This report was prepared as the result of a joint collection effort by the Army, Air Force and CIA and is disseminated in accordance with NSCID #7.

25X1

~~C-O-N-F-I-D-E-N-T-I-A-L~~

DISTRIBUTION STATE ARMY NAVY AIR

C-O-N-F-I-D-E-N-T-I-A-L

25X1

-2-



25X1



Personnel and Organization of the AVH at Tatabanya

25X1

4. Lieutenant Colonel Laszlo Toth (an AVH Lieutenant Colonel) was the commander of the Komarom District AVH, located at Ujvaros, Tatabanya, Hungary.

his title was Commander of the Komarom District Main Section of the AVH.

25X1

25X1

25X1

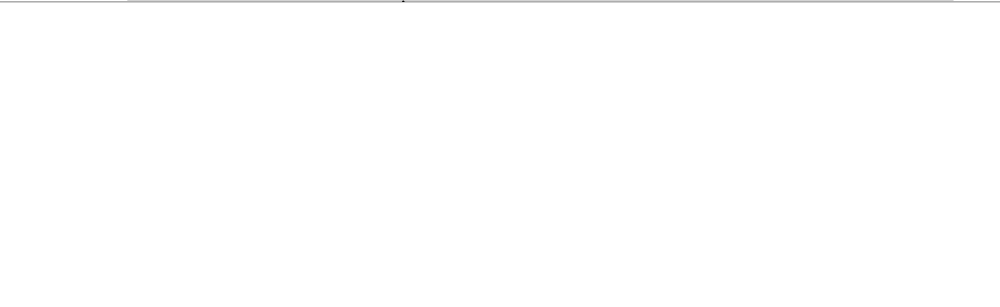

5. Captain (an AVH Captain) Toth is the head of the AVH investigative section at Tatabanya.

He is to be distinguished from Laszlo Toth above.

25X1

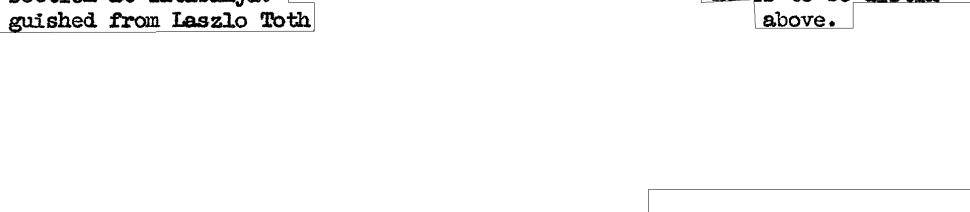

C-O-N-F-I-D-E-N-T-I-A-L

C-O-N-F-I-D-E-N-T-I-A-L

-3-

[Redacted]

25X1

[Redacted]

25X1

6. Captain Valvi worked at the AVH offices at Tatabanya [Redacted]

25X1

[Redacted]

25X1

7. Istvan Somodi was an AVH investigator in the AVH office at Tatabanya. His rank [Redacted] was that of AVH officer's candidate ("aspirant" or "enseigne"). [Redacted]

25X1

25X1

[Redacted]

25X1

8.

9. The following individuals were AVH agents in Tatabanya and Egercsehi when and where as indicated below.

a. Michael Szeplaki. This individual was the Secretary of the Communist Party in Tatabanya and was known to be connected with the AVH. [Redacted]

[Redacted]

25X1

b. Julius Gal. Gal was the manager of the coal mine [Redacted] in Egercsehi and was also a member of the AVH. [Redacted]

c. Major Csillag. This AVH major ostensibly resigned from the AVH in 1950 and went to work in a cement plant in Tatabanya as an office worker. [Redacted]

25X1

d. Janos Asztalos. Asztalos worked for about six months as a miner [Redacted]

25X1

C-O-N-F-I-D-E-N-T-I-A-L

C-O-N-F-I-D-E-N-T-I-A-L

-4-

25X1

- e. Michael Balazs. This individual was an AVH captain who acted as the Director of the cement plant where Csillag worked. The 1956 revolutionaries threw Balazs out of his job, but the Soviets reinstated him.

10.

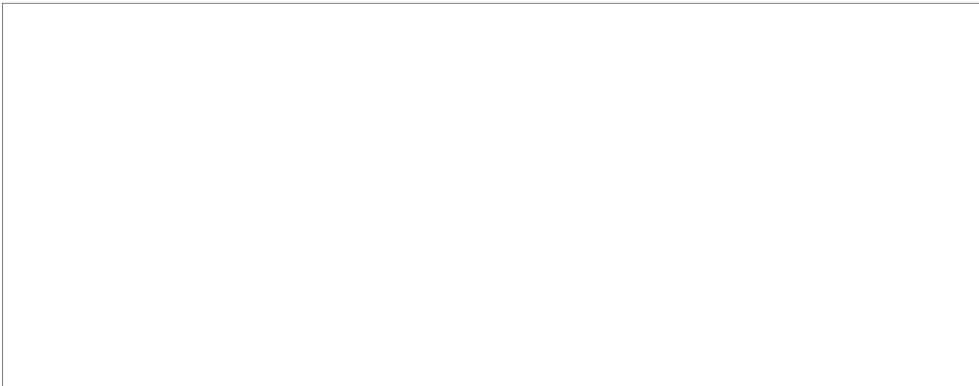

25X1

11. The AVH at Tatabanya, which ran AVH affairs in the Komarom District, was divided into two parts, the investigative section and the security forces section.
12. The investigative section of the Tatabanya AVH was located in a building in Tatabanya, Ujvaros.

25X1

the investigative section employed about 60 individuals on a full-time basis.

Most of these individuals wore uniforms. of these 60 individuals about 15 or 20 were women.

25X1

13. The security forces section of the Tatabanya AVH was quartered in barracks located at Alsogalla. This security forces section consisted of one battalion. the strength, equipment, and organization of this battalion were identical to the strength, equipment, and organization of regular army battalions.

25X1

25X1

The AVH battalion at Alsogalla was like all AVH security forces battalions in strength, equipment, and organization.

25X1

a. Estimate of organizational strength.

1. Staff of the Battalion Commander. Total: 16-18 men.
 - a. Commanding Officer
 - b. Political Deputy to the Commander
 - c. Adjutant (Group Commander)
 - d. Supply Officer
 - e. Armorer
 - f. Clerks, Messengers, Drivers.
2. Three Motorized Infantry companies. Each company has three platoons. Each platoon consists of 42 men, including the commander. Each company has about 126 men, therefore, not including the Master Sergeant, Clerk, and Messengers.

C-O-N-F-I-D-E-N-T-I-A-L

C-O-N-F-I-D-E-N-T-I-A-L

-5-



25X1

- 3. One Machine Gun Company. This company consists of about 80 men, organized into 12 squads. In addition, this company has two ammunition wagons with drivers. These individuals are not included in the figure of 80  given above.

25X1

b. The battalion is armed with weapons as indicated.



- 1. Staff of the Battalion Commander.

- a. The Commanding Officer, the Political Deputy, the Adjutant, the Supply Officer, and the Armorer all carry a 7.62 mm Soviet-type automatic pistol. This weapon carries six bullets in the magazine and one in the chamber.

- b. The clerks, messengers, and drivers all carry a 7.62 mm Soviet-type machine pistol, with either a drum type magazine (32 capacity) or 32-bullet capacity magazine in the handle. The latter type has come into common use since about 1951. The drum type is not a good weapon, but the newer type is good.

- c. In addition to the weapons  all of the foregoing carry two hand grenades each.

25X1

- 2. Two of the three Infantry Companies are provided with the old type Soviet long-barrelled (Mauser) rifle known as the Tokarev. The third company is armed with the machine pistol  described above. Each of the two companies armed with the Tokarev also has one light machine gun (7.62 mm Soviet issue). The squad leaders of the infantry companies are armed with the machine pistols  described above.

25X1

25X1

- 3. The Machine Gun Company is provided with 12 light machine guns (7.62mm Soviet issue) and is organized into three platoons. There are four light machine guns per platoon and one light machine gun per squad. The first three members of each machine gun crew carry an automatic pistol  described above. The rest carry the Tokarev.

25X1

Each Machine Gun squad is organized as follows: one squad leader; one machine gunner; one machine gun handler; three ammunition carriers. One ammunition carrier is responsible for water for the gun. The gun is mounted on small wheels and has a piece of armor plate for the protection of the crew. If the gun is taken apart the machine gunner carries nothing, the handler carries the gun, the "Number One" ammunition carrier carries the chassis, and the other two ammunition carriers carry the armor plate.

14.

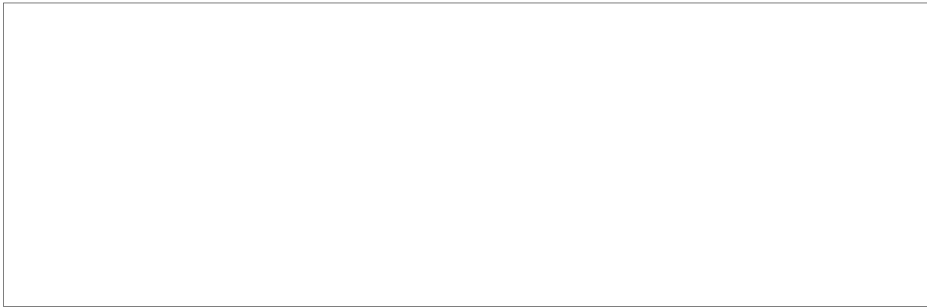

25X1

C-O-N-F-I-D-E-N-T-I-A-L

Page Denied

Next 1 Page(s) In Document Denied

C-O-N-F-I-D-E-N-T-I-A-L

-8-

25X1

25X1

General Description of the AVH Concentration Camp at Kistarcsa, Hungary

19. The AVH concentration camp at Kistarcsa, Hungary, is located very close to the interurban rapid transit line which runs between Budapest and G8doll8. More specifically, it is situated between the Sashalom and Kistarcsa stations on this line. The camp's main gate lies about 600 meters generally southeast of the Kistarcsa station. A street about 20 meters wide separates the village of Kistarcsa from the camp's East wall. There is no sidewalk on the side of this street which borders the camp wall. There is a sidewalk on the East side of the street. No one is permitted to step off this sidewalk. The camp is rectangular in shape and is about 300 meters wide (north to south) and 400 meters long (east to west). [redacted] attached sketch plan (not to scale)

[redacted] attached sketch (not to scale) of a typical watchtower. The sketch of the camp is marked "10" on its top. The sketch of the watchtower is marked "11" on its top.

20. Each of the watchtowers marked on the sketch was connected with the camp's command post by a bell alarm system and a telephone. One man was permanently stationed in each tower. When the prisoners were out for their exercise, however, one additional man was stationed in each tower. At such times the removable portions of the glass in each tower were removed and the submachine guns were trained on the prisoners through the openings. The guards who manned the towers were not permitted to enter the compound, but gained access to the towers by stairs leading to said towers from the outside only. These guards were components of a special AVH guard force called the "Armed Forces Police Force". These guards were relieved every two hours. [redacted] the guards were changed at 1300 hours and again at 1500 hours daily

[redacted] they had the same tour that the Hungarian army guards would have, namely, two hours on guard followed by four hours off. The tower marked (*) on the sketch was not manned unless there were prisoners working in the garden. Thus, seven towers were constantly manned, one tower irregularly manned. In addition to the tower guards

C-O-N-F-I-D-E-N-T-I-A-L

C-O-N-F-I-D-E-N-T-I-A-L

-9-

25X1

there were nine guards who took up stations between the buildings marked 1, 2, and 3 on the sketch during the prisoners' exercise periods. These guards were constantly changed

25X1

they were AVH officer candidates. Finally, each of the buildings marked 1, 2, and 3 on the sketch had two guards who kept watch over it.

25X1

25X1

25X1

21. The buildings marked 1, 2, and 3 on the attached sketch plan of the Kistarcsa AVH camp were all made of brick and were three stories high. Each of these three buildings was able to accommodate from 160 to 200 prisoners each. each of these buildings was watched over by two AVH guards, in addition to those guards who stayed in the spaces between the buildings and those who would take up their positions in the yard at the times at which the prisoners took their exercise.
22. The building marked 4 on the sketch plan of the camp was separated from the rest of the compound by a permanent wall, in which was set a small, steel door. New prisoner arrivals entered the camp by the gate marked 14 on the sketch plan and remained in the building marked 4 for periods ranging from one to three months. At the conclusion of this time the prisoner was either transferred to one of the buildings marked 1, 2, or 3 on the sketch plan or else was sent out of Kistarcsa altogether. The almost invariable destination in the latter case was either Recsk, or Tatabanya, or Inota, or Tiszalok. If the prisoner was sent to one of these localities he then performed forced labor in the power plant construction sites at Inota or Tiszalok or else at the silver and lead mine at Recsk, or else at the coalmine at Tatabanya. The building marked 4 on the sketch plan had a capacity of from 150 to 160 prisoners, but, of course, was not always full. The number of prisoners staying there depended on the numbers of new arrivals and also upon the demands of the forced-labor installations which I have listed above.
23. The following items will explain the remaining numbers indicated on the attached sketch plan of the AVH concentration camp at Kistarcsa.
5. Interrogation and Investigation Building.
 6. Solitary Confinement Cells.
 7. Garage.
 8. Billets for Married AVH officers,
 9. Command Headquarters and Offices.
 10. Main Entrance to the Camp. Each figure 10 indicates a double iron gate, wide enough to admit automobiles.
 11. AVH Guards' quarters.
 12. Prisoners' Exercise Area.
 13. Camp Hospital. The water reservoir for the camp was on the roof of this building
 14. Gate through which new prisoners arrived in the camp.

25X1

C-O-N-F-I-D-E-N-T-I-A-L

C-O-N-F-I-D-E-N-T-I-A-L

-10-



25X1

15. Building in which female prisoners were housed. Although on sketch plan this building appears considerably smaller than do the buildings marked 1, 2, and 3, in reality this building in which female prisoners were housed was of the same dimensions and capacity as were the other three. This building was separated from the remainder of the compound by a wall and had its own separate courtyard. There was strict segregation of male from female prisoners.

25X1



-end-

C-O-N-F-I-D-E-N-T-I-A-L

Approved For Release 2008/07/15 : CIA-RDP80T00246A000600730001-4

Page Denied

Next 1 Page(s) In Document Denied

AVH Camp -

WATCHTOWERS - 3 meters square.

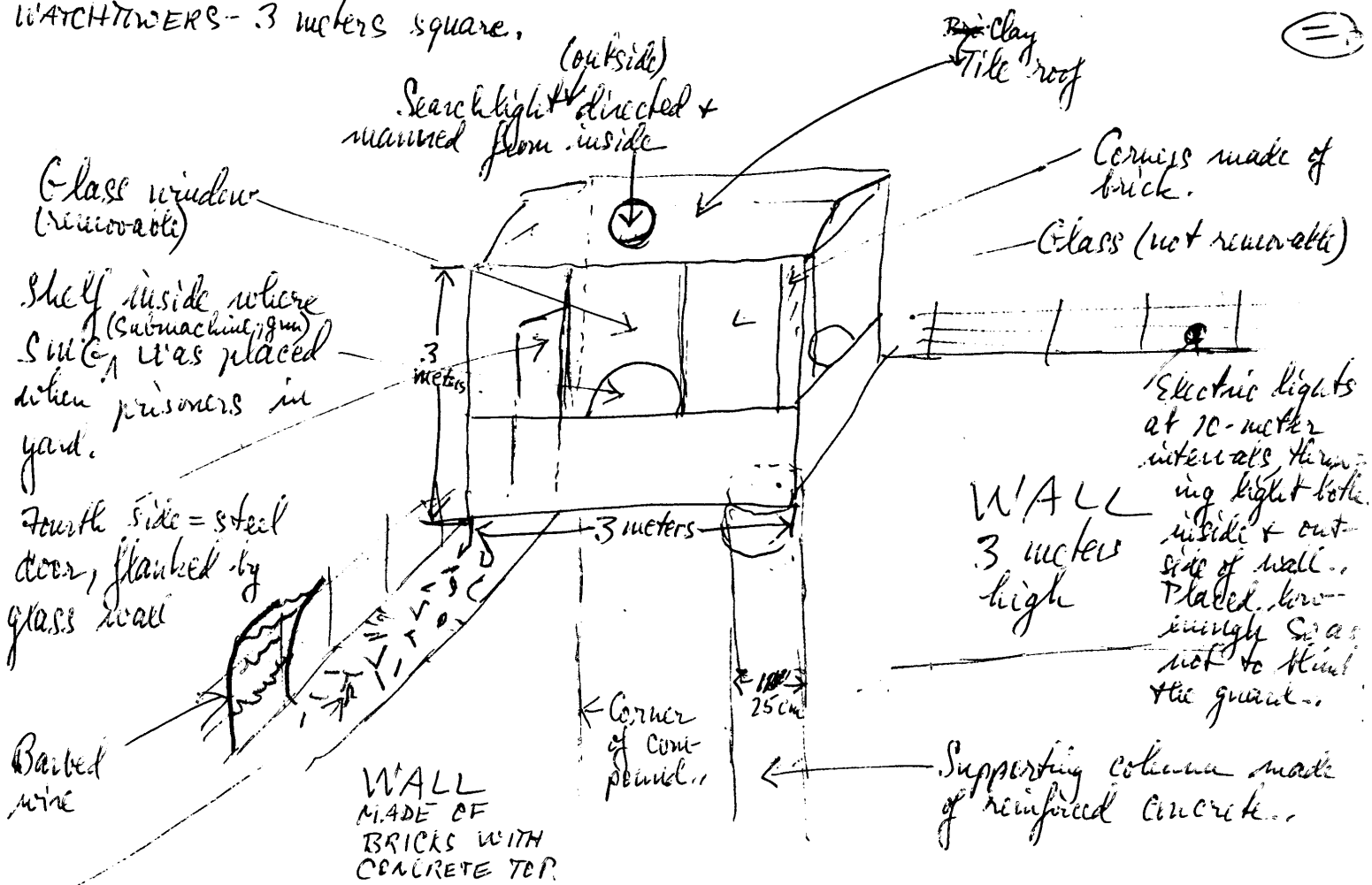

Steel ladder on outside of wall gives access to tower. No access to the towers from inside of wall.

