

# FORMATION REPORT INFORMATION REPORT

## CENTRAL INTELLIGENCE AGENCY

This material contains information affecting the National Defense of the United States within the meaning of the Espionage Laws, Title 18, U.S.C. Secs. 793 and 794, the transmission or revelation of which in any manner to an unauthorized person is prohibited by law.

SECRET

25X1

COUNTRY Hungary

REPORT

SUBJECT Pre-revolutionary Order of  
Battle Information

DATE DISTR. 11 February 1957

NO. PAGES 1

REQUIREMENT  
NO. RD

DATE OF  
INFO.

REFERENCES

25X1

PLACE &  
DATE ACQ.

25X1

SOURCE EVALUATIONS ARE DEFINITIVE. APPRAISAL OF CONTENT IS TENTATIVE

report

on pre-revolutionary Hungarian Order of Battle.

ARMY review  
completed.

SECRET

25X1

STATE	#X	ARMY	#X	NAVY	X	AIR	#X	FBI		AEC							
(Note: Washington distribution indicated by "X"; Field distribution by "#".)																	

25X1

**Page Denied**

SECRET

2

25X1

## HUNGARIAN ARMY ORDER OF BATTLE INFORMATION

Unit Designation	Subordination	Location	CO and Remarks
U/i Hungarian Army Installation	Unk	Unk TATA (N47-39, E18-19)	CO was Lt Col BARABAS, (fnu), Armor. This was allegedly a caserne for a Hungarian Armored OCS (?) and an unidentified Guard (?) unit of about 80 officers and EM.
[redacted] an unidentified Hungarian Reserve Armored Training unit group [redacted]			This installation appeared to be newly built. While here, members of [redacted] battalion received theoretical training near SZOMOD (see Annex B) with T-34 tanks and also took part in firing exercises during each of which the T-34 tanks fired four blank shells. [redacted] the training was very ineffective [redacted] (For pinpoint location and description, see Annex A.)
U/i Reserve Armored Training Bn (?) at the Summer Camp of the TATA Hungarian Armored OCS [redacted]	Unk	Unk In vicinity of TATA	CO was Maj TOPERCER, (fnu), Armor. [redacted] signed to an unidentified armored reserve training unit of battalion size and called by him a battalion. [redacted] The officers and RA NCO's were assigned here from other unknown units. [redacted] unit consisted of four companies, each having 120 officers and EM. Each company had four platoons with one junior lieutenant platoon leader and 30 EM trainees. The enlisted members of this battalion were armed with Soviet SMG's 7.62 mm PPSH-1941 or Soviet carbines 7.62 mm Mossin-Nagant 1944. The officers were armed with unidentified Soviet made pistols. [redacted] 15 GMC trucks and about 10 [redacted] jeeps which were organic to this battalion. The battalion had about eight T-34 and three JS-1 Soviet tanks. [redacted] four unknown type of small old SP guns of Soviet make and two outmoded unknown type of small SP guns, caliber unknown, allegedly of Hungarian make. [redacted] all weapons and equipment found at this battalion were on loan from an unknown Hungarian unit at TATA. The members of this battalion wore blue collar tabs with tank insignia. The whole unit was billeted in an unknown type of tents of 10 man capacity. One open movable WW II kitchen supplied the food to this unit and was located in the summer camp area. [redacted] training consisted of close order drills with or without weapons, dry firing runs and theory covering the SMG and the carbine. Armored training covered very generalized theoretical instruction pertaining to T-34 tank technical data. Training was poorly conducted and benefited the trainees little. 2. Upon completion of training, the men turned all equipment weapons and uniforms into the battalion section. Then they departed in their civilian clothing to BUDAPEST in several groups by rail transportation. [redacted] (For pinpoint location and description, see Annex C.)

SECRET

SECRET

3

25X1

Unit Designation	Subordination	Location	CO and Remarks
U/i Armored Reserve Unit at the Summer Camp TATA of the Hungarian Armored OCS	Unk	Unk	In vicinity of TATATO-VAROS CO was unk. [redacted] about 300 other EM (PFC's and Cpl's) were at [redacted] camp with an unidentified reserve training unit. Most of these men were of older year classes. [redacted] [redacted] these men served in the Hungarian Army during WW II. [redacted] members of this unit drilling with PPSH [redacted] This unit was also billeted in tents. [redacted] this installation would eventually become the site of an armored OCS [redacted] [redacted] training and the training of two other similar reserve groups took place at a tent camp about two kilometers away, referred to as the summer camp of the OCS. [redacted]
U/i Reserve Medical Service Co (?) at the Summer Camp of the TATA Hungarian Armored OCS	Unk	Unk	In vicinity of TATATO-VAROS CO was an unidentified male lieutenant, Medical branch. [redacted] [redacted] this unit to be a company consisting of approximately 100 female [redacted] [redacted] This company was in [redacted] unit's vicinity for the same duration as his unit was. [redacted]
[redacted] members of this company were also billeted in tents were, however, in a separated corner of the summer camp. This tent area was surrounded by a barbed wire fence and was guarded at all times by Hungarian Army male sentries. [redacted]			

25X1

SECRET

25X1

**Page Denied**

SECRET

5



25X1

Annex A

Pinpoint Location of the Caserne of the Hungarian  
Armored OCS at TATA (N47-39, E18-19)

(Pinpoints below expressed in UTM Grid Coordinates)

Map Ref:

Hungary  
1:50,000  
FELSOGALLA  
Sheet No 4961 W  
AMS Series M773

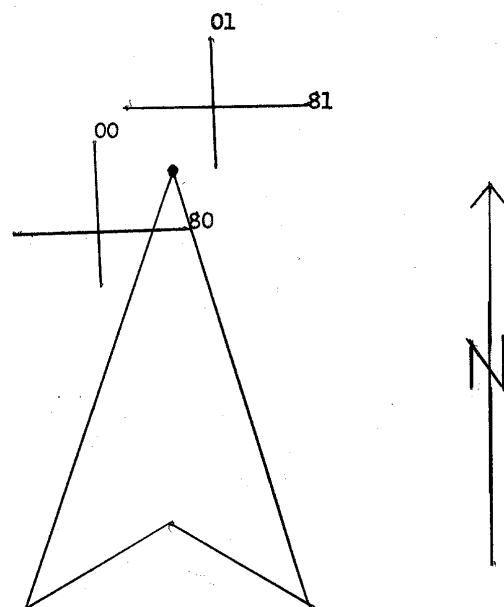

25X1

SECRET

SECRET

6

25X1

Annex A-1

Sketch of the Caserne of the Hungarian Armored OCS at TATA (N47-39,E18-19)

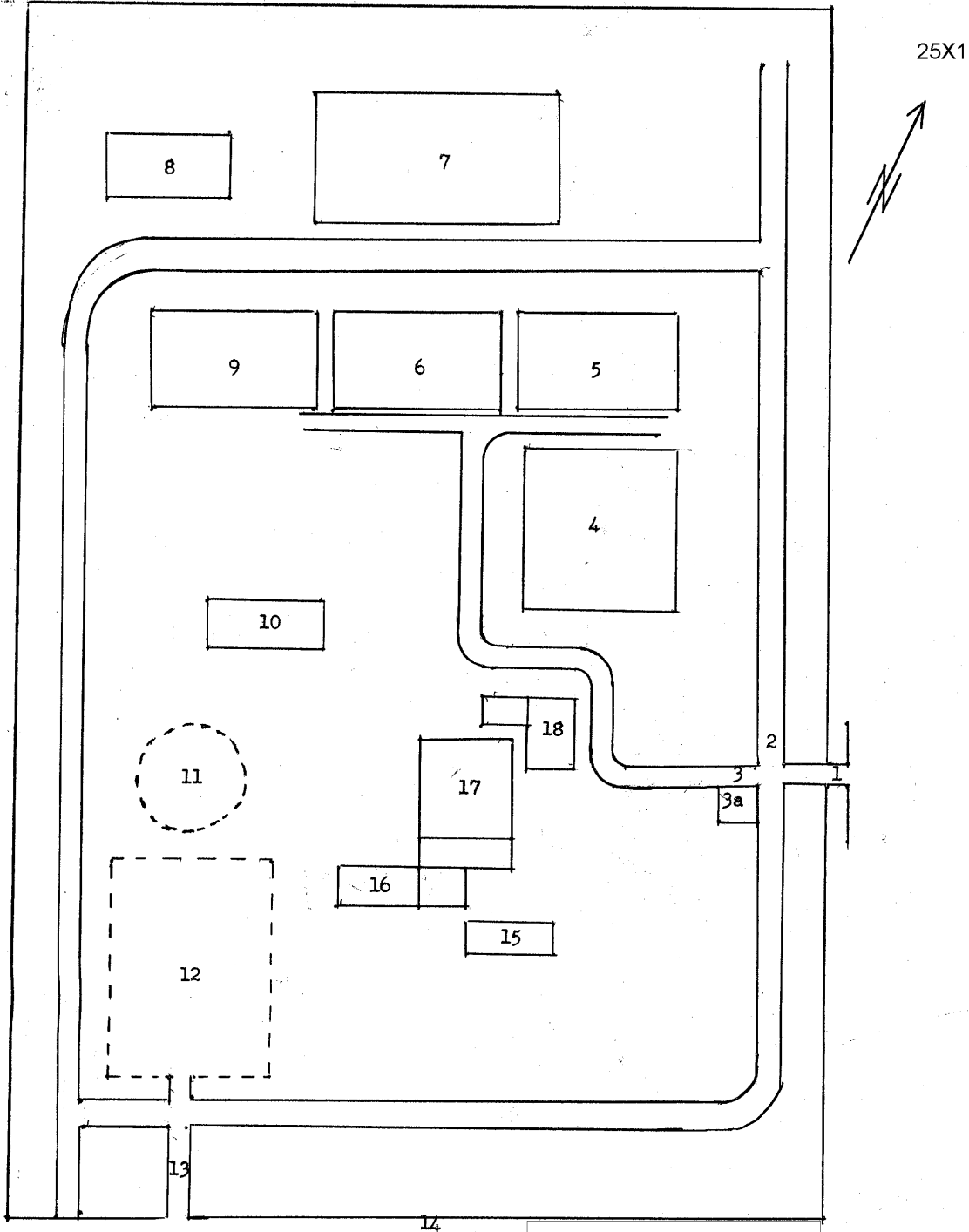

SECRET

SECRET

7

Annex A-1

25X1

LEGEND:

1. The main entrance for pedestrians and vehicles. An 8 m wide, 1.5 m high iron gate.
2. A 4 to 5 m wide gravel road for vehicles and pedestrians.
3. An 8 m wide gravel road for vehicles and pedestrians.
- 3a. A 1-story gray brick building, approximately 4 m x 4 m, with a peaked roof. It served as the guard room.
4. A 3-story cream brick building, approximately 40 m x 15 m, with a light-colored peaked tile roof. 25X1  
 the main headquarters and administrative building of this installation. 25X1
- 5., 6., 9. Three 3-story high gray concrete buildings, approximately 60 x 20 m, with gray flat roofs.  these buildings were used as billeting space for EM. 25X1
7. Grounds for formations, drill, and PT, approximately 100 m x 80 m.
8. A rifle range with grass and clay ground, approximately 100 m x 200 m.
10. A 1-story gray brick building, approximately 20 m x 8 m wide and 8 m high, with a gray flat roof. It housed an unidentified number of showers.
11. Unidentified circular structure, with a 15 m diameter which served as a fuel supply room.
12. A parking space, approximately 80 m x 80 m, for tanks and vehicles.
13. An 8 m wide wooden frame, wire gate. It served as an entrance and exit for vehicles and tanks.
14. A 1.5 m high barbed wire fence, which surrounded the installation on all four sides.
15. The officers' mess. A 1-story gray brick building, approximately 20 m x 8 m.
16. A warehouse for food. A 1-story gray brick building, approximately 15 m x 30 m, 6 m to 8 m high, with a gray peaked roof.
17. The kitchen and messhall for EM. A 1-story gray brick building, approximately 15 m x 30 m, 8 m to 10 m high, with a gray flat roof.
18. A 1-story brick building, approximately 8 m x 8 m, 6 m high, with a peaked roof. It served as the guardhouse and stockade.

SECRET



SECRET

8

25X1

Annex B

Pinpoint Location of Unidentified Hungarian Armor Firing

Range in the Vicinity of SZOMOD (N47-40,E18-20)

Map Ref:

Hungary  
1:50,000  
TATA  
Sheet No 4960 E  
AMS Series M773

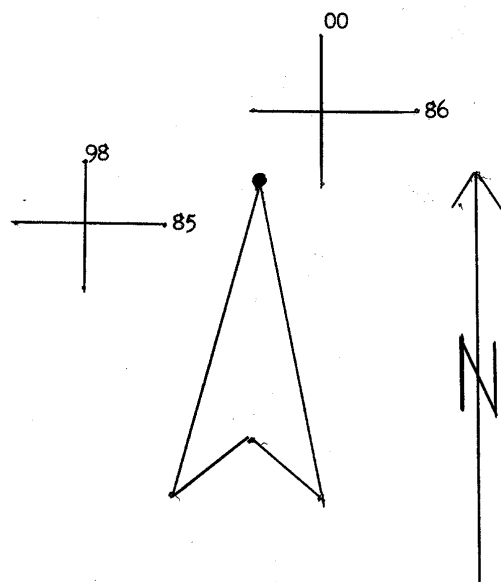

25X1

SECRET

SECRET

9

25X1

Annex C

Pinpoint Location of the Summer Camp of the TATA Hungarian Armored OCS  
(Pinpoints below expressed in UTM Grid Coordinates)

Map Ref:

Hungary  
1:50,000  
TATA  
Sheet No 4960 E  
AMS Series M773

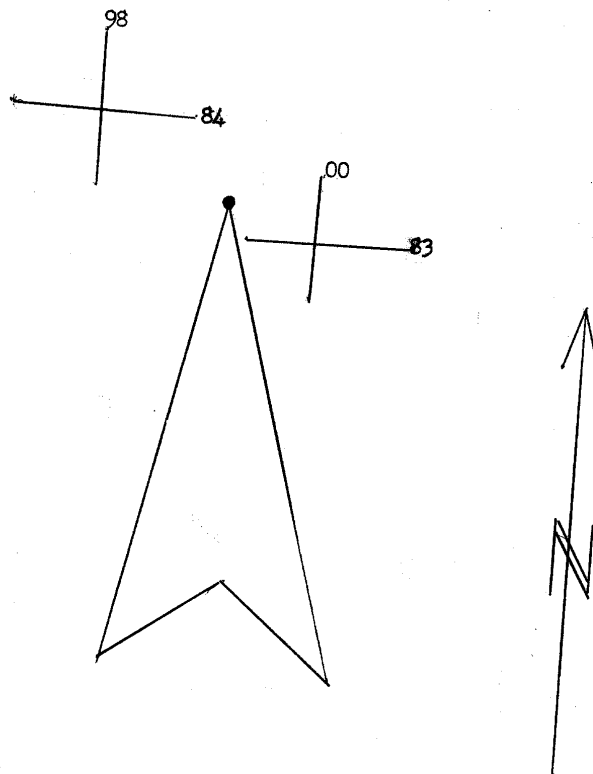

25X1

SECRET

SECRET

10



25X1

Annex C-1



Sketch of the Summer Camp of the TATA Hungarian Armored OCS  
in the Vicinity of TATATÓVÁROS

25X1

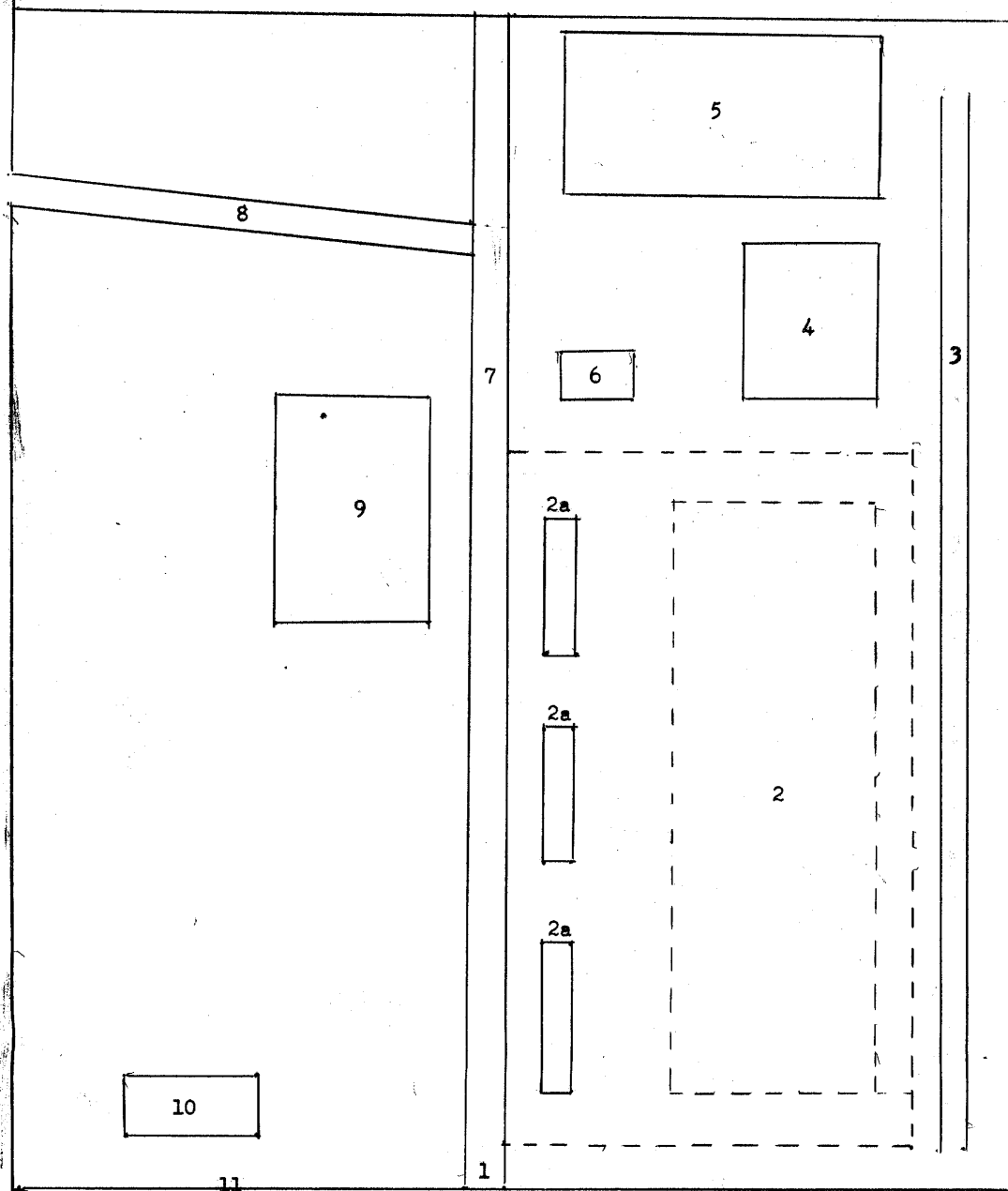

25X1



SECRET

SECRET

11

Annex C-1



25X1

LEGEND:

1. The main entrance for vehicles and pedestrians. A 6 m wide, 1.5 m high wooden frame wire gate.
2. The area in which 160 to 180 10-man tents were pitched.
- 2a. Washing places, concrete blocks, approximately 10 m x 3 m, with about 20 waterfaucets.
3. An 8 m wide unused dirt road.
4. A mechanics shop. A 1-story gray brick building, approximately 20 m x 8 m, with a gray flat roof.
5. A parking area, approximately 50 x 40 m, for tanks and vehicles.
6. A 1-room gas chamber. A 1-story brick building, approximately 5 m x 5 m, with a red flat roof.
7. A 6 m wide dirt road for pedestrians and vehicles.
8. A 3 m wide dirt road for pedestrians.
9. An open-air structure consisting of a 40 m x 20 m tile roof resting on wooden blocks. It was approximately 8 m high. This structure was used as a messhall.
10. An 8 m x 3 m brick building without a roof. It served as the latrine.
11. A 2 m high wire fence with a concrete foundation.

SECRET

25X1

**Page Denied**