

PROCESSING COPY

OCR

INFORMATION REPORT INFORMATION REPORT

CENTRAL INTELLIGENCE AGENCY

This material contains information affecting the National Defense of the United States within the meaning of the Espionage Laws, Title 18, U.S.C. Secs. 793 and 794, the transmission or revelation of which in any manner to an unauthorized person is prohibited by law.

SECRET

25X1

COUNTRY Hungary

REPORT

SUBJECT

Combine near Pétfürdő *Refinery operation*

Peti Chemical

DATE DISTR.

30 APR 1957

25X1

NO. PAGES

1

REQUIREMENT NO.

RD

DATE OF INFO.

REFERENCES

25X1

PLACE & DATE ACQ.

25X1

SOURCE EVALUATIONS ARE DEFINITIVE APPRAISAL OF CONTENT IS TENTATIVE

report on the Pet. chemical combine, situated near Pétfürdő (47-09 N; 18-07 E). The report contains information on the layout (sketch) and the working process of the plant.

25X1

116

SECRET

25X1

STATE	X	ARMY	X	NAVY	X	AIR	X	FBI		AEC				
(Note: Washington distribution indicated by "X"; Field distribution by "#")														

INFORMATION REPORT INFORMATION REPORT

25X1

SECRET

25X1

SECRET

HUNGARY

Economic

PETI CHEMICAL COMBINE, Near MEIFURDO.

1. This combine utilizes the oil from the NAGY LINGYEL Field. Its object is to obtain high grade fuels from Hungarian oil. The oil has four volatiles and Bitumen content of 14%, sulphur 3%.
2. The crude oil from NAGY LINGYEL is taken into the Pilot Plant. A carbon powder impregnated with a ferrous compound is used on the oil in the fluid phase with a suspended catalyst. H₂ gas is added at a temperature of 400° C. at a pressure of 100 atmospheres. The substance then passes to reactor, separator and cooling towers. The catalyst and asphaltenes are eliminated. The residue passes to a Hydrodesulphurization reactor with hydrogen over a catalyst bed at 70 atmospheres and 350° C. The next step would be the catalytic cracking into higher fractions. This has not yet been done practically, and therefore no information on the eventual capacity of the plant could be given.
3. A plan of the layout of this combine is attached.

SECRET

25X1

SECRET

SECRET

Attachment to report

PETI CHEMICAL COMBINE near PETFURDO

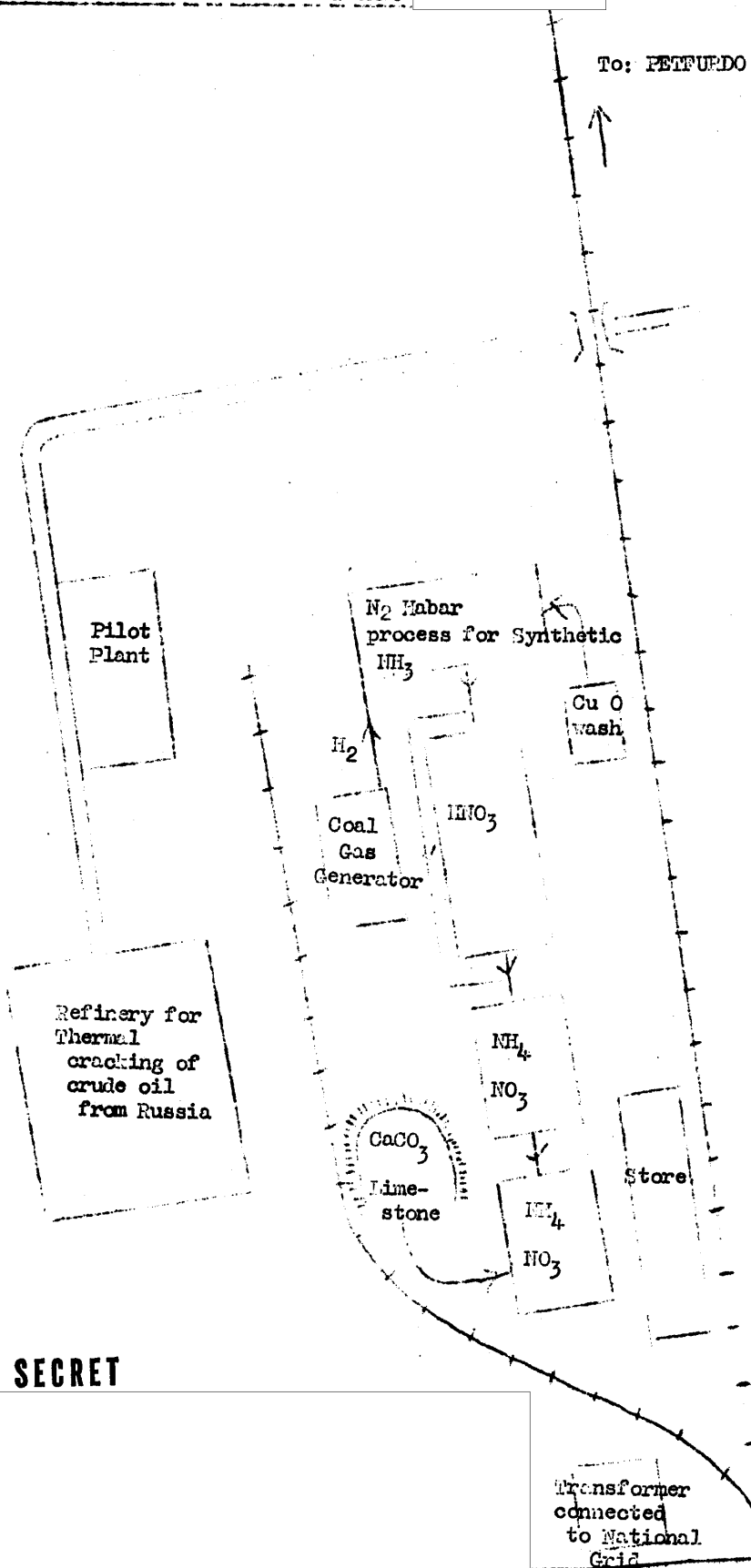

To: PETFURDO

Pilot Plant

Refinery for Thermal cracking of crude oil from Russia

N₂ Habar process for Synthetic NH₃

Cu O wash

H₂

Coal Gas Generator

HNO₃

NH₄

NO₃

CaCO₃

Lime-stone

NH₄

NO₃

Store

Transformer connected to National Grid

SECRET