

Sanitized Copy Approved for Release 2011/04/12 : CIA-RDP80T00246A057500370001-3

50X1-HUM

Sanitized Copy Approved for Release 2011/04/12 : CIA-RDP80T00246A057500370001-3

U 1290-36 (W)

INFORMATION REPORT INFORMATION REPORT

CENTRAL INTELLIGENCE AGENCY

This material contains information affecting the National Defense of the United States within the meaning of the Espionage Laws, Title 18, U.S.C. Secs. 793 and 794, the transmission or revelation of which in any manner to an unauthorized person is prohibited by law.

C-O-N-F-I-D-E-N-T-I-A-L

50X1-HUM

COUNTRY USSR

REPORT

SUBJECT Industrial, Military, and Town Information on Chelyabinsk, Lyublino, and Ryazan

DATE DISTR. 30 January 1961

NO. PAGES 1

Tractor factory in Chelyabinsk (frag. factory info); unscaled street plan of city of Lyublino; restricted area wood plant; Oyatovo Airfield; Artillery Training school; agricultural machinery plant; highways in area.

REFERENCES

50X1-HUM

DATE OF INFO.

PLACE & DATE ACQ.

50X1-HUM

THIS IS UNEVALUATED INFORMATION. SOURCE GRADINGS ARE DEFINITIVE. APPRAISAL OF CONTENT IS TENTATIVE.

reports on Chelyabinsk, Lyublino, and Ryazan

- a. Chelyabinsk (two pages). A few details on the Tank and Tractor Plant i/n Stalin are included.
- b. Lyublino (three pages and sketch). Town plan locating 42 points, including streets and minor installations.
- c. Ryazan (three pages and sketch). Information included, ~~and~~ wood plant producing veneer, aluminum household goods, and special, high-precision pieces. The plant was guarded, and workers were required to have documentation. There is also some town information.
- d. Ryazan (four pages and sketches). Town plan locating 34 points, including streets, military installations, and a new machine tool plant seven km northwest of the city. There is a sketch of military installations.
- e. Ryazan (six pages and sketches). Town plan locating 60 points, including military installations and industrial plants. Details on transportation and sketches of military insignia are also contained in the report.

50X1-HUM

50X1-HUM

C-O-N-F-I-D-E-N-T-I-A-L

STATE	X	ARMY	X	NAVY	X	AIR	15	NSA	X	OCR	X	NIC	X
-------	---	------	---	------	---	-----	----	-----	---	-----	---	-----	---

(Note: Washington distribution indicated by "X"; Field distribution by "#")

Sanitized Copy Approved for Release 2011/04/12 : CIA-RDP80T00246A057500370001-3

50X1-HUM

**Page Denied**

Sanitized Copy Approved for Release 2011/04/12 : CIA-RDP80T00246A057500370001-3

CONFIDENTIAL

ADDITIONAL DATA ON THE CITY OF CHELYABINSK

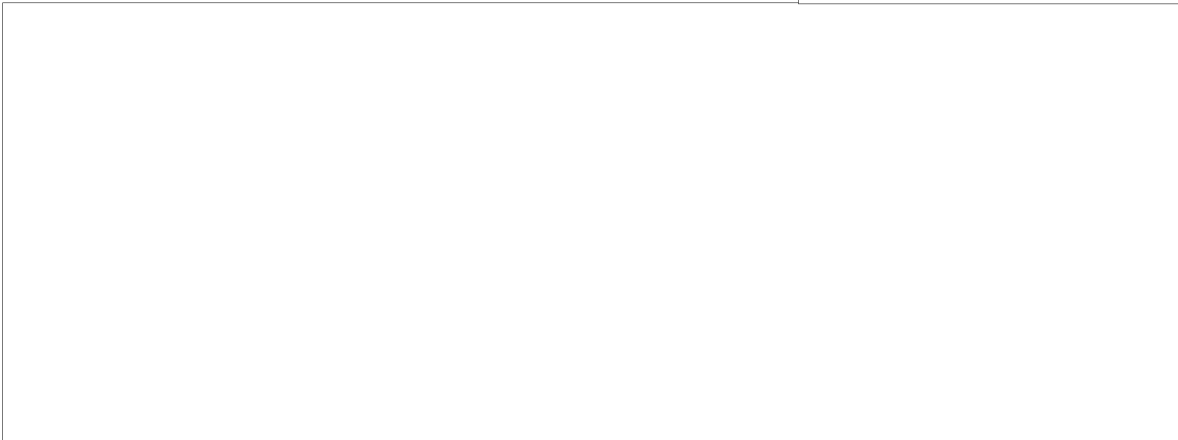

Chelyabinsk Tank and Tractor Plant i/n Stalin

2. [redacted] 50X1-HUM

[redacted] trolleys #3 and #6 went to this plant. The plant was known as ChTZ - Chelyabinskiy Traktorny Zavod - Chelyabinsk Tractor Plant - without any number or such name as i/n of Stalin or Kirov. It was not referred to as the Chelyabinsk Tank and Tractor Plant. [redacted]

the plant was surrounded by a wooden fence, about 2½ meters in height. 50X1-HUM

The fence had no towers or searchlights, but there were little guardbooths at regular intervals along the fence. The plant guards were dressed in 50X1-HUM

civilian clothes - armament unknown. [redacted]

[redacted] at night guards with dogs patrolled inside 50X1-HUM

the plant territory. [redacted]

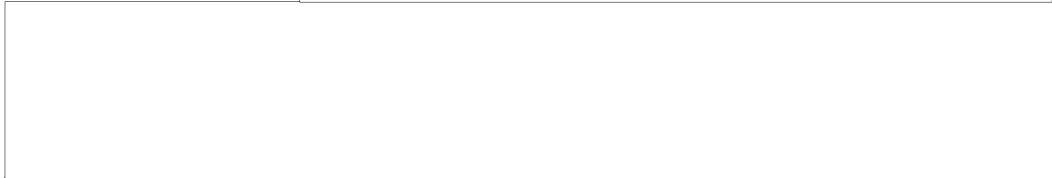

[redacted] the plant made tractors and tractor parts. [redacted] 50X1-HUM

[redacted] this plant had a large staff of engineers and technicians, and had several top secret shops (hearsay info). 50X1-HUM

Military Construction, New Construction, Miscellaneous

3. [redacted]

[redacted] in the metallurgical area, in the north, much construction of 4-5 story apartment buildings, about 50 m x 20 m, was going on in 1953-56. CONFIDENTIAL

b. [redacted] there was no civil defense training or air raid 50X1-HUM

shelters in the Chelyabinsk plexiglass plant or in Chelyabinsk.

c. There was full freedom of movement in and around Chelyabinsk.

prohibited area [redacted] was Kyshtym, which was off limits to a. 50X1-HUM

-2-  
CONFIDENTIAL



unauthorized personnel.

Additional DATA on the Plexiglass Plant

4.  rumors that the Chelyabinsk Plexiglass plant 50X1-HUM

sent glass to the Chelyabinsk Tractor plant  50X1-HUM



CONFIDENTIAL

**CONFIDENTIAL**

**INFORMATION REPORT**

50X1-HUM

COUNTRY: USSR (Ryazanskaya oblast)

REPORT

SUBJECT: City of Ryazan, Including  
Information on Dyagilevo  
Airfield and a Wood Plant

DATE OF

DATE AC

DATE OF REPORT: 6 December 1960

50X1-HUM

**CITY OF RYAZAN,  
INCLUDING INFORMATION ON DYAGILEVO AIRFIELD AND A WOOD PLANT**

Wood Plant

1. As of May 1957, there was a branch of a wood plant (No 2 on the sketch on page 4 ) about 200 meters from Sovetskaya ulitsa on the west side of the trolley bus park (sic; the trolley bus park is No. 1 on the sketch and seems to be north of the wood plant).

50X1-HUM

There were always two MVD guards at the entrance who required documentation from the workers or any other persons who wanted to enter the plant.

In the same fashion, trucks were inspected upon entering and leaving the plant, and documentation was requested of the drivers and assistants. This guard system was permanent, and during the night it was supplemented by patrols inside the plant area.

2.

50X1-HUM

3. Usually the production that the trucks took from the plant consisted of wardrobes, chairs, spoons, forks, knives, decanters, and other aluminum household effects, as well as veneer.

50X1-HUM

**CONFIDENTIAL**

50X1-HUM

**CONFIDENTIAL**

50X1-HUM

-2-

[redacted] this plant, as well as the central wood plant (No. 3 on the sketch on page 4 ) also produced some very special, high precision, delicate pieces.

50X1-HUM

[redacted] This fitter, who was a Russian, carried a card with a red diagonal line, and any time that he was arrested for being drunk or involved in any scandal, he would show it to the police and they would release him and ask his pardon.

50X1-HUM

50X1-HUM

Dyagilevo Airfield

- 4. The Dyagilevo Airfield, which was 12 kilometers northwest of Ryazan and about 500 meters south of the Moscow Ryazan highway, was called voyenny gorodok and was said by Ryazan citizens to be one of the most important air bases in the USSR. It did not have any connections with the railroad.

50X1-HUM

[redacted] the runways were oriented southwest-northeast since aircraft would land there from the southwest and take off to the northeast.

50X1-HUM

[redacted] both conventional and jet aircraft land there.

[redacted] the field had engine and radio repair shops

- 5.

[redacted]

- 6. At the entrance to the airfield there were several blocks of houses inhabited by the chiefs and officers of the air arm stationed at the field.

50X1-HUM

- 7. Although Dyagilevo was a military airfield, it also had some civilian traffic. The only flight that [redacted] was certain [redacted] was one to Kasimov (N 54-56, E 41-24)

50X1-HUM

[redacted] civilian flights to Moscow and mail flights left from the field.

**CONFIDENTIAL**

50X1-HUM

CONFIDENTIAL

New Installations

8. A new housing development consisting of about 1,000 apartments was constructed in the vicinity of the Dyagilevo Machine Tool Factory, about six kilometers north of the Ryazan-Moscow highway, and was inhabited by workers in this factory. The construction had already begun in 1953 and was still going on in May 1957. [redacted] there was a project under way to expand the factory as well [redacted]

50X1-HUM

9. In May 1957, posts with cement bases were being erected about four kilometers north of Ryazan, to be used for a new high tension line which was to run in an east-west direction. [redacted]

50X1-HUM

[redacted] there might be others [redacted]

[redacted] the Soviet Government was going to sponsor a project for expanding Ryazan. [redacted]

50X1-HUM

Trolley Bus Park

10. There was a trolley bus park about 200 meters south of the Ryazan-Moscow highway (No. 1 on the sketch on page 4), where about 500 trolley buses were housed in 1957. The park had a general repair shop and a machine tool shop. Thirty mechanics worked there, and the other 450 employees were bus drivers and conductors and cleaning women. The park had a civilian director [redacted] in 1957, the park was being modernized.

50X1-HUM

General

11. [redacted] one day a week DOSAAF members would have training and practice sessions. [redacted]

CONFIDENTIAL

50X1-HUM



CONFIDENTIAL

50X1-HUM

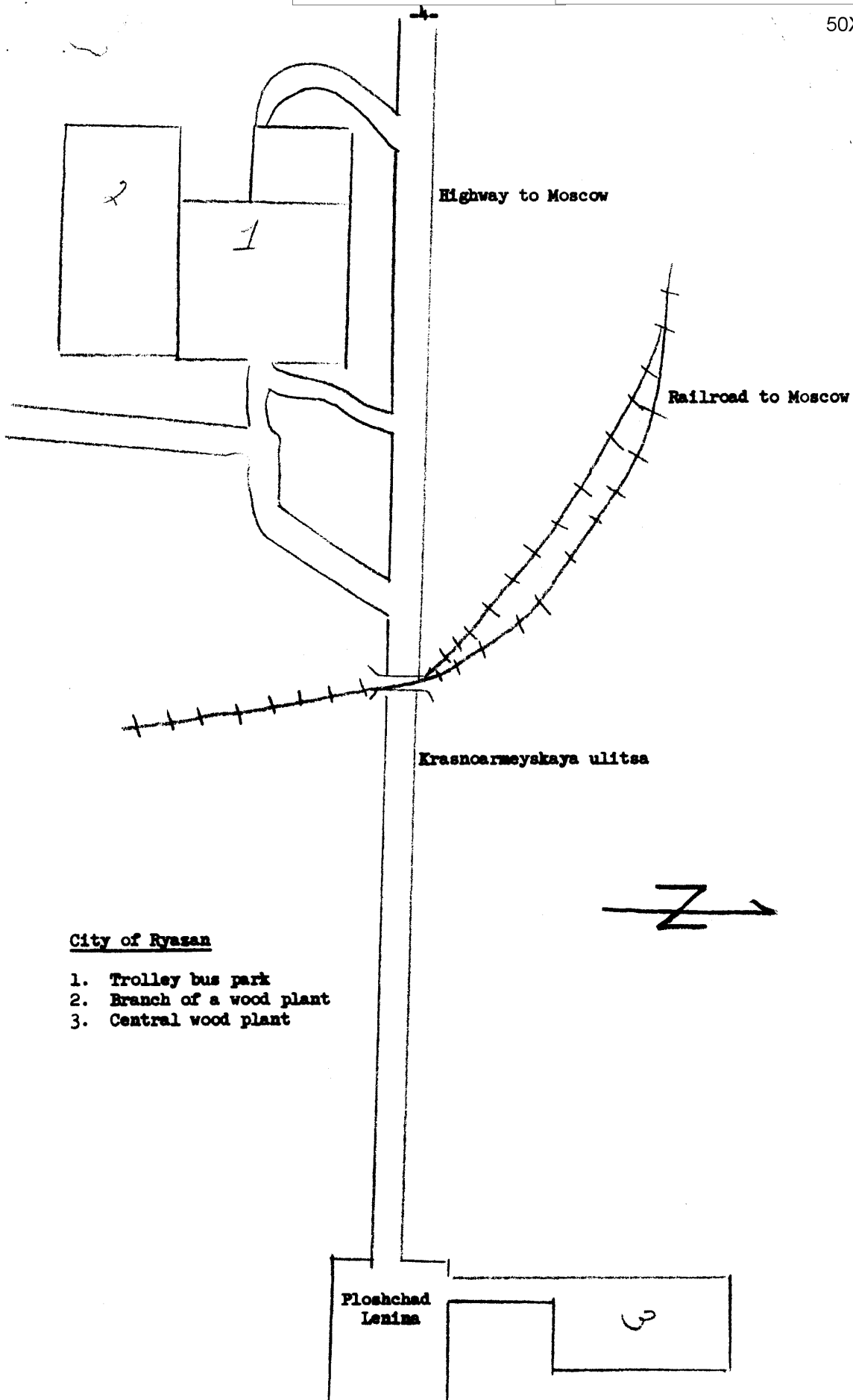

City of Ryazan

- 1. Trolley bus park
- 2. Branch of a wood plant
- 3. Central wood plant

Ploshchad  
Lenina

CONFIDENTIAL

50X1-HUM

CONFIDENTIAL

INFORMATION REPORT

COUNTRY: USSR (Ryazanskaya oblast) REPORT

SUBJECT: City of Ryazan

50X1-HUM

DATE OF REPORT: 7 December 1960

CITY OF RYAZAN

General

1. Ryazan had a population of a little over 100,000. These apartment buildings there were, for the most part, well constructed brick buildings, and the modern ones had from five to seven stories. It was customary to pay 80 or 90 rubles (a month?) for living quarters of about 12 to 16 square meters.
2. Most of the city of Ryazan depicted in the sketch of the city was well built up and consisted of new buildings. The area south of the main populated area (See No. 2 on the sketch), on both the right and left sides of the highway to Shatak (N 54-01, E 41-43), was made up of one and two-story buildings and could be called the old part of the city. They were already beginning to construct new buildings on both sides of the street between Yanskaya ploshchad and the square indicated by No. 1 on the sketch.
3. The city did not have a gas works since the gas came from Saratov. The gas and electricity supply was normal and was never interrupted.

CONFIDENTIAL

50X1-HUM

CONFIDENTIAL

50X1-HUM

-2-

Transportation

4. [redacted] three trolley bus lines in Ryazan. Line No. 1 began in ploshchad Revolyutsii (No. 34 on the sketch), continued to ploshchad Lenina, and along Krasnoarmeyskaya ulitsa and Pervomayskaya ulitsa to Mervino (N 54 38, E 39 40), and ended at the voyenny gorodok at Dyagilevo (N 54 39, E 39 37). Line No. 2 began in the square at No. 1 on the sketch, continued to Yanskaya ploshchad and along ulitsa Lenina <sup>1</sup> and ulitsa Revolyutsii to ploshchad Lenina, and then went along Krasnoarmeyskaya ulitsa and Pervomayskaya ulitsa to the square next to the Vtoroy Ryazan Railroad Station, where it turned around. Line No. 3 began in ploshchad Revolyutsii, continued along ulitsa Revolyutsii to ploshchad Lenina, went along Krasnoarmeyskaya ulitsa, and half-way along Pervomayskaya ulitsa, and then turned and went to the square next to the general hospital, (No. 60 on the sketch), where it turned around.
5. There was a bus line which began in Pervyy Ryazan square (No. 40 on the sketch), continued along Pervomayskaya ulitsa and Krasnoarmeyskaya ulitsa to ploshchad Lenina, then went along ulitsa Revolyutsii and along ulitsa Lenina <sup>1</sup> to ulitsa Libknekhta, and then along ulitsa Libknekhta to the square next to the military hospital (sic, probably general hospital). Twice a day buses left for Moscow from the Pervyy Ryazan square. The trip took about four hours and the bus stopped in Taganskaya ulitsa in Moscow. There were no streetcars in Ryazan.
6. The highway from Moscow to Ryazan was of asphalt, with very few curves, and was in very good condition. That from Mikhaylov (N 54 14, E 39 02) to Ryazan was not asphalted, but was a well-packed gravel road with small pieces of sand or packed dirt. There was bus service between Ryazan and Mikhaylov on this road. The highway from Moscow to Shatsk was asphalted like the Moscow-Ryazan road. The highway from Ryazan to Solotcha (N 54 48, E 39 51) was like the Ryazan-Mikhaylov road. There was a revolving wooden bridge on this road, which was put into motion by a mechanical device, and which would separate when boats on the Oka River had to pass under it.

50X1-HUM

Legend to the Sketch of Ryazan

1. Square which was one of the terminal points for trolley bus line No. 2.
2. Small houses in the old part of the city.
3. Radio station, which was in a newly-constructed building of seven or eight stories and which was very important.
4. Market for used goods.
5. Living quarters belonging to the medical institute. This was a well-built three-story building.

CONFIDENTIAL

50X1-HUM

CONFIDENTIAL

50X1-HUM

-3-

6. Calculating machine plant. About 1,000 persons worked in this plant, and many types of very complicated calculators were produced there, [redacted] The plant had a night shift, [redacted] 50X1-HUM
7. Park and stadium belonging to the Ryaselmash plant (See No. 18). Previously it has been called Tractor Park and Stadium, since the plant had been so named. In 1954 the plant team began to be called Torpedo, and thus the stadium also took this name.
8. Medical Institute.
9. Militia headquarters. This was a luxurious, five-story building, from which the traffic police and forces of law and order were directed.
10. Recruiting office, which was a four-story building where soldiers awaiting reassignment came and from whence they were assigned to the different armed forces units.
11. General Pedagogical Institute, which was a five or six-story building which covered a large area. It also contained living quarters for the students.
12. Government building. This was a newly-constructed building of five or six stories, which was very large and very luxurious. The president and secretary general of the Communist Party, the chief of the trade unions, and the Komsomol chiefs had their offices in this building. It was the best building in Ryazan.
13. Agricultural Institute, which had four stories. One could study for the degrees of agricultural engineer, mechanical engineer, veterinary engineer, or zootechnological engineer in this institute.
14. Parking area for trucks and buses. This was a garage where the city trolley buses were housed.
15. School for young girls. This was a large, well-constructed, three-story building where classes up to the tenth class were held.
16. Central Agricultural Institute. This was a three-story building which contained living quarters for the students. Some students would pass from this institute to the agricultural institute at No. 13 on the sketch.
17. Central Medical Institute. This was a well-constructed, seven-story building which occupied a large area.

CONFIDENTIAL

50X1-HUM

CONFIDENTIAL

50X1-HUM

-4-

- 18. Ryaselmash (Agricultural Machinery) Plant. in 1953 [redacted] alloys were made from metals, and potato harvesters, mowing machines etc. [redacted]

50X1-HUM

[redacted] were any plant in Ryazan converted to military production, it would have to have been the Ryaselmash Plant, since it had a lot of very good machinery. [redacted]

50X1-HUM

- 19. Vtoroy Ryazan Railroad Station.
- 20. Gardens of the Vtoroy Ryazan station.
- 21. Main bank of Ryazan.
- 22. Club and park belonging to a wood products factory.
- 23. Military living quarters. This was a well-constructed building of four or five stories, and it was assumed that it housed the officers of the artillery regiment at No. 39 on the sketch.
- 24. Men's prison.
- 25. Trolley bus repair area.
- 26. Football field and park for railroad workers.
- 27. Officers' club. This was a well-constructed five or six-story building where the chiefs and officers of the various military groups stationed in Ryazan congregated.
- 28. Police school, where traffic policemen were trained.
- 29. Army regiment. [redacted] it was a regiment, [redacted]
- 30. Main hotel in Ryazan.
- 31. Leather factory. This was not very important.
- 32. Monastery and church, which was a type of monument.
- 33. School, which was a large, well-constructed, four-story building. [redacted]

50X1-HUM

50X1-HUM

50X1-HUM

- 34. Ploshchad Revolyutsii.

CONFIDENTIAL

50X1-HUM

CONFIDENTIAL

-5-

50X1-HUM

35. A small factory which did not seem to be very important.
36. Pedagogical Institute, with women's living quarters.
37. Park, garden, and cattle market.
38. Women's prison.
39. Artillery unit, which covered a large area, [redacted] this unit was a [redacted] regiment or division, but at any rate, it was a large artillery unit. The epaulet insignia worn by the men in this area were those of the artillery troops as shown in DA Pam 30-50-1, according to a sketch [redacted] From the gate one could see trucks with trailers and cannons in the patio.
40. Square of the Pervyy Ryazan Railroad Station.
41. Pervyy Ryazan Railroad Station.
42. Main theater, which was large, beautiful, and luxurious.
43. Army regiment, which occupied a large area. [redacted] officers and soldiers enter and leave the area. There were guards at the gate, [redacted] the area had a length of a little more than 250 meters.
44. Clinic hospital. Workers were examined here and were given a low hospitalization rate.
45. Motor school or motorized unit. The area was very large and was surrounded by barbed wire. From the gate one could see various types of armored tracked vehicles. The epaulet insignia worn by the men in this area were those of the motor transport and military road units as shown in DA Pam 30-51, according to a sketch [redacted]
46. Garage for trucks which serviced the kolkhozy. This was located about 150 meters from the main highway from Moscow, and housed from 80 to 100 trucks which would pick up produce from Zakharovo (N 54 22, E 39 17), Mikhaylov, and the neighboring villages and transport them to the main storehouses in Ryazan (No. 58 on the sketch).
47. Service station for tractors and other agricultural machinery. Tractors, harvesters, sowers, etc. to be used by the kolkhozy were stored here. When a job was completed, the machinery would be returned to the service station and put in order for the next job.

50X1-HUM

50X1-HUM

50X1-HUM

50X1-HUM

50X1-HUM

CONFIDENTIAL

50X1-HUM

CONFIDENTIAL

-6-

48. Civilian airport, which was located about 200 to 250 meters from the main Ryazan-Moscow highway, and was an open field. A few biplanes were observed there.

50X1-HUM

the field was not very important.

50X1-HUM

49. The village of Dyagilevo, which was located about 300 meters from the main Moscow highway.

50. Living quarters for officers at the Dyagilevo military airfield.

51. Dyagilevo military airfield, which was located about four or five kilometers from the end of Pervomayskaya ulitsa, about 200 meters from the main highway. The field was very large and very important.

50X1-HUM

52. In 1948-1949, this building had been a school for apprentices. Prior to that time, it had been a concentration camp for Germans.

50X1-HUM

plans were being made for it to again be used as a prison or concentration camp.

53. Suburb.

54 to 57. Trolley bus stops on the route from Ryazan to the voyenny gorodok at Dyagilevo.

58. Grain storage elevator.

59. Rybnoye railroad station where machines and railroad cars in need of repair were parked.

60. General hospital, which consisted of seven or eight four-story buildings and occupied an area of about three square kilometers. This was one of the best hospitals in the Moscow area, having a good medical staff in all the specialities and hospitalizing not only the Ryazan population but also people from distant places.

Comment

50X1-HUM

1. Although ulitsa Lenina has not been indicated on the sketch, one might assume from the context that it is the street running north and south between ulitsa Revolyutsii and Yanskaya ploshchad.

CONFIDENTIAL

50X1-HUM

CONFIDENTIAL



Anexo I

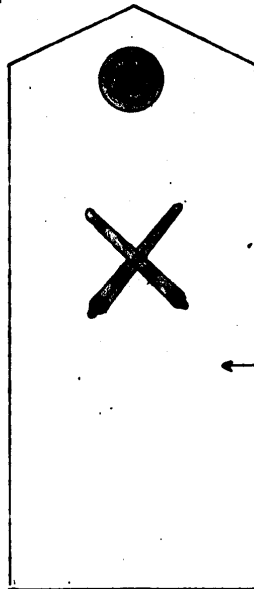

← fondo negro

Артиллерия в советской армии

*artillery*

CONFIDENTIAL



50X1-HUM,



**CONFIDENTIAL**



Amexo II

50X1-HUM



← fondo negro

АВТОТРАНСПОРТНАЯ ВОЙСКА И ВСЕ  
ПОДРОБНЕЕ ЧАСТИ

*Motor transport and subling road units*

**CONFIDENTIAL**

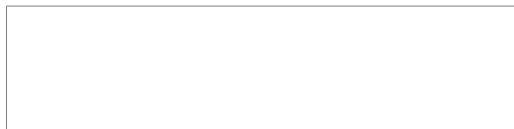

50X1-HUM

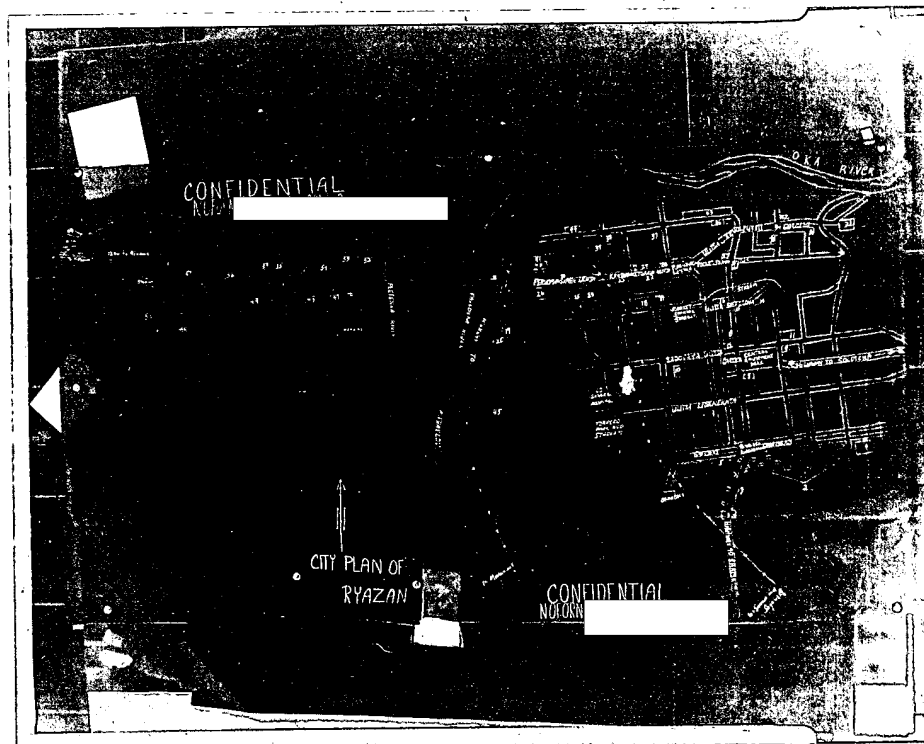

50X1-HUM

50X1-HUM

C-O-N-F-I-D-E-N-T-I-A-L

**INFORMATION REPORT**

COUNTRY: USSR (Moskovskaya oblast) REPORT

SUBJECT: City of Lyublino DATE OF

DATE AC

PLACE DATE OF REPORT:

50X1-HUM

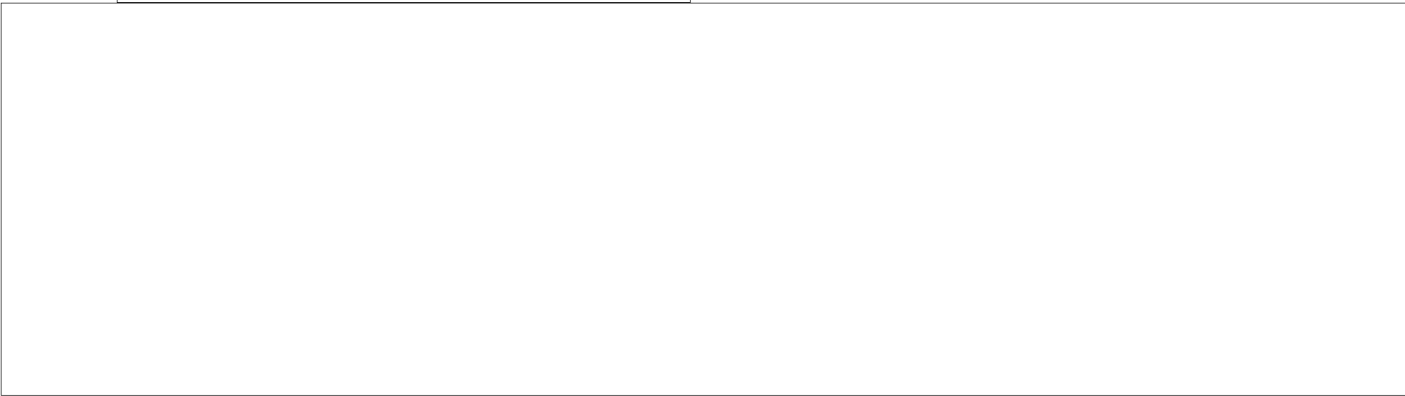

**CITY OF LYUBLINO**

1. The following legend pertains to the unscaled  sketch of the city of Lyublino reproduced on page 4.

50X1-HUM

- 1. Zhdanovskiy rayon of Moscow
- 2. Boundry between Zhdanovskiy rayon and the city of Lyublino
- 3. Terminal point of No. 43 bus line from Moscow
- 4. Community housing
- 5. Railroad school No. 2
- 6. Community housing
- 7. Plant for the production of items for the railroads
- 8. Street

50X1-HUM

50X1-HUM

C-O-N-F-I-D-E-N-T-I-A-L

50X1-HUM

C-O-N-F-I-D-E-N-T-I-A-L

- 9. Bus stop for bus line No. 43 50X1-HUM
- 10. Street 50X1-HUM
- 11, 12, 13 and 14. Community housing
- 15. Mayakovskaya ulitsa
- 16. Bus stop for bus line No. 43
- 17. Community housing
- 18. Street 50X1-HUM
- 19. Block of dwellings
- 20. Building 50X1-HUM
- 21. Old dwellings
- 22. Group of new dwellings
- 23. Moskovskaya ulitsa
- 24, 25 and 26. Group of old community dwellings
- 27. Lyublino city stadium
- 28. Vokzalnaya ulitsa
- 29. Lyublino railroad station
- 30. Bus stop for bus line No. 43
- 31. Highway to Moscow
- 32. Group of old community dwellings
- 33 and 34. Bus stop for bus line No. 43
- 35. Group of old community dwellings
- 36. Bus stop for bus line No. 43 50X1-HUM
- 37, 38 and 39. Group of old community dwellings
- 40. Automobile repair plant 50X1-HUM
- 41. Railroad to Moscow
- 42. Highway to Moscow

C-O-N-F-I-D-E-N-T-I-A-L

C-O-N-F-I-D-E-N-T-I-A-L

[Redacted]

50X1-HUM

-3-

2. About one kilometer south of the city of Lyublino a construction trust was building a group of new communal dwellings [Redacted] of new communal dwellings was under construction to the east of the city [Redacted]

Another group

50X1-HUM

50X1-HUM

50X1-HUM

3. The number 43 bus was the only public transportation in Lyublino.

[Redacted]

50X1-HUM

C-O-N-F-I-D-E-N-T-I-A-L

[Redacted]

50X1-HUM

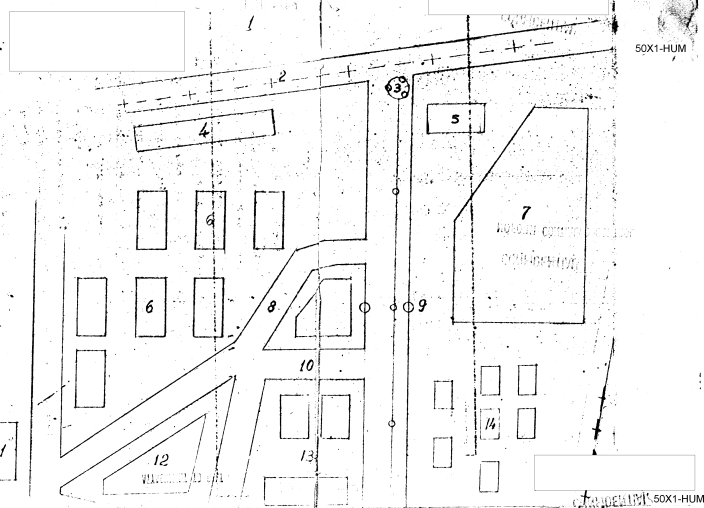

50X1-HUM

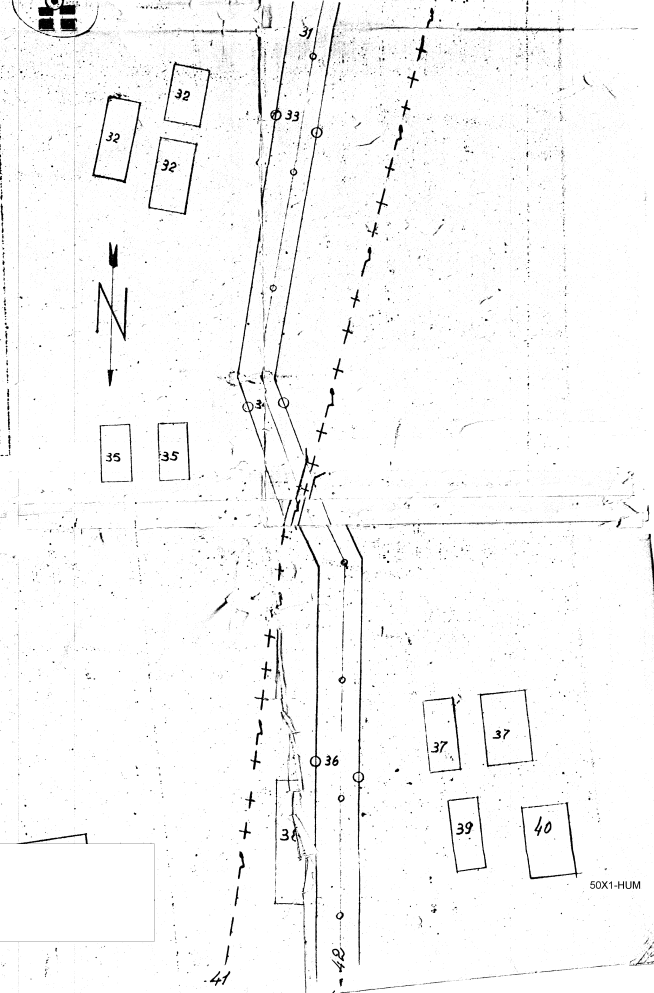
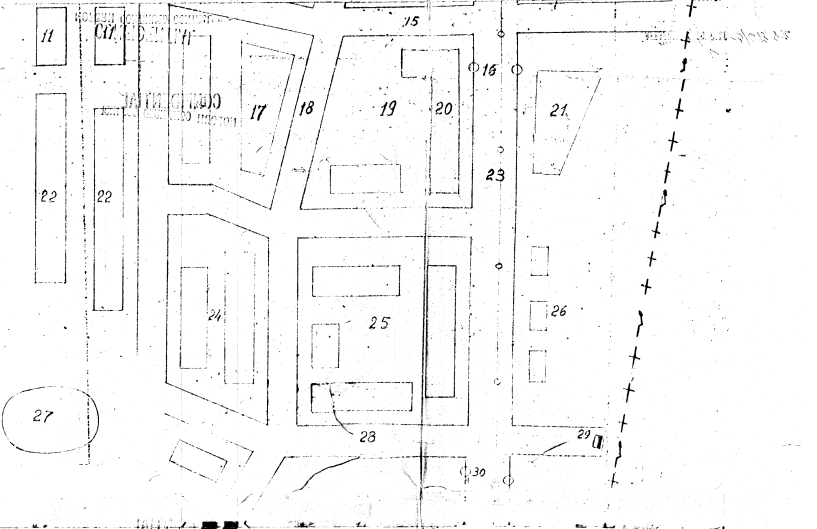

50X1-HUM

Sanitized Copy Approved for Release 2011/04/12 : CIA-RDP80T00246A057500370001-3

50X1-HUM

**Page Denied**

Sanitized Copy Approved for Release 2011/04/12 : CIA-RDP80T00246A057500370001-3

~~C-O-N-F-I-D-E-N-T-I-A-L~~

**INFORMATION REPORT**

COUNTRY: USSR (Ryazanskaya oblast) REPORT

SUBJECT: Military and Industrial DATE OF  
Installations in Ryazan

DATE AC

DATE OF REPORT: 14 November 1960

50X1-HUM

**MILITARY AND INDUSTRIAL INSTALLATIONS IN RYAZAN**

50X1-HUM

1. The legend given below refers to the overlay

1. Ploshchad Lenina.

2. Ryazan Kremlin

The Kremlin had several numbers because of the various buildings it contained inside. Inside were three churches, a cathedral, and a general Kray museum. Restoration was under the jurisdiction of the Ministry of Culture and the local authorities. The Kremlin was located at the east side of the Pletenka river, a small tributary of the Oka river.

3. Ulitsa Lenina; streets had even numbers on one side and odd numbers on the other

50X1-HUM

~~C-O-N-F-I-D-E-N-T-I-A-L~~

50X1-HUM



C-O-N-F-I-D-E-N-T-I-A-L

-2-

4. Podvelskaya ulitsa popularly referred to as "Pochtovaya ulitsa" because the Post Office (point 23) was located there.
5. Large military academy for infantry officers (lieutenants and above). The main building, containing classrooms, was a three story brick structure, covered with white plaster, and about 70 meters long. Smaller living quarters were located behind the classroom building, and in front was a parade ground and sports fields with some sports equipment (bars, jumping pit, etc.) A three-meter-high iron grill fence bordered the academy grounds on Krasnoarmeyskaya ulitsa. The unguarded entrance gate was on this street. [redacted] the students spent two to three years at the academy. See sketch of academy layout on page
6. An infantry unit of non-commissioned personnel was located about 300 meters west of the academy on the same side of the street. It had a metal grill fence about 500 meters long bordering Krasnoarmeyskaya ulitsa, but the entrance was around the corner to the northwest on another unidentified street. There were about five, two to three story brick structures covered with white plaster which comprised this installation. (See sketch 1.)
7. Krasnoarmeyskaya ulitsa.
8. Voyenkomat on Sadovaya ulitsa.
9. Ryazanskaya pervaya railroad station.
10. Ryazanskaya vtoraya railroad station. These two stations were not far apart, but Ryazanskaya pervaya was nearer to Moscow.
11. Large military airfield at Dyagilavo, about ten kilometers northwest of Ryazan in open country, and two or three kilometers beyond the Machine Tool Plant (point 16). The field had a hanger and various other buildings, including barracks. Only jet fighter planes were stationed here.
12. [redacted] this area shown on mosaic as a park or woods no longer existed [redacted]
13. City park about one block square.
14. Civilian hospital.
15. Electric light plant which also made the glass bulbs for radio tubes.

50X1-HUM

50X1-HUM

C-O-N-F-I-D-E-N-T-I-A-L

50X1-HUM

C-O-N-F-I-D-E-N-T-I-A-L

-3-

50X1-HUM

16. Very large new machine tool building plant located about seven kilometers northwest of Ryazan on the right-hand side of the highway and railroad to Moscow, about two or three kilometers before the military airfield at Dyagilevo. [redacted] there had been no factory here previous to 1949 when construction began. [redacted] the factory was in production in 1953. When there were already many two-to three-story buildings, and still others under construction. According to rumors, the factory was to have a work force of 20,000. Living quarters were built in the area near the factory. Skilled workers underwent a seven-month factory apprenticeship to qualify as turners, mechanics, etc. [redacted] 50X1-HUM
17. Selmash (agricultural machinery plant). [redacted] 50X1-HUM
18. Small port on Pletenka river.
19. Medical institute i/n Pavlov. This large institute was transferred from Moscow in 1953 as part of a decentralization program. The medical institute consisted of three to four large buildings for about 200 personnel. [redacted] this was the only installation in Ryazan where there were Chinese, North Koreans, and other foreigners besides Spaniards. 50X1-HUM
20. Monument to <sup>1</sup>/~~A~~.P. Pavlov. [redacted] 50X1-HUM
21. Agricultural institute i/n Kostuchev.
22. Sadovaya ulitsa.
23. Post Office.
24. Officers club. This was three-story recreational building for members of all branches of the service.
25. Pedagogical institute.
26. Bazar.
27. Stadium.
28. Race track.

C-O-N-F-I-D-E-N-T-I-A-L

50X1-HUM

C-O-N-F-I-D-E-N-T-I-A-L

29. ZAM (Zavod Avtomaticheskikh Mashin). When asked if this could might have been called the schetny machine plant, [redacted] This plant was being expanded, or living quarters were being built, in 1953. 50X1-HUM

30. Military unit southwest of the city. [redacted] believed [redacted] a cavalry unit. 50X1-HUM

31. Approximate location of a radio engineering institute which was transferred from Moscow about 1952.

32. Rail spur.

33. Rail bridge across Oka river.

34. Large artillery school. [redacted] 50X1-HUM

[redacted] personnel wore plain shoulder-boards while within the school, but when they came out of the school on the street they wore shoulder-boards with insignia of artillery sergeants or of motorized infantry units. The school had a band, whose members wore shoulder-boards with musicians insignia. This school was a three-story buick building covered with white plaster. Behind the building was a large parade ground with a single cannon of ancient vintage and a sports field with sports equipment. Behind the field were some smaller buildings used for living quarters. See sketch on page 6 for layout of this school.

2. [redacted] there were no signs of civil defense in the city, neither information, training, nor shelters. 50X1-HUM

C-O-N-F-I-D-E-N-T-I-A-L

50X1-HUM

C-O-N-F-I-D-E-N-T-I-A-L

-5-

MILITARY INSTALLATIONS IN RYAZAN  
(Not to scale)

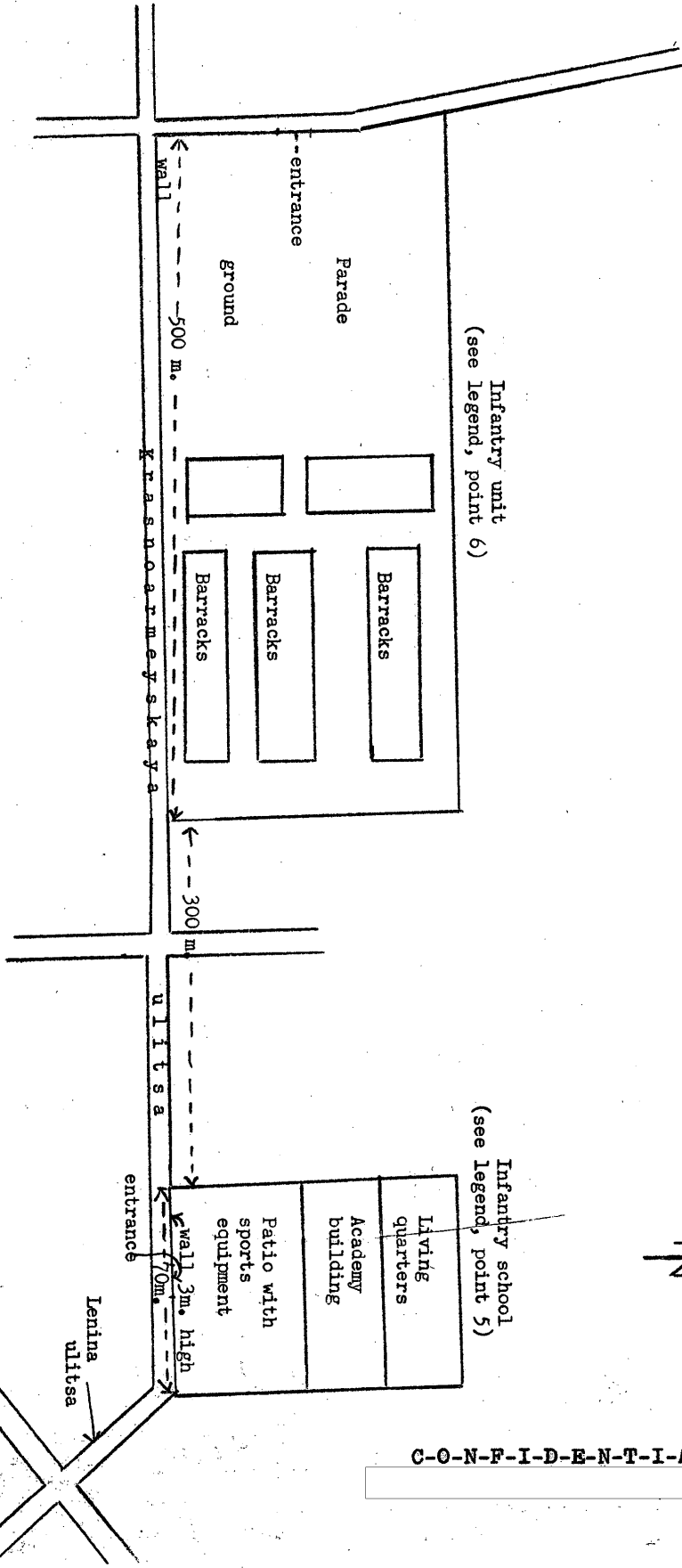

C-O-N-F-I-D-E-N-T-I-A-L

C-O-N-F-I-D-E-N-T-I-A-I

-6-

50X1-HUM

ARTILLERY SCHOOL IN RYAZAN  
(Not to Scale)

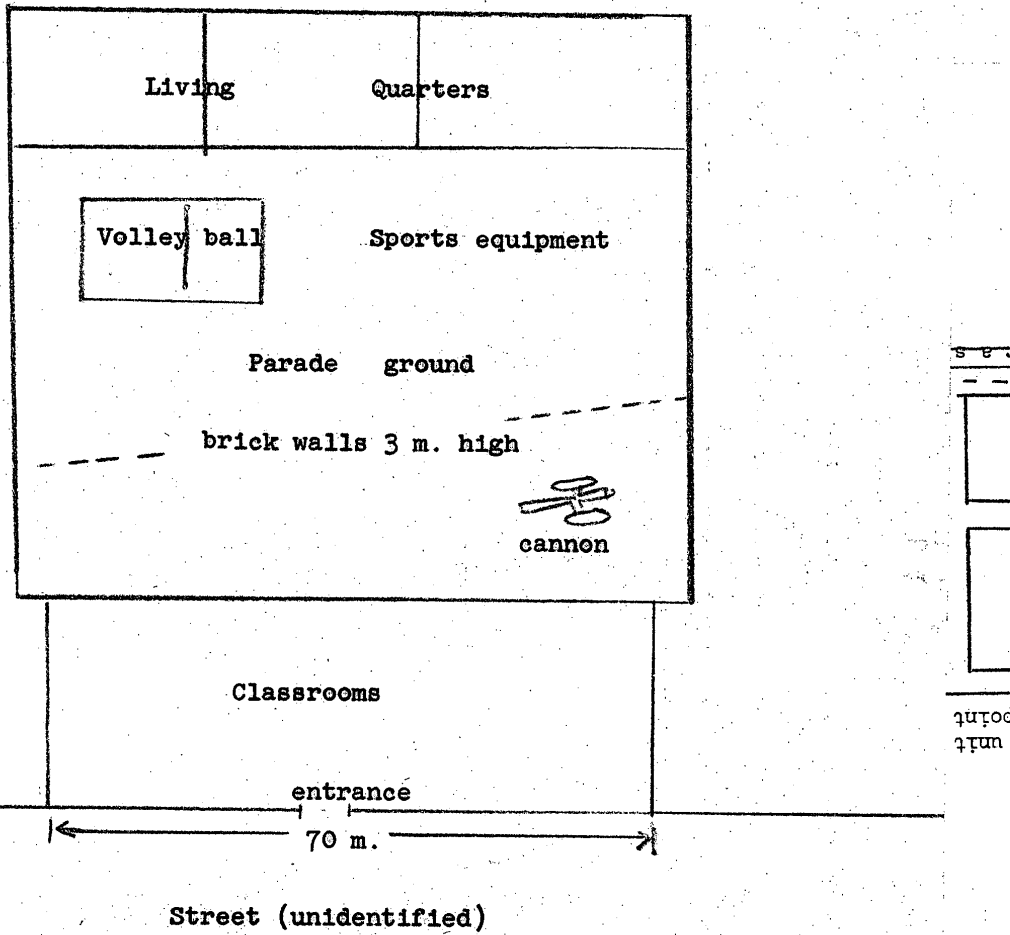

C-O-N-F-I-D-E-N-T-I-A-I

III

50X1-HUM

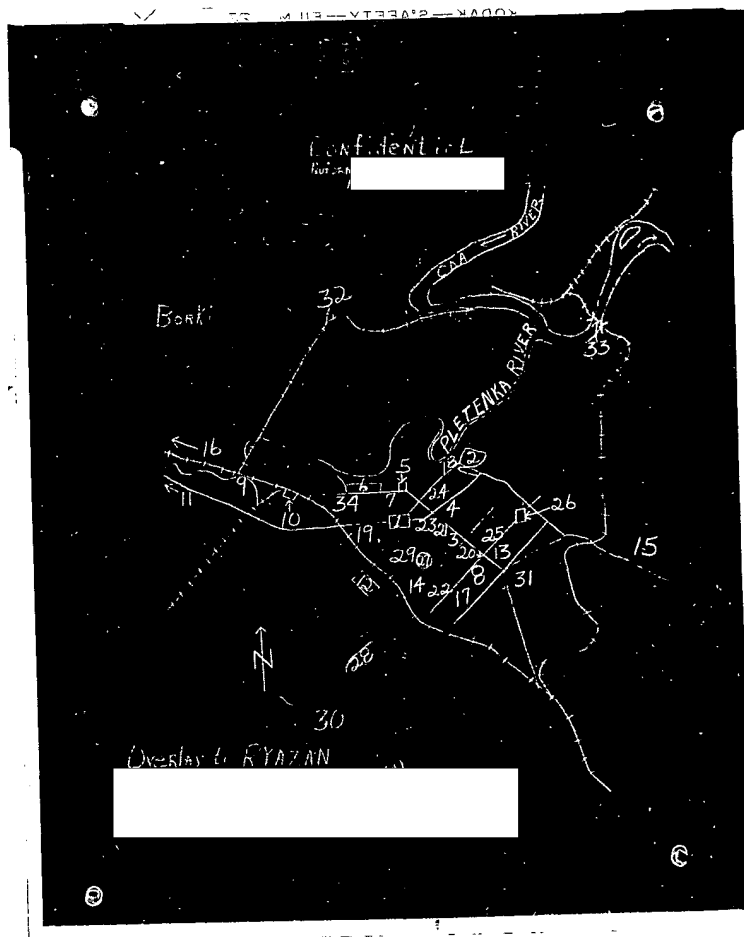

50X1-HUM

50X1-HUM