

25X1

25X1

00250003-3

ANNEX 1

LEGEND: see next page

Budapest Barracks

Potosfi Barracks

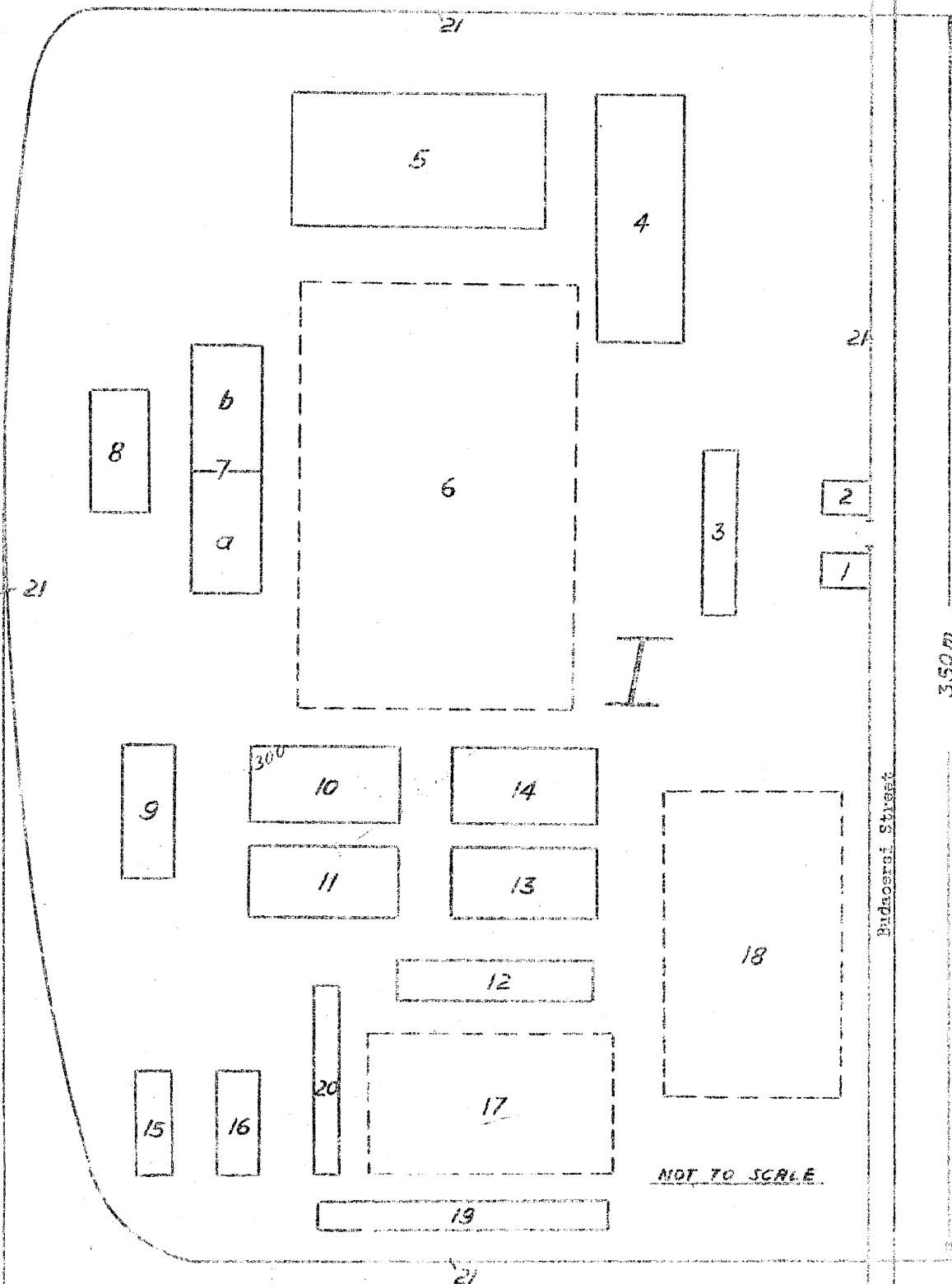
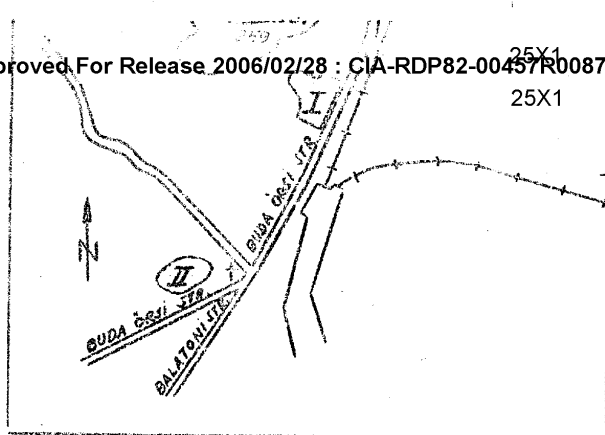

NOT TO SCALE

SECRET/CONTROL/NO OFFICIALS ONLY

Annex 1

25X1

- 2 -

Legend:Location Sketch.I Petoefi Barracks.II New barracks installation on Budacersi Street. For a layout sketch, see Annex 2.Layout sketch, Petoefi Barracks.

1. Three-story building, 15 meters square, containing guard room and prison, located on Budacersi Street.
2. Building of the duty officer, a three-story building 15 meters square.
3. Two-story building, about 40 x 10 meters, with the first floor containing rooms for visitors, barracks administration and barber shop; and the second floor containing apartments.
4. Three-story building, about 100 x 20 meters, housing an officers' course.
5. Three-story building, about 100 x 20 meters, housing a field-grade officers' course.
6. Barracks yard.
7. Three-story EI quarters, about 100 x 20 meters. The basement contained storerooms and workshops.
  - a. The first floor quartered the radio battalion, the second floor the telephone battalion, and the third floor the special detail.
  - b. The second floor quartered the telephone battalion. The use of the first and the third floors was unknown.
8. Former stables, now gutted.
9. Two-story EI school, about 70 x 20 meters.
11. Three-story EI quarters, housing an AAA school for EI.
12. Garage, about 80 x 10 meters.
13. Three-story building, about 70 x 20 meters, which was completed in October 1950. The school for training of women was quartered there.
14. Three-story building, about 17 x 20 meters, used by the officers who were quartered in building No 4.
15. and
16. Low garages and mechanical workshops, each about 30 x 15 meters.
17. Athletic field.
18. Soccer field.
19. Low depot, about 100 x 10 meters.
20. Low stables.
21. Brick wall, about 3 meters high.

SECRET/CONTROL/NO OFFICIALS ONLY