

~~CONFIDENTIAL~~
CLASSIFICATION ~~SECRET~~ CONTROL - U.S. OFFICIALS ONLY
SECURITY INFORMATION
CENTRAL INTELLIGENCE AGENCY

REPORT [Redacted]
CD NO. [Redacted]

COUNTRY Rumania
SUBJECT Danube Metallurgical Industry Rolling Mills (Braila)

DATE DISTR. 18 January 1952
NO. OF PAGES 5

PLACE ACQUIRED [Redacted]
DATE OF INFO. [Redacted]

NO. OF ENCLS. (LISTED BELOW) 50X1-HUM
SUPPLEMENT TO REPORT NO.

[Redacted]

THIS DOCUMENT CONTAINS INFORMATION AFFECTING THE NATIONAL DEFENSE OF THE UNITED STATES, WITHIN THE MEANING OF TITLE 18, SECTIONS 793 AND 794, OF THE U. S. CODE, AS AMENDED. ITS TRANSMISSION OR REVELATION OF ITS CONTENTS TO OR RECEIPT BY AN UNAUTHORIZED PERSON IS PROHIBITED BY LAW. THE REPRODUCTION OF THIS FORM IS PROHIBITED.

THIS IS UNEVALUATED INFORMATION 50X1-HUM

[Redacted]

1. The Danube Metallurgical Ent rprises, known as IMD (Industria Metalurgica Danubia), was formerly owned by Goldenberg Brothers but is now a State enterprise. The factory is located at Strada Transilvaniei No. 5 in Braila. It employs 1,800 skilled workers on a twenty-four hour a day schedule (three eight-hour shifts).
2. The largest section of the workd is the Lamination Section which produces half-finished goods that serve other departments as raw material. The equipment consists of two furnaces with four oil injectors each. There are also two series of rollers, with 24 rollers in each, arranged in vertical sets of three. Iron bars coming from the furnaces are introduced into a first roller known as the "oval," and emerge from the series through a roller called the "end." The mill produces 1,800 rods for reinforced concrete and 40-50 tons of flat and square bars.
3. The Wire Drawing Section produces finished iron and brass wire and also iron wire used as raw material for the Nails Department. Its equipment consists of a sulphuric acid bath in which wire coming from the Lamination Section is placed, an annealing chamber for wire removed from the acid bath, and two series of smaller rollers.
4. There are also a Nails Department, a Screws Department, a Chains Department, and a Cutting Department. The Cutting Department cuts the raw material into 1.20 meter lengths for the furnaces in the Lamination Section. It also cuts the reinforcing rods and bars produced by that section into the required lengths. Hand chisels are used for this purpose.
5. Other installations include an electric power station, workshops, a small factory for the production of packing cases for nails, repair equipment for electrical installations, and a railway siding.

50X1-HUM

STATE	X	NAVY	X	NSRB		DISTRIBUTION	
ARMY	X	AIR	X	FBI		ORR Ev	X

Document No. 7
 No Change in Class.
 Declassified
 Class. Changed To: TS S (S)
 AUTHORITY: 10-1
 Date: 31 AUG 1978

~~CONFIDENTIAL~~
~~CONFIDENTIAL/CONTROL - U.S. OFFICIALS ONLY~~

SECURITY INFORMATION



50X1-HUM

-2-

6. Pig iron is the chief raw material used, and it is brought by rail from Hunedara and Resita. It is unloaded and stacked ready for cutting near the railway siding.
7. Almost the entire output of the works is loaded on freight cars going to Reni (USSR).
8. There is a second rolling mill similar to the IMD works but better equipped, also at Braila, called Industria Sarmel. This mill is more highly mechanized.

~~CONFIDENTIAL~~
~~CONFIDENTIAL/CONTROL - U.S. OFFICIALS ONLY~~

~~CONFIDENTIAL~~
SECRET/CONTROL - U.S. OFFICIALS ONLY

SECURITY INFORMATION









50X1-HUM

-3-

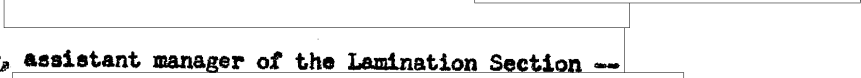
Appendix I

PERSONALITIES

- Bizancea, factory medical adviser -- 
- Dolaci, manager of the Lamination Section -- 
- Fischer, assistant manager of the Lamination Section -- 
- Gelbert, engineer -- 
- Gros, chief cashier -- 
- Jigman, general manager -- 
- Cezar, assistant manager of the Lamination Section -- 

50X1-HUM

~~CONFIDENTIAL~~
SECRET/CONTROL - U.S. OFFICIALS ONLY

CONFIDENTIAL

SECRET CONTROL - U.S. OFFICIALS ONLY

SECURITY INFORMATION



50X1-HUM

-4-

Appendix II

LEGEND

- | | |
|--|-------------------------------|
| 1. Arrow points toward center of town. | 11. Chain making department. |
| 2. Strada Transilvaniei. | 12. Lamination department. |
| 3. Strada Republicii. | 13. Nail drawing department. |
| 4. Entrance to the works. | 14. Wire drawing department. |
| 5. Road taken by employees and laborers. | 15. Screw cutting department. |
| 6. Vehicles only. | 16. Nail store. |
| 7. Porter and weighing machine. | 17. Railway siding. |
| 8. Administrative offices. | 18. Approximately 300 meters. |
| 9. Labor office. | 19. Approximately 400 meters. |
| 10. Electric power station. | |

CONFIDENTIAL

~~SECRET~~/CONTROL - U.S. OFFICIALS ONLY

CONFIDENTIAL

SECURITY INFORMATION



50X1-HUM

-5-

APPENDIX 2

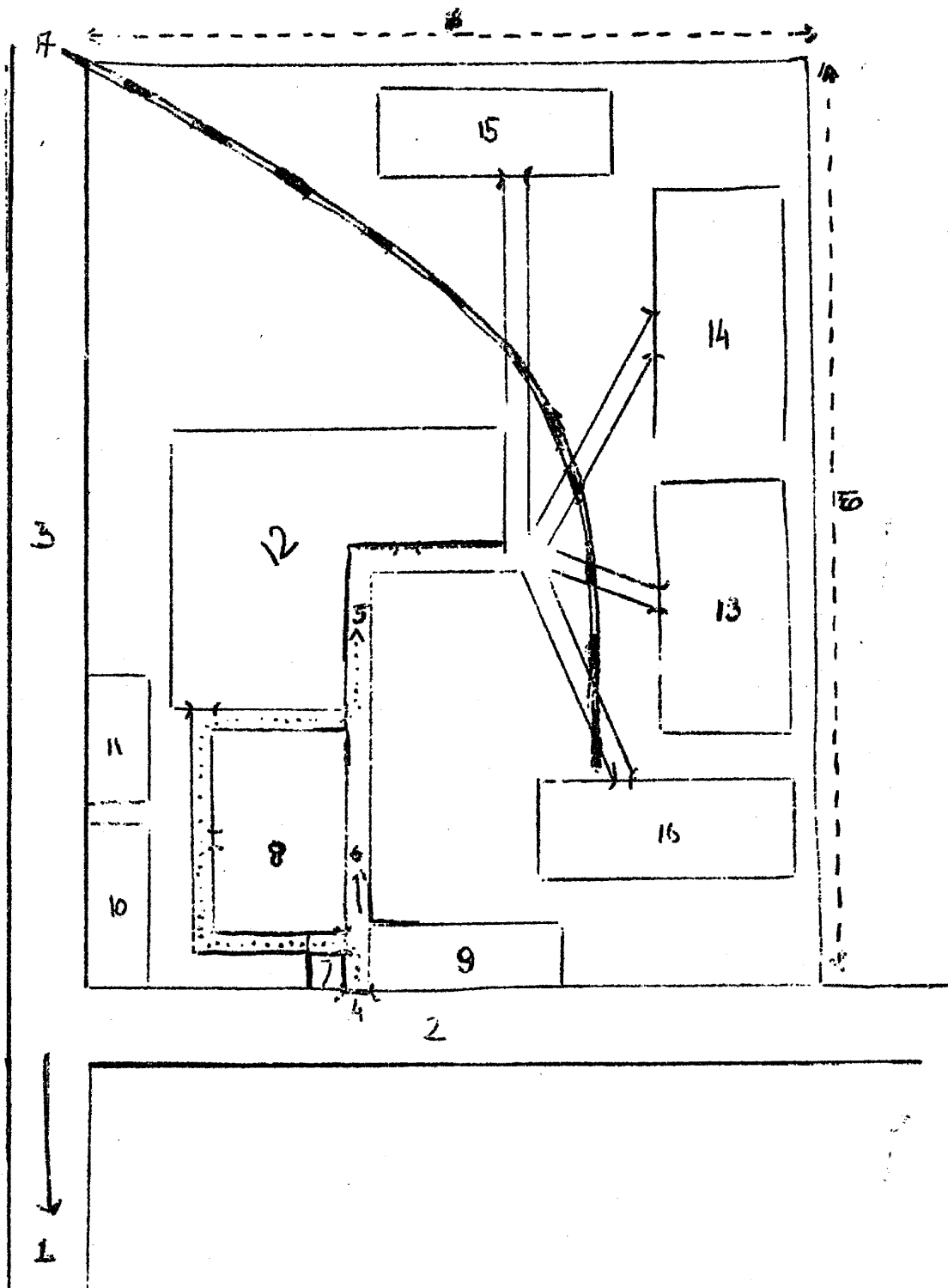

CONFIDENTIAL

~~SECRET~~/CONTROL - U.S. OFFICIALS ONLY