

25X1



Approved For Release 2002/08/15 : CIA-RDP83-00415R010500120011-9

TRACTOR PLANT AT, MINSK
(INFO AUG 45 - JUNE 49)
2P 2 ENCLS (2 ANNEXES)

25X1

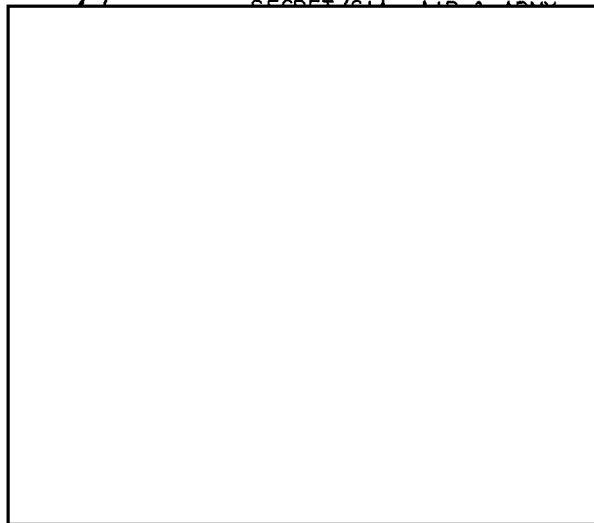

Approved For Release 2002/08/15 : CIA-RDP83-00415R010500120011-9

CONTROL NUMBER

0000
1111
2222
3333
4444
5555
6666
7777
8888
9999

5592

Handwritten initials

CLASSIFICATION ~~SECRET~~ [redacted]

CENTRAL INTELLIGENCE AGENCY

REPORT NO. [redacted]

**INFORMATION REPORT
RETURN TO CIA
LIBRARY**

CD NO. 25X1A

COUNTRY USSR (White Russian SSR)

DATE DISTR. 7 February 1952

SUBJECT Tractor Plant at Minsk

NO. OF PAGES 2

PLACE ACQUIRED 25X1A

NO. OF ENCLS. 2
(LISTED BELOW)

DATE OF INFO. [redacted]

SUPPLEMENT TO REPORT NO.

~~REFERENCE COPY~~

~~DO NOT CIRCULATE~~

25X1X

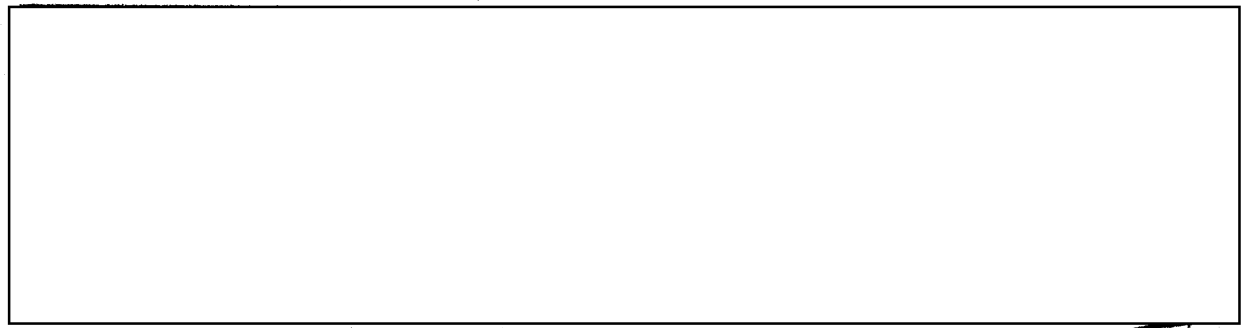

25X1A

Comment:

- a. Source submitted the attached two sketches of the location (Annex 1) and of the layout (Annex 2) of the Tractor Plant in MINSK, White Russian SSR. The two sketches represent the status of the tractor plant as of June 1949.
- b. Annex 1 on the plant location confirmed previous information. Annex 2 is also in agreement with previously received reports and can be considered correct. Detailed data on the sizes and types of construction of the plant shops are contained in the legend to this annex.

EXPLOITED BY IR

Legend to Annex 2:

- 1 Drop forge, about 600x600x75 feet, with 4 furnaces, 20x18 feet each. The foundations of the building are 20 feet deep. A 180-ton forge hammer is in the center of the shop.
- 2 Foundry, 420x240 feet, nearby complete
- 3 Transformer plant, 120x120 feet, with a 90-foot smokestack. The power transmission line was still under construction
- 4 and 5 New buildings, 600x600 and 240x120 feet, no details available
- 6 Wooden concrete mixing plant
- 7 PW Camp No 7163/14
- 8 Building 360x300 feet with:
 - a Three-story administration section
 - b Engine shop, 30 feet high most of the installed machinery was dismantled in the Meinkel Plant in GRANLIMBURG

CLASSIFICATION ~~SECRET~~ [redacted]

25X1

STATE	NAVY	NSRB	DISTRIBUTION																
ARMY	#	X	AIR	#	X	FBI													

- 9 Assembly hall, 540x300x75 feet, under construction
- 10 Machine tool department, 300x240x30 feet
- 11 Assembly hall, 450x240x75 feet, still without roof
- 12 Russian camp
- 13 Small magazine
- 14 Boiler house, 120x90 feet, with a 100-foot smokestack
- 15 Garage, 150x75 feet
- 16 Large magazine, about 600 feet long
- 17 Wooden storage shed, 180x45 feet (storage of machinery)
- 18 Building 240x120 feet with:
 - a Pattern shop
 - b Delousing station
- 19 Workshop 150 feet square, for the construction of the sewage system
- 20 Sawmill and carpentry with several auxiliary buildings, 1,200x300 feet

The plant section with the workshops 1 through 6 was surrounded by a fence. Only Soviet forced labor have worked there since the Spring of 1949.

- 2 Annexes: (1) Location of the Tractor Plant in MINSK
(2) Installations of the Tractor Plant in MINSK.

SECRET

Annex 2

25X1A

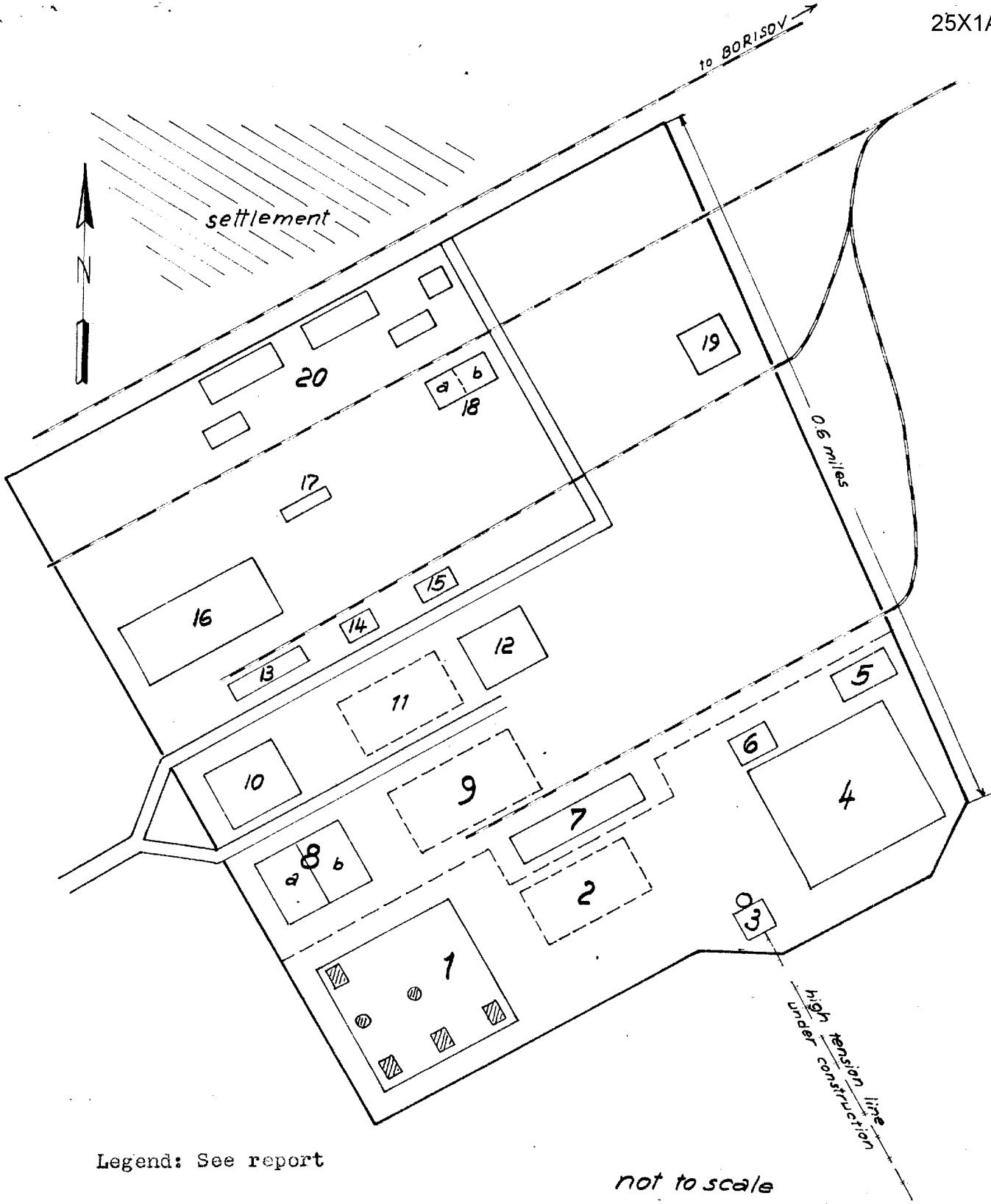

Legend: See report

not to scale

SECRET

RETURN TO CIA

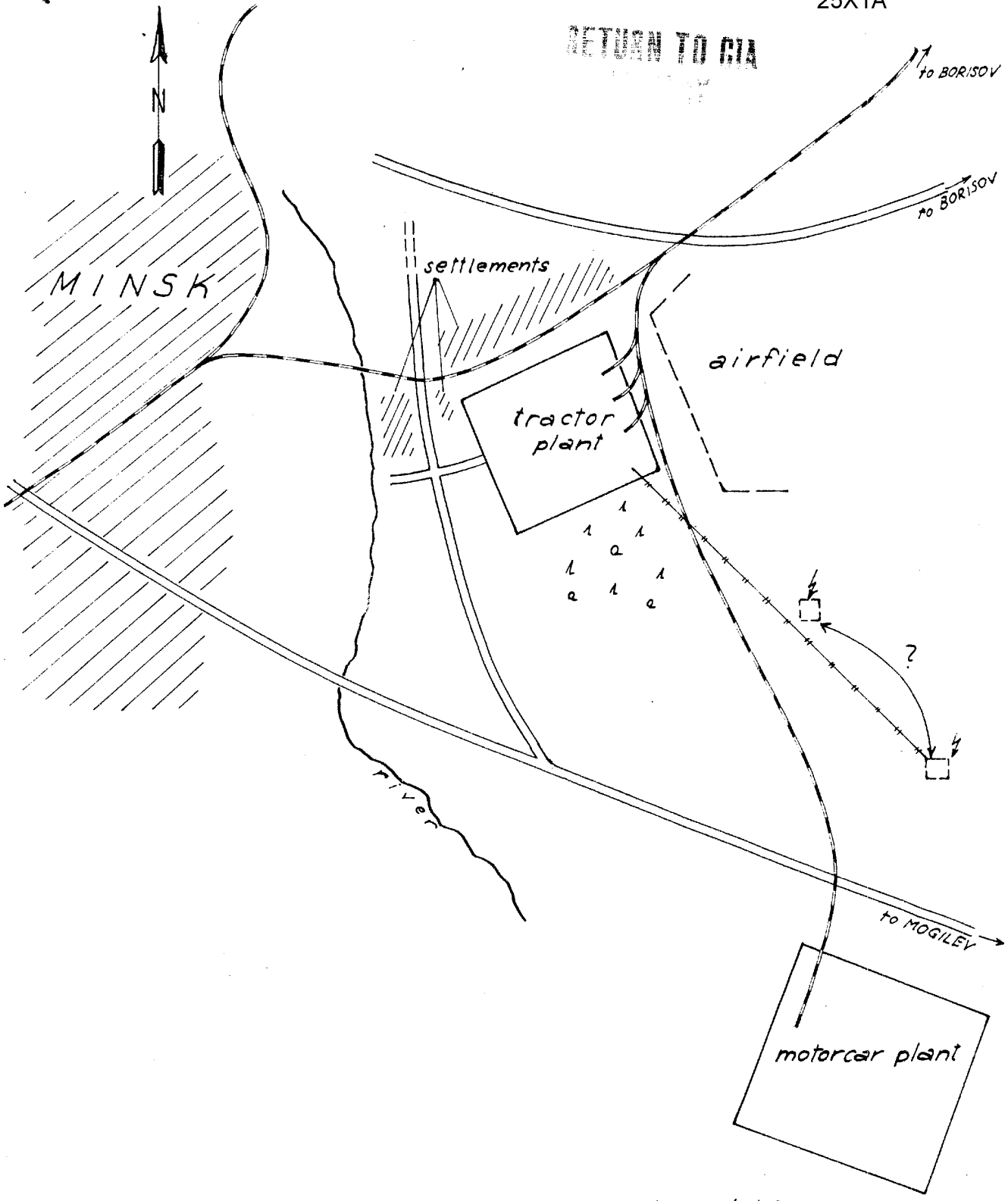

scale about 1:25,000