

SITUATION SUMMARY - PART 1

THIS SITUATION SUMMARY COVERS DEVELOPMENTS IN CUBA AS OF 29 AUGUST 1962. THE FOLLOWING IS COLLATED FROM A NUMBER OF HIGHLY RELIABLE SOURCES.

-MISSILES-

BAHIA HONDA SAM SITE 2257N 08317W  
8 NM NW OF BAHIA HONDA AT 22-57-32N  
083-17-28W.

SA-2 SAM SITE UNDER CONSTRUCTION. FOUR UNRETTED LAUNCH POSITIONS COMPLETED AND 2 UNDER CONSTRUCTION. TWO LAUNCHERS ARE NET-COVERED. FRUIT SET RADAR IS PRESENT AND SURROUNDED BY VERTICAL NETTING. SIX VANS AND 6 MISSILE TRANSPORTERS ARE PRESENT AND NET COVERED. APPROXIMATELY 15 TENTS AND 15 VEHICLES IN AREA.

*Please  
Return to me  
BB*

HAVANA SAM SITE 2309N 08213W  
6.7 NM ENE OF HAVANA AT 23-09-25N  
082-13-32W.

SA-2 SAM SITE UNDER CONSTRUCTION. SIX UNRETTED LAUNCH POSITIONS WITH LAUNCHERS, FRUIT SET RADAR WITH APPROXIMATELY 6 ASSOCIATED VANS, 6 MISSILE TRANSPORTERS WITH CANVAS-COVERED TRAILERS, APPROXIMATELY 10 VEHICLES, AND APPROXIMATELY 15 TENTS.

*File 30088*

LA COLOMA SAM SITE 2218N 08332W  
4.5 NM NNW OF LA COLOMA AT 22-18-42N  
083-32-35W.

SA-2 SAM SITE UNDER CONSTRUCTION. SIX LAUNCHERS, FRUIT SET RADAR AND 7 VANS IN CENTER. 15 TRUCKS, 6 TENTS, 3 MISSILE-HOLD POSITIONS WITH 2 CANVAS-COVERED MISSILE TRANSPORTERS IN EACH. 3 HOLD POSITIONS REVETTED. ONE LAUNCHER AND VANS IN CENTER OF SITE BEING REVETTED. POSSIBLE ACQUISITION RADAR SITE REVETTED AND NET-COVERED.

MARIEL SAM SITE 2300N 08249W  
2.8 NM WNW OF MARIEL AIRFIELD AT 23-00-55N  
082-49-30W.

EDD D  
WER [initials]  
KB [initials]  
RLP [initials]  
RDO [initials]  
PAG \_\_\_\_\_  
NC \_\_\_\_\_  
SAH \_\_\_\_\_

SA-2 SAM SITE UNDER CONSTRUCTION. SIX UNRETTED LAUNCH POSITIONS WITH LAUNCHERS (2 LAUNCHERS HAVE CANVAS OR NET COVERING), FRUIT SET RADAR WITH 6 ASSOCIATED VANS, 6 MISSILE TRANSPORTERS WITH CANVAS-COVERED TRAILERS, APPROXIMATELY 20 VEHICLES, AND 2 TENTS.

MATANZAS SAM SITE 2301N 08129W  
5 NM ESE OF MATANZAS AT 23-01-50N  
081-29-14W.

SA-2 SAM SITE UNDER CONSTRUCTION. SIX UNRETTED LAUNCH POSITIONS WITH 6 LAUNCHERS. FRUIT SET RADAR INSTALLED WITH 4 ASSOCIATED VANS, 6 MISSILE TRANSPORTERS WITH CANVAS-COVERED TRAILERS, POSSIBLE ACQUISITION RADAR, AT LEAST 12 VANS OR VEHICLES. PROBABLE STAR CONFIGURATION.

SANTA CRUZ DEL NORTE SAM SITE 2309N 08156W  
.9 NM WSW OF SANTA CRUZ DEL NORTE AT  
23-09-02N 081-56-20W.

SA-2 SAM SITE IN AN EARLY STAGE OF CONSTRUCTION. GUIDANCE POSITION WITH CABLE TRENCHING EXTENDING TO INTENDED LAUNCH POSITIONS. ONE UNOCCUPIED LAUNCH POSITION. PARKING AREA CONTAINS 12 MISSILE TRANSPORTERS WITH CANVAS-COVERED TRAILERS, FRUIT SET RADAR, 6 MISSILE LAUNCHERS, AT LEAST 12 VANS AND NUMEROUS TRUCKS.

SAN JULIAN AIRFIELD SAM SITE 2205N 08408W  
.2 NM SE OF SAN JULIAN AIRFIELD RUNWAY  
INTERSECTION AT 22-05-28N 084-08-58W.

SA-2 SAM SITE UNDER CONSTRUCTION. SIX LAUNCHERS, 6 CANVAS-COVERED MISSILE TRAILERS, 6 VANS, AND 9 TENTS. FIVE LAUNCHERS IN PROCESS OF BEING RETTED. CENTRAL GUIDANCE AREA CONTAINING VANS AND PROBABLE FRUIT SET RADAR IS RETTED.

SANTA LUCIA SAM SITE 2243N 08349W  
8.4 NM NE OF SANTA LUCIA AT 22-43-40N  
083-49-50W.

SA-2 SAM SITE UNDER CONSTRUCTION. SIX UNRETTED LAUNCH POSITIONS WITH LAUNCHERS,

6 CANVAS-COVERED MISSILE TRAILERS, FRUIT SET  
RADAR, APPROXIMATELY 20 VEHICLES, AND 8  
TENTS. STAR CONFIGURATION.

SANTIAGO DE LAS VEGAS SAM ASSEMBLY AREA 2257N 08221W  
2 NM ESE OF SANTIAGO DE LAS VEGAS AT  
22-57-40N 082-21-30W.  
POSSIBLY AN INTERIM SAM ASSEMBLY AREA  
CONTAINING 34 MISSILE TRANSPORTERS (6 OF  
WHICH ARE CANVAS-COVERED), 5 MISSILE  
DOLLIES, 12 PROBABLE GUIDELINE MISSILES,  
12 PIECES OF HEAVY EQUIPMENT AND  
APPROXIMATELY 35 MISCELLANEOUS VEHICLES.  
EXTENSIVE OPEN STORAGE.  
HANDLING, STORAGE, AND CHECKOUT FACILITIES  
NORMALLY ASSOCIATED WITH SOVIET-TYPE SAM  
SUPPORT FACILITIES WERE NOT OBSERVED.

BANES AREA, SAM EQUIPMENT 2058N 07538W  
5 NM ENE OF BANES AT 20-58-50N 075-38-10W.  
SAM LAUNCH AND RADAR EQUIPMENT STORED IN  
OPEN AREA ADJACENT TO PROBABLE ELECTRONICS  
FACILITY.  
EQUIPMENT -- 8 MISSILE TRANSPORTERS WITH  
CANVAS-COVERED TRAILERS, 7 ELECTRONICS  
VANS AND 20 MISCELLANEOUS VEHICLES.

FINCA ITABO AREA, REPORTED MISSILE ACTIVITY 2236N 08005W  
NO NEW CONSTRUCTION OR MISSILE ACTIVITY  
NOTED WITHIN 10 NM RADIUS OF FINCA ITABO.

FINCA MALAGUE, REPORTED MISSILE ACTIVITY 2257N 08243W  
ONLY MISSILE ACTIVITY NOTED IN AREA IS  
MARIEL SA-2 SAM SITE (23-00N 082-49W),  
REPORTED SEPARATELY.

LIMONAR REPORTED MISSILE ACTIVITY 2255N 08124W  
1.2 NM SSE OF LIMONAR.  
ONLY MILITARY INSTALLATION NOTED IN AREA  
CONTAINS LARGE SCHOOL OR ADMINISTRATIVE  
BUILDING WITH 12 WINGS AND 2 LONG BUILDINGS  
AT REAR. APPROXIMATELY 100 VEHICLES  
THROUGHOUT AREA AND 20 ADDITIONAL VEHICLES  
IN CONVOY PARKED ON ENTRANCE ROAD. TWENTY-

FOUR LARGE TENTS AND 30 SMALL TENTS IN AREA.  
UNIDENTIFIED EARTH SCARS TO SE OF MAIN  
BUILDINGS.

SAGUA LA GRANDE AREA, REPORTED MISSILE ACTIVITY 2250N 08004W  
NO NEW CONSTRUCTION OR MISSILE ACTIVITY  
NOTED WITHIN 10 NM RADIUS OF SAGUA LA  
GRANDE.

SANCTI SPIRITUS AREA, REPORTED MISSILE ACTIVITY 2156N 07926W  
NO UNUSUAL CONSTRUCTION OR MISSILE ACTIVITY  
NOTED. INCOMPLETE INFORMATION.

VINALES AREA, REPORTED MISSILE ACTIVITY 2237N 08342W  
NO MISSILE-RELATED ACTIVITY NOTED WITHIN A  
10 NM RADIUS OF VINALES.

-AIRFIELDS-

ANTONIO MACEDO AIRFIELD 1958N 07550W  
AIRCRAFT -- 7 LIAISON.  
RUNWAYS SERVICEABLE. NO SIGNIFICANT  
CHANGES IN FACILITIES OR DEFENSES SINCE

25X1D

CAMAGUEY INTERNATIONAL AIRFIELD 2125N 07751W  
AIRCRAFT -- TOTAL OF 18, INCLUDING 14 FAGOT/  
FRESCO, 2 LIAISON, ONE CAB AND ONE CRATE.  
NO SIGNIFICANT CHANGE IN FACILITIES SINCE  
INCOMPLETE INFORMATION.

25X1D

CAMPO LIBERTAD AIRFIELD 2306N 08226W  
AIRCRAFT -- TOTAL OF 28 INCLUDING ONE PBY,  
8 BRIGADYR, 2 LIAISON, 2 MORAVA, 5 ZLIN  
TRENER, AND 10 DERELICT.  
NO APPARENT CHANGE IN FACILITIES SINCE

25X1D

HOLGUIN AIRFIELD 2048N 07618W  
RUNWAY AND TAXIWAY APPEAR SERVICEABLE.  
CONSTRUCTION ON FACILITIES CONTINUES.  
AIRCRAFT -- NONE.

JOSE MARTI INTERNATIONAL AIRFIELD 2300N 08224W  
AIRCRAFT -- TOTAL OF 36, INCLUDING 3  
CONSTELLATION, 4 BRITANNIA, 5 C-47, 8 CRATE,  
ONE PROBABLE C-54, ONE C-45, ONE CESSNA 310,  
ONE B-26, 4 LIAISON, 2 BRIGADYR AND 6  
DERELICTS. TWO AIRCRAFT FUSELAGES.  
NO CHANGE IN DEFENSES OR FACILITIES SINCE  
[REDACTED]

25X1D

LOS CANOS AIRFIELD 2004N 07509W  
NO APPARENT CHANGE SINCE [REDACTED]  
AIRCRAFT -- NONE.  
INCOMPLETE INFORMATION.

25X1D

MANAGUA AIRFIELD 2258N 08217W  
APPROXIMATELY 6,800 FT OF 8,000 FT RUNWAY  
APPEARS SERVICEABLE. NE END OF RUNWAY STILL  
UNDER CONSTRUCTION.  
AIRCRAFT -- NONE.

PLAYA BARACOA AIRFIELD 2302N 08235W  
AIRCRAFT -- A TOTAL OF 13, INCLUDING 5 HARE,  
6 HOUND (ONE WITHOUT ROTORS), ONE C-47, ONE  
SINGLE-ENGINE DERELICT.  
FACILITIES -- ONE BUILDING 40 X 60 FT UNDER  
CONSTRUCTION ON SOUTH END OF AIRFIELD.  
DEFENSES -- AAA POSITIONS PREVIOUSLY NOTED  
ARE UNOCCUPIED. THREE ADDITIONAL GUN  
POSITIONS ARE UNDER CONSTRUCTION SOUTH OF  
SSW END OF RUNWAY.  
NO OTHER CHANGES IN FACILITIES SINCE EARLY  
[REDACTED] SQUARE SHIPPING CRATES AND TENTS/  
SHELTERS ARE STILL PRESENT.

25X1D

PRESTON AIRFIELD 2044N 07540W  
RUNWAY DETERIORATING AND UNSERVICEABLE.  
AIRCRAFT -- NONE.

25X1D  
SAN ANTONIO DE LOS BANOS AIRFIELD 2252N 08231W  
AIRCRAFT -- TOTAL OF 39, INCLUDING (16) FAGOT/  
FRESCO, 2 POSSIBLE MIDGET, 12 B-26 (2  
POSSIBLE DERELICTS) 2 T-33, 2 PROBABLE T-6,  
4 SINGLE-ENGINE FIGHTERS, AND ONE HOUND.  
NO APPARENT CHANGE IN FACILITIES SINCE  
[REDACTED]  
NO TROOP CONCENTRATION NOTED.

SANTA CLARA INTERNATIONAL AIRFIELD 2229N 07955W  
AIRCRAFT -- TOTAL OF 7, INCLUDING (5) FAGOT/  
FRESCO, ONE HOUND, AND ONE HARE.  
SEVEN COMPLETED EARTH-COVERED REVETMENTS AND  
4 UNDER CONSTRUCTION AT WESTERN END OF  
AIRFIELD, AND 7 COMPLETED EARTH-COVERED  
REVETMENTS AT EASTERN END.

SIGUANEA AIRFIELD 2138N 08257W  
NO REPORT.

-MILITARY ACTIVITY-

25X1D  
CAMAGUEY AREA, MILITARY INSTALLATIONS 2123N 07755W  
INFORMATION ON THE CAMAGUEY MILITARY  
INSTALLATIONS IS AS FOLLOWS -- MILITARY  
HEADQUARTERS LOCATED IN NE SECTION OF  
CAMAGUEY, 1.8 NM SW OF SW END OF  
INTERNATIONAL AIRPORT RUNWAY -- NO APPARENT  
CHANGE SINCE [REDACTED] INCOMPLETE  
INFORMATION.  
MILITARY TRAINING INSTALLATION 3.5 NM NNE OF  
CAMAGUEY AT SITE OF FORMER BERNABE SANCHEZ  
ADAN AIRFIELD -- INCOMPLETE INFORMATION.  
ARTILLERY TRAINING AREA 7 NM ESE OF  
CAMAGUEY -- NO REPORT.  
MILITARY TRAINING AREA LOCATED 4.5 NM ESE OF  
CAMAGUEY -- NO REPORT.  
MILITARY BARRACKS AREA 5.5 NM ESE OF  
CAMAGUEY AT EL PENON -- NO REPORT.  
MILITARY AREA LOCATED 7.5 NM SSW OF  
CAMAGUEY -- INCOMPLETE INFORMATION.

CEIBA MOCHA AREA, MILITARY ACTIVITY 2257N 08142W  
NO APPARENT MILITARY ACTIVITY NOTED.

MADRUGA AREA, PROBABLE MILITARY INSTALLATION 2255N 08150W  
1.6 NM ENE OF MADRUGA.  
CONTAINS 5 BARRACKS, 3 SUPPORT BUILDINGS,  
APPROXIMATELY 25 CANVAS-COVERED PROBABLE  
TRAILERS, APPROXIMATELY 30 MISCELLANEOUS  
VEHICLES AND LUMBER. AT LEAST 25 OTHER  
PROBABLE TRAILERS IN VALLEY SE OF MADRUGA.

CONSOLACION DEL SUR, MILITARY ACTIVITY 2232N 08332W  
NO MILITARY ACTIVITY NOTED.

EL CRISTO, MILITARY INSTALLATION 2007N 07546W  
SIX FA PIECES IN TRAINING AREA 2 NM NW OF  
EL CRISTO.  
NO OTHER SIGNIFICANT CHANGES NOTED SINCE  
[REDACTED]

25X1D

HOLGUIN AREA, MILITARY MOTOR POOL 2052N 07616W  
APPROXIMATELY 100 CONTAINERS IN OPEN  
STORAGE. NO TROOP CONCENTRATIONS NOTED.  
VEHICLES -- ABOUT 250 SMALL VEHICLES IN  
PARKING AREA.

JOVELLANOS, MILITARY INSTALLATION 2248N 08112W  
NO MILITARY ACTIVITY NOTED.

LA ESPERANZA - MARIEL 2301N 08245W  
SEE BAHIA HONDA SAM SITE.

LOS INDIOS, MILITARY ACTIVITY 2031N 07606W  
NO MISSILE ACTIVITY NOTED.

25X1D

MANAGUA MILITARY INSTALLATION 2258N 08217W  
DEFENSES -- NO CHANGE SINCE [REDACTED]  
CONSTRUCTION SOUTH OF HILLS CONTINUING.  
NO APPARENT CHANGE IN FACILITIES SINCE  
[REDACTED]

25X1D

VEHICLES -- APPROXIMATELY 350 VEHICLES

THROUGHOUT AREA.

PALMA SORIANO AREA, PROBABLE VEHICLE DEPOT 2010N 07557W  
NO REPORT.

TORRENS REFORMATORY, MILITARY CONCENTRATIONS 2259N 08228W  
MILITARY EQUIPMENT AT AND NEAR TORRENS  
REFORMATORY INCLUDES --  
SURROUNDING REFORMATORY ARE 31 TENTS, 31  
UNIDENTIFIED VEHICLES, 64 MEDIUM TRUCKS AND  
8 SMALL TRUCKS (POSSIBLY JEEPS).  
500 YDS SOUTH OF REFORMATORY ARE 4 BARRACKS-  
TYPE BUILDINGS, ONE OTHER BUILDING, 5 TENTS,  
28 UNIDENTIFIED VEHICLES AND 93 MEDIUM  
TRUCKS.  
1,000 YDS SOUTH OF REFORMATORY ARE 3 TENTS,  
6 MEDIUM TRUCKS, 14 LARGE TRUCKS, 9 TRAILERS  
AND UNIDENTIFIED VEHICLES.  
1.8 NM SSE OF REFORMATORY ARE 15 TENTS, 56  
MEDIUM TRUCKS, 6 LARGE TRUCKS, 3 CANVAS-  
COVERED VEHICLES AND 10 CRATES.  
.3 NM SOUTH OF EL CANO ARE APPROXIMATELY 15  
TRUCKS PARKED AT ROADSIDE UNDER TREES.  
AT CAPDEVILA (23-02-56N 082-24-15W) THERE  
ARE VARIOUS CRATES AND POSSIBLE VANS IN  
OPEN STORAGE.  
SIX BUILDINGS ARE UNDER CONSTRUCTION  
.8 NM EAST OF EL CANO (AT 23-01-45N  
082-26-40W), AND A 65 X 30 FT BUILDING IS  
UNDER CONSTRUCTION NORTH OF RANCHO BOYEROS  
(AT 23-01-10N 082-24-00W).

25X1D  
SAN JOSE DE LAS LAJAS, POSSIBLE MILITARY SITE 2256N 08211W  
NO APPARENT CHANGE IN FACILITIES OR DEFENSES  
SINCE [REDACTED]  
INCOMPLETE INFORMATION.

MARIEL AREA, MILITARY INSTALLATION 2300N 08250W  
1,200 YDS WEST OF MARIEL SA-2 SITE IS A  
HEADQUARTERS AREA CONSISTING OF 4 ONE-STORY  
BUILDINGS AND A STORAGE AREA WITH 11 STORAGE  
BUILDINGS AND ONE H-SHAPED BUILDING.  
VEHICLES -- SEVENTEEN SMALL TRUCKS, 3 LARGE  
TRAILERS, 13 JEEPS, 12 LARGE TRUCKS, 11  
SMALL TRAILERS, 16 POSSIBLE ARMORED CARS,



6 LARGE AND NUMEROUS SMALL CRATES, 8 TENTS,  
AND 20 UNIDENTIFIED VEHICLES IN OPEN STORAGE  
AREA.

VESSELS -- 4 PATROL CRAFT AT ANCHOR IN  
ARROYO DONA MARIA, 3 ARE APPROXIMATELY  
60 X 10 FT AND ONE 50 X 10 FT.

-GUANTANAMO AREA-

25X1D

GUANTANAMO AREA, DEFENSES 2005N 07510W  
NO APPARENT CHANGE SINCE EARLY [REDACTED]  
INCOMPLETE INFORMATION.

-ELECTRONICS/COMMUNICATIONS-

BANES AREA, PROBABLE ELECTRONICS SITE 2058N 07538W  
5 NM ENE OF BANES.

SITE CONTAINS 2 LARGE AND 2 SMALL REVETMENTS  
WITH EQUIPMENT, 5 ADDITIONAL GENERATOR OR  
VEHICLE REVETMENTS, AND ABOUT 30 TENTS.

CARABALLO, PROBABLE RADAR SITE 2303N 08145W  
.6 NM SE OF CARABALLO.

SEVERAL VANS IN EARTHEN EMPLACEMENTS, WITH  
PROBABLE RADAR ANTENNA NEAR CENTER OF SITE  
AND BARRACKS-TYPE BUILDINGS FOR PERSONNEL.

CAYO ESQUIVEL DEL SUR, REPORTED ELECTRONICS 2303N 08004W  
NO REPORT.

-PORTS & HARBORS-

25X1D

ANTILLA, PORT FACILITIES 2049N 07544W  
LOGISTICS -- APPROXIMATELY 123 UNITS OF  
ROLLING STOCK.

FACILITIES -- NO CHANGE SINCE [REDACTED].  
VESSELS -- SEVERAL SMALL CRAFT.

25X1D

CABANAS, PORT FACILITIES 2259N 08256W  
VESSELS -- NONE OBSERVED IN HARBOR.  
NO CHANGE IN PORT FACILITIES SINCE [REDACTED].

PAR 763-62

CASILDA, PORT FACILITIES 2145N 07959W  
2.5 NM SOUTH OF TRINIDAD.  
VESSEL OBSERVED OFF-LOADING MATERIEL.  
VEHICLES/EQUIPMENT -- 5 TANKS, 18 TANKS OR  
SP GUNS, 16 UNIDENTIFIED VEHICLES, AND  
APPROXIMATELY 20 TRUCKS IN IMMEDIATE  
VICINITY OF WHARF. APPROXIMATELY 10  
UNIDENTIFIED PIECES OF EQUIPMENT ON LARGE  
CARGO VESSEL AT PIER.

25X1D  
BARACOA, PORT FACILITIES 2021N 07430W  
DEFENSES -- MINOR TRENCHING ON FUERTE DE LA  
PUNTA AND WEST OF TOWN.  
NO APPARENT CHANGE IN FACILITIES SINCE  
[REDACTED]  
VESSELS -- SEVERAL SMALL CRAFT.

25X1D  
CIENFUEGOS, PORT FACILITIES 2209N 08027W  
NO APPARENT CHANGE IN PORT FACILITIES SINCE  
[REDACTED]  
VESSELS -- 3 FREIGHTERS OFF-LOADING AT  
TORRIENTE PIER AND DONESTEVEZ WHARF  
(ENSENADA MARSILLAN), ONE FREIGHTER AT  
ANCHOR IN BAHIA DE CIENFUEGOS, 4 PT BOATS  
AND ONE KRONSTADT-CLASS PC AT NAVAL BASE.

CORTES, PORT FACILITIES 2203N 08400W  
INCOMPLETE INFORMATION.

HAVANA, PORT FACILITIES 2308N 08221W  
VESSELS -- A TOTAL OF 35 CARGO/TANKERS, 3  
EX-US-PF, 2 PT BOATS AND 3 PC AS FOLLOWS --  
ONE FREIGHTER AT COAL WHARF NO 2. TWO  
LIGHTERS AND 3 UNIDENTIFIED VESSELS AT GAMIZ  
BOATYARD. SEVEN FREIGHTERS AND 3 PC  
AT PALMER PIER. ONE TANKER WITH 21  
CYLINDRICAL TANK CARS ON DECK AND ONE  
LIGHTER AT ESSO PIER. ONE FREIGHTER AT  
EDIFICIO QUAY NO 1. ONE FREIGHTER AT REGLA  
PIER 34. ONE FREIGHTER AT BEGUIRISTAIN  
WHARF. FIVE FREIGHTERS AND ONE TANKER AT  
CAYO CRUZ. ONE COASTAL FREIGHTER AT POTE  
QUAY. ONE FREIGHTER AT ATARES FRUIT WHARF  
AND ONE AT VACCARO WHARF. THREE FREIGHTERS  
AT WARD LINE PIER AND WHARF. TWO SMALL

PAR 763-62

FREIGHTERS AT UNITED FRUIT COMPANY PIER AND WHARF. ONE FREIGHTER AT HAVANA CENTRAL PIER. ONE SMALL FREIGHTER AT PAULA PIER NO 3. THREE US PF-TYPE VESSELS AT PAULA PIER NO 1. ONE FREIGHTER AT SANTA CLARA PIER. ONE FREIGHTER AT MACHINA PIER. ONE FREIGHTER AND ONE PASSENGER/CARGO VESSEL AT SAN FRANCISCO PIER. TWO PT AT INTERNATIONAL YACHT CLUB PIER. TWO BARGES, 3 FREIGHTERS AND VARIOUS SMALL CRAFT IN HARBOR. NO APPARENT CONCENTRATIONS OF MILITARY EQUIPMENT OR SUPPLY STOCKPILES IN HARBOR AREA.

LA COLOMA, PORT FACILITIES 2214N 08334W  
NO CHANGE IN FACILITIES SINCE MAR 62.  
VESSELS -- APPROXIMATELY 80 SMALL CRAFT.

LA ISABELA, PORT FACILITIES 2256N 08001W  
VESSELS -- ONE TANKER, ONE LARGE AND ONE SMALL FREIGHTER.  
INCOMPLETE INFORMATION.

MANZANILLO, PORT FACILITIES 2021N 07707W  
VESSELS -- 13 BARGES AND NUMEROUS SMALL CRAFT IN HARBOR.  
NO CHANGE IN FACILITIES SINCE [REDACTED]

25X1D

MARIEL NAVAL PORT 2301N 08245W  
VESSELS -- 13 PT BOATS MOORED NORTH AND SOUTH OF AIRFIELD OF WHICH 7 ARE KOMAR-CLASS (GUIDED MISSILE BOATS) AND ONE IS PROBABLY IN PROCESS OF CONVERSION. ONE UNIDENTIFIED VESSEL SW OF NAVAL PIER AND ONE UNIDENTIFIED VESSEL, APPROXIMATELY 270 X 50 FT, AT NAVAL PIER. ONE FREIGHTER AT MARIEL PIER WITH 11 LARGE TRUCKS, 14 MEDIUM TRUCKS AND UNIDENTIFIED MATERIAL ON PIER. TWENTY-FOUR CRATES (24 X 8 FT) AND 16 TRUCKS ON APRON AT AIRFIELD.

25X1D

MATANZAS, PORT FACILITIES 2303N 08134W  
VESSELS -- ONE FREIGHTER DOCKED AT MOLASSES  
PIER.  
VEHICLES -- APPROXIMATELY 22 TRUCKS PARKED  
AT DUBROCC WHARF.  
NO SIGNIFICANT CHANGE IN FACILITIES SINCE  
[REDACTED].

MOA AREA, PORT FACILITIES 2039N 07454W  
VEHICLES -- ONE LARGE FREIGHTER AND 2 BARGES  
IN HARBOR.  
FACILITIES -- 11 HORIZONTAL TANKS, 8  
VERTICAL TANKS (ONE IN FINAL STAGE OF  
CONSTRUCTION), 4 CRANES AND ONE FLOATING  
CRANE IN PORT AREA. ONE NEW WAREHOUSE UNDER  
CONSTRUCTION NEAR EAST WHARF. LARGE  
QUANTITIES OF MATERIAL IN OPEN STORAGE.  
ROADS HAVE BEEN IMPROVED.

NUEVA GERONA, PORT FACILITIES 2153N 08248W  
NO REPORT.

NUEVITAS, PORT FACILITIES 2132N 07716W  
NO REPORT.

25X1D

PRESTON, PORT FACILITIES 2046N 07539W  
NO APPARENT CHANGE IN FACILITIES SINCE  
[REDACTED]  
VESSELS -- ONE TANKER AT PIER.

SANTIAGO DE CUBA PORT 2001N 07550W  
VESSELS -- 2 LARGE FREIGHTERS, 3 SMALL  
FREIGHTERS.  
INCOMPLETE INFORMATION.

SURGIDERO DE BATABANO NAVAL PORT 2241N 08218W  
NO REPORT.

~~SECRET~~  
NO FOREIGN DISSEM

PAR 763-62

-MISCELLANEOUS-

MINAS DE MATAHAMBRE, COPPER MINES AND MILL 2235N 08356W  
ONE NM NORTH OF MINAS DE MATAHAMBRE.  
NO MILITARY ACTIVITY NOTED.  
MEDIUM-SIZED PIT MINE AT MATAHAMBRE WITH  
LARGE ORE-CRUSHING PLANT, 10 MEDIUM-SIZED  
BUILDINGS AND APPROXIMATELY 12 SMALLER  
BUILDINGS. INSTALLATION IS ROAD SERVED AND  
IS CONNECTED BY AN OVERHEAD BUCKET CONVEYOR  
SYSTEM TO SANTA LUCIA PORT.

~~SECRET~~  
NO FOREIGN DISSEM

TOP SECRET

Approved For Release 2001/03/06 : CIA-RDP89B00569R000700090001-8

TOP SECRET

**Mission Plot Overlay**  
 Max No 5000  
 Date 19 Aug 62  
 System 22, 22 - 2X  
 Control 1, 1, 1  
 Map Ref JN 05, 04, 03  
 DS No 162707

Naval Service - 401st Bomb Group  
 2000 20 00 00 00 00 00  
 K. On. on 21 5 PM  
 This is taken, the distance to Point, Enter Number

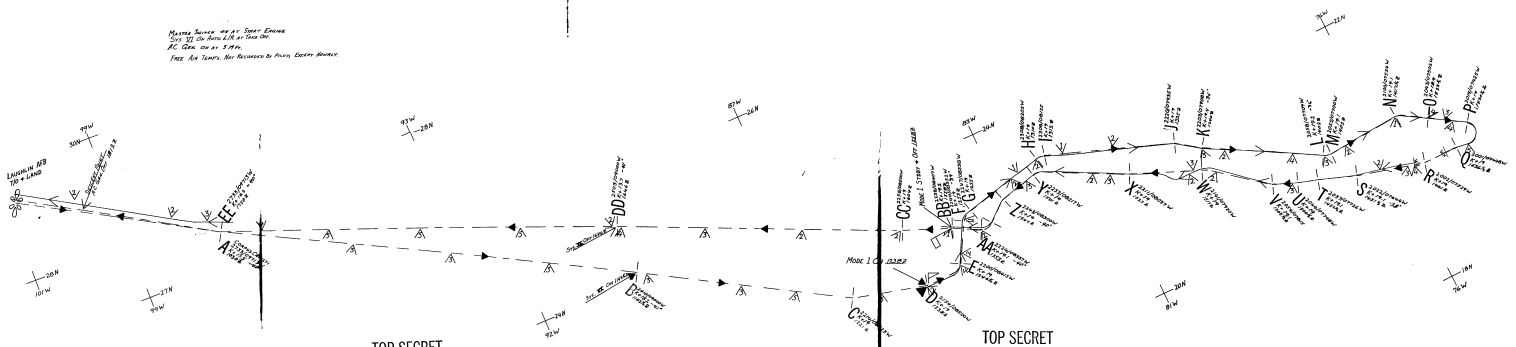

TOP SECRET

Approved For Release 2001/03/06 : CIA-RDP89B00569R000700090001-8

TOP SECRET

TOP SECRET

Approved For Release 2001/03/06 : CIA-RDP89B00569R000700090001-8

TOP SECRET

MISSION PLOT Overlay

Mission No 3088  
Date 19 Aug 62  
System JF-17 - JK  
Country S-7  
Map No JA 85, 04 # 8  
TSS No 162712

Master Station On Air Since 0800  
Call Sign: 100-100-100  
AC: 100-100-100  
Fuel: 100-100-100

TOP SECRET

Approved For Release 2001/03/06 : CIA-RDP89B00569R000700090001-8

TOP SECRET

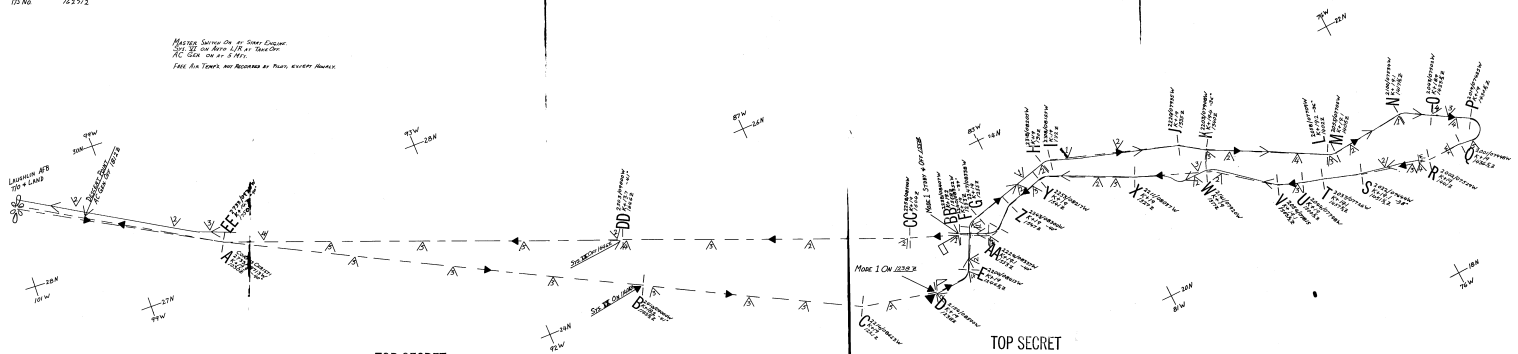

Approved For Release 2001/03/06 : CIA-RDP89B00569R000700090001-8

TOP SECRET CRESS

TOP SECRET  
TOP SECRET CRESS

TOP SECRET CRESS

MISSION PLOT OVERLAY  
Msn Nr 301F  
Date 29/11/62  
Systems 3.049  
Config. 81T  
Map Ref. JN 4644T  
TIS No. 162764

HC 1234  
11614 OIT: AT  
SY. XI OM: AT

74W  
723N  
71N

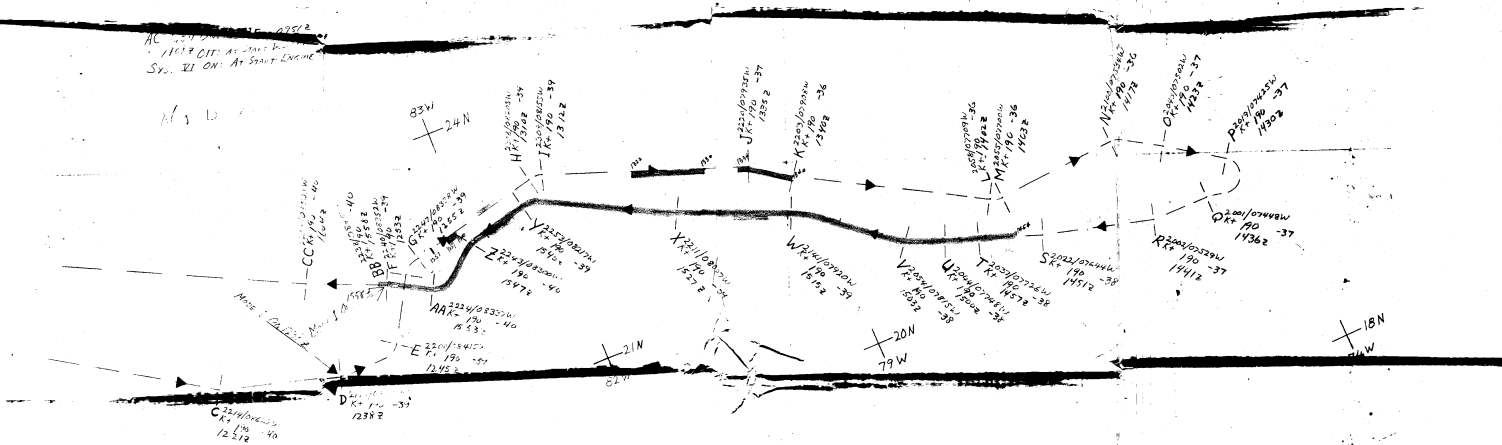

LEGEND.

TOP SECRET CRESS

25X1A



TOP SECRET CRESS  
TOP SECRET

TOP SECRET CRESS