

Project 8003a #14  
Division CCC 58  
15/400 Apr 80

- back to motor pool
- Gate, double fence
- Tgt time 1000, 15 Apr 80 → proceed
- field artillery piece - 122mm D-30
- near vehicle park - another separate area
- Large "Storage" type ~~door~~ light from roof →  
a clear stone type bldg or windows  
up near roof.
- assembly line - machinery, tools all  
around. Conveyor type. associate  
w/ some type of vehicle.
- describe relative position inside
- exact center
- move to NE most end; describe
- Cradle - like garage type door - outdoor to  
storage - things moved out to storage
- moved into big open area in NE corner  
large bldg inside large bldg like  
of a quality control
- describe function
- equipment is finalized completed at  
this point. whatever is being put  
together is finished at this point
- move back to 1st area.
- conveyor belt, slow moving, people  
on each side
- move and describe finished product
- vehicle w/ large tires not tracks  
Sels BTR-60

CCCSB-M

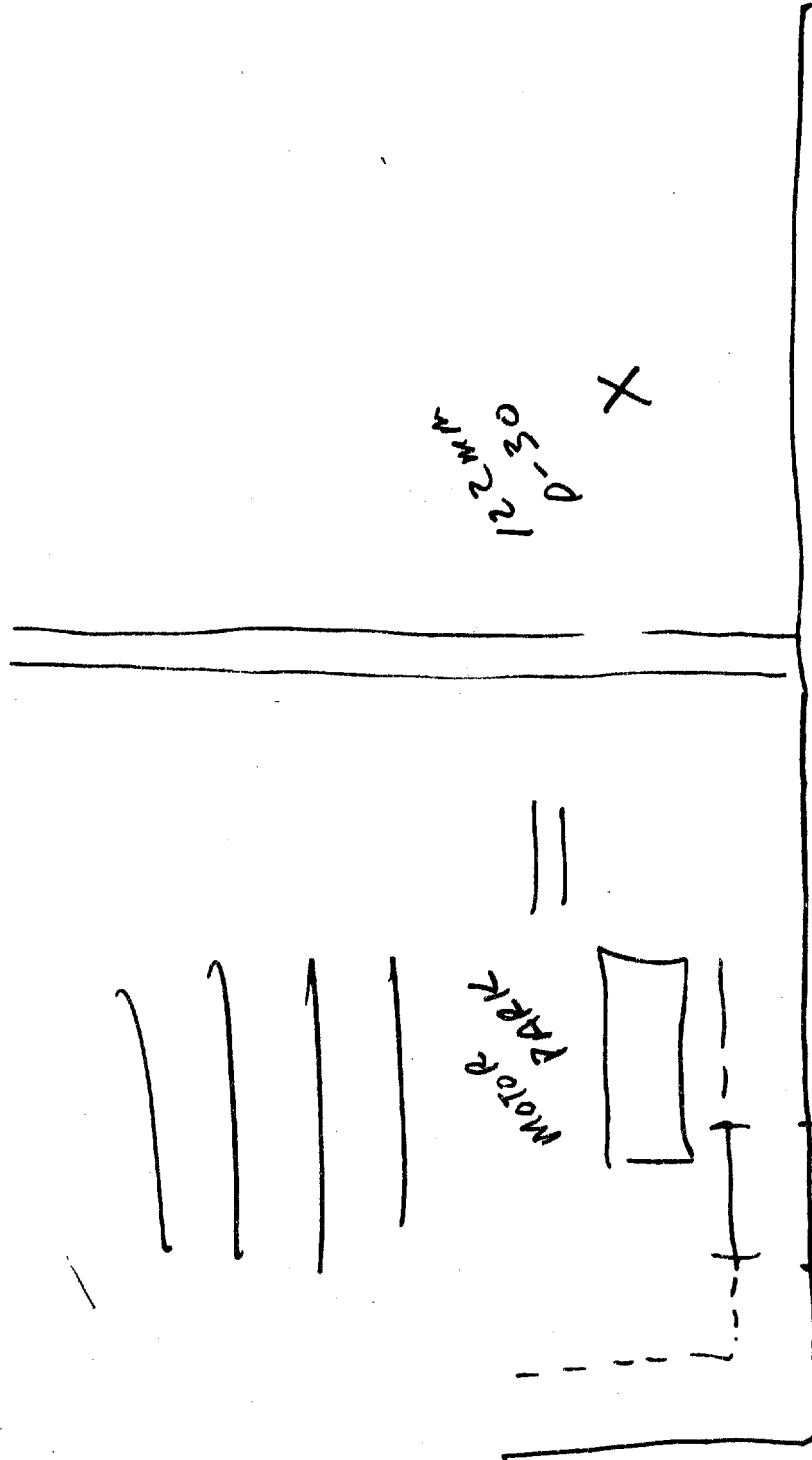

58-M

2

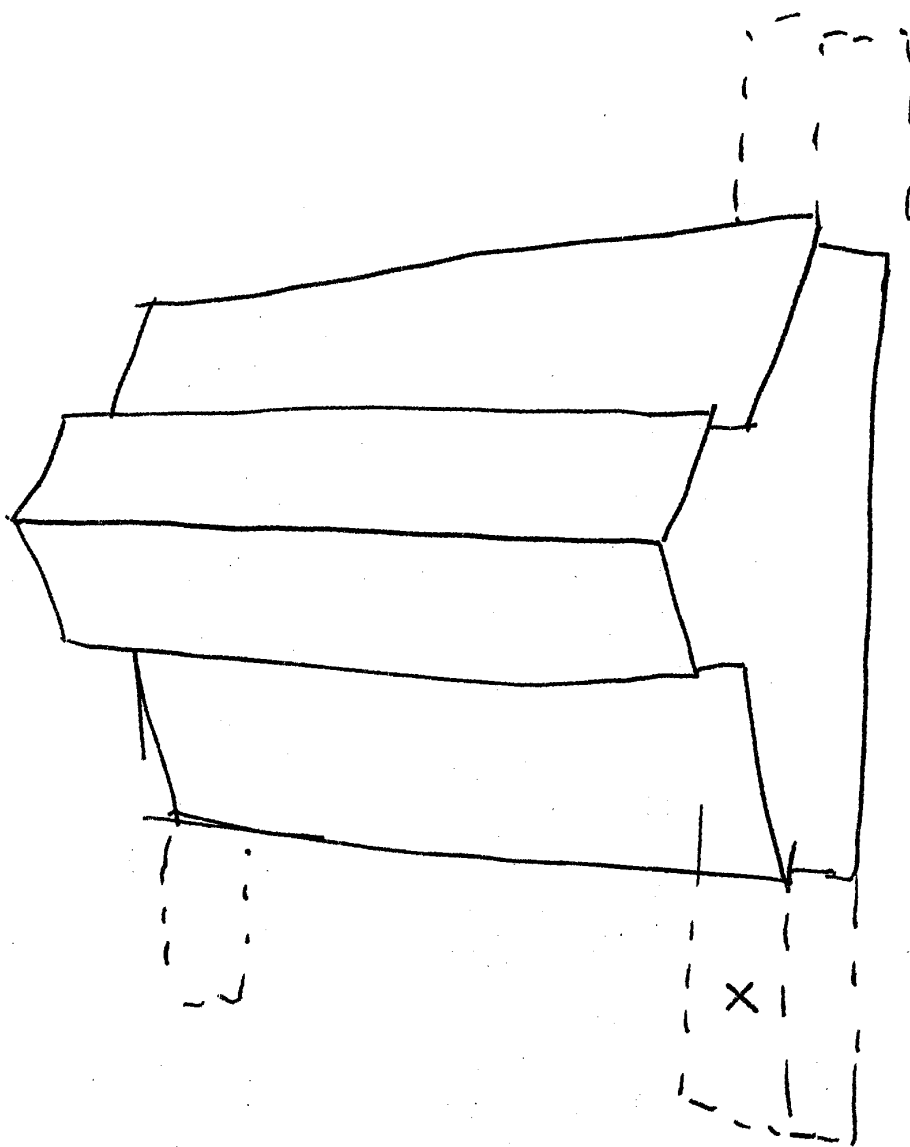

(B)

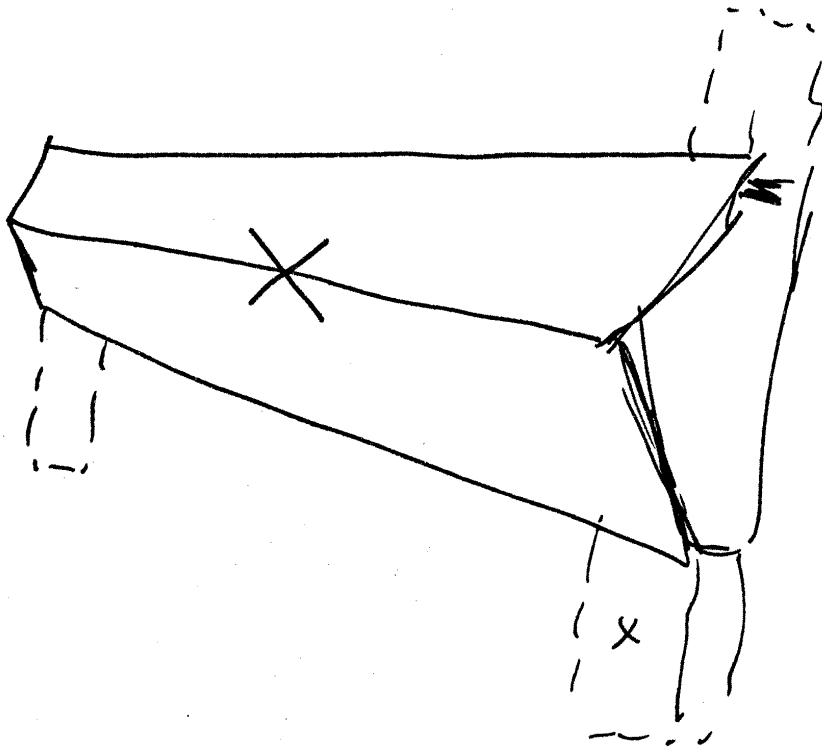

Approved For Release 2000/08/07 : CIA-RDP96-00788R000200540011-0



Approved For Release 2000/08/07 : CIA-RDP96-00788R000200540011-0

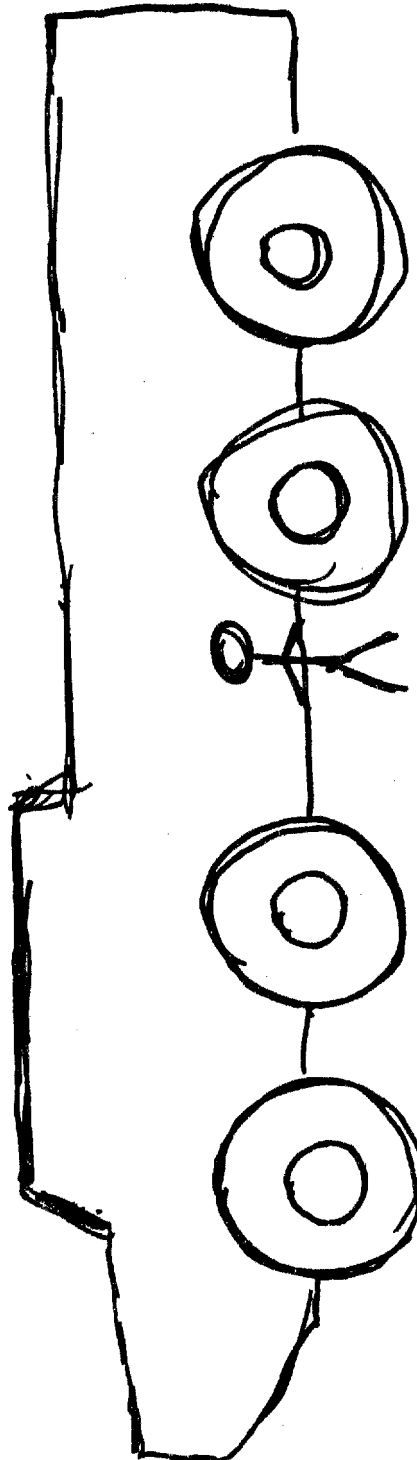

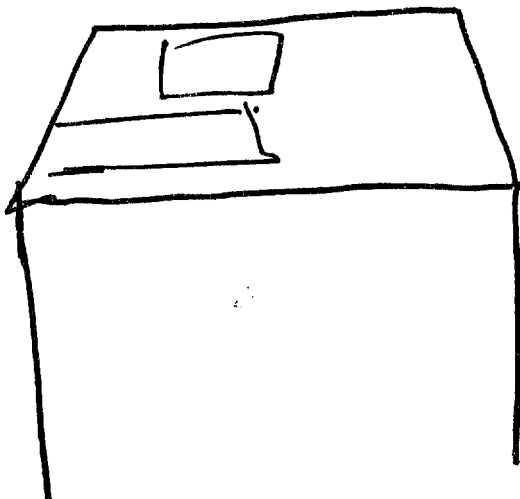
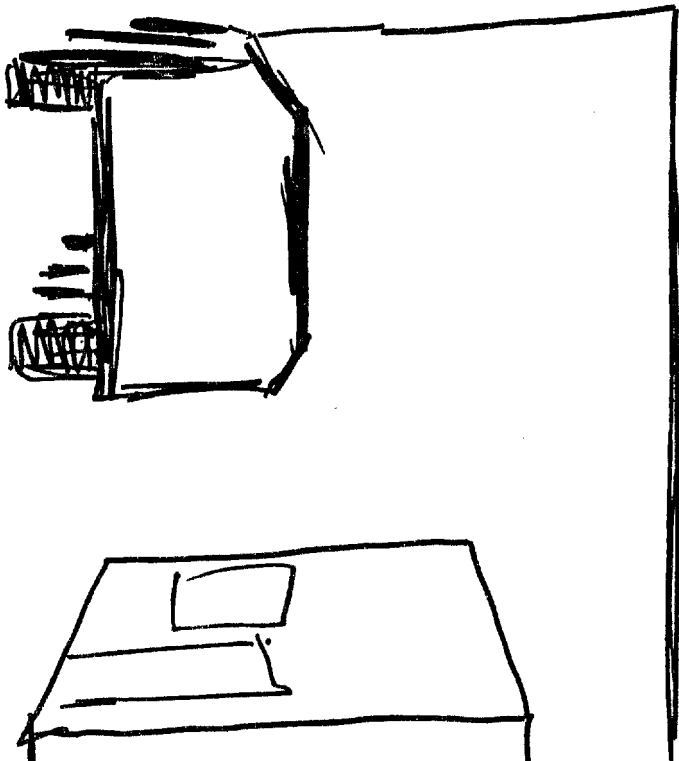
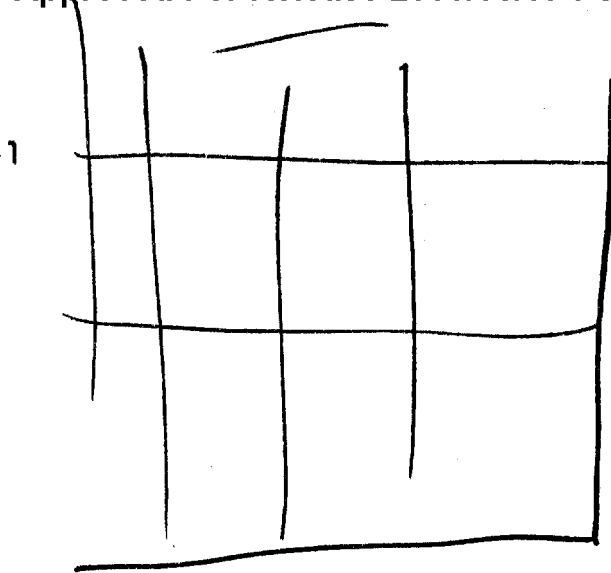

(7)





ccc



												I
												H
												G
												F
					E-7							E
		4	.	.	.							D
												C
												B
12	11	10	9	8	7	6	5	4	3	2	1	A