

~~SECRET~~

INSCOM  
GRILL FLAME  
PROGRAM

SESSION REPORT

*GF-055-81*

CLASSIFIED BY:MSG,DAMI-ISH

DATED: 051630ZJUL78

NOT RELEASABLE TO FOREIGN NATIONALS REVIEW ON: *July 2001*

~~SECRET~~

GRILL FLAME

*Copy 1 of 2 copies*

~~SECRET~~

SUMMARY ANALYSIS

REMOTE VIEWING (RV) SESSION DCC-86

1. (S/NOFORN) This report documents a remote viewing session conducted in compliance with a request for information.
2. (S/NOFORN) The remote viewer's impressions of the target are provided as raw intelligence data, and as such, have not been subjected to any intermediate analysis, evaluation or collation. Interpretation and use of the information provided is the responsibility of the requestor.
3. (S/NOFORN) The protocol used for this session is detailed in the document Grill Flame Protocol, AMSAA Applied Remote Viewing Protocol (S), undated.
4. (S/NOFORN) Following is a transcript of the viewer's impressions during the remote viewing session. At TAB A are drawings made by the remote viewer reference his impressions of the target site. At TAB B is target cuing information provided the remote viewer.

NOT RELEASABLE TO FOREIGN NATIONALS

~~SECRET~~  
URCON

~~SECRET~~

TRANSCRIPT

REMOTE VIEWING (RV) SESSION DCC-86

TIME

#14: This will be a remote viewing session for 8 July 1981; mission time is 0900 hours.

#01: Test.

#14: This will be a pre-mission briefing. All right #01, you've looked at this picture here of this *building* which of course you should be familiar with, you've been there before. And what we'll be doing is going back to this building. We'll start from there, we'll get further instructions.

#01: Okay.

0900 #14: All right #01, the time is now 0900 hours. I want you now to focus on the building in the photograph. I would like you to project your awareness to this building, and once again locate [REDACTED] I would like you to begin by standing in the hallway at the door [REDACTED] When you are there, please let me know...

SG1A  
SG1A

#01: Okay.

#14: As you look through the doorway I'd like you to look around from your left to your right, and very briefly describe what you see.

+01 #01: See a light colored wall..kind of a funny door... Another bright wall, some kind of metallic wall.. That's all I see. A hallway goes in both directions.

SG1A

#14: Okay. At this time I'd like you to move your awareness into [REDACTED] just inside the door. What do you see to your left?

+03 #01: I'm standing in a lab room. To my left there, uh...some kind of a..design type tables. Uh, construction type tables..like design technicians or engineers would use. Some cabinets there as well, security cabinets... Behind that's just a..black wall with looks like two more doors.. That's all I have on my left.

#14: Okay. I'd like you to look straight ahead, look straight ahead and describe what you see from the door.

#01: I have like the ends of long tables..extend off to the right. And there's equipment like sitting on these tables, some tools.. some objects, range in size from component elements, uh, maybe

~~SECRET~~

~~SECRET~~

#01: the size of cigarette packs and up.. Larger sizes are, uh.. like tubes with boxes fastened to them. Get an impression of heavy black cable. It's a big test bench or something.. long tables..design test bench.

+06  
+07

I'm seeing what looks like reflecting mirrors or..some kinda optical mirrors. I just get a feeling of reflection... Feel I'm in a..bright, bright light. Some kinda different color. I got cables going to a, uh..like mini elements, mini computers. Some kinda digitalized..digitalized type computer elements, the old black boxes type things. Some kind of electronics. I'm tryin' to..I can't put it together. It's like part of this stuff is taken apart, or is being built. I get a feeling for like bread board effect, something temporarily constructed for testing.. Very refined measurement. It's like a emission and collection system, like the- I don't know what it is, but it emits and collects at the same time.

+09

+10

Keep getting this very dark chamber with ~~in~~ descent specks of light. And the refelection's like all the colors of the rainbow.. Tense, it's like looking at stars. As a matter of fact there's black glass, thick black glass. Uh, think that might be some kind of shielding. I get a feeling for shielding.

#14: Okay #01, look to your right. What do you perceive as being on your right?

+11

+12

#01: Metal parts cabinets, storage bins.. Some cross-hatch design of some kind..grid or screening or something. Other doors... this would be like a large power panel or something in the corner. Heavy black cables again with gray squares and big switches... Get a feeling like this is like the..the core element of a larger lab effort... This is more the physics element, like the..build and display part. The center, the central area. I don't know how to explain that.... Hold on a minute. I'm losin' it, I gotta get... Just a minute.

#14: Okay, take your time.

PAUSE

+15

+16

#01: Okay. I'm getting, uh..flashes of what looked like circular scopes..some kind of a...some kind of electrical, uh, optical type displays, varying sizes. These are somehow tied into, uh.. stars, the lights. Very refined, uh, targeting or measurement type devices. Keep getting these- I don't know what to call 'em, they're..it's like..light slashes or..ribbons..light slashes. They're like light beams, they're turnin' sideways as they go away. Very thin... These, uh...it's coming out of very small elements, so I don't..surprisingly small. Keep tryin' to find a color and I can't.

#14: Okay #01, I want you to relax now. I want you to refocus, refocus yourself to the hallway once again, outside [REDACTED] SG1A

~~SECRET~~

~~SECRET~~

#01: Okay.

#14: Look through the doorway [REDACTED]

SG1A

#01: Okay.

#14: Is this the same room that you have been describing?

#01: Get a feeling like there's two rooms. The, uh..think [REDACTED] has more..like the designer type furniture. It's like the engineering type room, but the..there's an adjacent room that has equipment in it. Get a feeling I'm passing through a steel wall between the two. For some reason this..the actual test room has to be shielded and it's very small compared to the [REDACTED]

SG1A

SG1A

SG1A

#14: Okay. As you're standing in the hallway imagining there's a window in the door [REDACTED] From the hallway what can you see?...

+19

#01: Just dividers..look like our dividers with the cloth..and, uh... keep seeing those table lamps, like the long arm, adjustable table lamps. Then they start breakin' on into, uh, like drawing tables..and miniature equipment, small equipment, components... Looks like some of those, uh, flat storage cabinets, security cabinets, like for maps and drawings... That's all I get. I'm just getting strong feelings of, uh, like laboratory feelings, experimental and constructive.

#14: Okay. Is there any other type of furniture, whether it be unusual or what you would normally see there or whatever, that you haven't described yet?

#01: Okay, just a minute..... I'm getting too much overlay, I'm inventing things.

#14: Okay. How would you describe the activity in this room at this time?

+22

#01: Uh, normal, workday type, uh, largest group of people talking would be two or three. Uh, engineer and staff type personnel moving around the room discussing elements of configuration or design.. Normal...

SG1A

#14: Okay. If you could put it all together, and ask yourself this question. Ask yourself, what is the function or purpose of this [REDACTED]

#01: Okay, give me a minute.

#14: Okay.

PAUSE

~~SECRET~~

~~SECRET~~

- +24 #01: I'd say, uh...developmental design and..and initial testing of some form of targeting or...light frequency type measurement devices... Having trouble with the reason for them though. I don't know- I keep mixing emission with collection for some reason... I keep getting electronic displays but I don't know if those are elemental to the devices or..or other test equipment. This place reminds me of a...reminds me of what you would see in like a, uh, project development scenario with a contractor... Like enhancements to existing devices, experimental development, that sort of thing...
- #14: Okay, I want you to focus your attention inwardly, and again ask yourself the question: what is it they are trying to develop?
- #01: Okay, just a minute.
- #14: We will wait.....
- +27 #01: I get this like, uh...it's like a, uh, anti-ray-ray type effect. It's like, uh, some kind of a ray is emitted and used for targeting, and what they're developing here is a device for like automatic defense against being targeted by such a device, along with its own capacity to target. Be like two tanks with, uh, with targeting lasers, and one..both have the same capability except what they're tryin' to develop, or one would be..when targeted by the other tank, the capacity to disrupt the other tanks targeting and target their own. That kind of- like a counter-counter-defense/offense against laser type, uh, weaponry. I don't know if it's a tank or not. I get a feeling for different kinds of, uh, armament. It's like a counter-counter ray type targeting device....
- #14: Okay #01, I have no further questions at this time. I'd like you to spend a few minutes engraving in your mind the layout of this room, the layout of this room, and I will be asking you to draw an overhead sketch of this room, and possibly putting in some of the items that you've been describing and locating them for us.
- #01: Okay. Just a minute... I get a feeling that the, uh..that this is a, this effort is, uh, service connected, like to Army, for instance. I get a, I get views of military type people as well as civilian, which is..new to the target. That's all I got.
- #14: Okay.
- Okay. We're now ready for debrief.
- #01: Okay. On page one, the one and only page, I've done as best as I can a rendition of the interior of this room. I had a lot of problems with this drawing because I think I was really in two rooms at the same time, and I was getting gestaltic impressions of bits and pieces of the room, but I, you know, I wasn't getting a visual overall view of this entire room. Essentially it consists of a left wall with a door in it, a right wall with two

~~SECRET~~

~~SECRET~~

#01: doors in it, something blocking the view as you go through the door, like an interior L-shaped wall or something. And there's dividers in there that divide up drafting tables, or desks, or some kinda table that has the, you know, the drafting type lamps fastened to it. And the security cabinets are in each of these little alcoves. It's like an area where engineers would go to do design work or discuss design work, that sort of thing. Back against one wall are work type benches. Against another wall are the map or drawing type security cabinets, you know those low, flat drawer type things. And, uh, in the middle of the room are like metal equipment tables with equipment or parts or pieces of said same on top. Uh, and then there's some desk in there somewhere.

Uh, purpose-wise I get the feeling that some form of laser or quasi-laser type optical device is brought in here and design work's being done to either upgrade it or develop new techniques in the use of these devices. It may even be that one-time devices are built here for some special purpose. But I get a feeling of a very tightly knit close group of people, each with their own area of expertise working together to either enhance or develop optic laser type precision implements or instruments. I don't get a feel for big ones. I get a feel for little ones, like these micro miniature jobbers. You know, the little black case with the tube sticking out the end. That sort of thing. I don't get a feel for whether it's purely laser emission or collection. You know, I get a feel for both, like they emit and collect, meaning targeting devices. Uh, I also get a feel for present development into some kind of counter laser optic type device here. Or they may be using our current technology to develop counter devices. But it's a design and development type room, if you will. Like a special group of people in advanced technology, and optic laser type devices. And it's also directly associated to U.S. Army. And the reason why I said that is I had a flash or impression of, uh, U.S. Army airfield, with helicopters on it. And that may be directly associated to this building in some way, but I'm not sure. It's just a flash that I had right at the end of the session. Uh, you know, I use that as an indicator that this is probably a U.S. Army type endeavor, and it may be just overlay. That's an impression that I had.

#14: Well, earlier in the session you had mentioned you had a feeling it was a..like working with a contractor.

#01: Yeah, right. Sort of a contractor type..facility. I don't.. I don't know if it's actually owned by the contractor, if they're supplying people or if it's a joint enterprise. But it's definitely a U.S. Army enterprise.

#14: Uh, okay. This is the hallway?

#01: Oh yeah, I'll mark the hallway on here.

#14: Okay.

~~SECRET~~

~~SECRET~~

#01: I said, you know..it would appear that..I just couldn't get an overall view of this room. It's like I was in two rooms at the same time. They're probably very adjacent to one another, or the function of what's going on in this room is directly tied into the second room, directly associated to the second room. Definitely a research laboratory type feeling though. That's essentially all I got.

#14: Okay. End of session.

~~SECRET~~



**TAB**

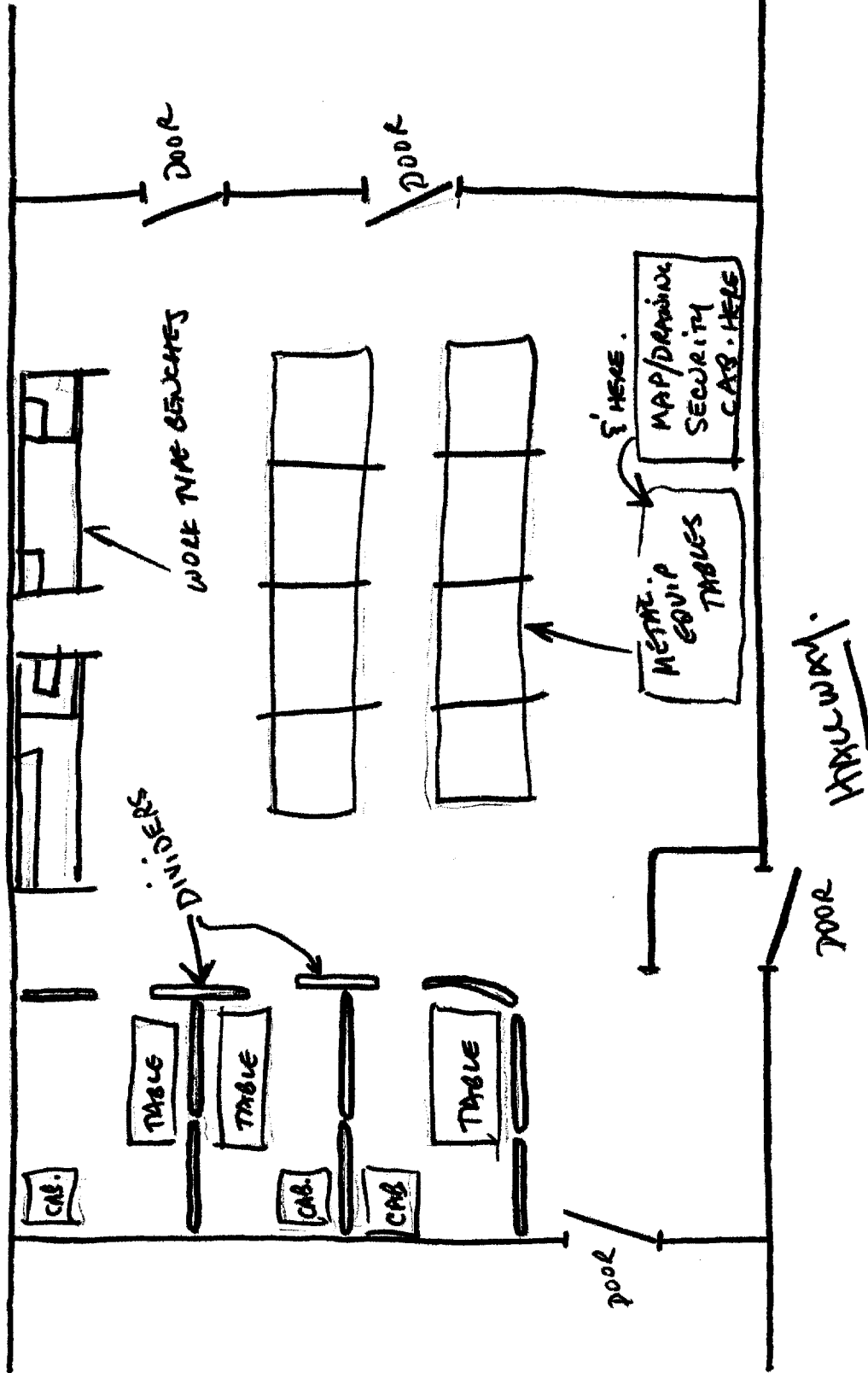

**TAB**

~~SECRET~~

TARGET CUING INFORMATION

REMOTE VIEWING (RV) SESSION DCC-86

1. (S/NOFORN) Prior to the start of this session the remote viewer was shown the attached photograph and was told that his target would be the building in the background.

SG1A

2. (S/NOFORN) During the session the viewer was asked to position himself in the hallway outside [REDACTED] He was asked to describe the room, moving from left to right, from his position at the door. The viewer was then asked to determine the purpose/function of this room.

NOT RELEASABLE TO FOREIGN NATIONALS

~~SECRET~~

SG1A

Approved For Release 2000/08/07 : CIA-RDP96-00788R000500900001-8

Approved For Release 2000/08/07 : CIA-RDP96-00788R000500900001-8