

Next 2 Page(s) In Document Exempt

**SECRET**

INTERVIEW

#66: This will be a CENTER LANE INTERVIEW with source #01. Time is 0900 hours, date is 19 January 1983. Focusing on 8 December 1982 at

SG1A



there is a building. Locate the area of spider like objects and describe the area on 8 December 1982.

#01: I have a machine that is very tall. I got to figure out where it is....Very tall, it's got four open ends, and a series of clamps, open hole in the center, round thick, dark black metal base. Spider objects are inserted in the hole, their webs come out.

#66: Describe the machine.

#01: It's clear, tall. It's got pieces of vertical movement. It's got an umbilical cord that goes to a sit down console.

#66: Describe console.

#01: ...Screen shows sign waves, paper roll that has six output pens. Shows variations of sign wave. It's in the basement of the new building. Just a minute, I'm losing it all of a sudden.

#66: I'll wait.

#01: .....There's an impression that these are..both manufactured underground for some reason or another.

#66: Explore function of machine and console.

#01: Some kind of stress test. See clamps come down and insert in the slots that hold the wires and the steady pressure of the plunger from the top. There's a readout through the wires. ...And they're recording extremes...Something else there too, just a minute.

#66: I will wait.

#01: ...Someway I'm left with an impression that this is a piece or a part of something larger. Keep getting....keep getting a view of very light weight object, but hard. It's some kind of plastic. It's oblong and it's got four edges that are rounded.....Seeing people trying to, trying to stick things through it or push things through it.

**SECRET**

NOT RELEASABLE TO FOREIGN NATIONALS

*INCL 2*

**SECRET**

#66: Describe the area surrounding it.

#01: Black, like deep space, it's black.....

#66: Focusing on the area of the machine and console, tell me about the spider like object.

#01: ..Shiny, hard, keep wanting to call it plastic but it's not. It changes color, it's..looks black but it's very deep blue, blue color when the light's right.

#66: Size?

#01: ...Palm, palm size, it's like a hockey puck with a hump... Keep trying to look through it, but all I see is a bunch of wire..

#66: focusing on this object now, move to a time before this, before the area of the console in the machine, describe the object and its surroundings, a time before this.

#01: See it on a metal rack, it's in a holder. There's a bunch of them. And they're racks on wheels and there's....Getting furnaces now.

#66: Describe.

#01: See these spider objects on edge, between gas jets, they're like blast furnaces, intense heat, very white, devices are cherry red,..no, that's wrong, they are different colors, white to red. They're very heat resilient, it's as if they cool very rapidly, hardly any expansion or contraction, very dense. For some reason they're heating them, only one at a time. And only heating them to certain degrees. Each one varies. and they're stacking them in the rack on this cart...I see that the wire is pressed in after. (mumble) two halves come together, pressed into this wire, it's mesh. Starting to get an impression that this is the connectors of some kind or connected in some way...

#66: Describe the impression you have that makes you say this.

#01: See grid patterns<sup>and</sup>, where the lines intersect I see these palm sized devices fastened. They're holding..ah..some kind of weaving of lines all intersecting out. Get lost in it.

#66: Are these the wires inside the object?

#01: Part of it, but it's all interlocking.

#66: Okay. Move to a time now before the furnace and before the objects stacked in the rack. Move to a time before this.

**SECRET**

#01: Seem to find myself in a lab of some kind. It's another building.

#66: Describe building.

#01: "T" shape, "T" the cross part of the "T" very tall and thin. Leg part of the "T" is lower and thicker. Some kind of a plant, like chem, chemistry or lab type place.

#66: Describe how they go from this place to the place of the machine and the console.

#01: See..people in coats, white coats mixing glass viles of some powders. Putting powders..in...containers. Containers are dropped into a machine. Just a minute....Keep jumping from machine to the furnace....I think they're molded in the furnaces. Then other furnaces heat them after they're cooled. Go through some other process, they come out and go on these carts with wheels. They're wheeled down a long corridor to the new building, stacked in a room, have numbers on them.

#66: The----

#01: Just wait a second, I'm getting a pattern here, has to do with these, I see them stacked off center like checkers. I don't know what that means, but it's important...Very much like the weaving pattern. I don't know where that takes place.

#66: Okay. Listen carefully now. This place of lab and people in white coats, before the furnace, describe the means of transport from the place of lab and white coats to the furnace.

#01: It's long corridors.

#66: Describe corridors.

#01: Many lights gray, square, wider than high, not more than 12 feet wide, 9 feet high. Just a lot of lights. See guard gates though, no, gates is wrong, see guards. There are people standing checking, checking things through doors.

#66: All right I have no further questions, concerning the spider like objects. I would like you now to explore on your own and comment as you see fit. Do so now.

#01: Hear a.....distinct crack noise, like cracking noise somewhere in the new building where these devices are being checked. It's not a crack, it's more of a snipping noise. I don't know where it's coming from though. That's all I got.

#66: All right, fine.

DRAWING EXPLANATION

- #01: The Drawings, drawing #1 is the place where the devices are, the spider like objects. That's where we first went. That's the top view to the left and the right view is the over all view.
- #01: Page #2 is where these devices sort of come from in a way. It's the location of the furnaces and it's a different building.
- #01: Page #3 is a little complicated, but this is different from my other perceptions in that this was like in, it had no background, you know I couldn't view any background, no rooms in the background, no objects in the background. This is like a free space kind of view of what the objects are and how they're put together and everything. And so I get an intense feeling like this is more of a concept of some kind. And it should be taken as that.
- #01: Page #4 is another part of the concept where I perceive people trying to poke holes through these sheets, these knobby sheets, And I don't know what that has to do with the first page of concepts. But this is also a concept drawing. And it also may not be the scale.
- #01: Page #5 are long corridors. This is how they transport everything around. I just keep getting these visions of really bright well lit gray walled corridors with big double door entry, exits and little door for people with guards.
- #01: And Page #6 is the "T" building where the chemists work with their beakers whatnot, that were putting together the, some kind of packets. That's it.
- #66: Okay, thank you very much.

SECRET

SECRET

①

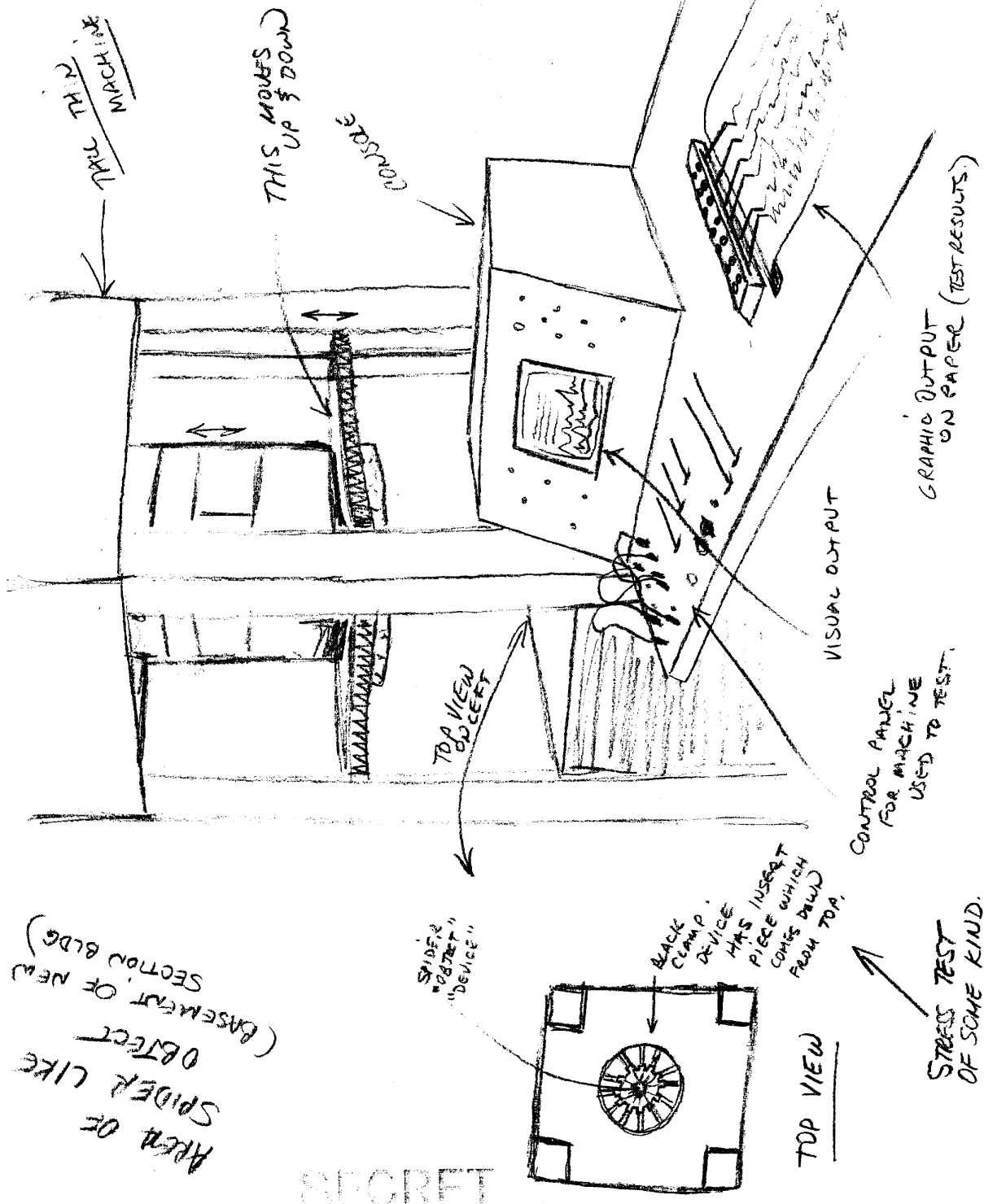

SECRET

SECRET

2

DIFF. FINGERPRINTS  
(THERE ARE 3 TYPES)  
DIFF. FINGERPRINTS  
(THERE ARE 3 TYPES)  
DIFF. FINGERPRINTS  
(THERE ARE 3 TYPES)

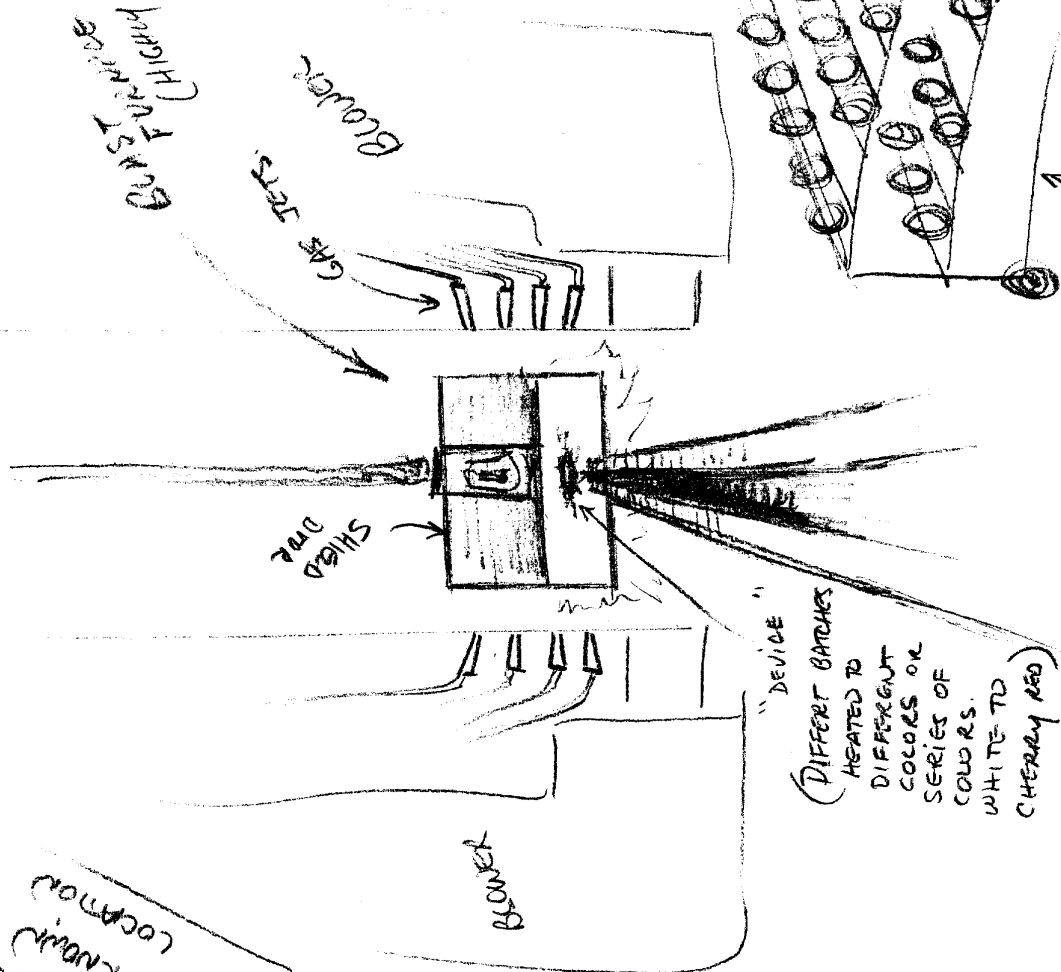

"DEVICE"  
DIFFERENT BATCHES  
HEATED TO  
DIFFERENT  
COLORS OR  
SERIES OF  
COLORS.  
WHITE TO  
CHERRY RED

EACH CART IS A  
SPECIFIC "BATCH" W/CONTROL #'S.

AREA OF FINGER  
PROCESSING - DIFFERENT  
BLDG - UNKNOWN  
LOCATION

SECRET

SECRET

3

THIS IS A CONCEPT  
ACTUALLY SEEN  
DRAWING & NOT

2ND PATTERN

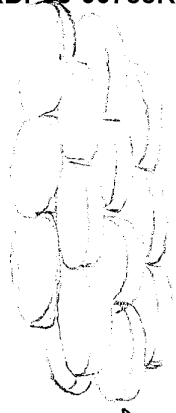

MULTI-LAYERED  
W/WIRES INTER-  
CONNECTED

USED IN TWO PATTERNS  
TO MAKE SOMETHING  
(DRAWN BELOW)

HUMP APPEARS  
AFTER FURNACE  
HEATING  
STEPS.

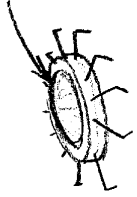

TOP HALF



BOTTOM  
HALF

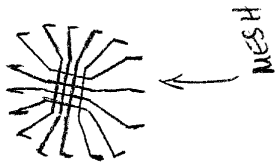

MESH

1ST PATTERN

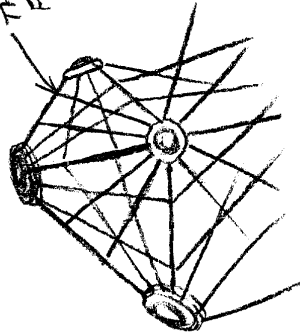

(!?)  
THIS METALOID OR  
FINE WIRE OR  
LIKE COVERED  
IS COVERED  
W/ SOMETHING

TO MAKE  
SOMETHING LIKE THIS?



? (ONLY VIEW I HAD)

SECRET



SECRET

4

NOT SURE OF  
SOURCE IN  
THIS DRAWING

NOT SEEN AS  
PART OF TARGET  
SITE BUT PART  
OF CONCEPT  
PERCEPIONS

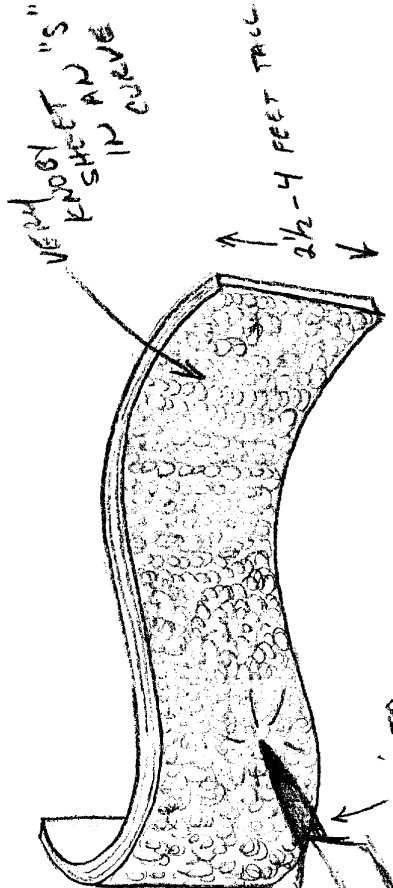

POINTED  
DEVICE  
TRYING TO  
PUNCH THROUGH  
SHEET IN  
DIFFERENT  
AREAS.

PEOPLE  
ON BOTH  
SIDES

LARGE  
MACHINE

SECRET

5

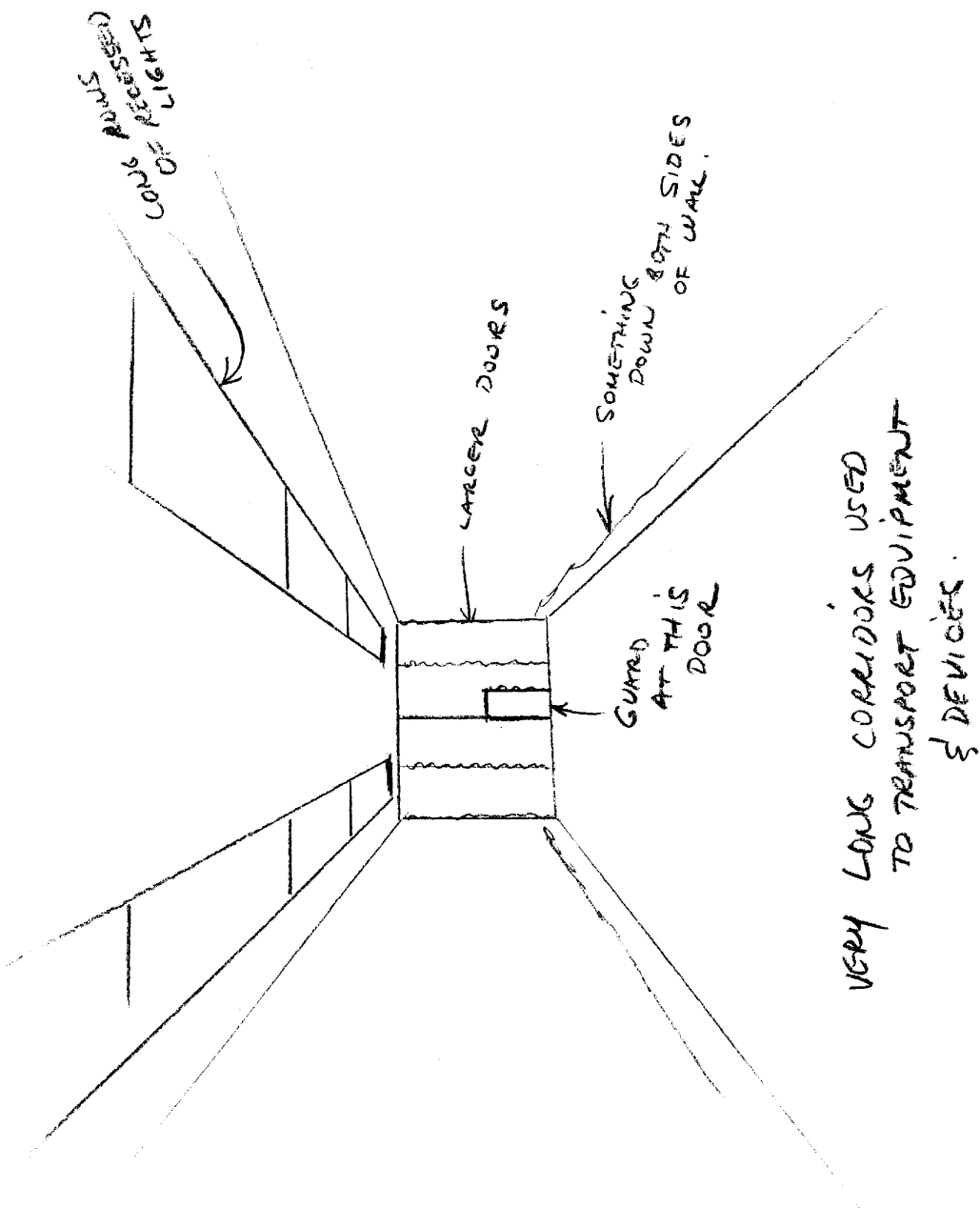

SECRET

SECRET

BLDG WHERE  
CHEMISTS WORKING  
WHITE CARTS WERE  
SEEN

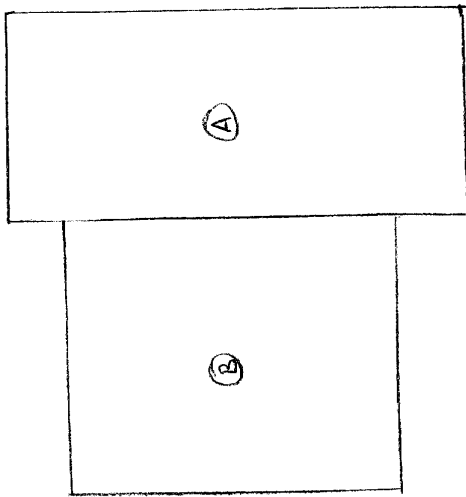

TOP VIEW  
OF T-BLDG  
SHAPE.

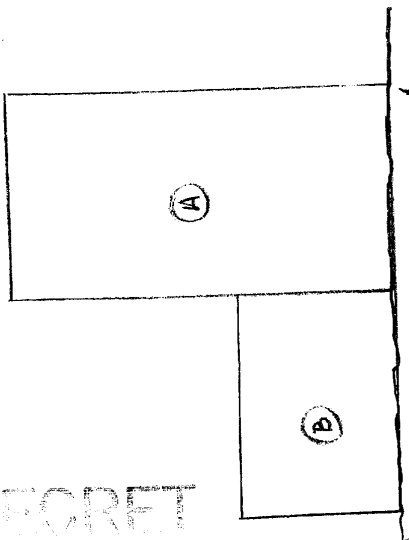

SIDE VIEW  
OF T-BLDG

OTHER  
CROWDED IN WITH  
BUDGS &  
OTHER T-BDG  
ALL BUDGS  
AS A  
"DEFINITE D  
SHAPE"  
FEEL LIKE  
TO OTHER T-BDG  
THIS T-BDG  
WITH CAB IS  
CROWDED IN WITH  
BUDGS &  
OTHER T-BDG  
ALL BUDGS  
AS A  
"DEFINITE D  
SHAPE"

SECRET

~~SECRET~~

AGENT REPORT

For use of this form, see FM 30-17(C); AR 381-130, the proponent agency is the Office of the Assistant Chief of Staff for Intelligence.

1 NAME OF SUBJECT OR TITLE OF INCIDENT

2 DATE SUBMITTED



SG1A

3 CONTROL SYMBOL OR FILE NUMBER

CL-994/8210/01

4. REPORT OF FINDINGS

On 19 January 1983, Source CL-01 was interviewed concerning [redacted]. During a previous interview (CL-973/8210/01, conducted 8 December 1982) Source described "spider like objects" in an area in a building. This interview was an attempt to have Source further describe this area and these objects. Source stated substantially as follows:

SG1A

Initial manufacture or construction of the "spider like objects" began in a lab in a "T" shaped building. The building (not further identified, but not the previously identified building) might be a chemical laboratory or plant. Personnel in white coats mixed powders and then put that mixture into containers. These containers were then placed in a machine or furnace in another location (not further identified, but possibly underground). The objects may have been molded by this machine or furnace. After this, the objects were reheated in other furnaces. Each batch of objects was heated to a different level or temperature, different colors white to red. The objects were very heat resilient. They cooled very rapidly with hardly any expansion or contraction. At this point a wire mesh was sandwiched between two halves and the objects developed a hump and looked like a "palm sized hockey puck". The batches of processed objects were numbered and placed on carts for cooling and transport. The carts of objects were then taken through a long well lit corridor to the basement of the newer section of the previously identified building. Here the objects underwent some kind of stress test.

In the basement area there was a very tall machine with open sides, a round thick black metal base, and a center component which moved vertically above a hole with clamps. The "spider objects" were inserted in the machine for testing. During testing steady pressure was applied to the objects by the plunger. The wires which had been installed within the objects were then used to measure extremes (not further identified). During this test a

WARNING NOTICE: SENSITIVE  
INTELLIGENCE SOURCES AND  
METHODS INVOLVED

CLASSIFIED BY: MSG,DAMI-1<sup>SH</sup>  
DTG: 051630ZJUL78  
DECL: Originating Agency's  
Determination Required

continued:

5. TYPED NAME AND ORGANIZATION OF SPECIAL AGENT

6. SIGNATURE OF SPECIAL AGENT

NOT RELEASABLE TO FOREIGN NATIONALS

*Invt 3*

DA FORM 341  
1 APR 52

REPLACES AGO FORM 341, 1 JUN 47, WHICH MAY BE USED

GPO: 1970 380-807/248

~~SECRET~~

SECRET

AGENT REPORT

For use of this form, see FM 30-17(C); AR 381-130; the proponent agency is the Office of the Assistant Chief of Staff for Intelligence.

1 NAME OF SUBJECT OR TITLE OF INCIDENT



SG1A

2 DATE SUBMITTED

3 CONTROL SYMBOL OR FILE NUMBER

CL-994/8210/01

4 REPORT OF FINDINGS

distinct crack or snipping noise was reported. The object itself looked shiny and hard. It was black or deep blue. This machine was connected to a console. The console provided a readout of the test. At the console personnel were recording extremes occurring during the test. The console had a visual display (cathode ray tube), a control panel, and a graphic output for a record of the test results. The visual screen showed sign waves and the graphic output showed variations of sign waves.

NOTE: Source felt that this test had something to do with a larger hard oblong light weight plastic object. Conceptually, people were trying to push things through the object.

No further amplifying information was obtained from Source during this interview. Attached hereto is EXHIBIT I, drawings provided by Source concerning the areas described above.

5 TYPED NAME AND ORGANIZATION OF SPECIAL AGENT

6 SIGNATURE OF SPECIAL AGENT

DA FORM 341 1 APR 52

REPLACES PREVIOUS FORM 341, 1 JUL 51

SECRET

GPO: 1970-580-507/248



**SECRET**

①

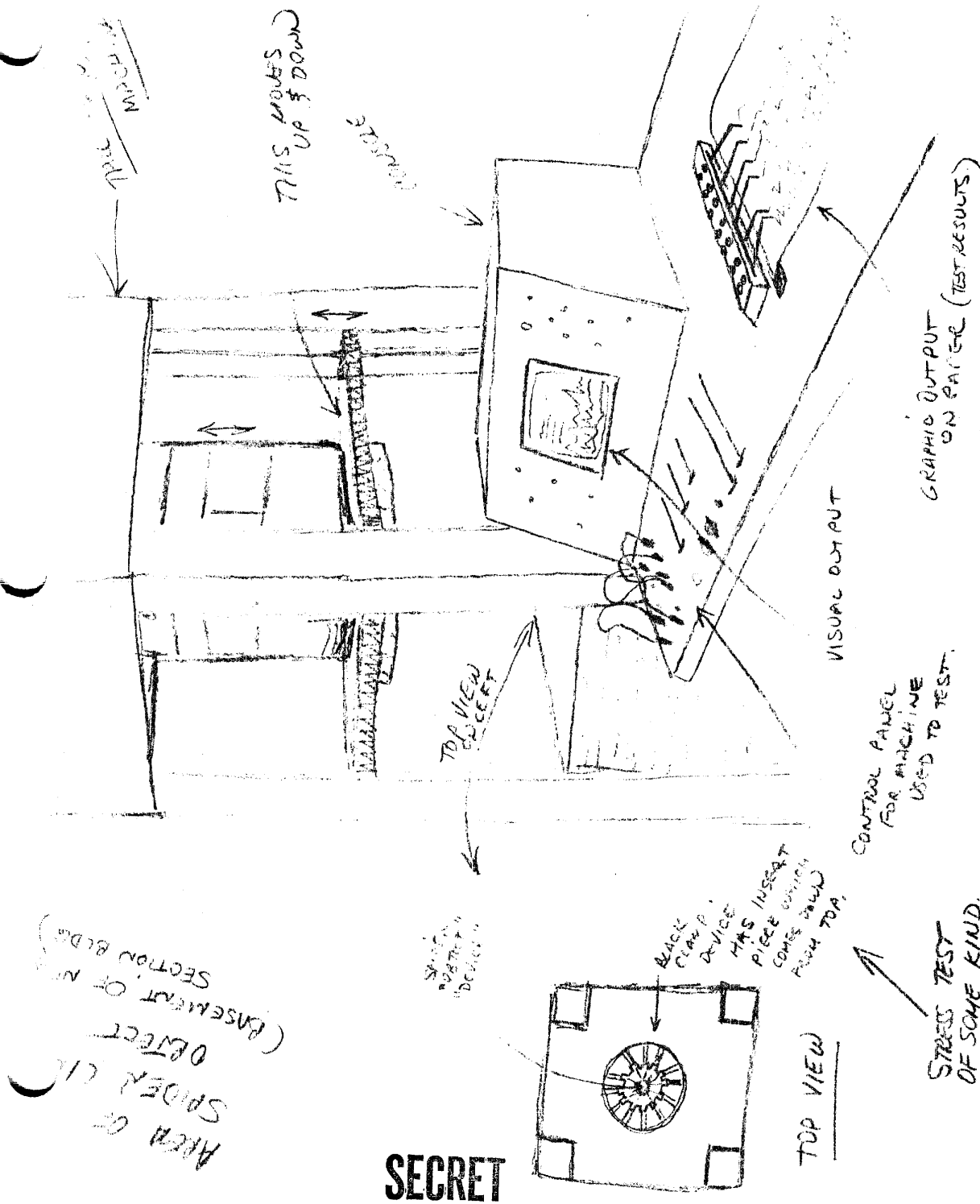

**SECRET**





**SECRET**

3

THIS IS A GOOD DRAFTING SEQUENCE

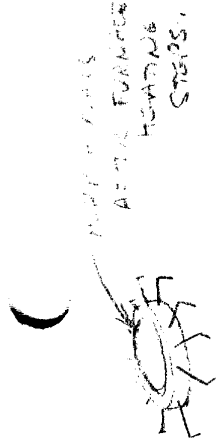

TO GET THE HOLE AT THE TURNING POINTS.

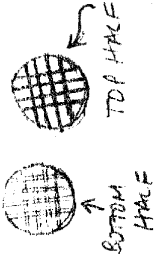

MESH

USED IN TWO PATTERNS TO MAKE SOMETHING (DRAWING BELOW)

2ND PATTERN

1ST PATTERN

(?) THIS MEANS THE FINE WEAVING OR LIKE COVERED IS COVERED W/ SOMETHING ELSE

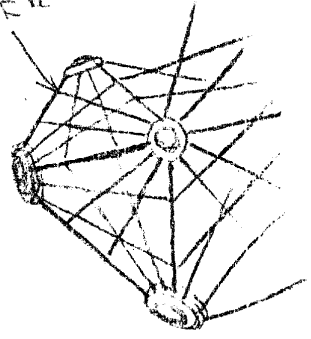

MULTI-LAYERS W/ LINES INTERCONNECTED

TO MAKE SOMETHING LIKE THIS



? (ONLY VIEW I HAD)

**SECRET**

SECRET

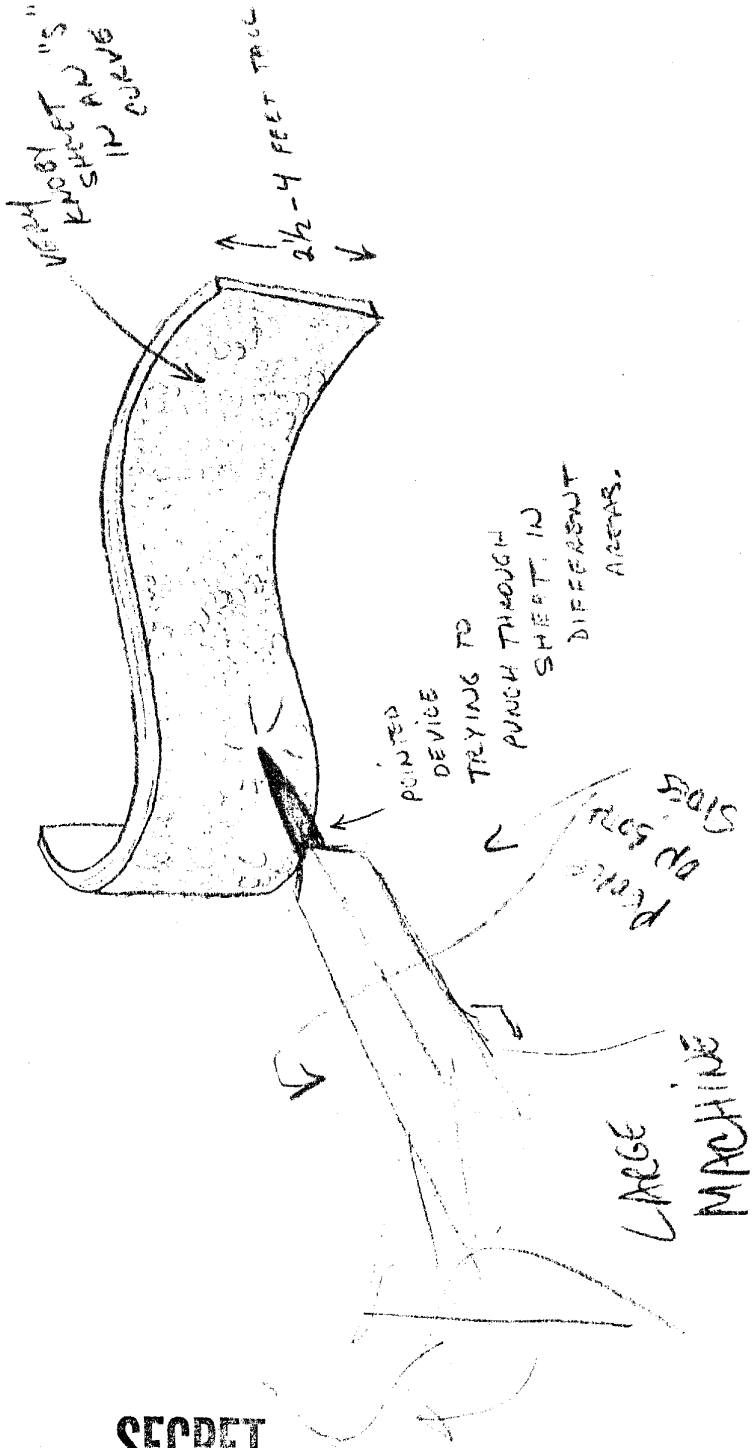

SECRET

**SECRET**

(5)

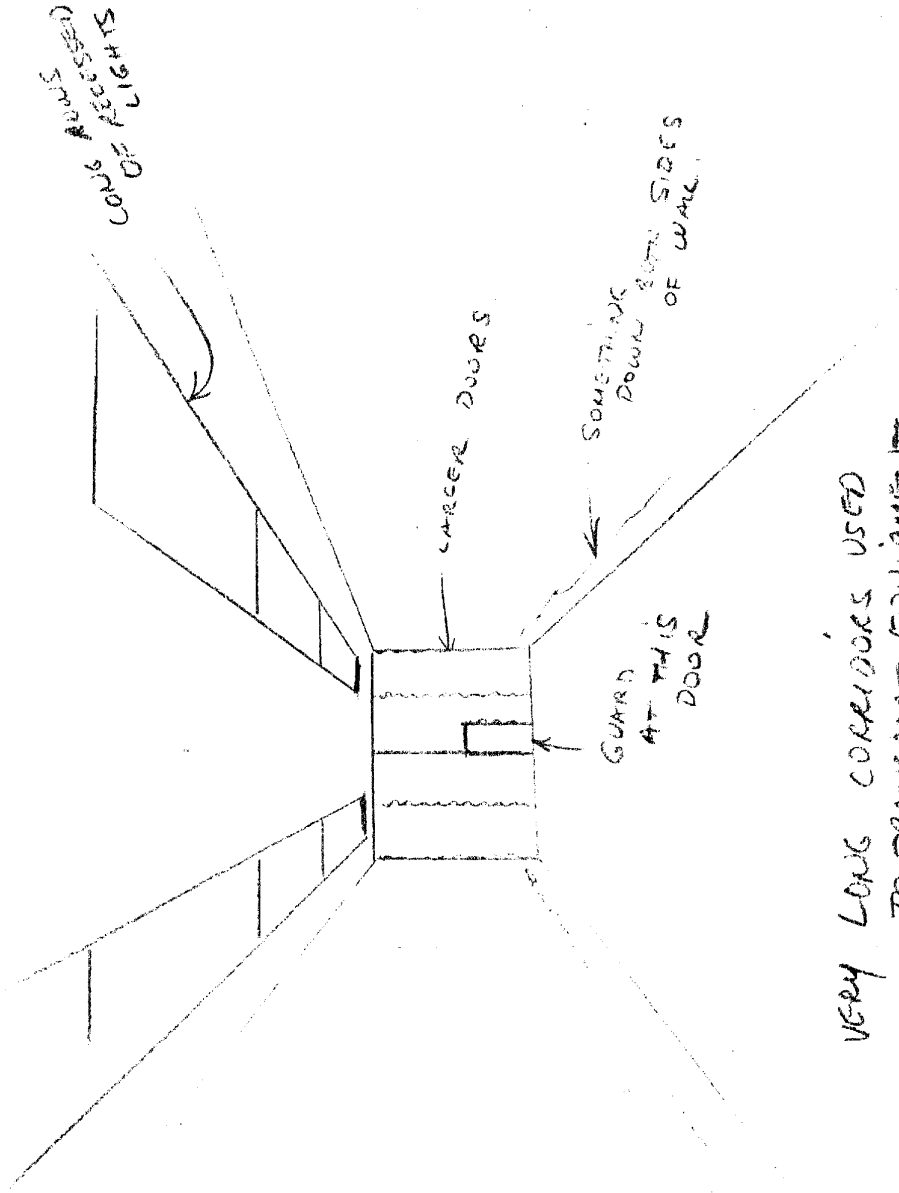

VERY LONG CORRIDORS USED  
TO TRANSPORT EQUIPMENT  
& DEVICES.

**SECRET**

**SECRET**

BDDG WORKS FROM START WITH CHEMISTS ATTEMPT WHITE COATS SEND

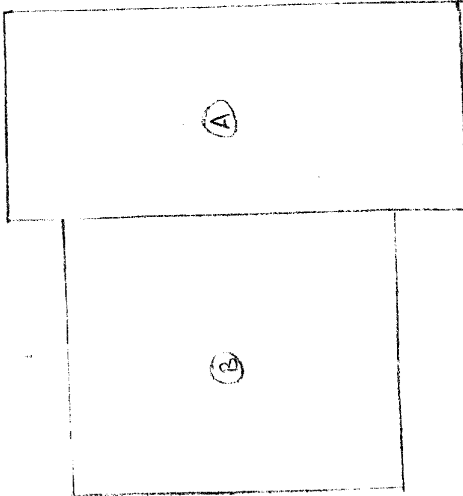

THIS BDDG IS ORDERED IN WITH OTHER BDDG'S & OTHER T-BDDG. PLEASE GET LIKE "DEFINITE BDDG AS A SHAPE".

SIDE VIEW OF T-BDDG

