

SG1A

Approved For Release 2000/08/08 : CIA-RDP96-00788R001600200002-2

Next 2 Page(s) In Document Exempt

Approved For Release 2000/08/08 : CIA-RDP96-00788R001600200002-2

INTERVIEW

- 66: This will be a CENTER LANE interview with source #01, time is 0900 hours, 11 January 1983. The interior of the building in the photograph is perceptible on 11 January 1983.
- 01: The..four double are glass and a ramp going down..white intersecting.. hall. (mumble) grays on both sides, gray..stone...that has..... double sweep back staircase in the center, both sides..... ah..a wide corridor down both ends.....Trying to get a feel for it.. what's going on.
- 66: I will wait.
- PAUSE
- 01: They function pretty much like a, like a pentagon, a lot of mix of military,..different kinds of military. But there's a majority of civilians making those, playing men's roles.sort of like defense ministry.
- 66: Describe the impressions you have which make you draw these conclusions.
- 01: Tense military feeling, a lot of civilians,..higher level of government. It's like a ministry in itself. That's all I get.
- 66: Focusing on the piece of this building, the center piece of this building on the upper floors. Describe the areas of the upper floors to me.
- 01: Center is almost all vaulted ceiling. It's very open like a round open rotunda type area. Staircase zigzags back and forth on both sides all the way up. There's really not much in the center except walkways and corridors ..or balconies..Off both sides are on any given floor are corridors, appear to be double corridors....Offices on both sides of corridors. Some rooms are general rooms, general people rooms.
- 66: Describe the impression you have which makes you say general people rooms.
- 01: See rooms of long tables and many people sitting at tables, talking, very ornate...It's very club type atmosphere as well like it's..something special to belong to this, this group.
- 66: Focus on one of these rooms with the long tables and describe it further to me.
- 01: ..dark colored rug, thick plush,..some glass in the walls, very ornate high ceiling.
- 66: Describe the activity in the room to me.

NOT RELEASABLE TO FOREIGN NATIONALS

CLASSIFIED BY MSG,DAMI-ISH
DIA: 051630ZJUL78
DECL: Origination Agency's
Determination Required

SECRET

- 01: Um, group of 5 or 6 standing to one end of the table. Many people sitting at the table, a lot of papers, folders..it's like a formal type meeting area, but..informal discussion. Same atmosphere you'd find at a seminar....Large table on one side as a.. a some kind of refreshments or something on it.. water, tea and whatnot.
- 66: Okay. Did good. Move now to an alternate area within this section of the building.
- 01:See a room with a lot of maps, many desks..people putting pins on maps and..marking in files.
- 66: Okay. Move onto another area now.
- 01: Glass walls, black,.lights of some kind, dots in the glass..blinking.... Just a lot of black glass with blinking lights, dark, the room is kept dark.
- 66: Okay. Move to another area now.
- 01: See offices, a restaurant, a special kind of restaurant,..very, very exclusive, only certain people can eat here. People in black coats working there,..very formal.
- 66: Okay. Now broaden your perspective to cover the concept of the whole building section here. Describe the activity to me.
- 01: It's a...it's a kind of major policy and ministry building of some kind.
- 66: Describe the impressions to me.
- 01: Get an impresssion it's a place where a, it's a place where decisions are made of a certain kind, can't be made anywhere else..absolute control over certain things here..of world importance.
- 66: Okay. I have no further questions. But I would like to allow you a few minutes now to explore and comment as you see fit. Do this now.
- 01: That's all I got. Just an immense building, very old. I would put it at about late 1800's, early 1900's. That's all I got.
- 66: Okay, fine.

SECRET

~~SECRET~~

DRAWING EXPLANATION

- 01: Page 1 is a quick sketch of the top view, which is an open area surrounded by the sweeping staircases. And this is opened from probably six up all the way from the ground floor and it's domed on the inside and everything. And I get a feeling of double corridors on both sides.
- 01: Page 2 is kind of like a view of the way the staircase starts out and it just keeps sweeping back on itself, corridors on both sides and the main entrance is just facing the staircase. It's almost like a ramp. It's just a long, slow sweeping type of carpeted entrance, with a lot of gray stone and marble and stuff inside. It's a real old building. The only reason why there's not more detail is that this is kind of a macro approach to whatever the problem is. That's the best I can do.
- 66: Okay.

~~SECRET~~

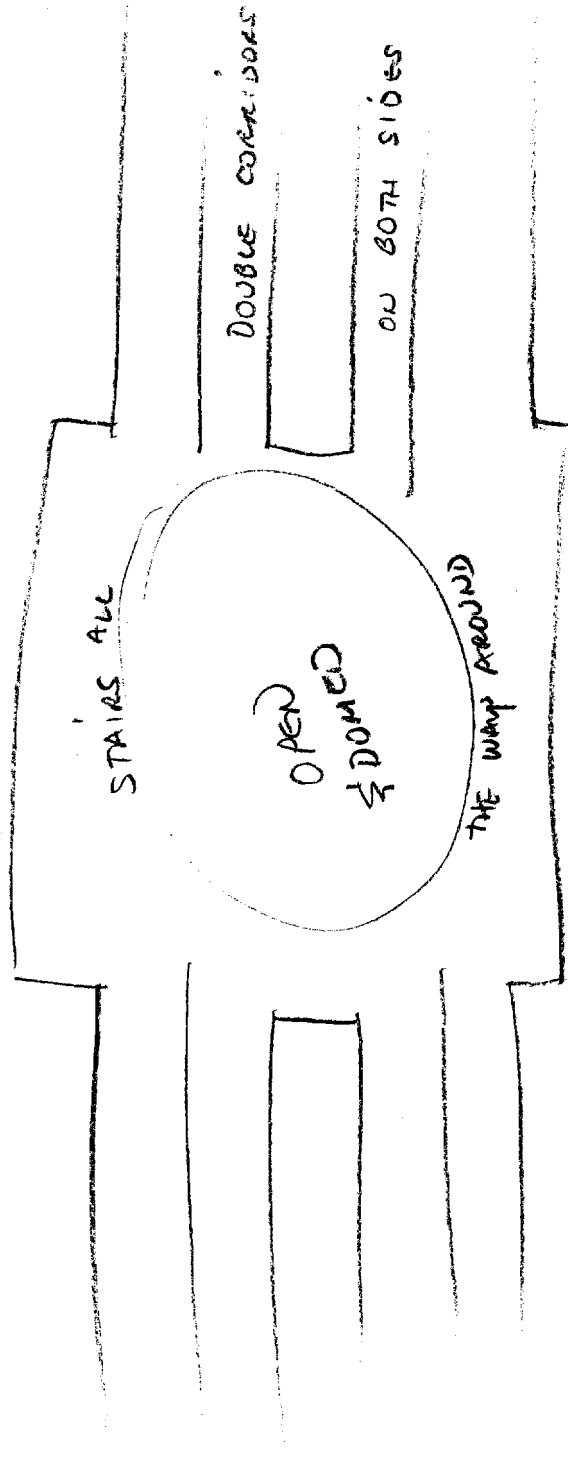

TOP VIEW

WHOLE CENTER
OPEN - VERY
LARGE AREA

SWEEPING
STAIRS
ALL THE
WAY UP

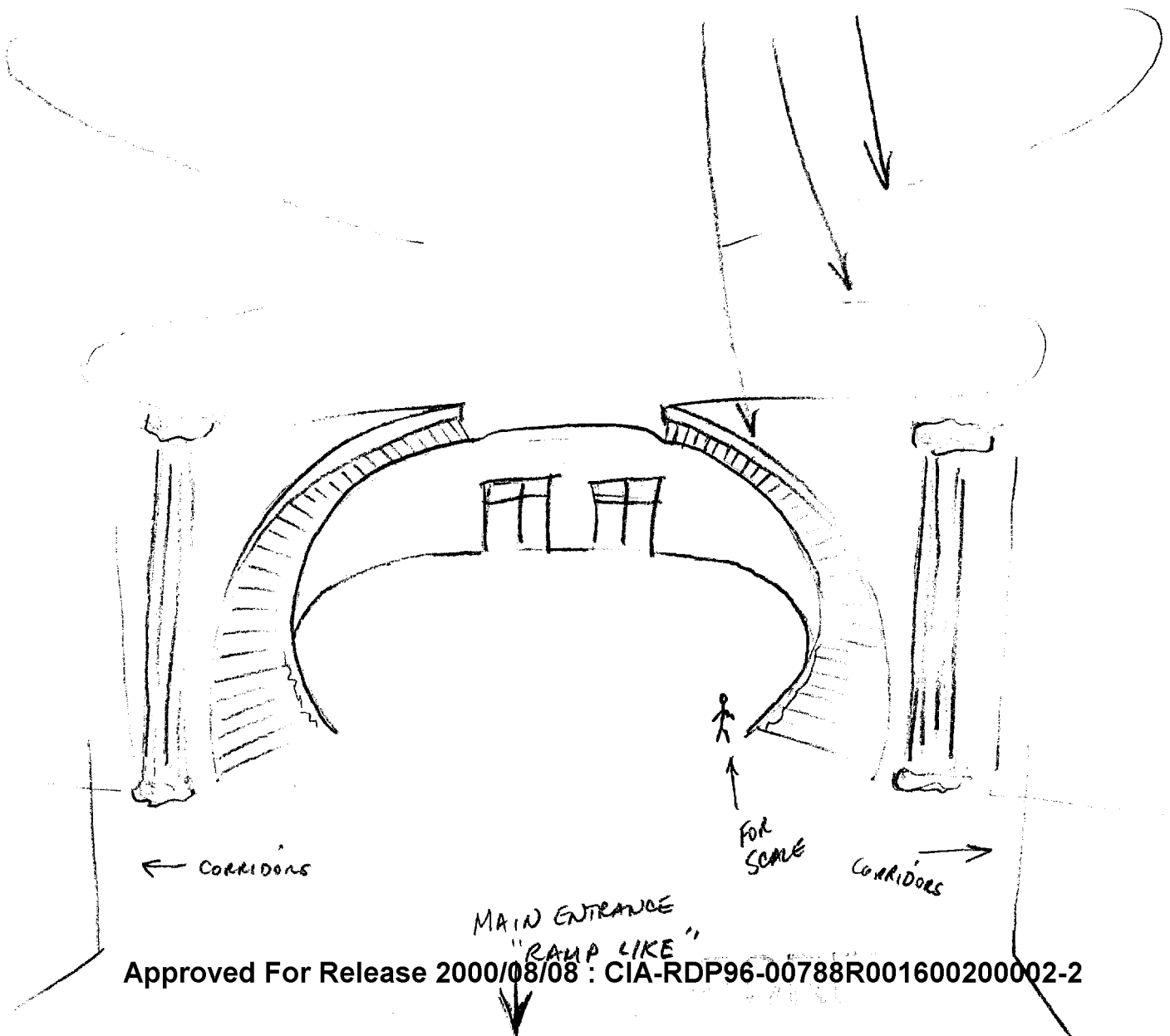

AGENT REPORT

For use of this form, see FM 30-17(C); AR 381-130; the proponent agency is the Office of the Assistant Chief of Staff for Intelligence.

1. NAME OF SUBJECT OR TITLE OF INCIDENT

2. DATE SUBMITTED

SG1A

3. CONTROL SYMBOL OR FILE NUMBER

CL-984/8211/01

4. REPORT OF FINDINGS

On 11 January 1983, Source CL-01 was interviewed concerning a section of a building in [redacted]

SG1A

Source stated substantially as follow:

SG1A

The center part and entrance to this section of building was very open. This open area extended from the ground floor up to probably the sixth floor. In the open area, staircases zigzagged back and forth on both sides all the way up. There was not much in the center except walkways and corridors and balconies.

SG1A

Off both sides of the center, on any given floor, were corridors, possibly double corridors. On both sides of some corridors were offices. On other corridors were general rooms, rooms of long tables and many people sitting at tables. There was a club type atmosphere in these rooms. The rooms with the long tables had dark colored rugs, thick and plush. There was some glass in the walls and very ornate high ceilings. In one of these rooms there was a group of 5 or 6 standing to one end of a table. Many people were sitting at the table with a lot of papers or folders. There seemed to be a seminar atmosphere in the room. There was a large table on one side with some kind of refreshments, water, tea and whatnot.

Source very briefly described several other areas within this section of the building. There was a room with a lot of maps, many desks and people here were putting pins on maps and marking in files. There was a room which appeared to have black glass walls with lights of some kind which appeared as dots in the glass. The dots seemed to blink. This room was kept dark. In addition to these areas there were more offices and a restaurant which was very formal and exclusive for people in black coats who worked in the building.

Source provided some general comments as to his opinion of the function/activity of this section of building. The area had a mix of different kinds of military. But, there was a majority of civilians. These civilians seemed to be playing men's roles. Within this area there was a tense military feeling coupled with an impression of a lot of civilians and a

CLASSIFIED BY:MSG, DAMI-ISH
DIG: 051630ZJUL78
DECL: Origination Agency's
Determination Required

... NATIONALS (continued)

5. TYPED NAME AND ORGANIZATION OF SPECIAL AGENT

6. SIGNATURE OF SPECIAL AGENT

DA FORM 341 1 APR 52

REPLACES WD AGO FORM 341, 1 JUN 47, WHICH MAY BE USED.

GPO: 1970 390-907/245

INCI 3

AGENT REPORT

For use of this form, see FM 30-17(C); AR 381-130; the proponent agency is the Office of the Assistant Chief of Staff for Intelligence.

1. NAME OF SUBJECT OR TITLE OF INCIDENT



SG1A

2. DATE SUBMITTED

3. CONTROL SYMBOL OR FILE NUMBER

CL-984/8211/01

4. REPORT OF FINDINGS

higher level of government. Source compared his feeling of this area to that of a ministry. Source also stated that in this section of building certain kinds of decisions were made which could not be made anywhere else. In this area there was absolute control over certain things of world importance.

Attached hereto is IXHIBIT I, drawings provided by source concerning the section of building which he described.

No further amplifying information was obtained from source during this interview.

AGENT'S NOTES: Source was somewhat irritated during the interview. He felt that it was not appropriate to ask him to describe an entire section of a building. He stated that one might as well ask him to describe a whole country when what they really wanted was a description of the area surrounding one missile silo. Source's mental attitude may have had an adverse effect on his reporting.

NOT FOR RELEASE TO FOREIGN NATIONALS

5. TYPED NAME AND ORGANIZATION OF SPECIAL AGENT

6. SIGNATURE OF SPECIAL AGENT

DA FORM 341 1 APR 52

REPLACES WD AGO FORM 341, 1 JUN 47, WHICH MAY BE USED.

GPO: 1970 390-907/24B

EXHIBIT COVER SHEET

EXHIBIT I:

Drawings

SG1A

SUBJECT:

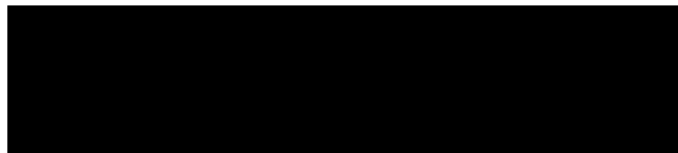

CONTROL NO.:

CL-984/8211/01

SECRET

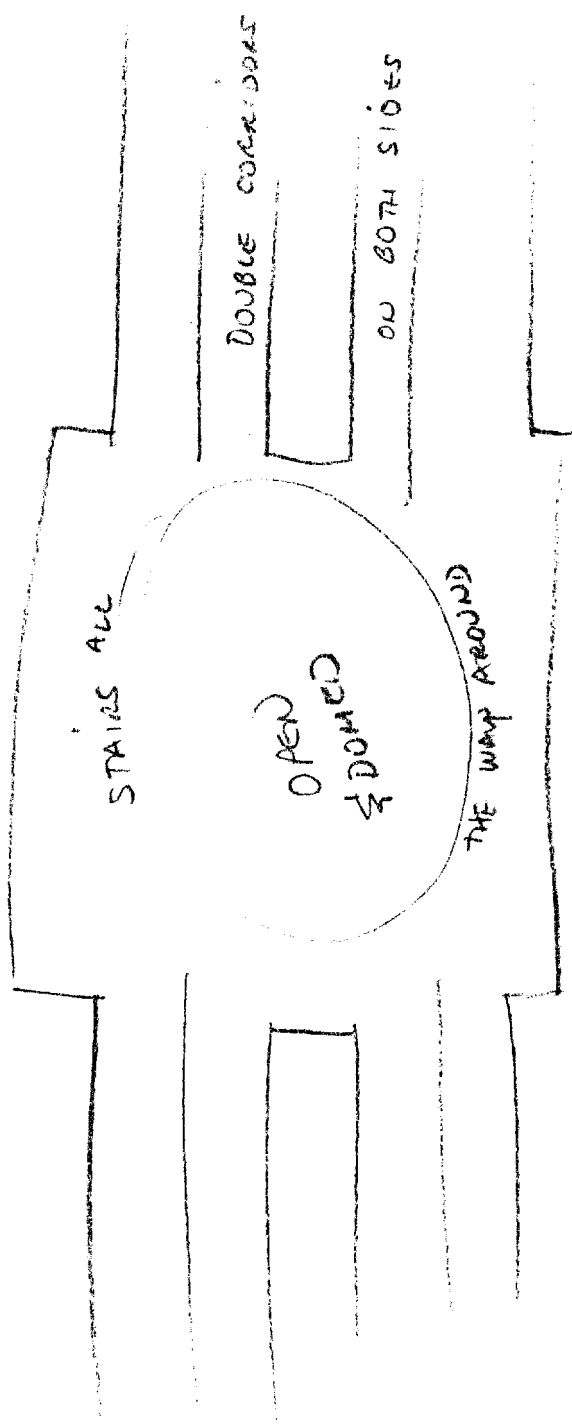

TOP VIEW

SECRET

SECRET

WHOLE CENTER
OKD - VERY
LARGE AREA

SWEEPING
STAIRS
ALL THE
WAY UP

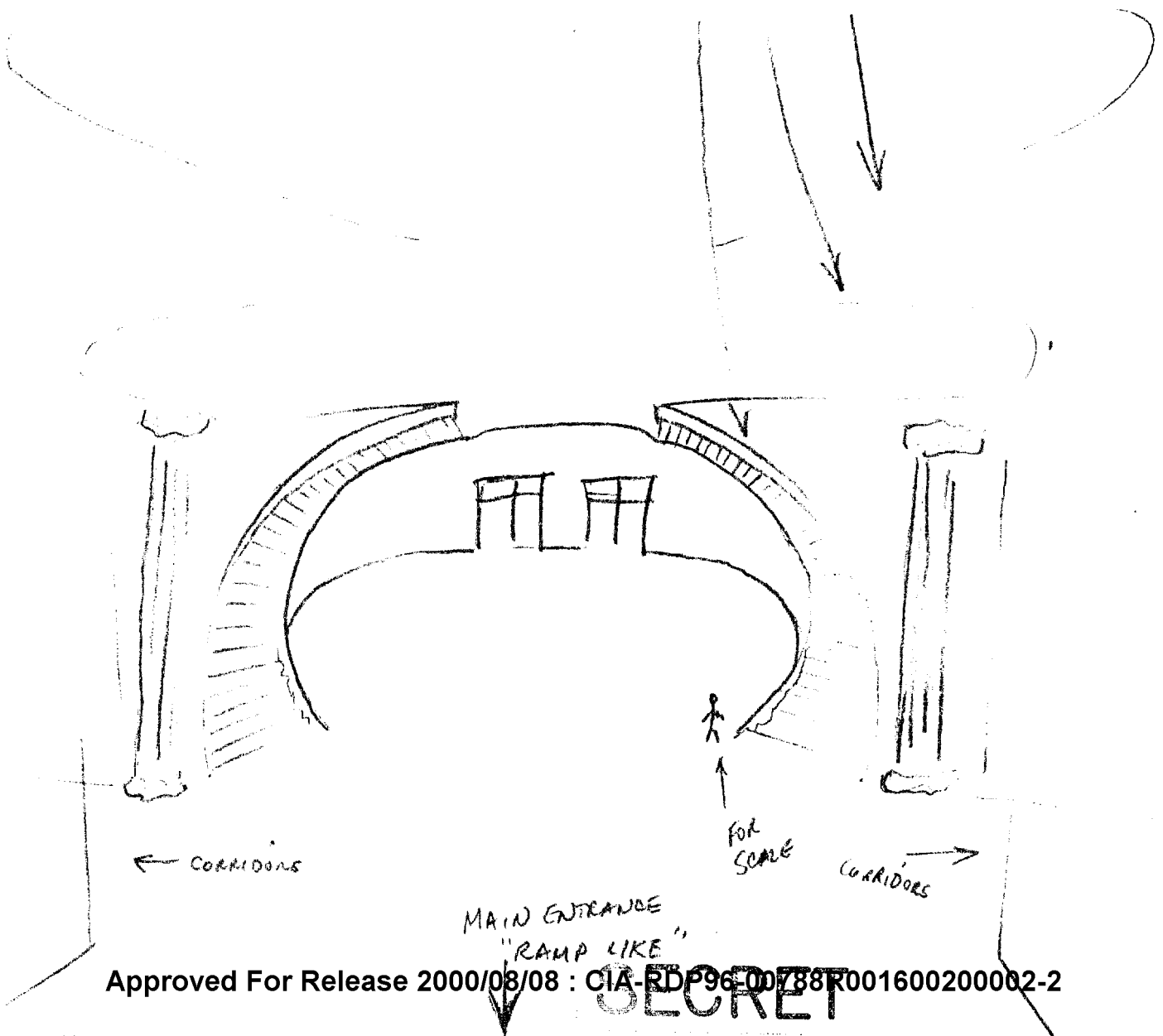

SECRET