

SECRET

IAGPA-F-SD

15 February 1984

MEMORANDUM FOR RECORD

SUBJECT: CENTER LANE Interview Summary - HU-1058/8314/63 (U)

1. (S/CL-3/NOFORN) On 201100 December 1983, source #63 was interviewed concerning personnel and activities within a building unknown to him. The project 8314 sponsor had provided a photograph of the building (see Incl 1).
2. (S/CL-3/NOFORN) For this interview source was shown the photograph provided by the sponsor and asked to focus his attention on the building. Source was not told of the suspected activities in the building. No other identifying data was provided to source. All other information was withheld for use as feedback and cuing for subsequent interviews.
3. (U) A transcript of the interview was prepared which included structured objectifications provided by source during the interview (see Incl 2).
4. (U) A DA Form 341 (Agent Report) was prepared for the sponsor. This report related the salient points of the interview (see Incl 3).

3 Incl
as

SG1J

OPS/TNG Officer

CLASSIFIED BY: CDR, INSCOM
DECL: OADR

CENTER LANE

WARNING NOTICE!

SPECIAL ACCESS PROGRAM

RESTRICT DISSEMINATION TO THOSE
WITH VERIFIED ACCESS

CATEGORY 3

NOT RELEASABLE TO FOREIGN NATIONALS

SECRET

SG1A

Approved For Release 2000/08/08 : CIA-RDP96-00788R001900450002-2

Approved For Release 2000/08/08 : CIA-RDP96-00788R001900450002-2

~~SECRET~~

TRANSCRIPT

HU-1058/8314/63

#66: This will be a CENTER LANE Interview for 1100 hours 20 December 1983. And I will sit here and attempt to interrogate the signal when I feel it's appropriate.

#63: (mumble) . Okay, I'm going to put inclemency down. I'm going just feel the hustle and bustle of today. I'm unsure on how we're doing this.

#66: Can I ask you to raise the microphone up a little? Put it by your second button and kind of point it towards your mouth.

#63: Let pen down first and then touch the picture.
.....miss break

#66: Okay.

#63:I'm just going to stage 2s,...many floors,.... noises,... white,.... tall, ...windows,..... Tend go the lobby, elevator...AOL break, ...SRI NY.(mumble) different, (mumble) dimension all levels, ... intangible, different tenants in the building,... AOL break, ... like the isn't owned by all one group.

#66: Correct.

#63: Signal, AOL signal. There's one floor of interest, ... or two floors of interest. AOL break,....one or two floors of interestabout half way up. Stage 2s, blue, white,.....Access by elevator, protected area.

#66: Correct.

#63: It's a sketch,..... This is inside, there's a viewing window here, to see the lobby here,.... the entrance door is over here and this is a doorway that you can see when you from the lobby into the window, or in through the viewing window.Stage 2, quiet.... .. blue and white.This is the lobby viewing window and door, ...activity is over here,and a dark feeling over here.

~~SECRET~~

ENC 2

~~SECRET~~

PAUSE

- #63: ...AOL break, feels abandoned, ... empty,
intangible, new,...dimensional, new
.....AOL break, strange,..... (mumble)
partitions,..... rooms,.....
..... My concentration keeps getting drawn over
here as opposed to the rest of the place.
- #66: Okay, what's that new label there?
- #63: That's where I said the activity was before.
- #66: On a new piece of paper make yourself a stage 4
matrix, and label the stage 4 matrix activity.
- #63: Okay. intangible exclusive,
.....intangible, guarded,tangible is
manned,intangible, temporary,.....
.....tangible, concentrated,.....AOL
break, ..just kind of debrief filling in, it's like
they've got a whole floor in this building, but
most of the floor is not being used. Everything is
right there in one little area, like it centers
around one man, maybe one man, the secretary or
something and it seems like this is just a
temporary facility. They just moved into it and
they are getting ready to leave it again. Um,....
that's about it.
- #66: Okay. (mumble) that in AOL.
- #63: Um, um.
- #66: Okay, make yourself another stage 4 matrix and
label it personnel. And you'll find that you might
have to jump back and forth between the matrixes.
- #63: Um, um.
- #66: Acquire the site.
- #63:Tangible is man,stage 2 is light
complexion,stage 2 is pale,... stage 2 is
dark hair,, stage 2 is beard,.....
intangible is one main figure,boss.
- #66: Make another stage 4 matrix, label that matrix boss.
- #63: Intangible is solid, self assured, in

~~SECRET~~

charge,firm, notice one (mumble) scary
.....has many people under him.

#66: Push stage 2s on boss.

#63:Stage 2, stocky, black hair,beard,
light complexion,casual clothes,
....dominant,

#66: See if dominant belongs in another column in stage
2.

#63: Intangible, dominant.He controls people,
...people coming and going.Planning
something.

#66: I didn't hear you.

#63: Planning something.(mumble)

#66: Okay. You've done very well. I was wondering if
some of the stage 2s wouldn't, since you're working
on a person, should some of the stage 2s be
tangibles instead of stage 2s?

#63: Um, um, probably. Should be black hair--

#66: Those would be tangibles.

#63: Yeah.

#66: Okay.

#63: Beard would be tangible. Light would be stage 2,
complexion would be a tangible.

#66: Okay, good. I agree with this (mumble). Okay,
when you're ready again, I want a stage 4 matrix of
boss location.

#63: All right.

#66: Where in that building is boss?

#63:Woosey

#66: Tell these trips back and forth.

#63: Ha, ha.

#66: Jet lag.

#63:

#66: Okay. Stage 4 matrix for boss location.

#63:EI's here, woosey,light headed.

#66: Does inclemencies are EIs?

#63: EIs, it's what I actually feel.

#66: Okay. Acquire the site of the boss location.

#63: Stage 2, hot and cold.Stage 2, sunny,..... AOL break,...southern hemisphere.

#66: Okay, after your break, remember why, know all of that, we want "where in the building". You're doing good. You're obviously responding to the question, but we want to know inside the building where he is?

#63: Well, I got to start somewhere and work my way there.

#66: Yeah.

#63:Dimensional 6 or 7....I would really discount that.....sketch, come out of an elevator here,looks like a lobby here, a doorway here, with a window here and a room and another room here, and this is the location of the boss.

#66: Okay, on what floor?

#63: 6 or 7 comes to mind.

#66: Oh okay, you think the 6 or 7 applies to floors.

#63: Um, um.

#66: I know before you said upper type floors or about the middle or something like that.

#63: Um, um.

#66: But we do know that it's not the ground floor.

#63: um, um.

#66: Okay.

~~SECRET~~

- #63: It's up, I'd say this is the building here, looks like right around in here somewhere.
- #66: Okay.
- #63: That's the windows and stuff. It's got some sort of pattern on it.(mumble) back in this corner.
- #66: Okay.
- #63: Colors in this area are stage 2s, blue, white and dark areas.This is just a big blank over here to me.
- #66: Remembering your stage 4 matrix on this, considering the boss's location in itself, let's take a look at the stage 4 matrix and see what other information comes out, (mumble) from the boss's location.
- #63: Boss's location,....desk in there, ...something over here, the entry door to his place is here.This is all out structure and I don't how to try to keep it in. But he has a plan, he seems friendly, but it is only to accomplish his goal.He's foreign, he speaks english, ...loner.
- #66: These are obviously some tangibles and intangibles from your other stage 4 matrix. I understand you're out structure but let's keep going, as long as the signal keeps coming in, let's keep taking it down.
- #63:His plan is for elsewhere,..... another building,.....Get an AOL break, (mumble)See people coming and going,and they're helping in plan, End.
- #66: Okay, let's do a summary and if you'll lay your sheets in front of you, let's do a summary and lines and telling me a little story about this place. Start out something like this is a building with several floors.

5
~~SECRET~~

~~SECRET~~

SUMMARY

HU-1058/8314/63

- #63: It's a building of many floors. We are interested in one or two floors. They're about half way up the building and it has a new feeling to it as though they just moved into that particular floor. I don't see a lot of furniture or anything else, (mumble) a lot of people (mumble). Half of, half of that floor seems vacant to me. You access that room by elevator and you arrive into a lobby, small lobby, colors are blue and white. And to the left as you come out of the elevator is a viewing window like receptionist's window or something, like she has to buzz the door for you to be able to come in any further than the lobby. And behind that receptionist's area is the boss's office.
- #66: We'll walk through your structure here and tell me how you came to arrive that there was some one central figure of interest.
- #63: Because of the void feeling of the floor, I kept being drawn back to the left rear corner of the area. And the rest of the building felt vacant, but I came to that one area, that's where all the activity that was taking place, on that floor, was taking place.
- #66: Okay. Let's look at your activity stage 4 matrix and summarize it.
- #63: Um...I have a man, I have this exclusive guarded, temporary and concentrated of the intangibles I have.
- #66: What was the word? What were words again?
- #63: Exclusive, guarded, temporary and concentrated.
- #66: All right.
- #63: Feel like he's doing the whole thing himself. He has people coming and going and they're helping him, but he's in charge.
- #66: And what is it this thing that he does?
- #63: He's planning something.

~~SECRET~~

~~SECRET~~

- #66: Okay.
- #63: He is medium height, little----
- #66: --And you feel as though there is some focus on this singular individual, something that concerning this singular individual?
- #63: Um, um. I feel that people are a little frightened of him, people who deal with him, maybe are afraid to...to wrong him in any way.
- #66: Okay. So when I asked you to do a stage 4 matrix on personnel, you broke out several things and looked like you tried to focus on one particular person, so we called that person the boss.
- #63: The boss, right.
- #66: Okay. Let's look at the stage 4 matrix of boss and summarize.
- #63: Okay. He is ah..solid physically, built about like you are. He is self assured, he's in charge and he knows it. There's many people coming and going. He seems friendly on the outside, but that's in order to accomplish his mission. The people that deal with him are little frightened of him, I believe. He's dominant, he controls the people. I believe he's light complected, wears casual clothes, has dark hair, perhaps black hair and a beard.
- #66: Okay, now you had some intangibles in terms of language?
- #63: Yes, he's foreign, I believe.
- #66: Okay, he's foreign.
- #63: But he speaks English. All the transactions that I saw him doing there seem to be in English.
- #66: All right. When you say foreign, do mean foreign to the location that he's in now or do you mean foreign to you and I or don't you know?
- #63: Let me think about it for a second.I don't know.
- #66: Okay.

~~SECRET~~

~~SECRET~~

#63: His location is in that back room and 6 or 7 comes to mind, which perhaps the 6th or 7th floor of that building.

#66: Okay. Now, looking at your page where we broke structure, you need to summarize out of that.

#63: Okay. That's the plan he seems friendly to accomplish his goal, foreign but speaks English, he's a loner. But his plan doesn't, isn't for around the area where he's in, it's for elsewhere. I tried to get elsewhere, but I couldn't. I see a city, I do see a city.

#66: Okay.

#63: --That the plan is for some city somewhere and people coming and going and that's it.

#66: Okay.I have no further information, but I would like for you to look at what you've got and see if you would like to do your own stage 4 matrix with any of the elements that we've explored or one that you would like to explore. Perhaps there is something on the signal line that we have forgotten to ask about that needs to be asked.

#63: I would like to come back again tomorrow and work on this again.

#66: All right. Let's do an end then.

#63: Okay.

~~SECRET~~

S-2

D

AI

EI

T

I

AOL

SIG

Blue
white

access
by
elevator

protected
area

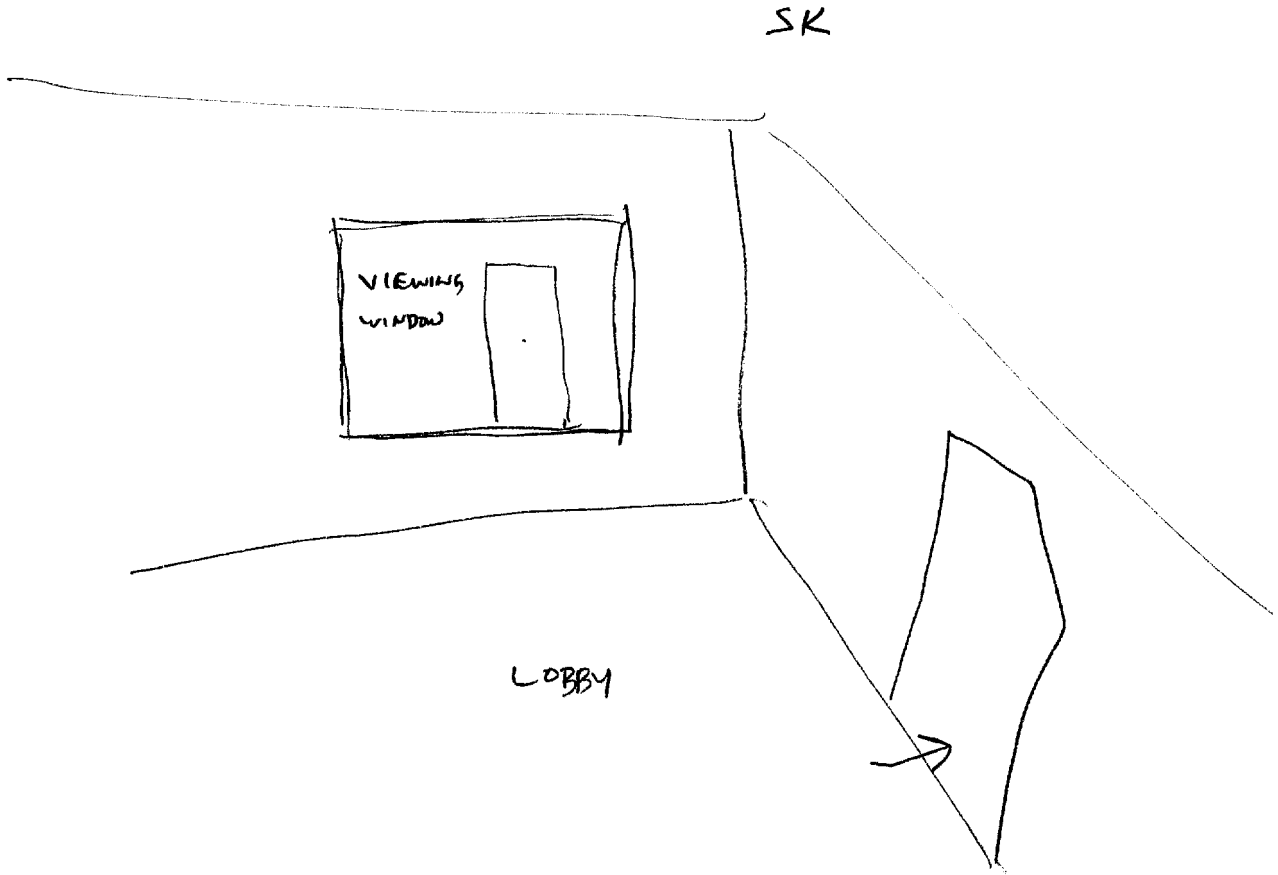

quiet
blue
white

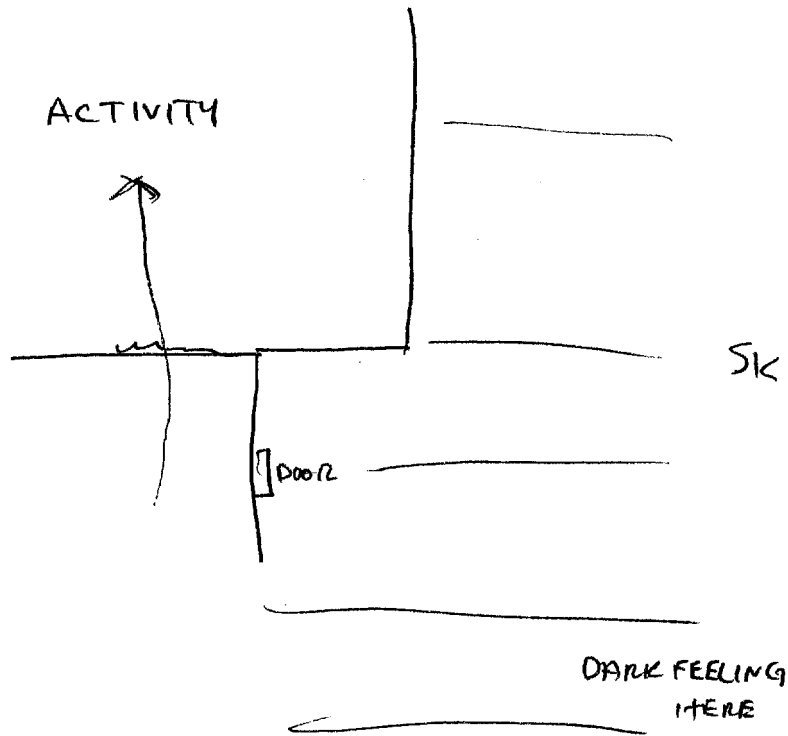

Aal Beal
 Feels abandoned
 Empty

SZ D AI EI T I AOL SIG

new Arah
 Strange new

Parkside
 Rooms

S-2 D AI EI T I AOL SIG

exclusive
guarded

Man

temporary
concentrated

AOL Base 2

declassified
↓

temporary feeling
one man, just moved in
about to move out
occupy one whole floor
however only small portion
used.

PERSONNEL

S-2 D AI EI T I AOL SIG

man

light
complexion
pale
dark
hair
beard

PERSONNEL

SZ D AI EI T I AOL SIG

one
main
figure
Boss

Boss

SZ D AI EI T I AOL SIG

solid
self
assured
in charge
firm

scary

has
many
people
under him

stocky
black
hair
beard
light complexion
casual clothes
dominant

dominant

controls people
People coming and going

SZ D AI EI T I AOL SIG

Planning something

Break

S-2 D AI BOSS LOCATION I AOL SIG
EI T

Woody
light headed

hot and
cold
Sunny

AOL Peak
Southern
Hemisphere

607

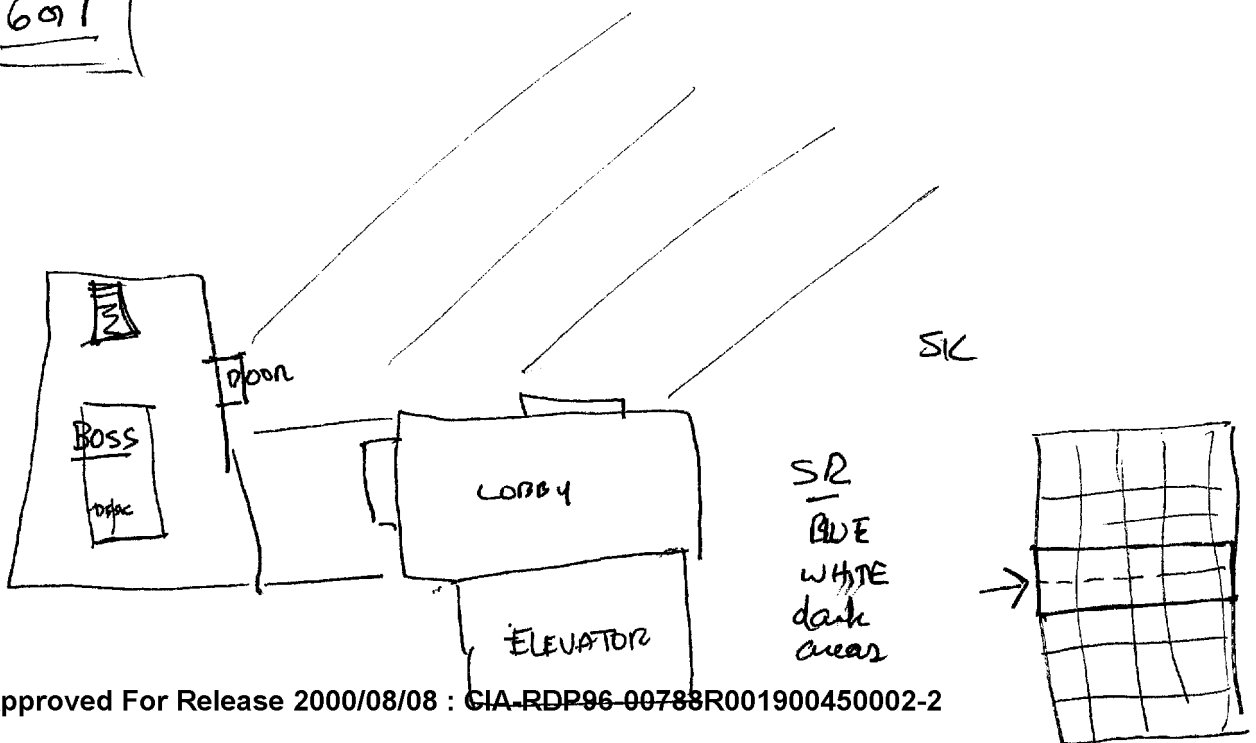

Plan

seem friendly
to accomplish goal

foreign
speaks English
loves lower

Plan is for elsewhere
another building

~~Asl Book~~
NY

people coming out
going

helping with planning

Break

Sum:

Building

many floors

1 or 2 floors of interest

1/2 up building

new feeling

elevator

small lobby

colors blue and white

behind reception area

is losses office

BOSS

Planning something

foreign speaks English

loner

black hair-beard

stocky build

End

~~SECRET~~

AGENT REPORT

For use of this form, see FM 30-17(C); AR 381-20; the proponent agency is the Office of the Assistant Chief of Staff for Intelligence.

1. NAME OF SUBJECT OR TITLE OF INCIDENT

SG1A



2. DATE SUBMITTED

3. CONTROL SYMBOL OR FILE NUMBER

HU-1058/8314/63

4. REPORT OF FINDINGS

On 20 December 1983, Source IS-63 was interviewed concerning personnel and activities within a building complex to determine if there was any intelligence interest in the complex. Source stated substantially as follows:

The building was occupied by more than one tenant or group (not further identified). Approximately half way up the building there were one or two floors of interest, a "protected area" (not further identified). Access to these floors was by elevator. Portions (not further identified) of the building were empty or abandoned. On one of these middle floors was an office (position unknown) where most of the activity seemed to occur. Adjacent to this office was a lobby or reception area which controlled access to the office. Something about this location was new, as though the room had just been occupied.

Activity in the office centered around one main figure, a "boss." This "boss" controlled other people (not further identified) who visited the office. They were making a plan (not further identified) for another building in a city (not further identified). The activity was "exclusive, ..guarded,temporary." The "boss" was male, wore casual clothes, appeared foreign (not further identified) and spoke English; he had a stocky build, a light complexion, black hair, and a beard. He was "solid, self assured, in charge, firm, a loner and scary."

No further amplifying information concerning SUBJECT was obtained from Source during this interview.

AGENT'S NOTES: Information provided by Source relevant to descriptions of rooms or offices may be accurate independent of their locations within buildings. Source is sometimes unable to accurately relate the position of rooms within buildings, or the position of a building within a group of buildings, due to the nature of his access to a targeted area.

WARNING NOTICE: SENSITIVE INTELLIGENCE SOURCES AND METHODS INVOLVED

CLASSIFIED BY: CDR, INSCOM
DECL: OADR

NOT RELEASABLE TO FOREIGN NATIONALS

5. TYPED NAME AND ORGANIZATION OF SPECIAL AGENT

6. SIGNATURE OF SPECIAL AGENT

DA FORM 341

~~SECRET~~

INCL 3