

*ke*  
*is the basic intelligence*  
*question of significance*  
*in the*  
*11-11*

~~SECRET~~/NOFORN - SKEET CHANNELS ONLY

PROJECT SUN STREAK (U)

ERV SESSION PROCEDURES REPORT

WARNING NOTICE: INTELLIGENCE SOURCES AND METHODS INVOLVED

CONTROL NUMBER: 8713

NICKNAME: None

DATE OF SESSION: 6 Oct 87

TARGET COUNTRY: Unknown

REFERENCES: None

SESSION NUMBER: 01

DATE OF REPORT: 8 Oct 87

MISSION STATUS: Continuing

TECHNIQUE UTILIZED: ERV

SOURCE IDENTIFIER: 079

1. (S/NF/SK) INTERVIEWER TASKING: This is the initial session of a new project conducted utilizing this Source. Specifically the Interviewer is to task the Remote Viewing Source to provide data on a specific site to include the general external configurations purposes of any structures and objects at the site and data pertaining to the development and utilization of materials/objects at this site. The Interviewer has not been made cognizant of the true nature of this site. The Interviewer utilized the encrypted coordinate of "14752/1213," which is a departure from accepted protocols of two six digit coordinates. There were no indications that shortened coordinates had any noticeable affect on Source's performance in this session and She was able to quickly adapt to this rather small departure from past procedures.

2. (S/NF/SK) SOURCE TASKING: Source was specifically told that this "will be a new operational target that you have not worked before. I want you to be prepared for unusual coordinates. This should not affect you". Source was not provided with any further cues or descriptive data pertaining to this target prior to the session. This session was conducted utilizing Extended Remote Viewing (ERV) protocols in its entirety.

3. (S/NF/SK) INCLEMENCIES: Approximately half way through the formal session component a tractor driven lawn mower began cutting the grass around the operational site. The noise was so overpowering that the Interviewer was required to stop the session so until the outside maintenance activity had abated. Source, in post session interviews stated that She did not hear the noise and therefore it is unlikely that the interruption had any lasting effect on the session data. There were no other reportable incidents or anomalies which

*11-11*  
*11-11*  
*11-11*

*Activity*  
*11-11*

*11-11*

*11-11*

A: SAR 79-13.#01

~~SECRET~~/NOFORN - SKEET CHANNELS ONLY

may have influenced the data obtained in this session.

4. (S/NF/SK) SUMMARY: Source furnished the attached summary which was prepared following the session and submitted to the Interviewer within twenty four hours following the session. The completeness of the typewritten summary has been compared to the Interviewer's notes and all omissions, changes, and/or corrections have been verified as acceptable by the Interviewer. The information provided in the summary was found to be a complete accounting of the data provided by the Source during the session and did not require further modification, clarification or additions by the Interviewer.

5. (S/NF/SK) COMMENTS: Source's impressions and post-session summary would seem to indicate that Source's impressions at the site were confusing and erratic. The data provided by Her concerning Her impressions was ambiguous with no single clearly definable thread of information that could have been exploited by the Interviewer. It is necessary to note again that the Interviewer is unwitting as to the exact nature of the target site and therefore the existence of specific cues and relevant data may have gone unrecognized. Source tended to attempt to label items in the session which caused the Interviewer to spend an inordinate amount of time directing the Source to describe these items rather than label them. There did not appear to be any one specific item or activity of interest at this site which "attracted" the attention of Source however, in post-session interviews She commented that She "felt" there was something of interest within the structure and that given more time to "explore" the facility She will locate this item and provide the necessary data. This is an unusual insight by a Source and may be indication that the Interviewer's efforts to maintain structure may have actually impeded the Source's efforts to "go to the item" of interest. It is a tricky question of trade-offs which may require further introspective analysis by the Interviewer in subsequent session.

SGFOIA3

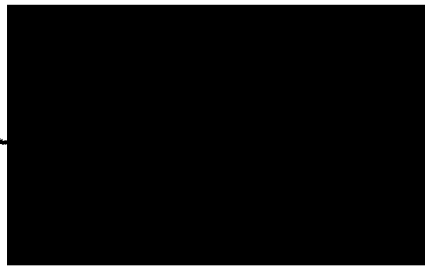

~~SECRET~~/NOFORN - SKEET CHANNELS ONLY

SOURCE 079  
6 OCT 87

# Summary

AT FIRST I FELT THAT I WAS INSIDE A VERY BIG, HARD, DEEP OBJECT. I WAS STANDING IN THE MIDDLE AND THE SIDES OF THE OBJECT WERE ROUNDED AND WERE NOT EVEN. THE SIDES WERE NOT EVENLY LINED UP. I HAD THE FEELING OF BLOCKS AND BREAKAGES.

LATER ON DURING THE SESSION, I FELT THAT THIS OBJECT WAS A STRUCTURE. THE STRUCTURE WAS HARD, SQUARE, TALL, WIDE, AND BIG. THE STRUCTURE HAD A TRIANGULAR BASE. THE SIDES OF THE STRUCTURE WERE POINTED. I KEPT LOOKING UP AT THE STRUCTURE BECAUSE IT WAS SEPARATED INTO BLOCKS AND I COULD SEE PEOPLE SITTING AT THE TOP WITH TABLES AROUND THEM. THEY WERE OBSERVING AND LOOKING OUT. THEY WERE CHATTING TO EACH OTHER. IT WAS A NICE LOCATION AND THIS WAS A RELAXED ATMOSPHERE.

THE AREA AROUND THE STRUCTURE WAS BIG. I COULD SEE PEOPLE WALKING AND MOVING FREELY. IT WAS A BUSY AREA BUT NOT CROWDED. THE AREA WAS CLEAN AND WELL KEPT. IT WAS PLAIN, SIMPLE, AND NICE. THERE WAS A ROAD NEARBY. I COULD SEE SOME GREEN GRASS BUT THERE WAS WHITE CEMENT NEAR AND AROUND THE STRUCTURE. THERE MAY BE A PARKING AREA NEARBY.

ONCE INSIDE THE STRUCTURE, I WAS FIRST IN A BIG, ROUND, CIRCULAR AREA. I COULD SEE A LARGE, CIRCULAR PIECE OF FURNITURE THAT LOOKED LIKE A DESK AND THERE WERE WOMEN HERE WHO STOOD BEHIND THE DESK AND HELPED PEOPLE AS THEY ENTERED. THERE WAS AN OPEN STAIRWELL GOING UP IN A CIRCULAR MOTION BEHIND THE DESK. IN THE BACKGROUND, I COULD SEE LARGE SHELVES AND IT LOOKED AS THOUGH

AGAIN  
079  
6 Oct '87

BOOKS WERE SITTING ON THE SHELVES. THE FURNITURE AND THE SURROUNDINGS INSIDE THIS AREA WERE EXQUISITE. I COULD SEE LARGE WINDOWS WITH BIG DRAPES HANGING ON THEM. IT LOOKED AS THOUGH SOMEONE HAD JUST REMODELED THIS AREA. IT WAS VERY CLEAN AND BEAUTIFUL. I KEPT SEEING LARGE BLACK AND WHITE SQUARES IN THIS AREA. I HAD THE FEELING THAT THIS AREA HAD SOMETHING TO DO WITH HISTORY OR THE PRESERVERANCE OF HISTORY. I HAD THE FEELING THAT PEOPLE READ PAPERS HERE IN THIS AREA. I ALSO HAD THE FEELING THAT PEOPLE "SERVE" HERE. "SERVING" CAME INTO MY MIND. I HAD A POLITICAL FEELING.

I SAW MEN WHO WORE SUITS AND THEY SEEMED RATHER IMPORTANT. THEY WERE WELL DRESSED. THE WOMEN ALSO DRESSED VERY WELL.

OVERALL, I KEPT WANTING TO GO WHERE TO THE UPPER LEVELS WHERE I SAW MEN AND WOMEN SITTING AROUND TABLES AND WHERE THEY WERE RELAXED.

①

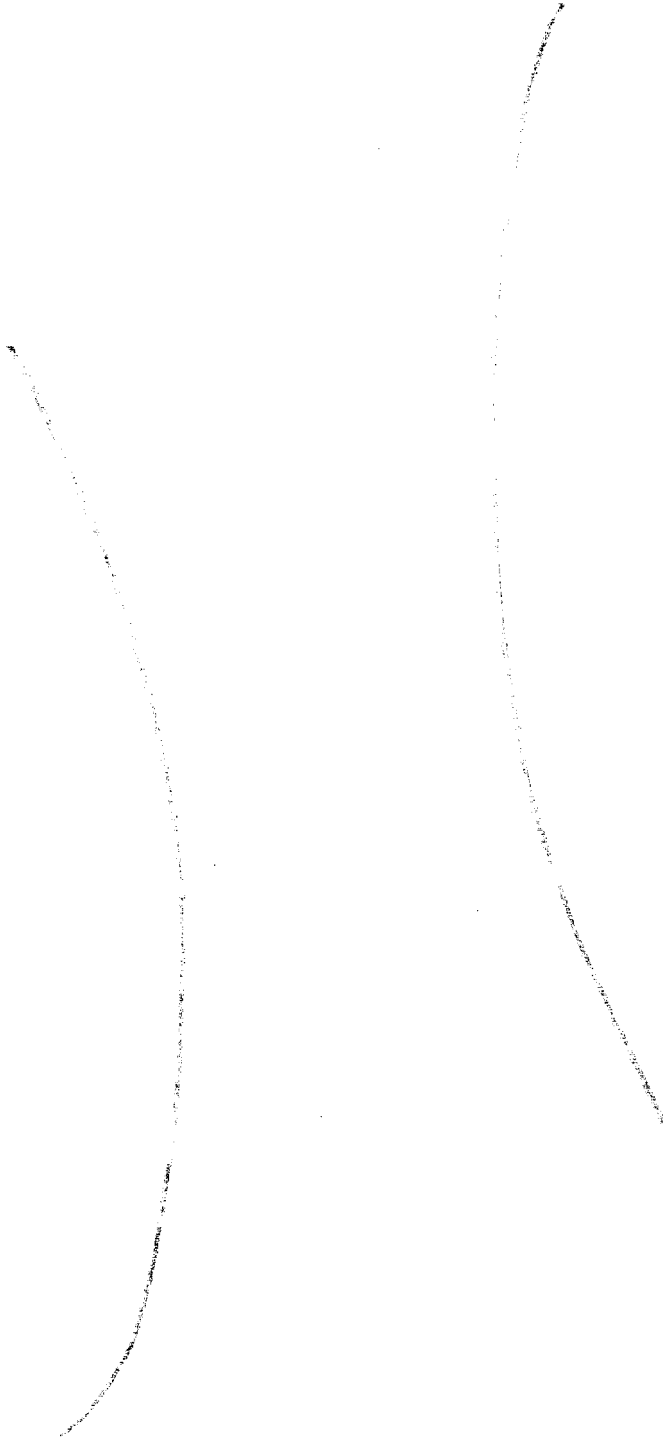

Should be in the same level / object  
Deep  
Put evenly lines up

(8)

blocker

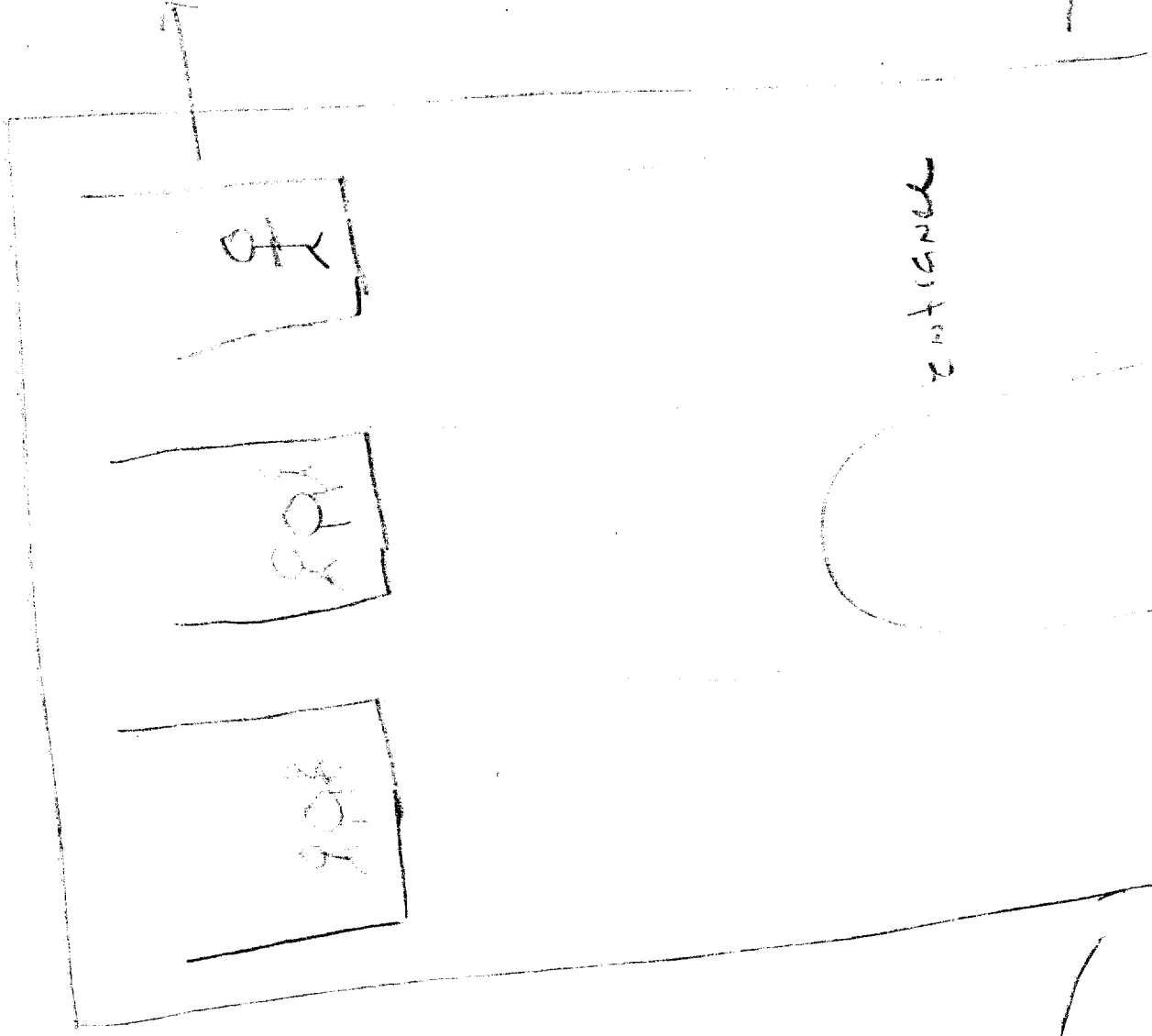

structure  
 People sitting  
 on top of  
 structure

VIEWER 079  
 8713  
 6 Oct 87

3

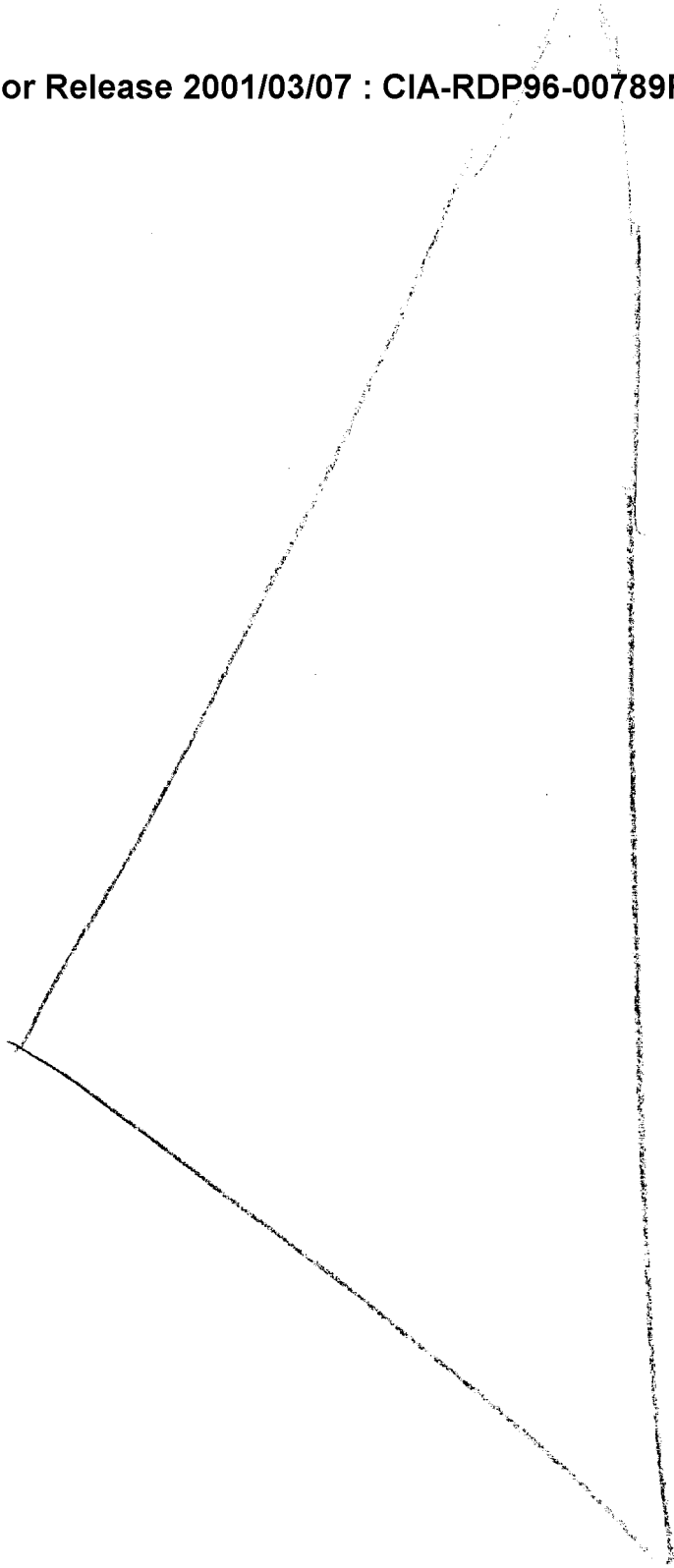

~~Triangular base~~  
Triangular Base of structure

VIEWER079  
60487  
8713

5

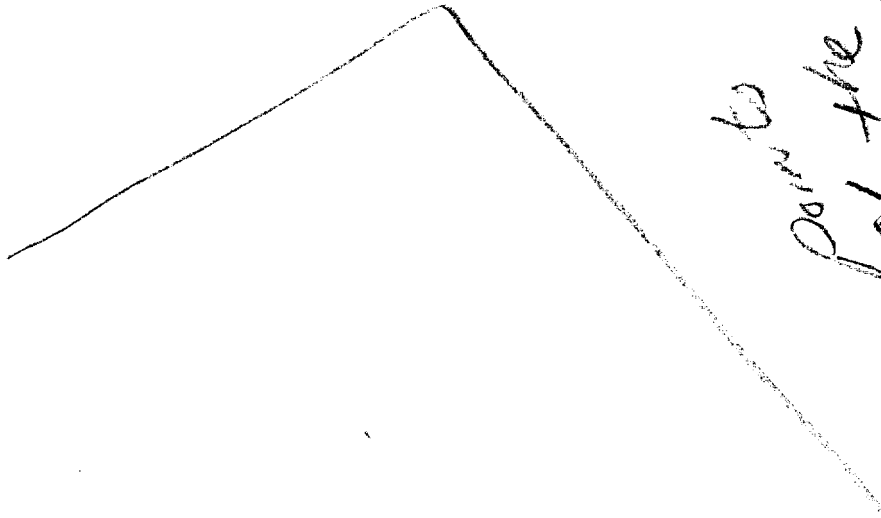

points  
to the  
structure

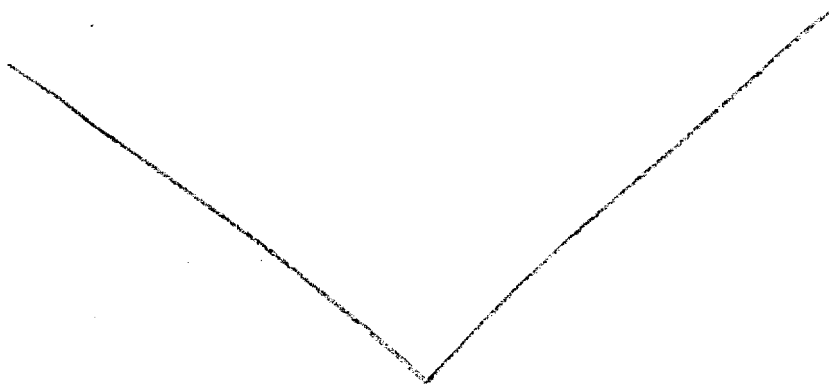



5

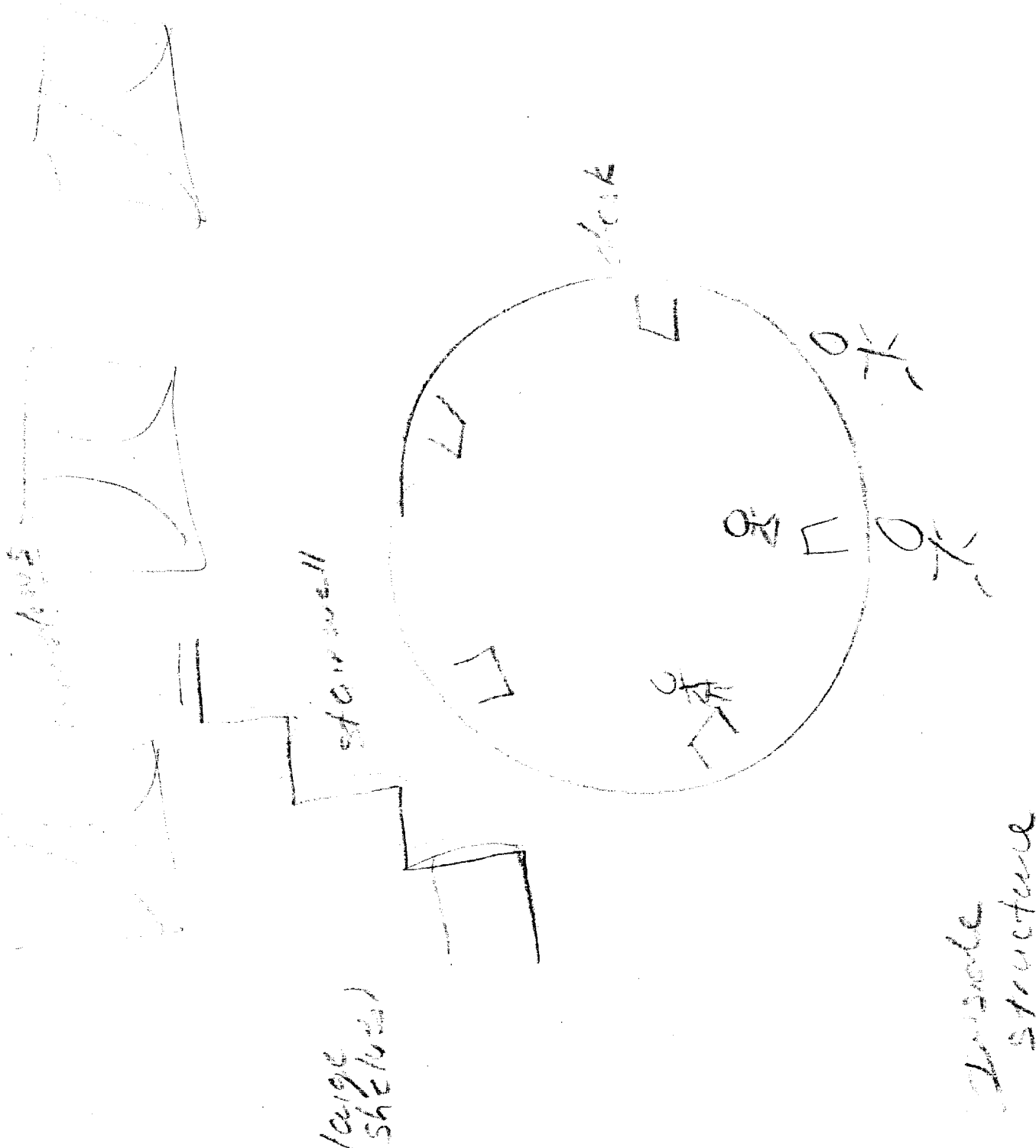

(2)

→ 1 4 7 5 2 / 1 2 1 3

★ WALKING UP TO AN OBJECT THAT IS VERY BIG, THERES A BREAKING, AN OPENING, A LARGE OBJECT BEING SEPARATED, DEEP, I'M STANDING IN THE MIDDLE OF THE BREAK, ITS HIGH AND DARK, THE OBJECT IS HARD, MEN ARE HOLDING PARTS OF THE OBJECT, THINGS YOU THROW OVER, THROW OVER THE BACK OF THE OBJECT, SOMETHING YOU THROW OVER TO MAKE IT WORK, MEN HOLDING IT TIGHTLY, MEN ARE HERE

→ DESCRIBE THE OBJECT,

★ ITS BIG AND ROUND, THE SIDES ARE BEING SEPARATED, MOVING UP, MOVING SIDEWAYS, THE OBJECT IS POINTED, LARGE TRIANGULAR SHAPE, HANDLING COMES DOWN AND OUT, THIS IS WHERE THE MEN ARE, A BRIGHT COLOR, SEEING THROUGH LIGHTS, THERES A BIG SQUARE SIDE THAT PROTRUDING OTHER OBJECT, THIS OBJECT IS SHARP, IT MOVES, IT MOVES

→ PAUSE - I WANT YOU TO USE A FEW MOMENTS TO RELAX UNTIL THE NOISE GOES BY - RELAX UNTIL I'M READY FOR YOU. - (TRACTOR MOVER OUTSIDE WINDOW) - 14752/1213

★ LARGE STRUCTURE - OPEN AT THE TOP, PEOPLE INSIDE AND OUTSIDE, STRUCTURE IS BIG, STANDING, HEAVY, STRUCTURE, PEOPLE HERE.

→ TELL ME ABOUT THE AREA AROUND THE STRUCTURE

★ BIG, NOT CROWDED, CLEAN, WELL KEPT, PLAIN, SIMPLE, NICE, GREEN GRASS, NOT HOT, NOT COLD, THERES PEOPLE WITH THE STRUCTURE

→ DESCRIBE THE STRUCTURE

(3)

★ ITS SQUARE , BIG, MORE OPEN AT THE TOP , QUIET HERE

→ CONTINUE TO DESCRIBE

★ SQUARE, WHITE, BLUE , BIG, OPEN AT THE TOP, PEOPLE SITTING AT THE TOP, MALE AND FEMALE , SITTING NEAR OPEN WOODEN AREA , THERE'S A ROAD NEARBY, TRAVELLING ROAD, VEHICLES ON THE ROAD, VEHICLES GOING -

→ STRUCTURE- DESCRIBE THE ACTIVITY

★ PEOPLE SITTING DOWN, OBSERVING, WORKING, FEMALES HERE, PEOPLE ON THE UPPER LEVEL SIT AROUND AND CHAT, ITS A NICE LOCATION, MAN-MADE, BUILT FOR THESE PEOPLE, POLITICAL

→ RAW DATA

★ SERVING, I DON'T KNOW - THE STRUCTURE HAS, THE TOP HAS BLOCKS TAKEN OUT OR PUT IN, FORMED AND CHANGED SO PEOPLE CAN COME HERE

→ TELL ME ABOUT THE SHAPE OF THE STRUCTURE

★ SQUARE, TALL, THE TOP IS DIFFERENT THAN OTHER, PEOPLE WALKING, ENTRANCE (HEAD ON) IN FRONT, PEOPLE MOVE FREELY,

→ SHAPE OF THE STRUCTURE - STOP TELLING ME ABOUT PEOPLE

★ SQUARE, ...

→ MORE DATA

★ SQUARE, BIG,

→ DESCRIBE YOUR LOCATION

★ LOOKING UP

(4)

- TELL ME ABOUT THE DIFFERENT PORTION
- ★ BLOCKED OFF AREAS - HOLES CUT OUT AT DIFFERENT AREAS, PEOPLE GO TO THESE DIFFERENT AREAS, CIRCULAR INSIDE, BIG FLOOR, BIG HALLWAYS
- FOCUS OUTSIDE, REMAIN OUTSIDE - DIFFERENT PORTION DESCRIBE
- ★ THERE'S THREE DIFFERENT PORTIONS AND THEIR HIGH, CHANGES ARE HIGH, ...
- CONTINUE
- ★ SEPARATE BLOCKS
- BLOCKS RAW DATA
- ★ SET INSIDE THE STRUCTURE, DIFFERENT, BLOCKED OFF, IT'S WHERE THE PEOPLE GO
- FOCUS AROUND THE OUTSIDE, DESCRIBE THE ACTIVITY
- ★ PEOPLE WALKING, CLEAN AIR, CEMENT, MAYBE PARKING NEARBY, PEOPLE WALK PAST THE STRUCTURE
- OKAY, INSIDE -
- ★ ROUND, A ROUNDNESS, BIG HALLWAYS, ECHOING, DRAPED, VERY NICE INSIDE, HISTORICAL, THE FEELING OF A LOT OF HISTORY, PRESERVING HISTORY, BLACK AND WHITE
- RAW DATA
- ★ COLORS, ALL OVER, QUIET, A DESK, CIRCULAR DESK IN ROOM
- DESK RAW DATA

④

★ PEOPLE STANDING, BEHIND THE WOODEN DESK, HELPING RECEIVING, QUIET, MANY DIFFERENT FLOORS, GOING UP, MEN, VERY IMPORTANT MEN WORK HERE, MEN IN SUITS ARE HERE, OLDER MEN,

→ ACTIVITIES

★ WORK, PEOPLE TALKING, WALKING, READING PAPERS BACK AND FORTH, STUDYING, READING PAPERS. BIG SHELVES IN CERTAIN AREAS

→ SHELVES RAW DATA

★ STORING BOOKS, PAPERS, ALL IN THE BACKGROUND

→ PAUSE - FOCUS OUTSIDE - LEAVE THIS PLACE - RELAX 14752/12 13

★ ~~BY~~ UMM - STRUCTURE, WIDE, BIG, TALL, BREAKAGES

→ DESCRIBE TO ME BREAKAGES

★ THERE IN THE STRUCTURE, I SEE PEOPLE, MEN, I SEE WOMAN, THEY'RE WORKING, HOLDING TOGETHER,

→ CONTINUE TO DESCRIBE THE STRUCTURE

★ ITS TALL, (HARD), I CAN DRAW IT

→ DESCRIBE -

★ I'VE LOST IT

TERMINATE

constructs - 5 minutes  
objects