

6

SECRET/NOFORN-SKEET CHANNELS ONLY

PROJECT SUN STREAK (U)

WARNING NOTICE: INTELLIGENCE SOURCES AND METHODS INVOLVED

CRV Session Procedures Report (S/NF/SK)

Control Number	: 8704
Date of Session	: 26Mar87
Date of Report	: 26Mar87
Source Identifier:	003

SG1A

1. (S/NF/SK) Tasking: Original tasking data sheet attached. Monitor briefed [REDACTED] on 24 Mar 87 and requested to place collection emphasis on this specific aspect of the site.

2. (S/NF/SK) Session: Source a little lethargic. Session began in S4 after a review and refamiliarization/orientation using the area sketch produced during source's 24 Mar 87 session (sketch attached). S6 was employed at one point to determine whether or not anything passed in/out of the structure. Source feels that he has exhausted the signal line with regard to this target. Monitor asked source, once again, if he could attempt a sketch of the target. Source demurred, stating only that it was "massive, deep, and curved" which produced constant AOLs of "dam".

3. (S/NF/SK) Summary: Same basic description of structure as in earlier sessions. A/S of "radiation sign". Structure has a function of containing/surrounding vs enclosing. Within the structure, at the bottom, is a metal object ("protected, anchored, cushioned; containing, shielding") that is faceted or domed, curved and rounded. The top of the object may be unlatched to inspect the contents, which are dark grey, "implicate" (?), intricate, fixed, bumpy yet smooth, rounded and angled with interstices. "Pieces" are involved. People are present wearing uniforms or suits, whose tasks include monitoring, observing, inspecting, adjusting, reporting and making sure that parameters are maintained within the proper range (AOL-"reactor"). This place is not where people would prefer to be; people stay away purposely unless forced by duty obligations to be there. They feel that their job is important, but potentially dangerous; it is not pleasant, but the knowledge that "somebody has to do it" imbues them with a certain

SECRET/NOFORN-SKEET CHANNELS ONLY

CLASSIFIED BY: DIA-DT
DECLASSIFY : OADR

SECRET/NOFORN-SKEET CHANNELS ONLY

feeling of pride. Nothing leaves this structure except for information (status checks, reports, etc.)--its function is to make certain nothing gets out. However, during periodic maintenance or repair periods, something dangerous (debilitating, life threatening) may escape that seems to take the form of streams of particles rather than random molecules. (AOL-"radiation, chemical, bio").

4. (S/NF/SK) Feedback: Source was told that monitor would require further guidance from the ops officer prior to revisiting this site.

SG1J

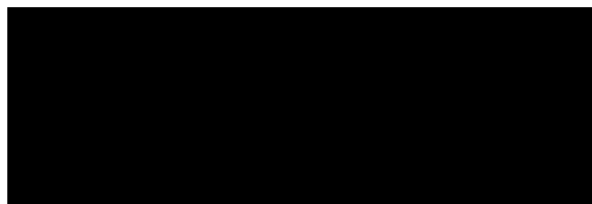

SECRET/NOFORN-SKEET CHANNELS ONLY

Project FY 8704

Interviews, Monitor Tasking

1. Describe the area (purpose of) located vic:

SG11



↳ (area used to ...)

2. Describe the structure(s) located 6km SW of the above area.

personnel, activities, equipment, etc.

3. to be announced

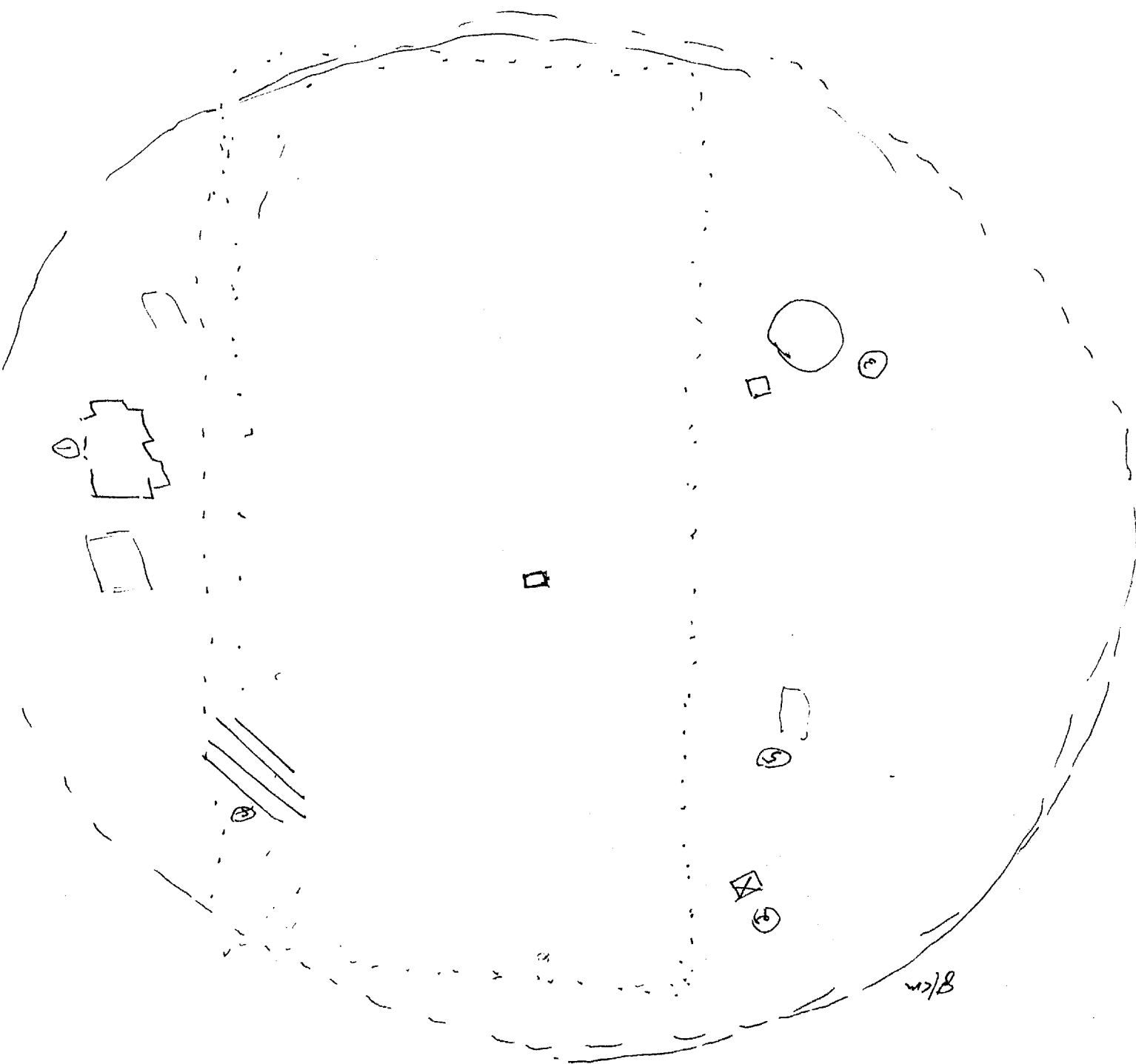

Paul
26 Mar 87
F. Mark MD
EJ
1031

S.2

D

A2

E2

T

I

AOL

A/S

Cement

thick
massive
open
deep
high
wild
Circular
angular
large

ladder

orange
also

A2 BK
very open

red

downed

A/S
radiation
sign

"fenced off"
Sign registers

S2 P A2 E2 T I AVL #15

large-scale

controlling
"heavy-duty"
large-scale

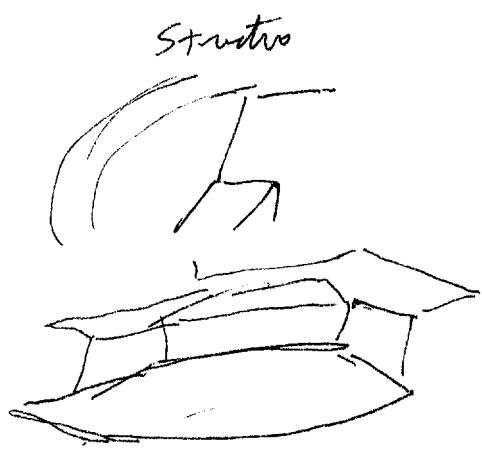

S4 1/2 outside function as opposed to inside - around instead of enclosing

brown

S4 1/2 dark - as in out of the sun

cool
quiet

metal
object

rounded

containing

as
blue

walkway

5 2

AI EI T I I L #/s

holding
supporting
shredding
perfectly
SECURITY
"anchoring"
anchoring

APLBIK
SEISMOMETER
COSMIC RAY
DETECTOR

inside

dark
gray
hard

complicated
intricate

for the
electronics

fixed
fine

"piece"

small
together

bumpy
rough
angled

smooth
constant res

S2

#1

#1

T

I

AVL

#15

S4 1/2 like you could unlatch the top half - like a cover - & lift it off to get at the insides.

S4 1/2 object sits there. Other keys nearby. These to be used on occasions when necessary. "Like" it monitors

people workers

S4 1/2 uniforms & suits - specific tasks aiming to be as/monitoring some certain stability or steady state or range of ^{limited} fluctuations ~~or~~ \rightarrow status quo is maintained.

- observe
- inspect
- adjust
- report

instrument monitoring

AVL IB1- reactor

S4 1/2 place is not one where people would prefer to be. people stay away on purpose unless forced by duty to be there.

S2 D AI FI T I AOL AL

S 1/2 sense that nobody "comes out," or it is so very rarely - + there only for maintenance or repair "type" activity.

Information comes out - status checks, reports, etc. Designed so nobody gets out.

S 1/2 people working feel job is important, but potentially dangerous. Not exactly pleasant, but "somebody has to do it," + they're a little proud of that.

Exposure
debits
life threatening

Yellow
~~Yellow~~
Vaporous
thin

Doc bk
of radiation,
chemical,
b.i.r

S 1/2 molecular level = AOL/AOL-S/sound of streams of particles - vs - random molecular wandering - 7 vpm.

Structure is tall & one deep, wide, with thick, very wavy
 concrete walls. Idea of structure is to "surround" rather than
 "enclose". Down deep is at least one object which exteriorly
 is vertical, curved, rounded with the idea of "~~vertical~~
 or domed
 being "held," "contained," "shielded," "protected," "secured," "enclosed," or "cushioned".
 The "top" might be unlatched & removed to access the contents,
 which are dark, "implying," intricate, fixed, firm, small, together,
 bumpy, yet smooth, round & angled w/interstices. Pieces are
 included

1123