

*21 MAR 88*

~~SECRET~~/NOFORN

PROJECT SUN STREAK

WARNING NOTICE: SENSITIVE INTELLIGENCE SOURCES AND METHODS INVOLVED

---

PROJECT NUMBER: 8801                      SESSION NUMBER: 1  
DATE OF SESSION: 09 Feb 88              DATE OF REPORT: 21 MAR 88  
START: 1326                                  END: 1427  
METHODOLOGY: CRV                          VIEWER IDENTIFIER: 003

---

1. (S/NF/SK) MISSION: Describe content of target building. Describe function and intended use of the content of the building.

2. (S/NF/SK) VIEWER TASKING: Access and describe the target at coordinate 113096/532189.

3. (S/NF/SK) COMMENTS: After describing a building complex, the viewer was shown a photo (xerox copy) of the target building and asked to describe the contents inside.

Viewer #003 described some general equipment and a variety of activities and projects which he felt were related to "research and development."

HANDLE VIA SKEET CHANNELS ONLY  
SPECIAL ACCESS REQUIRED

~~SECRET~~/NOFORN

Site involves a group of structures in a dim, cold, windy area. Flat is a predominate dimension at the site. One primary structure is rectangular, several stories tall, flat on top and fairly tall and large. There seems to be water nearby. Inside is a dimly-lit hall that makes a sharp turn to the left at the end. Inside is equipment that is large, metallic, dealing with precision, heavy, solid, rounded, dense, turning, and composed of numerous interconnected shapes. There is an object or apparatus that involves a cylindrical shape containing and shielding something that is long, rounded, solid, loose, smooth, assembled, connected, unitary, rounded, tapered, and bronze color. There is a person associated with this site who is not obnoxious but who is not someone one would especially seek out as a friend. He is very competent at what he does but tends to regard it as one of very few things worth doing, and has a slightly condescending attitude towards anyone else involved with anything else. Others exist to him only to the extent they can be useful to him in some way. The structure has a bureaucratic feel about it, political. An official/governmental sense as far as sponsorship is concerned. Some weighty things occur here but it seems more technocrat/concrete goal-oriented, like intermediate step in transforming abstract ideas into final, tangible results. Sense of bureaucratic science/engineering. There are devices present that are technical, sophisticated, complex, and involve computations, physics, interactions, and reinforcing effects. The idea of capitalizing on an effect where two forces/powers/effects/phenomena/physical laws can be brought together to build on each other, enhancing the "strength" or "impact" of the phenomenon.

Work at this location is more theoretical than actually production-centered. "Like" prototype might be built or tested, then taken apart to analyze; but sent elsewhere in the end for further, more mundane development. There is a sense both of hardware and "software" (not necessarily in sense of computers, etc.) being involved and necessary for performance of task requirement, "like" idea of a gun needs ammunition, a computer needs floppy disks, a Windex bottle needs Windex, etc. AOLs were experienced of fusion research and fuel/air munitions or binary chemical agents.

The idea of fluid mechanics, laminar flows, combining, and controlled conditions is present. Controlled conditions are necessary since not precisely controlled conditions produce unpredictable reactions. There is some concern that things can be made to work under strictly controlled conditions but never be ultimately practical "outside the lab." A donut-shaped ring was perceived that seemed to be composed of composite materials: metal "almost like" laminated or bonded to non-reactive, highly bestandhaft plastic-like material. There was a further impression of catalysis. There was also the idea of a venturi-type principle involved. Flowing substances/gases/fluid/plasma/whatever with long, integrated, even streaks like flows of differing substances temporarily non-mixing, moving along together in equilibrium maintained by surface tensions between the different substances. Any improper

and uncontrolled disturbance disrupts equilibrium and upsets effect and the "experiment" and can prove unpleasantly hazardous. Flowing material is amber with greenish, dark-brown streaks/lines. It is translucent, viscous and warm/hot. Constant steady heat. Specific inner environmental temperature and other variables require precision and precise maintenance to get required results. There is an impression that interference of flow generates static charges which must be dealt with so as to avoid destabilizing process and adding unpredictable variables. If precise conditions are not met, many other possible outcomes can result instead of the desired one. Balance is very delicate. An analogy would be if a particular kind of polymer was desired that was only slightly different in structure from many other polymers that were different in behavior and properties. Changing conditions only slightly resulted in producing any number of different kinds of polymers that were similar but not usable or satisfactory. Overall structure gives the sense of many, varied eclectic projects and applications for what is going on in the building. There is an element of national interest here, involving military, communications, economics (i.e., economic advantages of having process/engineering/equipment breakthroughs. Not just one thing is happening here, but rather a bunch of different activities. Overall the idea is that the structure houses a variety of R&D related projects.

Paul  
9 Feb 88  
F. Meade, MD  
met  
1326

113096  
53 21 82



A. above  
flat  
bar

B. low

A. above  
waves  
this  
part

A. above  
flat  
under  
split

B. surface

A. by above  
under above  
dark  
solid

B. surface

S2  
hard  
grey  
dark  
cold  
short  
hard

bright  
grey  
dark

open  
wide  
slip  
front

A2 B2  
feet exposed

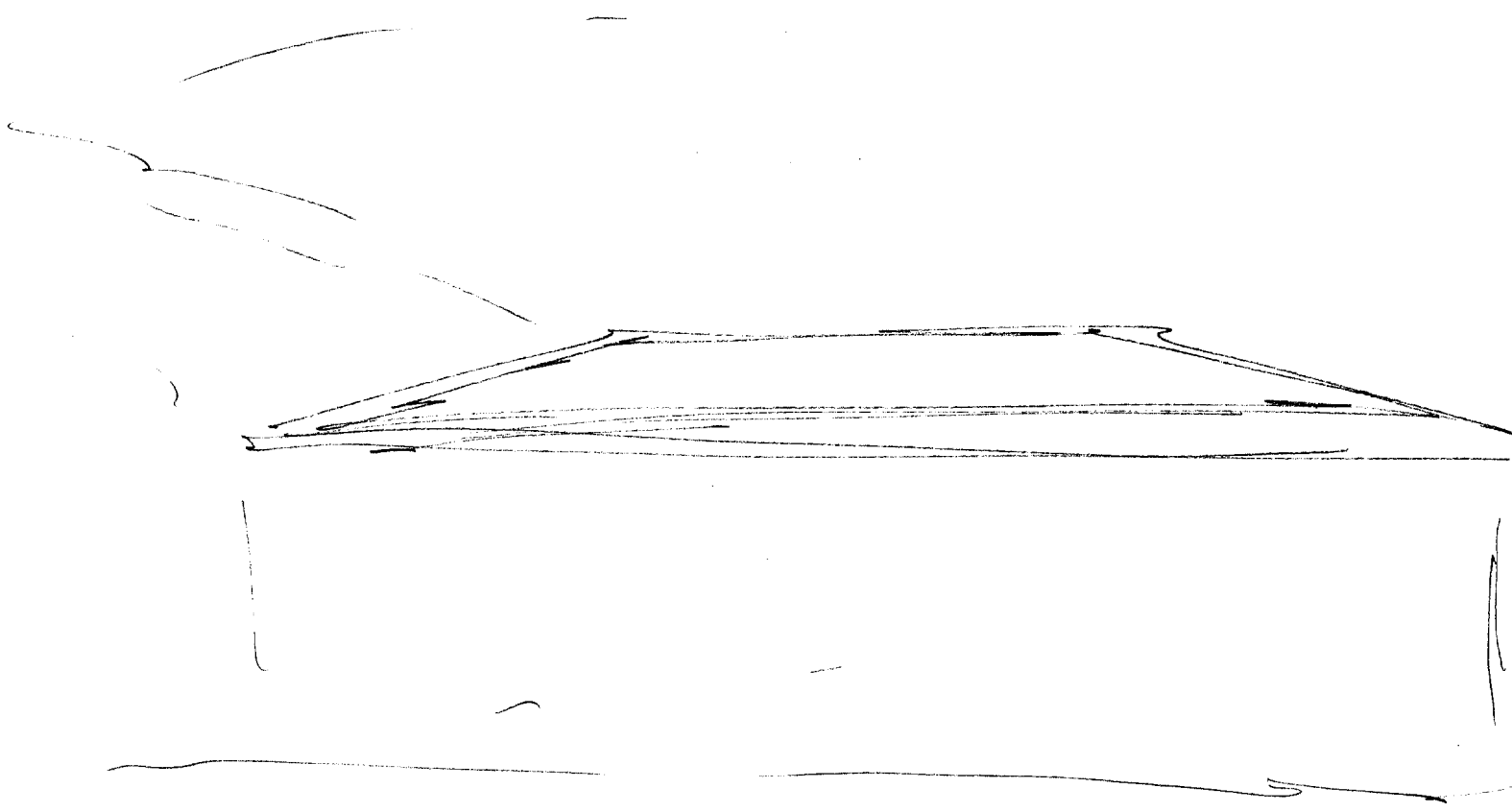



S2 D A2 EC T I

for Ho

dim  
kavle  
clouds  
cold  
windy

open  
flat  
angle  
solid  
up

cold

bed  
orange  
grey

structure

flat

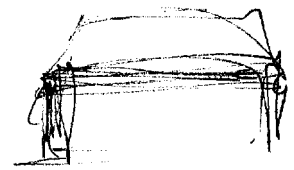

water

heavy

level  
angle  
large

S-2 : D #2 E2 T J JOL UAG

Several

Structure

my

large

flat topped

feebly

S-2 seems to be after dark here and at least ~~at~~ at dusk. Cold windy.

#2 B2  
heavy  
settling

Structure

divided

known  
lighted  
human

hallway

A1 Bk  
depressing

S-2 sense of a corridor, walls lit with change of direction at  
end of it.



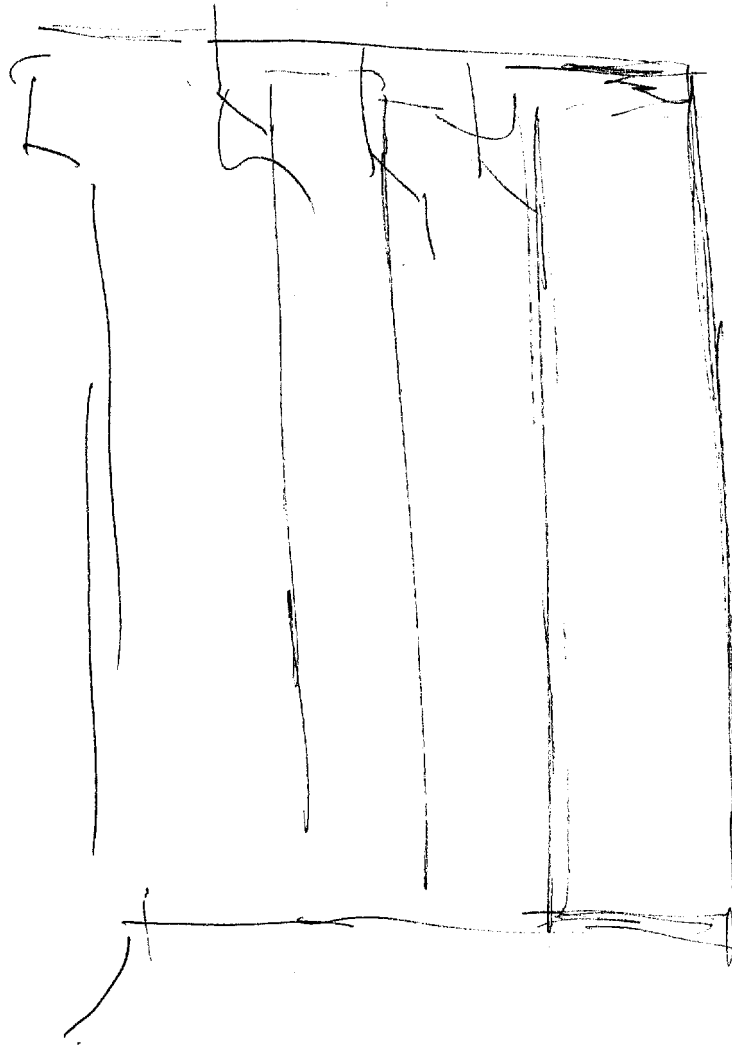

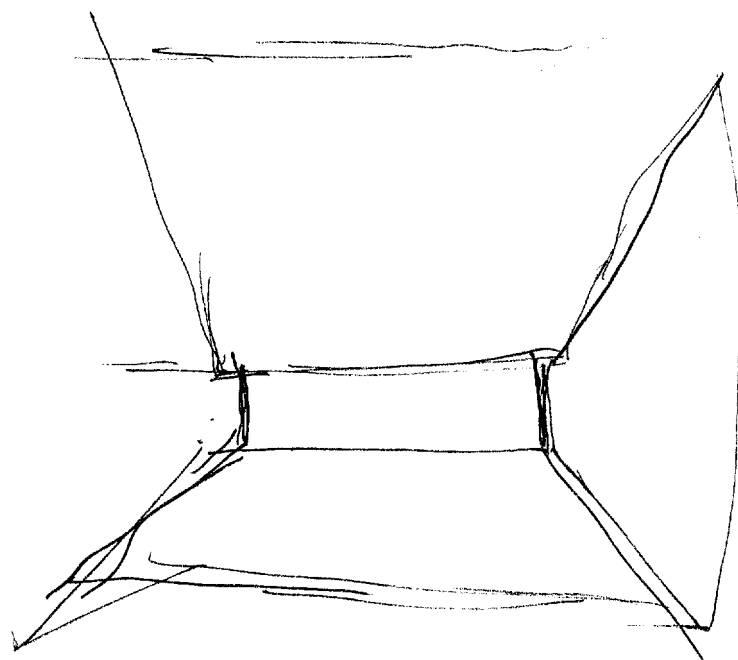

S VI

6

52

D

R2

EI

T

I

ADL

H/S

rooms

Cabinet

large  
open

rooms

laboratory  
like

white  
fibers  
clean  
solid

equipment  
metallic

precision

heavy  
solid

electrical

parts

rooms

blade  
silvery

turning

rounded

substantive

dense

thermo couple

6a

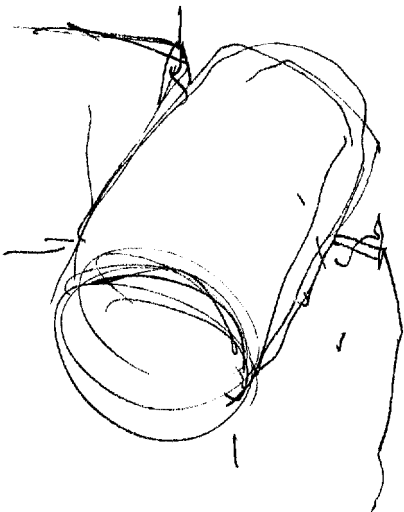
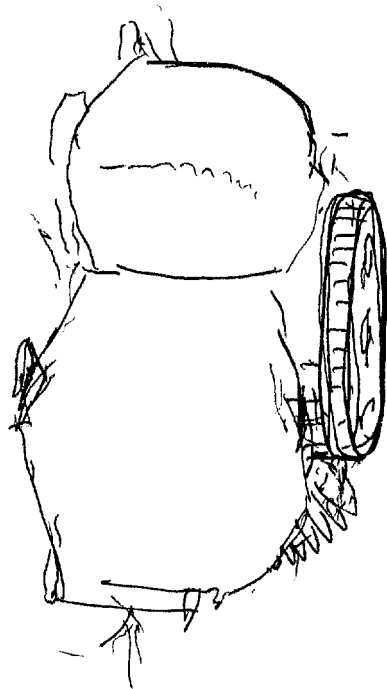
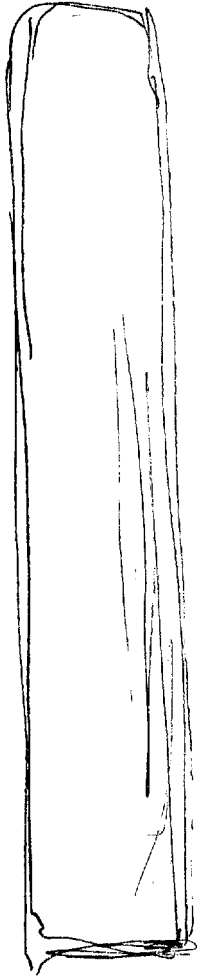

6a

S.2

Cylinder

combustion  
noisy  
huddling  
shielding

Sel's something long, rounded, solid, loose, smooth, assembled, rounded, military, rounded, tapered bronze color,

404 like pencils one of front end of a 40mm grenade

people

thinking  
whistle  
discussion  
announcing

person

short  
vocal

glasses  
balding

Sel's not strongly obnoxious but not someone you'd seek out as a friend - non personable. Narrow. Very competent at what he does but tends to regard it as one of very few things worth doing & has a slight condescending attitude toward anyone involved with anything else. Bureaucratic feel: Political. Other Exist

512 : <sup>503</sup>  
to know only to the extent they can be useful to him  
in some way.

AZ BK  
source of  
facilities,  
depression, boredom,  
dead-endness  
officialdom

513 The official/governmental sense as far as sponsorship is  
concerned. Some very good things occur here but seem  
more technocrat/<sup>concrete</sup> goal oriented like intermediate in transforming  
abstract ideas into final tangible results. Sense of  
bureaucratized science/engineering.

Devices

technical  
sophisticated  
complex

nuclear

computations

formulas

physics  
interactions  
reinforcements

514 idea of capitalizing on an effort where two  
~~the~~ forces/powers/effects/phenomena/physical laws can  
be brought together to build on each other, enhancing the  
"strength" of the phenomenon

SUZ

9

S2

FZ

FZ

I

HVL

H5

S4/2

work here is more theoretical than actually  
 production centers. "Like" prototype might be built  
 & tested, then taken apart to analyze; but sent  
 elsewhere to the end for further development.  
 Some of both hardware & "software" (not necessarily  
 in sense of computers etc) being involved & necessary  
 for performance of task requirement "like" idea  
 of ~~gun~~ gun needs ammo, computer need floppy disk  
 index both needs wheels, etc.

Person

highly qualified  
at what he does

AOL Bk  
fusion  
research

AOL Bk  
Facilitator  
humint  
or binary  
chem agents

laminar  
flows

controlling

fluid mechanics

controlled conditions

S4/2 ~~unimportant~~ ~~concern~~ ~~that~~ ~~it~~ ~~can~~ ~~make~~ ~~under~~ ~~such~~ ~~cond.~~ ~~it~~ ~~ing~~ ~~but~~ ~~never~~ ~~be~~  
 validated practical outside lab

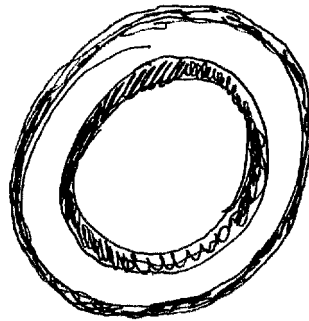
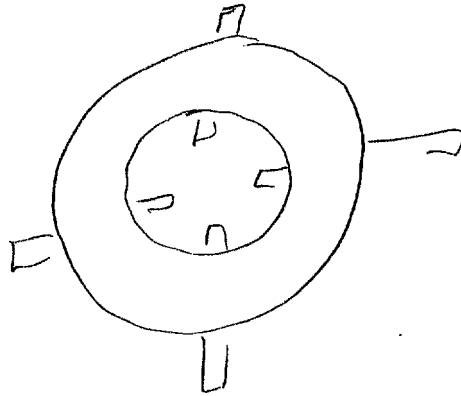

Composite materials  
metal + non-reactive  
highly resistant to  
plastic like material  
Almost like laminates  
in bonded. Impression  
in analysis

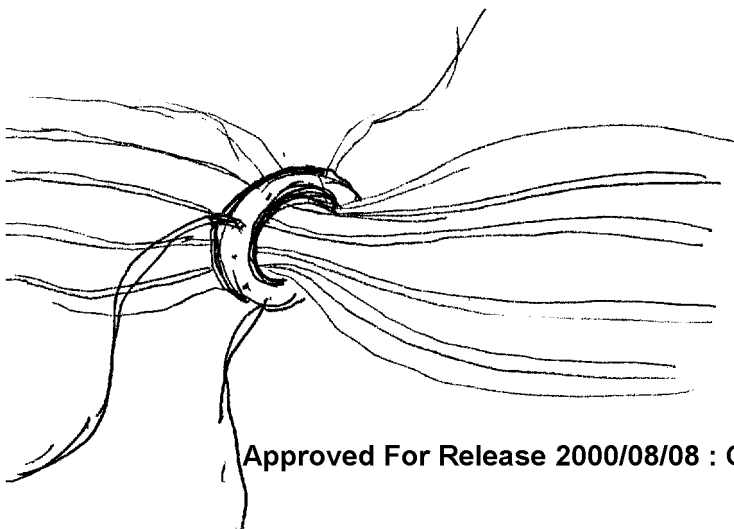



SVI

52 D PI E T L AZL A(2)

sets idea of Venturi type principle involved. Flowing substance pores / ~~fluid~~ fluid / plasma / water with long, integrates even 3+ weeks like flows of differing substances temperature non-mixing moving along together in equilibrium maintained by surface tension between the different substances. Any imperfection & uncontrolled disturbance disrupts equilibrium upsets effect & experiment & can prove unpleasant hazardous.

amber  
dark brown  
greenish  
translucent  
opaque  
v. 3.000  
warm hot

magnitor  
galvanometer

heat  
constant  
steady

temperature

sets specific <sup>thermal</sup> environmental temperature & other variable requires precision & precise maintenance necessary

507

11

52

I VOL ALS

Static

Static

blending

5/4/2 interference of flow generated static electrical charges must be dealt with so as to avoid destabilizing process + adding undesirable variables. One result is desired but unbalanced variables can cause several other, non-desirable results to occur. "Like" one particular polymer might be desired, but slight variation in conditions could produce any number of undesirable polymers.

applications (C)

high energy physics

5/4/2 Some of many, varied practical applications for what is learned/developed/~~explored~~ here - most of national level interest involving military, commerce, economics (i.e. - economic breakthroughs + engineering + equipment breakthroughs)

Sense that ~~is~~ not just one thing is happening here, but rather a bunch of different ~~sides of R+D explorations~~ activities. Overall idea is that structure houses a variety of R+D related projects.

1427