

*22 Mar 88
Shane*

~~SECRET~~/NOFORN - HANDLE VIA SKEET CHANNELS ONLY

PROJECT SUN STREAK (U)

WARNING NOTICE: INTELLIGENCE SOURCES AND METHODS INVOLVED

PROJECT NUMBER: 8802	SESSION NUMBER: 3
DATE OF SESSION: 22 MAR 88	DATE OF REPORT: 22 MAR 88
START: 0843	END: 0910
METHODOLOGY: CRV	VIEWER IDENTIFIER: 011

SG1B

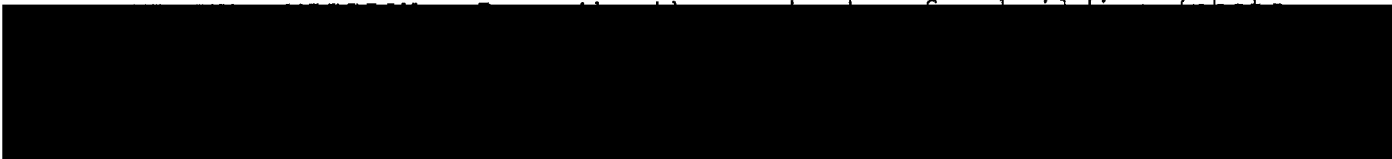

2. (S/NF/SK) VIEWER TASKING: 011 was informed that this session was to be the third attempt to acquire and describe an operational target (see 011 sessions #1 & #2, 10 Feb 88 and 08 Mar 88, respectively). After successfully acquiring the site in Stage 1/2/3, the viewer was moved inside the target structure to explore. When what seemed to be a key area (in terms of the EEI) was perceived, 011 was instructed to sweep a time line, back and forth from past to future and report any changes in the area.

3. (S/NF/SK) COMMENTS: An excellent session; looks like 011 answered the mail. The AOL ("artillery manufacturing", etc.) is interesting, and may represent useful data...to someone.

SG1J

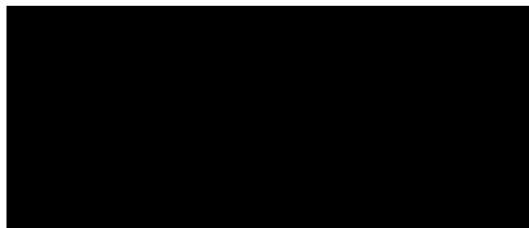

~~SECRET~~/NOFORN - SKEET CHANNELS ONLY

CLASSIFIED BY: DIA-DT

DECLASSIFY ON: OADR

SESSION SUMMARY

SG1J

SESSION: 22 MAR 88, 0843-0910



THE TARGET IS A LONG, RECTANGULAR STRUCTURE. IT APPEARS TO BE TALL, BUT NOT TOO TALL, PERHAPS 2-3 STORIES; NO MORE THAN THAT. THE INSIDE OF THIS BUILDING IS DARK, DINGY AND DIRTY, EVEN THOUGH THERE ARE WINDOWS ALMOST FROM FLOOR TO CEILING. THERE SEEM TO BE WOODEN PALLETS LYING AROUND IN DISARRAY, BUT THE OVERALL FEELING IS ONE OF SPACIOUS EMPTINESS, LIKE AN ABANDONED WAREHOUSE. MOVING BACKWARD IN TIME, I GET THE FEELING OF PALLETS, FORKLIFTS, MACHINERY, AND AN OVERALL IMPRESSION OF LIGHT INDUSTRIAL MANUFACTURING.

UNDECLARED RECURRING ADL: LIKE MANUFACTURING OF ARTILLERY PROJECTILES SOMETIME IN THE PAST. NOT AT THE PRESENT, BUT IN THE PAST. PERHAPS EVEN DURING WW II.

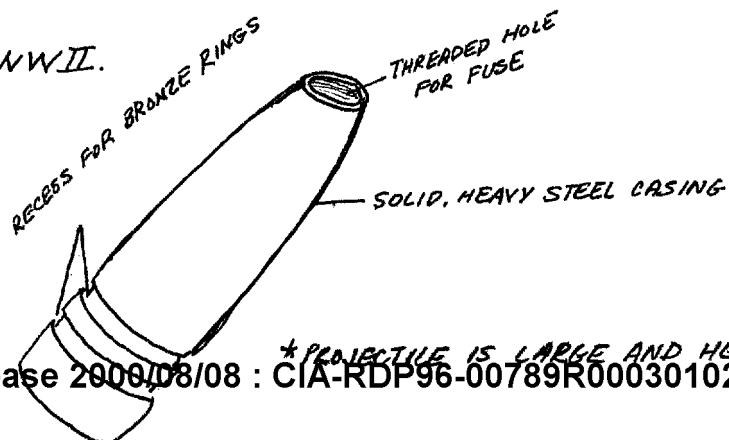

* PROJECTILE IS LARGE AND HEAVY; APX 50-75 LBS.

*Pls - none
AVS - none*

SG11



22 MAR 88

0843-0910

275
601
958
580

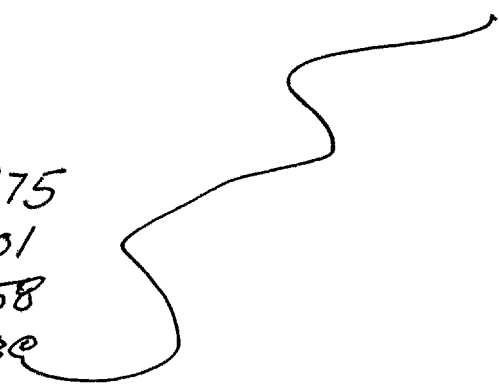

*A across, angle up
angle across, angle
up across
hard
B structure*

275601
958682

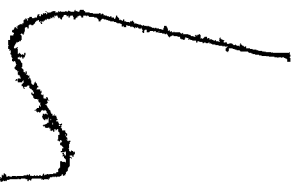

S-2?

hard
cold
rough
gritty
tan
brown
grey
up
vertical
tall
straight
angular
curving
flat
tall, but not tall
boxy
rectangle
long



SIDE VIEW

A. across, angle up
angle across,
hard
B. structure

Target Structure



long rectangle

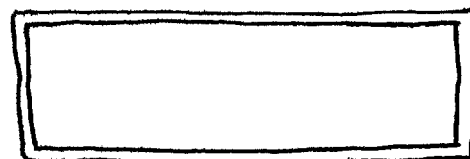

OVERHEAD

- 011
- 8802
- 22 mar 88

INSIDE!

dark
grey
white

angles

hallway!

room

large
empty

windows

not built
like an empty
warehouse

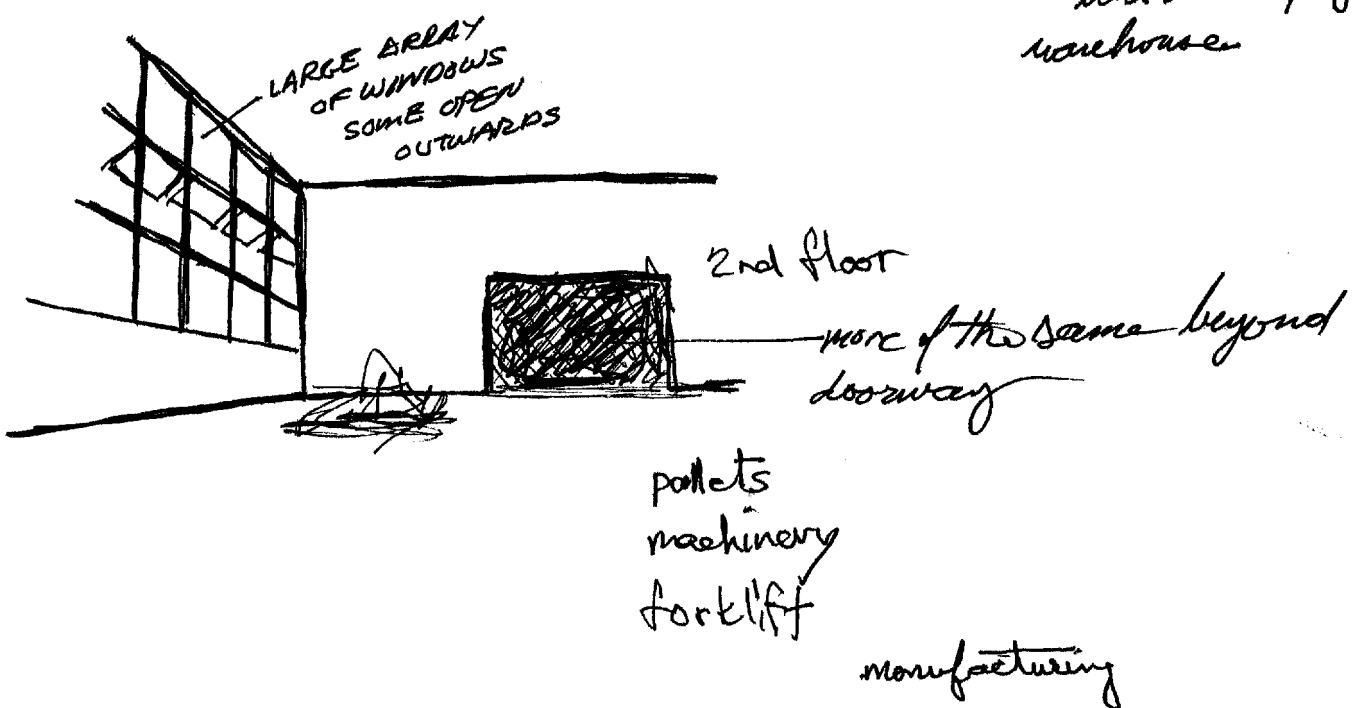

dark
dingy
dirty

4 1/2 - associated with manufacturing in the past

0910 hrs