

~~SECRET~~/NOFORN

PROJECT SUN STREAK

WARNING NOTICE: INTELLIGENCE SOURCES AND METHODS INVOLVED

PROJECT NUMBER: 8929 SESSION NUMBER: 04
DATE OF SESSION: 28 NOV 89 DATE OF REPORT: 29 NOV 89
START: 1037 END: 1048
METHODOLOGY: SOLO VIEWER IDENTIFIER: 018

SG1A



2. (S/NF/SK) VIEWER TASKING: Follow the constricted passageways reported in Session 02. Probe to the right and left of the tunnel as well as underneath the tunnel; sketch and report on your findings. Ascribe measurements to the structures.
3. (S/NF/SK) COMMENTS: No inclemencies noted. A Summary of Information is attached to this report.
4. (S/NF/SK): EVALUATION:
5. (S/NF/SK) SEARCH EVALUATION:

HANDLE VIA SKEET CHANNELS ONLY

~~SECRET~~/NOFORN

CLASSIFIED BY: DIA (DT)
DECLASSIFY: OADR

~~SECRET~~

WORKING PAPER

Project: 8929
Date: 891129
Time: 1037-1148
Viewer: 018
Session: 04

SUMMARY OF INFORMATION:

1. (S/NF/SK) Probe outside the tunnel and accompanying structural complex and describe perceptions: The area around the tunnel and accompanying

structural complex has vertical reinforcements of wood and metal underneath the tunnel and curved reinforcement layers of concrete and metal over it.

An air vent rises from the tunnel to the ground surface, above. Other than this, there are only perceptions of solid ground.

2. (S/NF/SK) Estimate site dimensions and physical relationships:

a. The vertical distance from the top of the stairwell (which is located at the basement level of the surface building) to the corridor which runs alongside the underground tunnel appears to be approximately 150-200 feet.

b. The tunnel appears to be approximately 50 feet high, measuring from the flat floor to the rounded ceiling, and approximately 70-80 feet wide.

c. The "no frills" room is approximately 1/4 to 1/3 the height of the tunnel, and has its floor at approximately the same level as the tunnel floor.

d. The locked doorway between the tunnel and the corridor is located near one end of an area of the tunnel which is open to public access (see sketch, page 4). This area has walls which are covered with light tan, shiny material (like tile). A vertical wall separates this public-access

HANDLE VIA SKEET CHANNELS ONLY

~~SECRET~~

~~SECRET~~

area from the rest of the tunnel. The other portion has walls which are not as nicely covered. This area is not accessible to the public.

e. The air vent which rises from the tunnel to the surface is approximately 2 feet in diameter. There was a strong perception of sudden gushes of air rushing up the tube at long time intervals rather than just a constant airflow exchange to the surface.

f. If one could look down on the surface building and also see through the ground to the tunnel below, one would see that the tunnel is not "lined up square" with the structure (see sketch, page 2).

HANDLE VIA SKEET CHANNELS ONLY

~~SECRET~~

018

29 NOV 89
10 37 HRS
FT. MORRIS
SALO
SESSION 4

P.I. BACKACHE
A.U. PREVIOUS SESSIONS.

SKETCH:

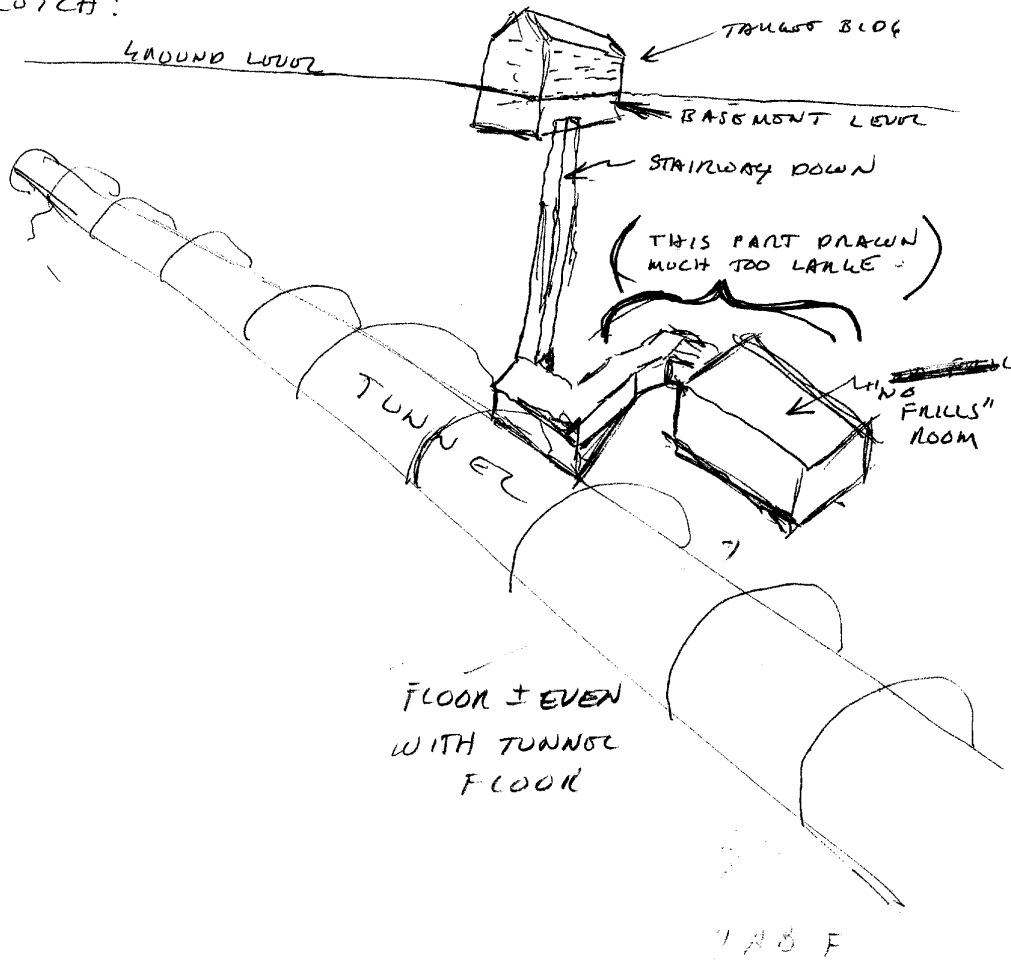

(2)

S 6 1/2 : IMPRESSION THAT STAIRWELL
GOES DOWN AT LEAST 150', MAYBE
200'

S 6 1/2 IMPRESSION THAT TUNNEL AND
BLDG ARE NOT "LINED UP", (TUNNEL
GOES AT AN ANGLE TO THE LAYOUTS
AT GROUND LEVEL) (SEE BELOW)

SKETCH FROM ABOVE

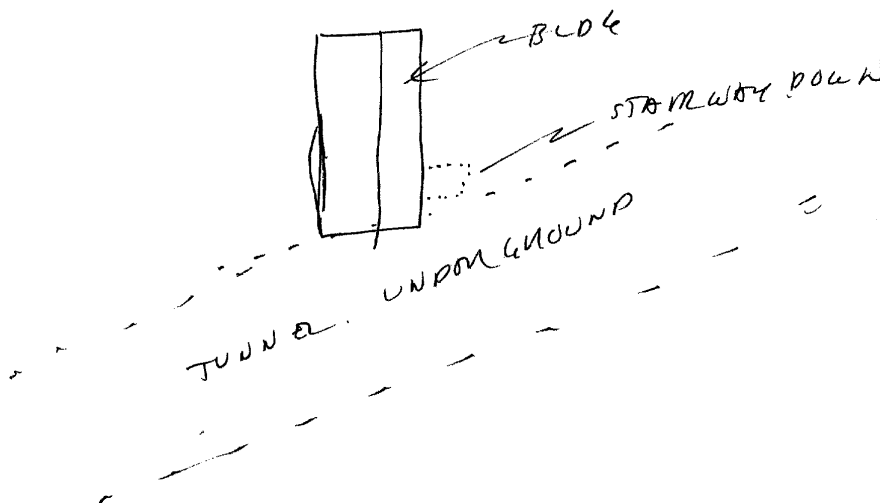

3

S6: (SEE PROBE MAP, P. 3A)

S2 0 A1 2 5 1 A2 1/2

① ~~S6 1/2 EQUAL~~
(S6 1/2 - "NO FALLS" ROOM + CORRIDOR AND D.W.)
HAS SAME LEVEL AS THE TUNNEL.

② S6 1/2 TOP OF TUNNEL IS ± 3 OR 4
TIMES AS HIGH AS THE TOP OF THE
"NO FALLS" ROOM.

③ DANK
BLACK
PLAIN
UNFINISHED
NOT PUBLIC AREA.

④ VERTICAL SURFACE WALL

⑤ BROWN
TAN
SHINY
& SMOOTH

(3A)

PROBE MAP: SEE ~~STAGE 6~~ STAGE 6
ON PAGE 3 FOR IMPRESSIONS GAINED
AT EACH NUMBERED POINT.

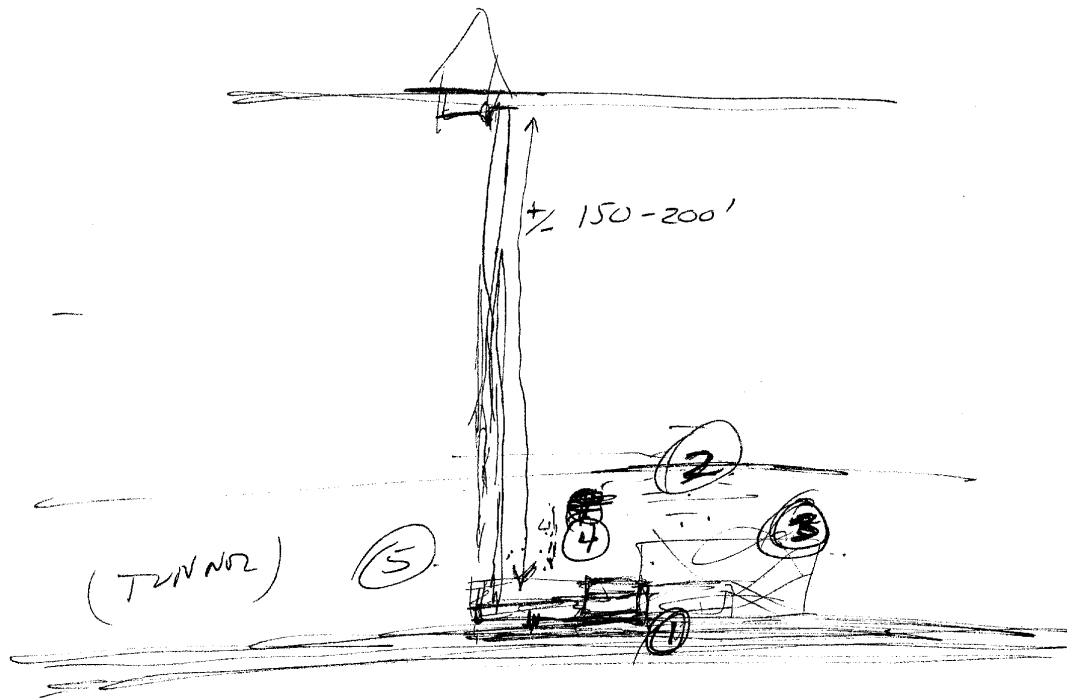

1386

(4)

S 6 1/2 IMPRESSION THAT THE DOORWAY
BETWEEN THE TUNNEL + THE CORRIDOR
IS AT THE FAR END OF A PUBLIC
ACCESS AREA, JUST BEFORE THE TUNNEL
LEADS INTO AN "UNFINISHED" AREA OF
"UNFINISHED" SURFACES ~~WHICH~~ WHICH IS NOT
OPEN TO PUBLIC ACCESS.

SKETCH: (LOOKING FROM OVERHEAD)

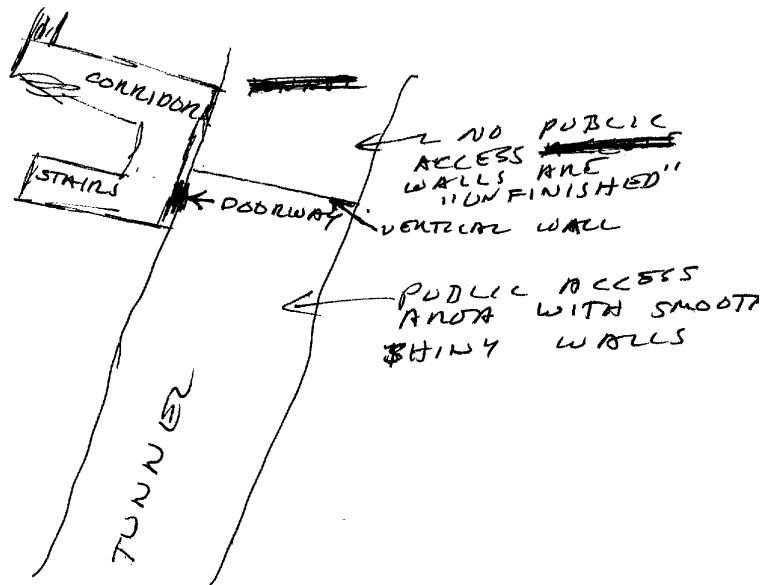

S 6 1/2 IMPRESSION OF TUNNEL HEIGHT;
I, 50' ~~FLOOR TO~~ FLOOR TO FLOOR
TO CONCRETE COLLAR.
WIDTH! ± 70' TO 80'

5

TASK: PROBE AROUND THE UNDERGROUND
AREA SURROUNDING THE TUNNEL
& CORRIDOR/ROOM COMPLEX.

(SEE PROB MAP 2, P. 5A)

SZ D 07 02 T 1 A02 A/S.

① SHOWINGS
VERTICAL
BLAKE
WOODROW
MOTEL

5"

② LAYERS
ROUNDED
REINFORCING
PHOTOETAL

SA

PROB MAP 2. SEE STAGE 6
MATRIX, BEGINNING ON PAGE 5
FOR IMPRESSIONS GAINED AT EACH
NUMBERED POINT.



TUNNR

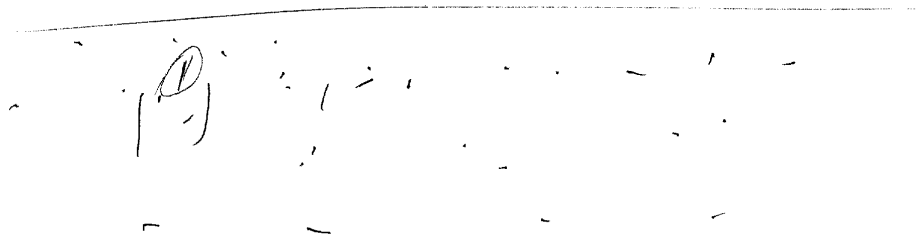

6

(SEE PROBE MAP 2, P. 5A)

SL D M O T , AZR A/S

3

VERTICAL

METALLIC

WIDOW (2')

PIPE

VENT

S6 1/2: VERTICAL AIR VENT TO SURFACE IS FROM THE TUNNEL.

SOUNDS

("NOISE"
"SWOOSH")

AIR BLOWING OUT OF VENT AT INTERVALS OF TIME.

A/S
~~S6 1/2~~

LENOWIAH CONVICTION THAT TUNNEL IS A SUBWAY SYSTEM.



TASK: PROBE AROUND TUNNEL & COMPUTER
(SEE PROBE MAP 3, P. ~~BA~~)

SZ D M O T , ALL KLS.

S 6 1/2 ! CONTINUED PROBING FINDS
ONLY DARKNESS, DIRT & REINFORCEMENTS
TO THE TUNNEL & COMPLEX STRUCTURE.

SESSION END 1148



PROB MAP 3; SEE STAGE 6
MATRIX BEGINNING ON PAGE 6
FOR IMPRESSIONS LATITUDE AT EACH
NUMBERED POINT.

