

# memorandum

DATE: 12 MAR 90  
REPLY TO  
ATTN OF: DT-S  
SUBJECT: SUN STREAK Project 9002-D (U)  
TO: HQDA, ATT: DAMI-PO

1. (S/STD/NF) During the period of 6 February 1990 to 2 March 1990 inclusively, six sessions were conducted to describe substantially the residence of a target personality identified as

2. (S/STD/NF) Remote Viewer 003 described the target as a structure having "a red bumpy roof." The structure was surrounded by a masonry wall and an entry way facilitated by a wrought-iron gate. See 003's conceptual sketch at TAB A.

3. (S/STD/NF) Remote Viewer 011 described the target site as an enclosed "complex" consisting of a multi-storied building located among several other smaller "support buildings". The complex appeared surrounded by a chain-link fence. A "court-like" area was located in the immediate vicinity of the main structure. It was also surrounded by a chain-link fence. A rail-line appears located in the vicinity of the target area. The complex is served by an access road. Residential areas can be found located north and west of the target area. The area located south of the target site is open and grassy. A large body of water is situated east of the complex. At this time, "the complex appears empty (feeling of abandonment)." See 011's sketch at TAB B.

4. (S/STD/NF) Remote Viewer 025 described the target site as a warm, inland area characterized by a presence of "red dirt" and interspersed with trees. The target site has "heavy drug connotations." Viewer 025's attention became focused on a

HANDLE VIA SKEET CHANNELS

CLASSIFIED BY: HQDA-DAMI-PO  
DECLASSIFY BY: OADR

~~SECRET~~/STIPPLED/NOFORN  
SPECIAL ACCESS REQUIRED

~~SECRET~~/STIPPLED/NOFORN

depot, a structure used in connection with contraband in the form of illegal drugs. Both drugs and explosives were present in the structure. There appeared to be a long, oval, area in front of the target structure. Drugs were transported by aircraft. Remote Viewer's perceptions are reflected in a sketch at TAB C.

5. (S/STD/NF) Remote Viewer 079 described the target site as a flat, circular area somehow associated with the color red (red clay?). The structure of interest was a building resembling an old shed. See TAB D. Old vehicles and small aircraft were involved in the transport of boxes; this activity normally occurred on the average of about every five days. Viewer 079 then focused on a personality involved in the activity and described as a young man living in an apartment building; he was observed as sitting in the vicinity of a swimming pool located behind a white stucco house. A second young man in military uniform with access to a jeep also appeared involved in the activity. (His role and responsibility, if any, were not described). See 079's second sketch at TAB E.

6. (S/STD/NF) OPS COMMENTS: Every viewer appears to have accessed the target. Viewer 003 and 011 appear to have a broader perspective of the target area while 025 and 079 focused on the specific activities related to the drug storage area, and transportation facilities in terms of trucks and aircraft.

5 ENCLOSURES  
TABS A - E  
SKETCHES

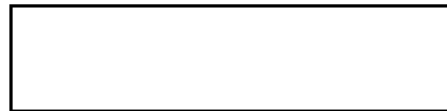

Branch Chief

SG1J

~~SECRET~~/STIPPLED/NOFORN

TAB

9002-D

9003

900302

5:01

unidentified object

object w/ crinkly exterior

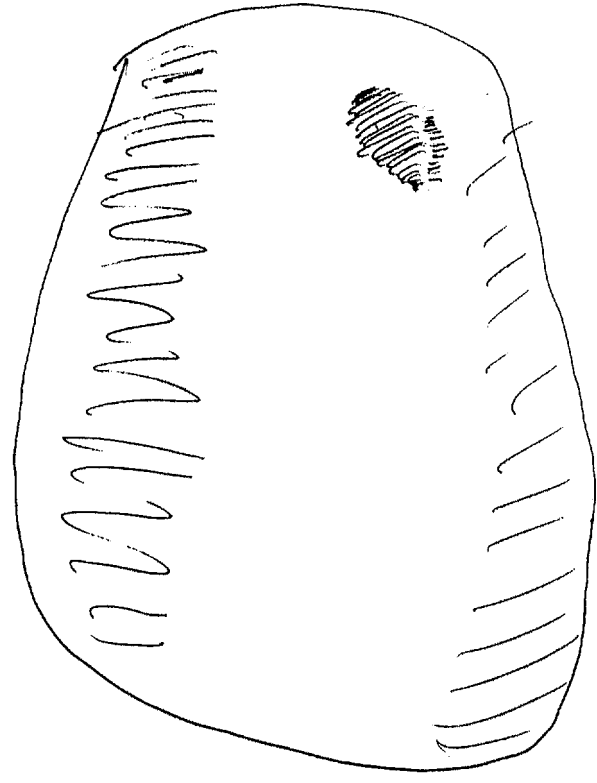

GATE MASONRY WALL

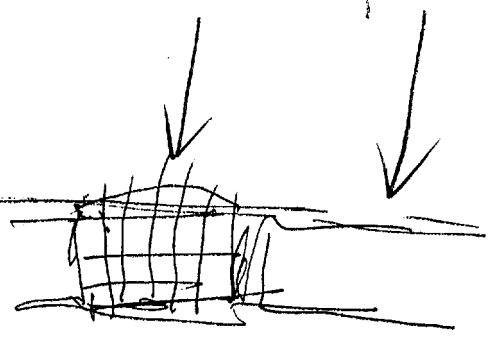

RED BUMPY ROOF

Structure / Red, Bumpy roof

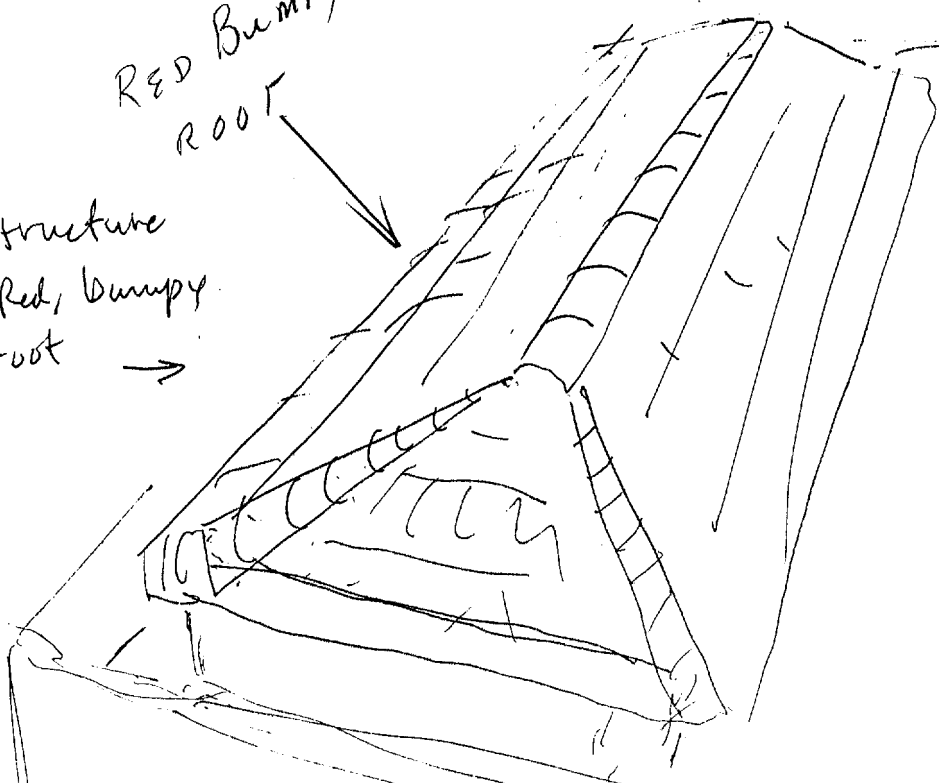

**TAB**

~~SECRET~~ STD  
WORKING PAPER

D 900301  
VO11  
S01

T 1430-1540

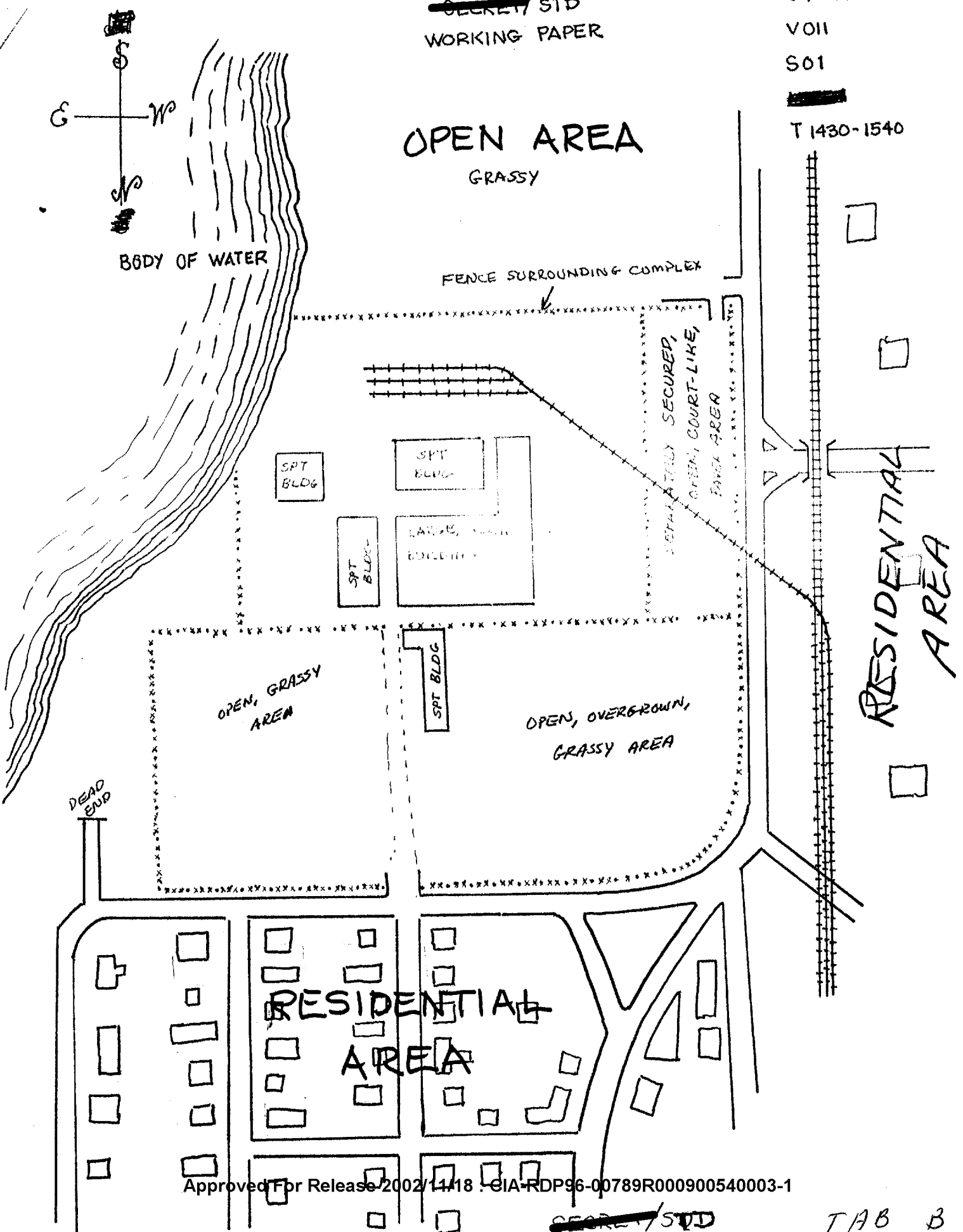

~~SECRET~~ STD

TAB B

**TAB**

9002-D  
900223  
V: 025  
S: 01

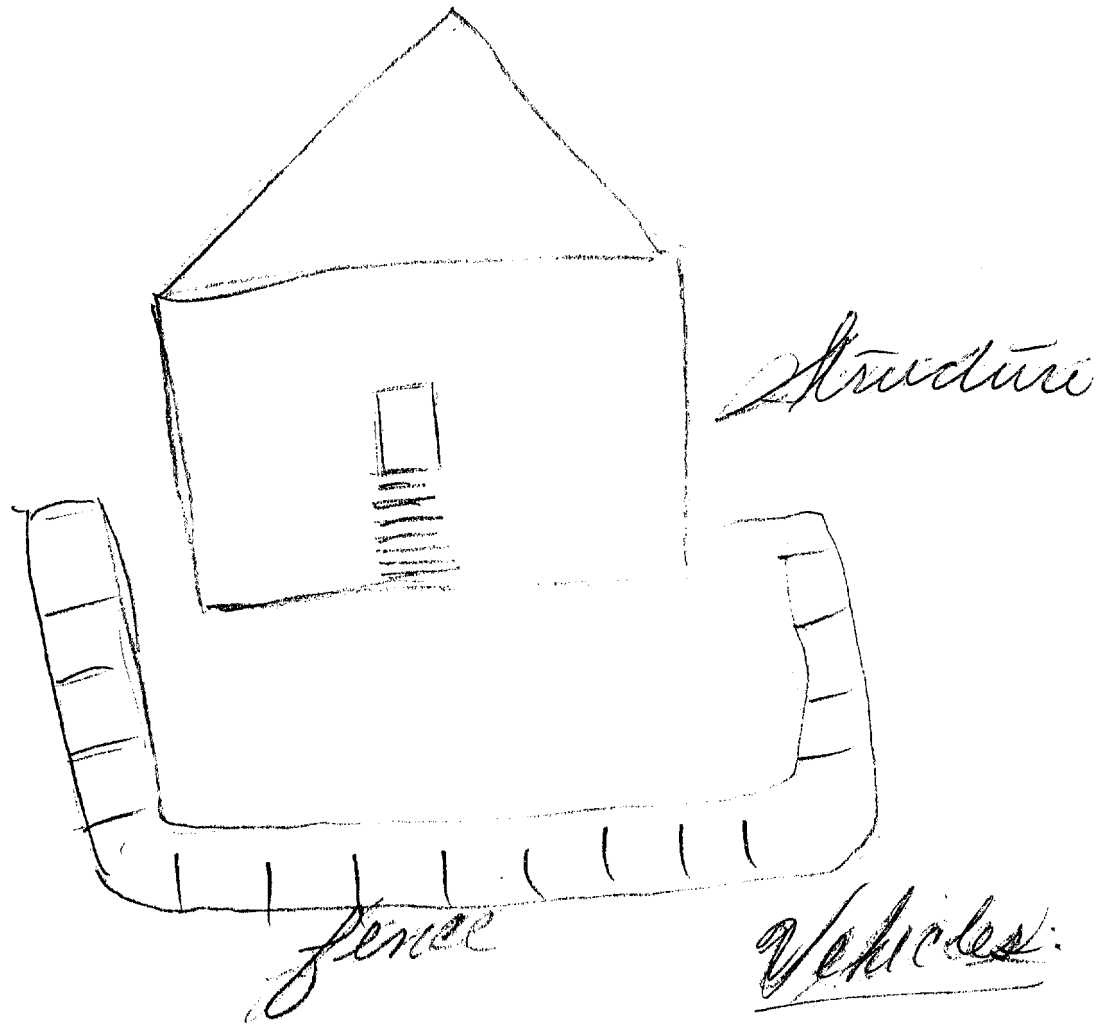

Long Oval Area



**TAB**

9002-D  
900212  
V: 0079  
S: 07

Structure  
K shed

X aircraft  
lands  
here

Door

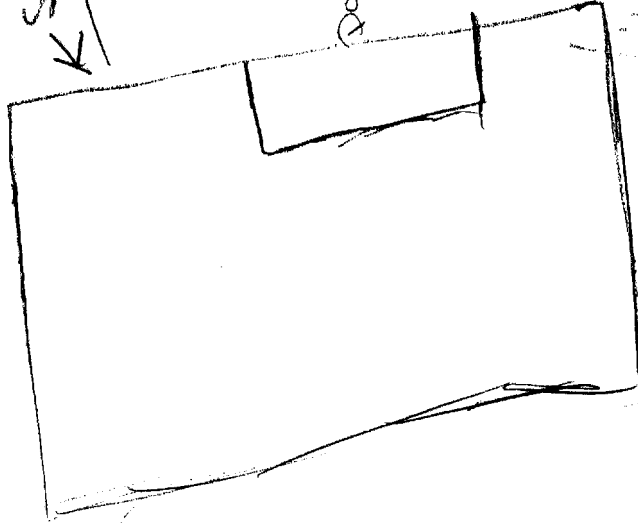

**TAB**

9002-D

900212

V:079

S:02.

apartment  
where  
map  
starts

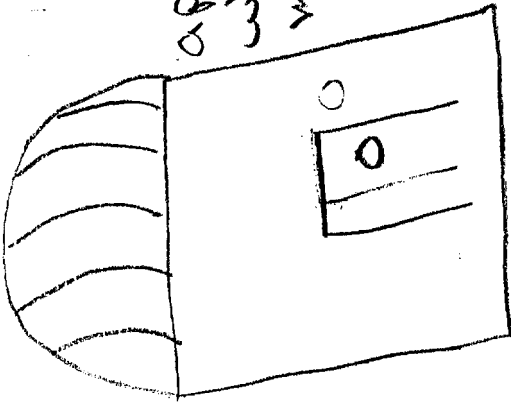

TAB E.