

Tasker JT4-080-90 (26 Jul 90) SG1A

Target: S/V [REDACTED] 41 foot ketch, fiberglass, white hull, blue SS, two masts.

EEL:

1. What is its location?
2. What activity is it involved in?
3. Is it carrying contraband drugs?
4. Provide any additional information available.

PT - *Martin* *Trid*
AV - Bow of any vessel

00F
JTF-4
26 Jul 90
P:080
00F
0935

900726
90008

Miss BK

900726
90008U

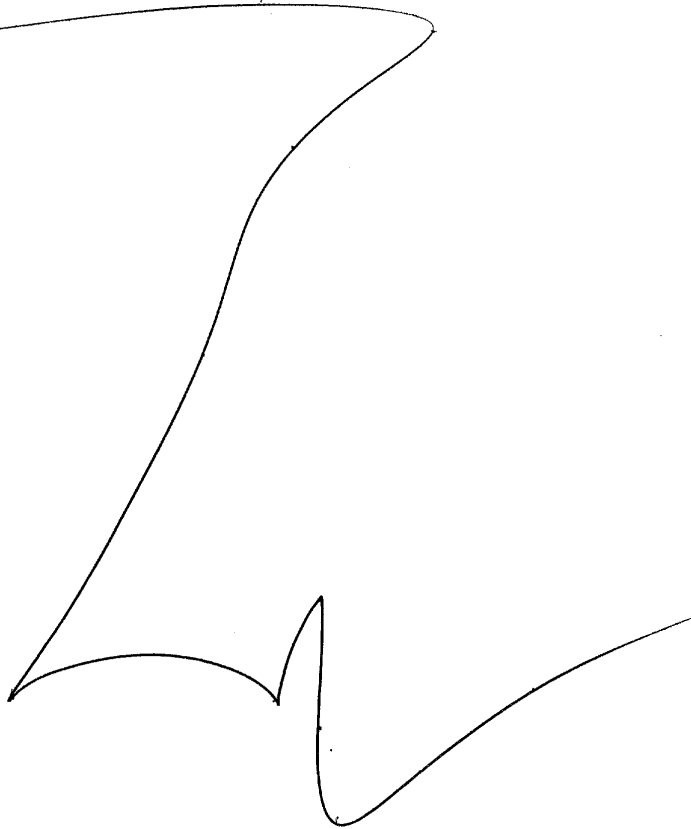

A - across, angle down,
angle forward, steep
angle up, angle down,
angle up.

- semi soft
Mammals

B - structure

AOL BK
Fiberglass hull
Sail boat

A - hard
- Mammals

B - structure

AOL BK
Chrome Railings

A - Motini
air

B - air

AOL BK

Sail (s)

3-masted schooner

AOL BK

KEEL

A -

AI BK

Makes me feel
as if I'm plunging
into deep, cold water

3)
A) ~~Boat~~
- wamples
B- wood
AOC BK
WOODEN RUDDER

AOL SKETCHES

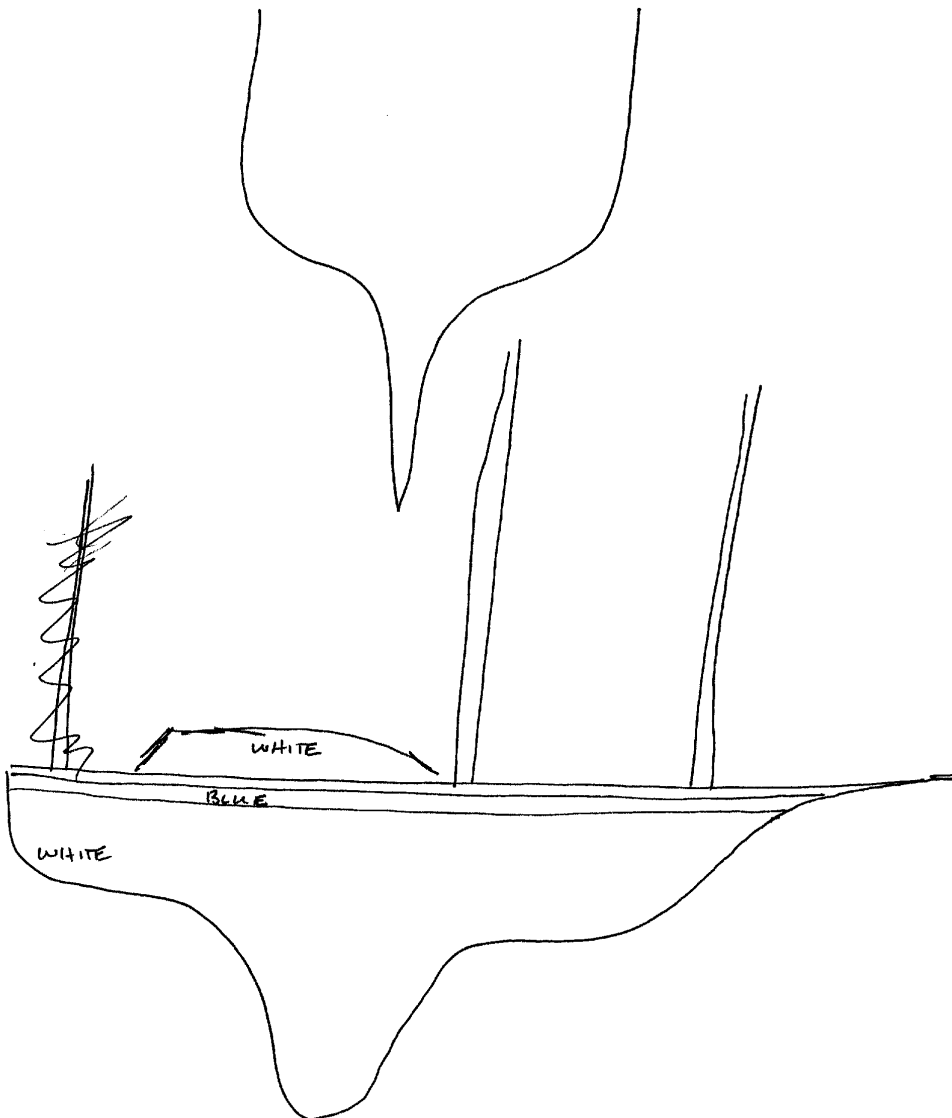

4)
S2.
White
Yellow
Green
shiny
hot
bright
red
big
full
flat
curved
deep (see)

yellow smell

AOL BK
N47

AOL BK
Lemons

Dry smell
Woody smell (see)
Coarse
rough
smooth
woven (see)

AOL BK
Canvas sails

Break
0950

52

D AI EI T I AOC A/S
[Location]
23° 27' N 89° 22' W

AOLBK
Metal Shavings
Blue Tuna Fish

R
[Activity]

green
square

wood

A/S
green wood
blocks
AOC
Gov't Ammo
Boxes

crisp
crispy
black

monette, barrel

rubber smell
reddish

engine area
nylon bags

heavy
rectangular

a man eating

D AI EI T I AOC A/S

(Activities)

Swirling motion

AOC
VORTEX

faint
striped
parallel lines

ceiling beam

A/S
wooden
deck

loading
~~detected~~

AOC
Nice man
in Harrisburg
PA.

scrubbing

Knife

solid

solid walls
packing in between
studs.

54 1/2 Man's not aware of anything.

54 1/2 size that must be in one of the wrists

white
dew

injected

54 1/2 size that must, has been injected into center mat - that mat is cross-hatched expendable.

cutting in half

round

angle

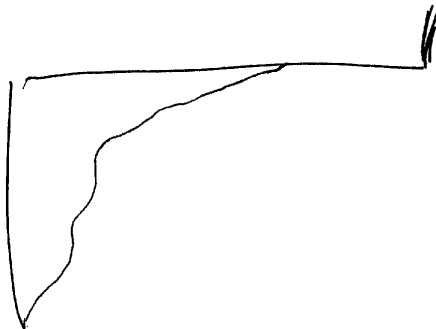

8)

A/S

A/S
Widglobe

Solid

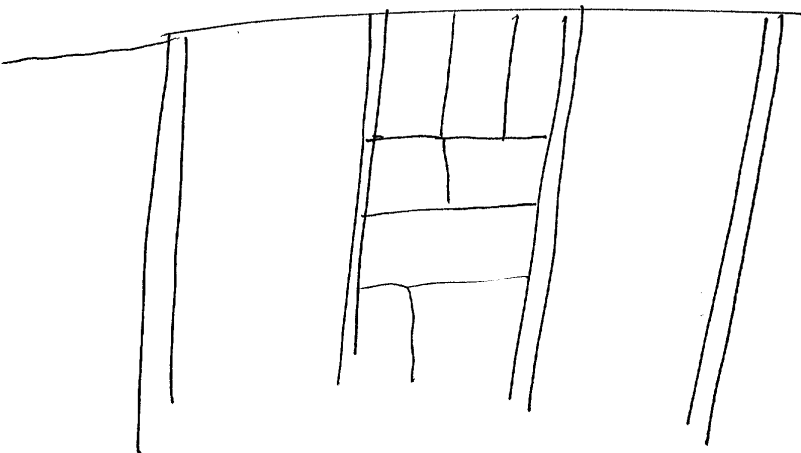

5 1/2 Metal shavings are present near area where something is densely packed.

A/S
Base of mast
Along port
edge of wall
w/ engine area

Keel

5-11/2 Saw that person on board does not know about what is on board.

↑
one man

5-11/2 Attempt was made to clean up & remove all of the metal filings/shavings; however, there are remnants in one of the two places.

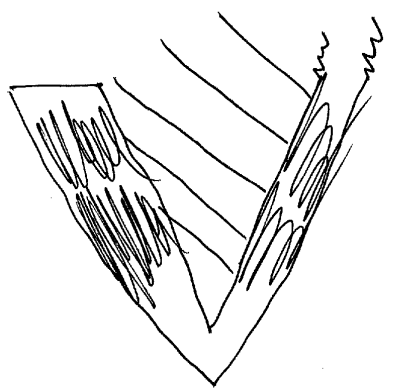

ET 1043