

~~SECRET~~

Approved For Release 2000/08/09 : CIA-RDP96-00789R003500810002-3



DEFENSE INTELLIGENCE AGENCY

WASHINGTON, D.C. 20340-

S20,018/DT-S

3 October 1989

MEMORANDUM FOR CHIEF SCIENTIST DEFENSE INTELLIGENCE AGENCY

SUBJECT: SUN STREAK Operational Report - 8928 (U)

1. (S/NF/SK) During the period of 11 September 1989 to 2 October 1989 inclusively, seventeen sessions were conducted to determine the nature of a key activity at a geographical location represented by Encrypted Coordinates 362104/453869. Results of this effort follow below.

2. (S/NF/SK) Remote Viewer 003 perceived the activity as occurring in a "blue chip, think-tank" atmosphere. A government-oriented group of personnel were working towards "a goal not publicized." It involved planning, orchestrating behind the scenes in an atmosphere of non-disclosure (secrecy). The people at the meeting appeared serious, grim on the one hand, and altruistic and dedicated to a common cause on the other. The ultimate objective was to determine the means to implement a course of action. The implementation was to be effected by subordinates, representatives of the personnel at the meeting. The target site appeared to be a hotel, an office structure located near a beach.

3. (S/NF/SK) Remote Viewer 018 perceived the key activities as being directly related to "concealed weapons" stored within double metallic walls. See TAB A. The metallic walls led 018 to believe that the concealed weapons were aboard ship. The weapons were cylindrically-shaped and closely packed in stacks. They were small, grayish-green in color and had spring-loaded fins. They resembled small missiles. The weapons were activated for use through the pushing and pulling of levers located on the side of the cylinder. The weapons appeared destined for use against insurgents.

4. (S/NF/SK) Remote Viewer 025 perceived the key activity as being directly related to an early warning "protection system".

WARNING NOTICE: SENSITIVE
INTELLIGENCE SOURCES AND
METHODS INVOLVED

HANDLE VIA SKEET CHANNELS ONLY
SPECIAL ACCESS REQUIRED

CLASSIFIED BY: CHIEF SCIENTIST, DIA
DECLASSIFY BY: OADR

Approved For Release 2000/08/09 : CIA-RDP96-00789R003500810002-3

~~SECRET~~

~~SECRET~~

025 perceived the presence of transmitters and antennas. The target site was located in a fenced area. Uniformed personnel and guard dogs were present.

5. (S/NF/SK) Viewer 032 believed the key activity was related to a meeting held by several men of similar political and religious beliefs, and dressed in business suits. The purpose of the meeting was to determine how to neutralize a threat to their status (not further defined). The group appeared threatened by gunmen and bombs. The presence of a vessel phonetically surfaced as being related to the issue at hand. It was identified as "Allied Trader"; it was anchored in a port north of the target area. See TAB B.

(OPS CMTS): At this point Viewer 032 believed this scenario to be drug-related. This appears to be in error.)

6. (S/NF/SK) Remote Viewer 079 perceived the target area as being located in a "third-world country," at the site of a previous (well-known) disaster. Dark-skinned people populated the area. The target site was located in the vicinity of a body of water and a mountain. At some (undetermined) time in the past, a search for lost people was conducted in the vicinity of the body of water. Viewer 079 then concentrated on an isolated, yellow, brick building in the area. Within this structure was a mobile object "on wheels" configured like an "upgraded canon". See TAB C. The object appeared to have no explosive capability. The object measured distances in a ground order-of-battle atmosphere. Small aircraft were observed as related to this activity. Personnel wearing red berets were located on the periphery and appeared intent on observing the object and its activities. A man was apparently tied-up (to chair) in the target area. (Relevancy of the man tied up in a chair was not determined.)

7. (S/NF/SK) Remote Viewer 095 perceived a large, gray, smooth three dimensional rectangular object that appeared to be related to the key activity at the target. See TAB D. It had smooth, "substance-tight" seams. Lengths, distances, measurements, fast motion, loud noises and pressure were concepts directly related to the object. There was a presence of underground tunnels perceived as long, lined, smooth and polished. They were surrounded by a "rock-hard" substance. See TAB E. The seams between the tunnel sections were of such smoothness as to make them indistinguishable. Additionally, there was a horizontally-

~~SECRET~~

~~SECRET~~

positioned object on supports estimated as being at about 50 to 60 feet off the ground. See TAB E. People in the area were clad in white, one-piece outfits and wore thick insulated boots. At this point, viewer 095 received the distinct impression that this was nuclear-related site.

5 ENCLOSURES
TABS A - E
Sketches

[REDACTED]

SG1J

GS-14
Branch Chief

~~SECRET~~

8928 (2)
890926
S:02
V:018

SK!

DOUBLE METAL
W/ A L
(CUTAWAY)

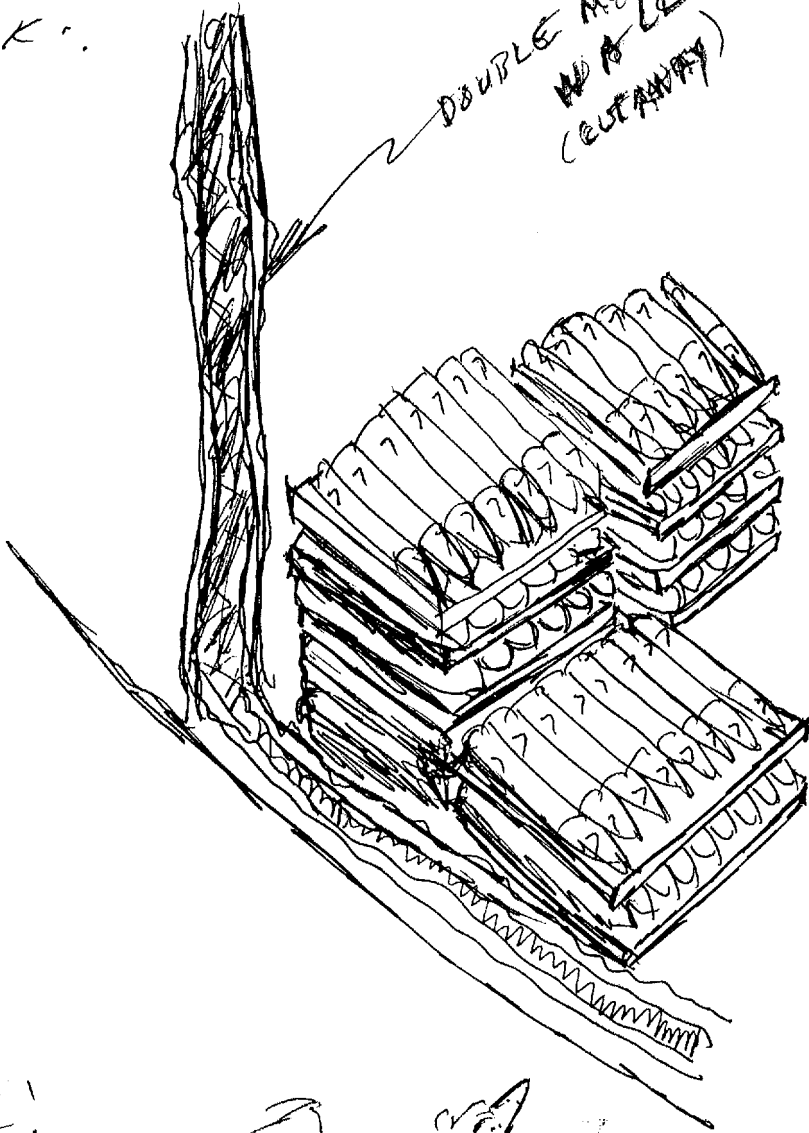

PACKED
CLOSELY
TO 400000

LOTS MORE
STACKS
IN THIS
ROOM

SK!

SIZE:

A LITTLE
LONGER
THAN A
PERSON'S
FOREARM

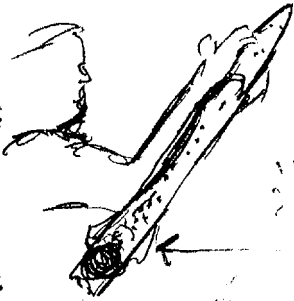

FINS

TAB - A

A LITTLE
LONGER
THAN A
PERSON'S
FOREARM

SG1A

8928
8909 18
V: 032
S: 01



se 2000/08/09 : CIA-RDP96-00789R003500810002-3
- SHIP'S NAME

Sketch #1

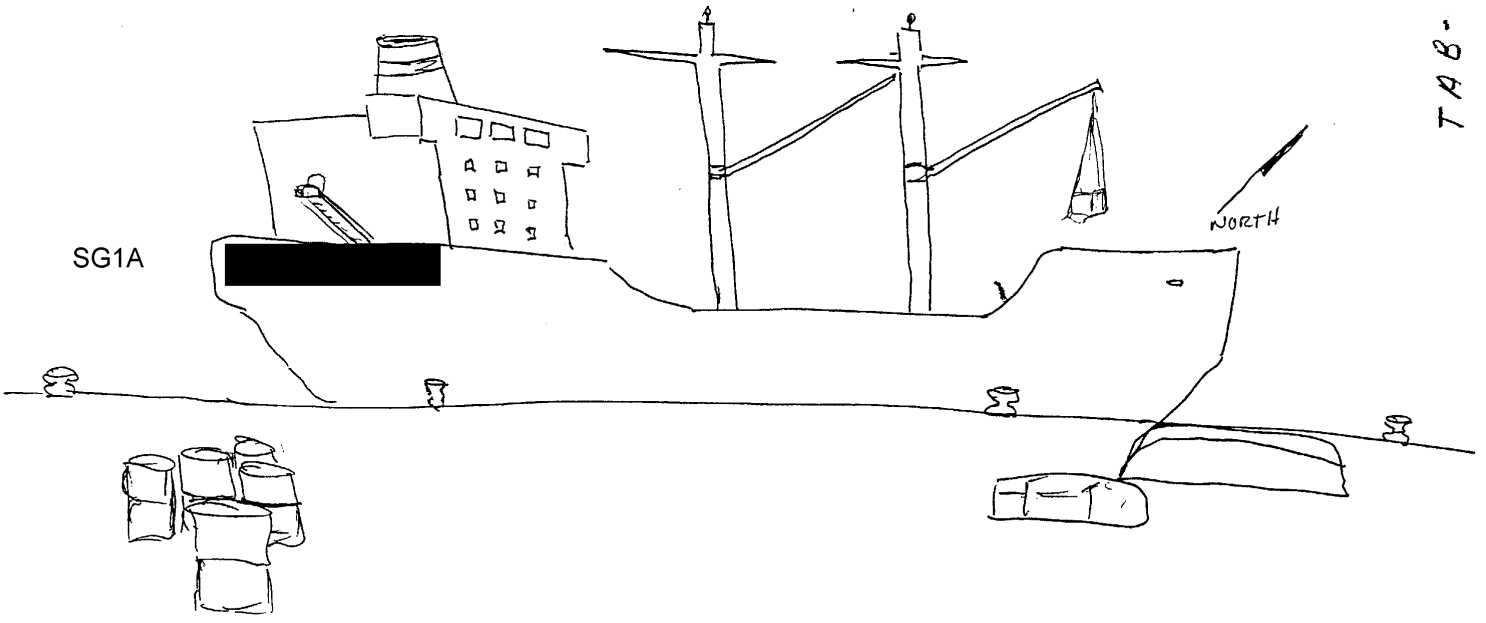

TAB-B

object
looks like
an updated
canon
sit on
platform
with wheels

8928
890925
V:079
8:02

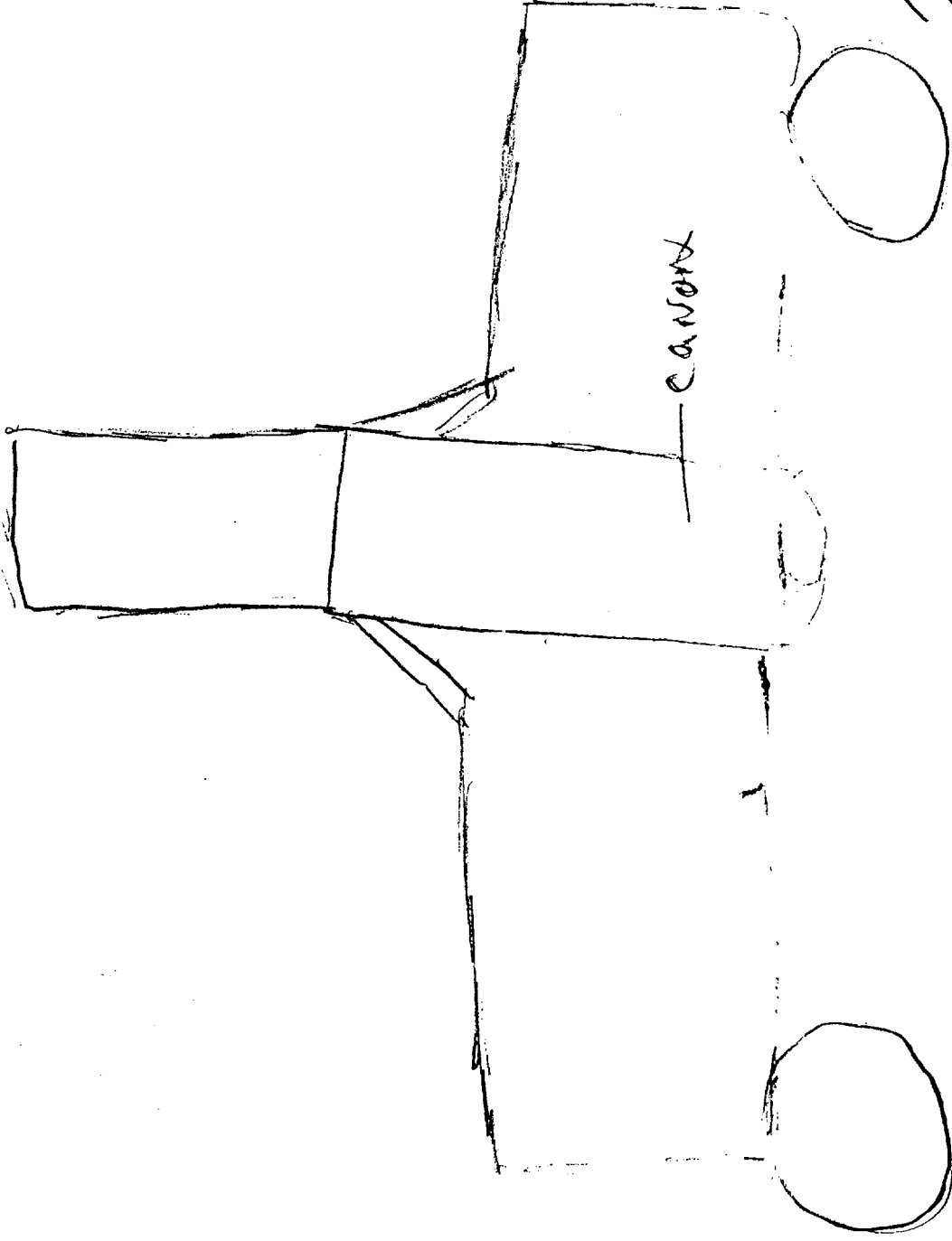

TAB C

← 20' - 30' →

8928
890925
V: 095
8:04

smooth
curved

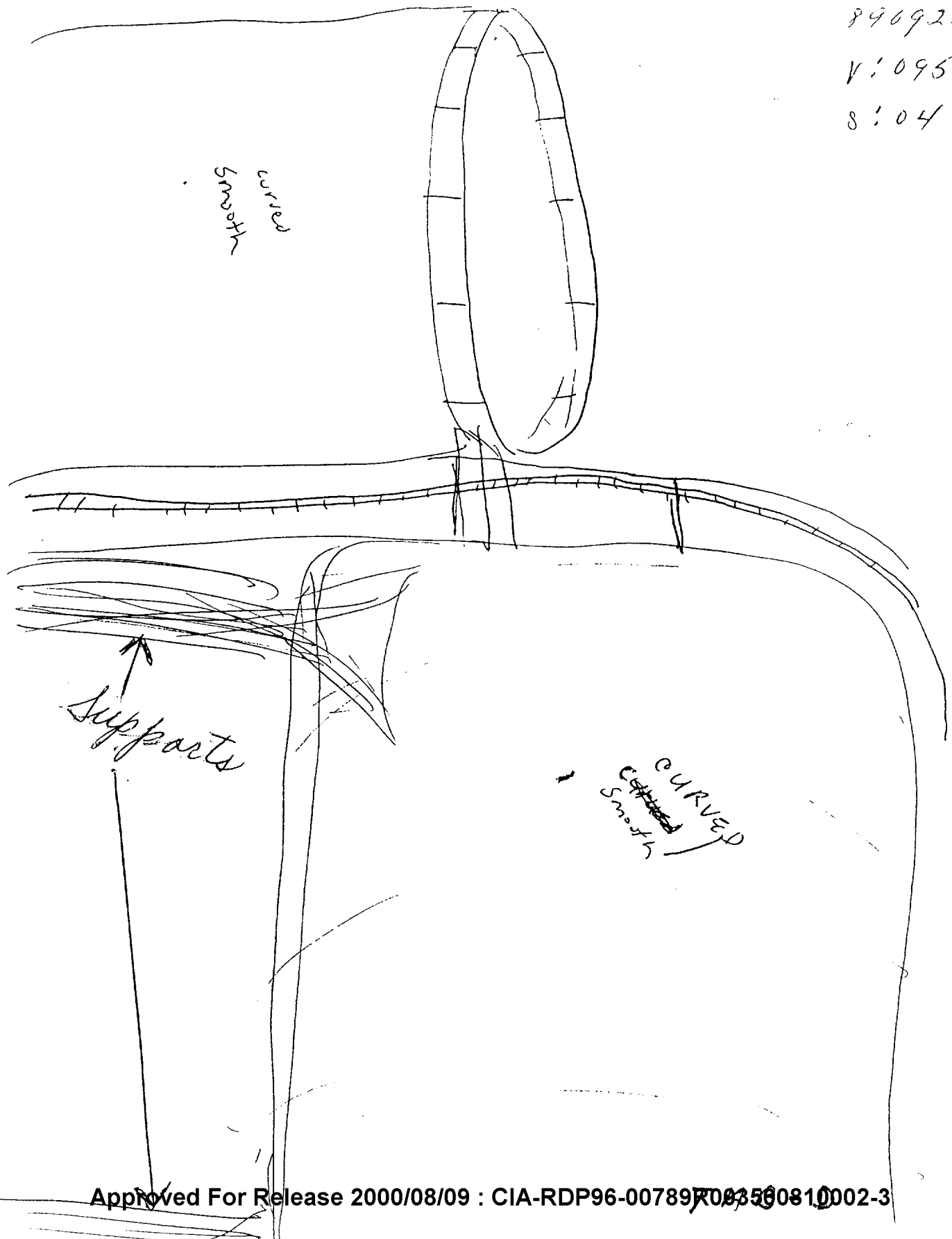

8928
890921
V: 095
S: 03
890921
FT made
CRV solo
936-1000

AV none
PI more

S-2 D A1 E1 T 1 A00 AISC

[8.928]

smooth
long
polished
vertical
lined

UNDERGROUND TUNNELS

tunnel

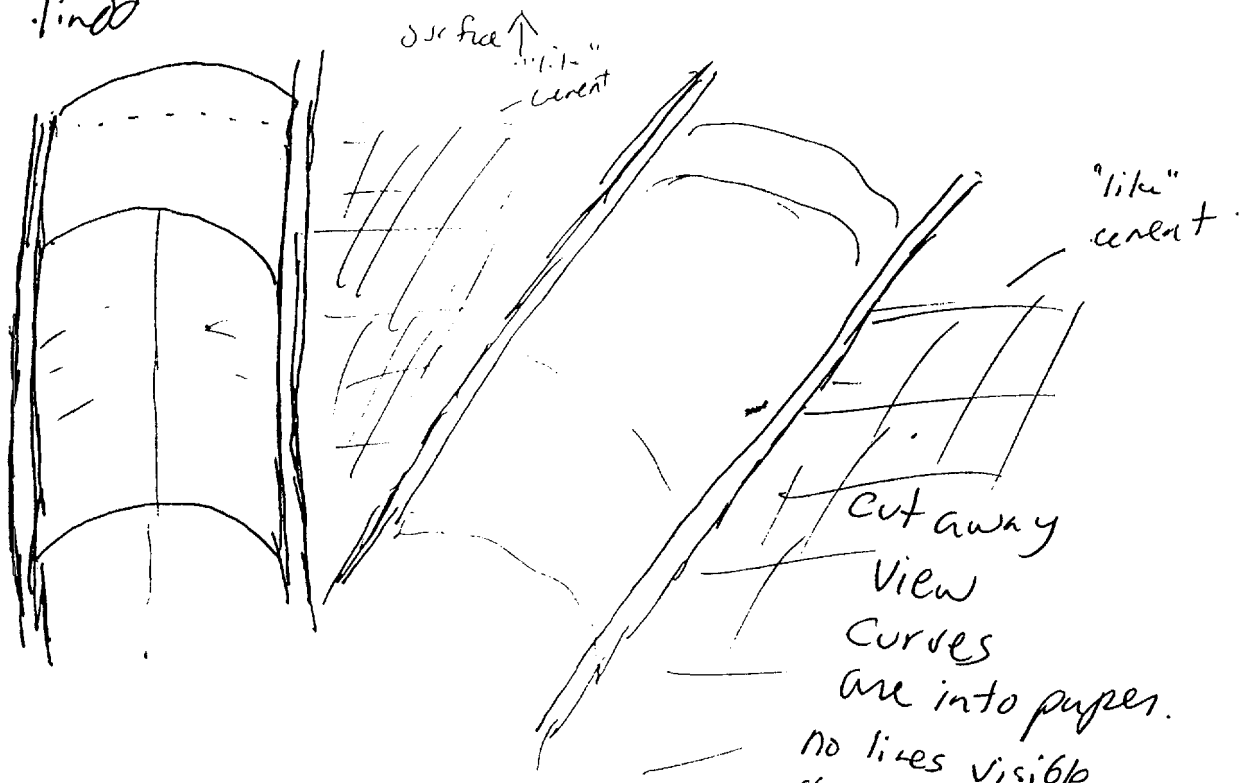

cut away
view
curves
are into paper.
no lines visible
very smooth
the lines are to
show how curved

long.

TAB E

~~TOP SECRET~~

WORKING PAPER

TASKER

1. PROJECT: 8928.
2. ENCRYPTED COORDINATES: 362104/453869.
3. ESSENTIAL ELEMENTS OF INFORMATION:
 - A. DESCRIBE THE ACTIVITY OF SPECIAL INTEREST AT THE GEOGRAPHICAL LOCATION REPRESENTED BY THE ENCRYPTED COORDINATES 362104/453869.
 - B. DESCRIBE THE TARGET SITE AND ITS IMMEDIATE SURROUNDINGS.
 - C. DESCRIBE THE PERSONNEL DIRECTLY RELATED WITH THE TARGET.

SUBMIT CONCEPTUAL SKETCHES IN SUPPORT OF YOUR FINDINGS

Tasker

~~TOP SECRET~~

~~SECRET~~

WORKING PAPER

TASKER

1. PROJECT: 8928.
2. ENCRYPTED COORDINATES: 362104/453869.
3. BACKGROUND: The Encrypted Coordinates represent a geographical location of specific intelligence interest.
4. ESSENTIAL ELEMENTS OF INFORMATION:
 - a. Describe the issue of specific intelligence interest at the location represented by the Encrypted Coordinates 362104/453869.
 - b. Describe the immediate surroundings of the target area.
 - c. Access and describe the people directly associated with the target.

Provide your conceptual representations in the form of sketches in support of your findings.

HANDLE VIA SKEET CHANNELS ONLY

~~SECRET~~