

~~SECRET~~



DEFENSE INTELLIGENCE AGENCY

WASHINGTON, D.C. 20340-



S20,016/DT-S

13 September 1989

MEMORANDUM FOR CHIEF SCIENTIST, DEFENSE INTELLIGENCE AGENCY

SUBJECT: SUN STREAK Operatioanl Report - Project 8927 (U)

1. (S/NF/SK) During the period of 21 August 1989 to 7 September 1989 inclusively, twelve remote viewing sessions were conducted in an effort to determine and describe the key current activity at a target site identified by the Encrypted Coordinates 764313/316913.

2. (S/NF/SK) Remote Viewer 011 described the perception of a target activity as a meeting occurring between two men in a swampy, dark area labeled as some sort of retreat.
[OPS COMMENTS: Remote viewer appeared unable to access the target site.]

3. (S/NF/SK) Viewer 018 perceived the "key activity" as a pick-up and delivery point for objects/packages being transported to and from a large, secure room that could be located below ground. See sketch at TAB A. The objects were wrapped in dark, yellowish burlap and bound with black tape; their configuration reminded 018 of "bales of hay." See sketch at TAB B.

4. (S/NF/SK) Viewer 025 described two, apparently unrelated facets of a key activity. The first involved the energetic release of an encapsulated object from a tubular turret type object. See TAB C. The second perception involved the shipments of cargo in compartmented containers via ground vehicles, (subsequently identified as) trucks. An object shaped like a carousel (with a spinning motion?) and made of "zirconium" was perceived as being related to the key activity. Moreover, a separate valve system was involved; the purpose of the procedure was to produce a whitish substance. The substance was not further identified.

[OPS COMMENTS: The dictionary describes zirconium as a strong metallic element having a high melting point, an element that is highly resistant to corrosion and used in the production of alloys and ceramics.]

WARNING NOTICE: SENSITIVE
INTELLIGENCE SOURCES AND
METHODS INVOLVED

HANDLE VIA SKEET CHANNELS ONLY
SPECIAL ACCESS REQUIRED

CLASSIFIED BY: CH SCIENTIST, DIA
DECLASSIFY BY: OADR

~~SECRET~~

~~SECRET~~

5. (S/NF/SK) Viewer 032 perceived the key activity as involving the arrival of trucks at the target site described as a hot, dusty, area. Viewer 032 located and described the target as a large, expansive, storage building where ceramic containers were stored. The ceramic containers appeared fashioned like huge electrical insulators. See sketch at TAB D. The containers contained a granular substance that stung the eyes and irritated the nose and throat. The objects were hurriedly being transported by aircraft. See TAB E.

6. (S/NF/SK) Viewer 079 perceived the target site as being located in a somewhat hilly, brown, and dusty area. The key activity is perceived as being related to a "white aircraft" flying a predetermined route of travel. Trucks were in the area, and in context of the key activity, they were somehow related to the aircraft activity. Personnel at the target site appeared to be of a Latin or Middle-Eastern origin. Men were observed carrying "large, square, slim boxes containing equipment in the form of "plates/shields." See TAB F. The price of gas or oil appeared related to the target site.

7. (S/NF/SK) Viewer 095 perceived the key activity as a form of experimental, medical research possibly involving living subjects, probably animals. The activity dealt with stimuli responses to induce changes in patterns. The presence of medication and electronic equipment produced "machine-generated" graphs. See sketch at TAB G.

8. (S/NF/SK) By way of conclusion, one can infer that the key activity appears related to the receipt, storage and shipment of objects described as containers. The essence of the material appears to be caustic, and medically or chemically related in an atmosphere of scientific testing. Transportation is assured by trucks; and, may possibly involve an aircraft.

SG1J

7 ENCLOSURES
TABS A-F
SKETCHES

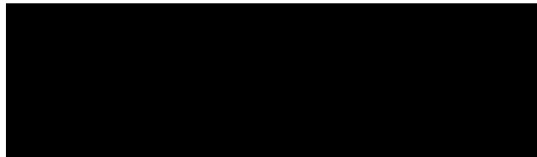

~~SECRET~~

~~SECRET~~

018

8 SEP 89
0915 HRS
FR. MORGAN
SOLO

P.I. NAUSSA, SINUS,
COLO,
A.V. WAND.

764313
316913

S2 D AT OF T , AN ALS,
(KEY ACTIVITY)

PODLO

DINT

HOLS

LILAT

MULTILEVEL

S4 1/2 UPPER, OPEN PART HAS A HOLE WHICH
LOOKS DOWN INTO A LOWER, OPEN PART.

SK:

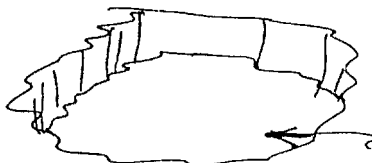

ALL DNIC
HOLE IN ROOF OF
UNDERGROUND
LEVEL.

OPEN
AREA
ROOF
OF
UNDERGROUND
LEVEL

~~SECRET~~

TAB A

~~SECRET~~

(Handwritten mark)

S2 D M U T 1 1802 A/S,
(ACTIVITY IN ROOM)

LOADING
DROPPING OFF
DELIVERING
UNLOADING

A/S, VISUALLY,
LARGE "OBJECTS" LOOK
LIKE STACKS OF
BALES OR ~~WRAPPED~~
DUNLOP-WRAPPED
BUNDLES.

TRUCK.

GUARDS

UNIFORMS.

VISUAL

GROUND OUTSIDE
SLOPES UPWARD

TRUCK

PEOPLE
(GUARDS)

NOT A
GUARD

~~SECRET~~

TAB B

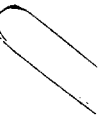

Approved For Release 2000/08/09 : CIA-RDP96-00789R003500990001-5

Capillary

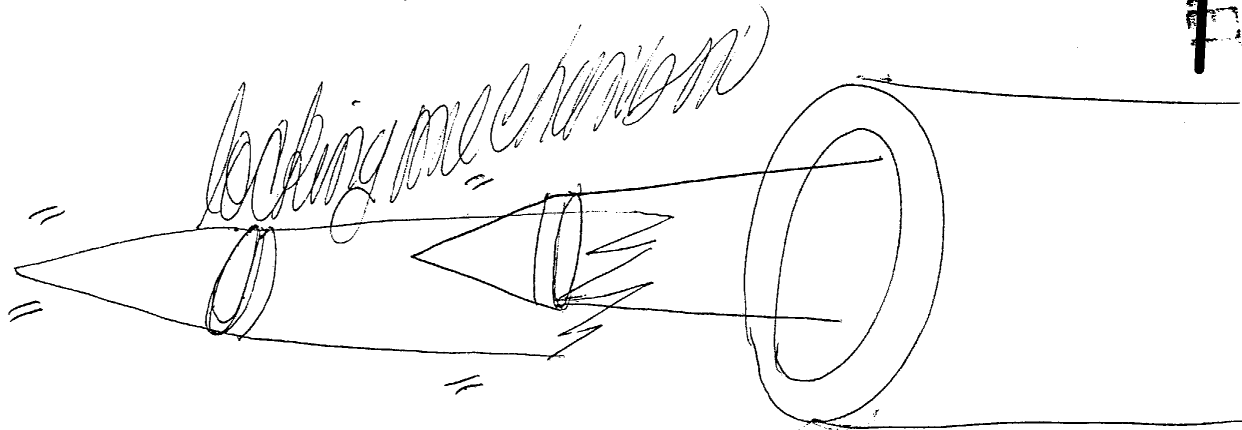

Reduce Decontamination Energy

Approved For Release 2000/08/09 : CIA-RDP96-00789R003500990001-5

~~SECRET~~

TAB C

~~SECRET~~

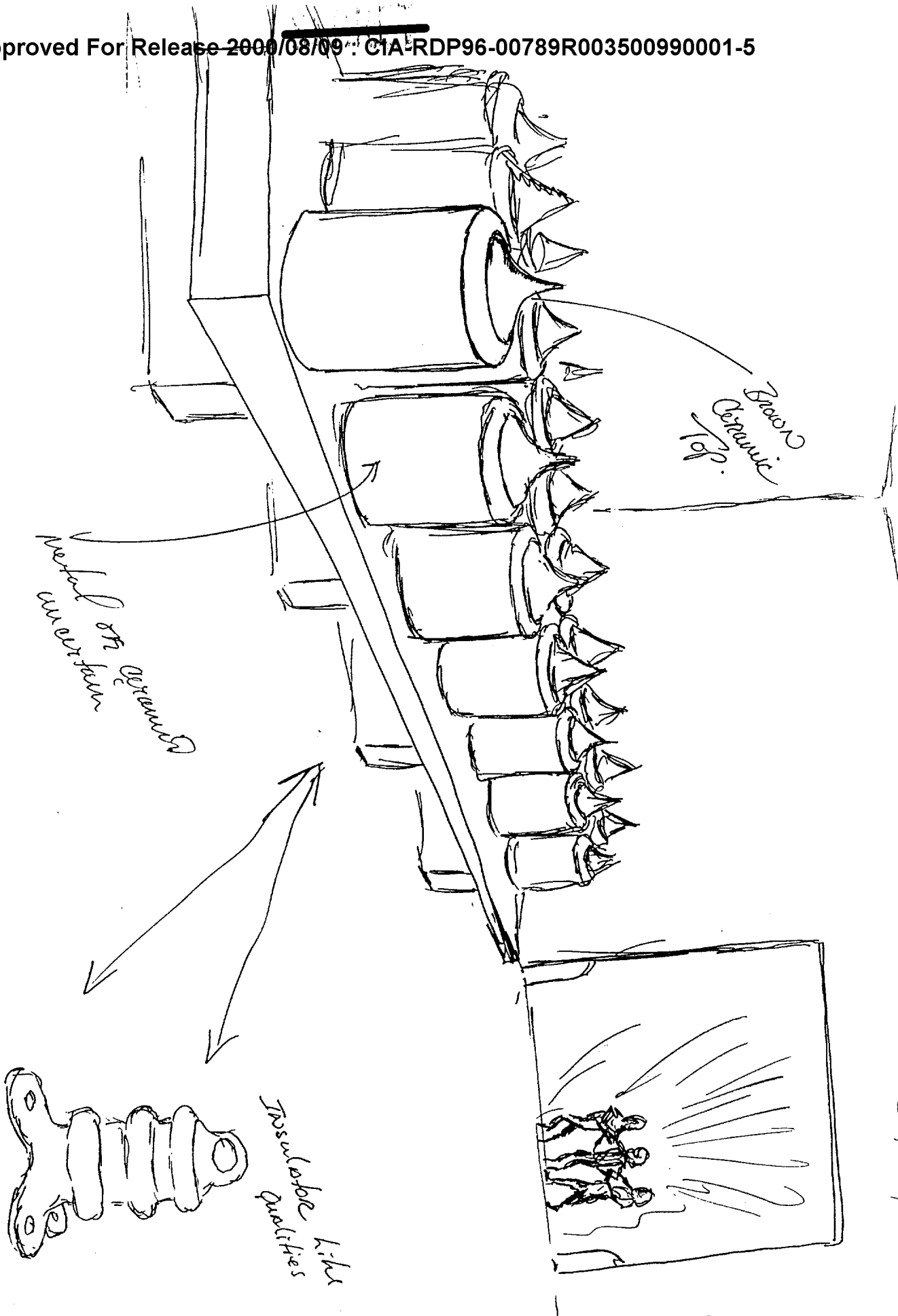

TAB D

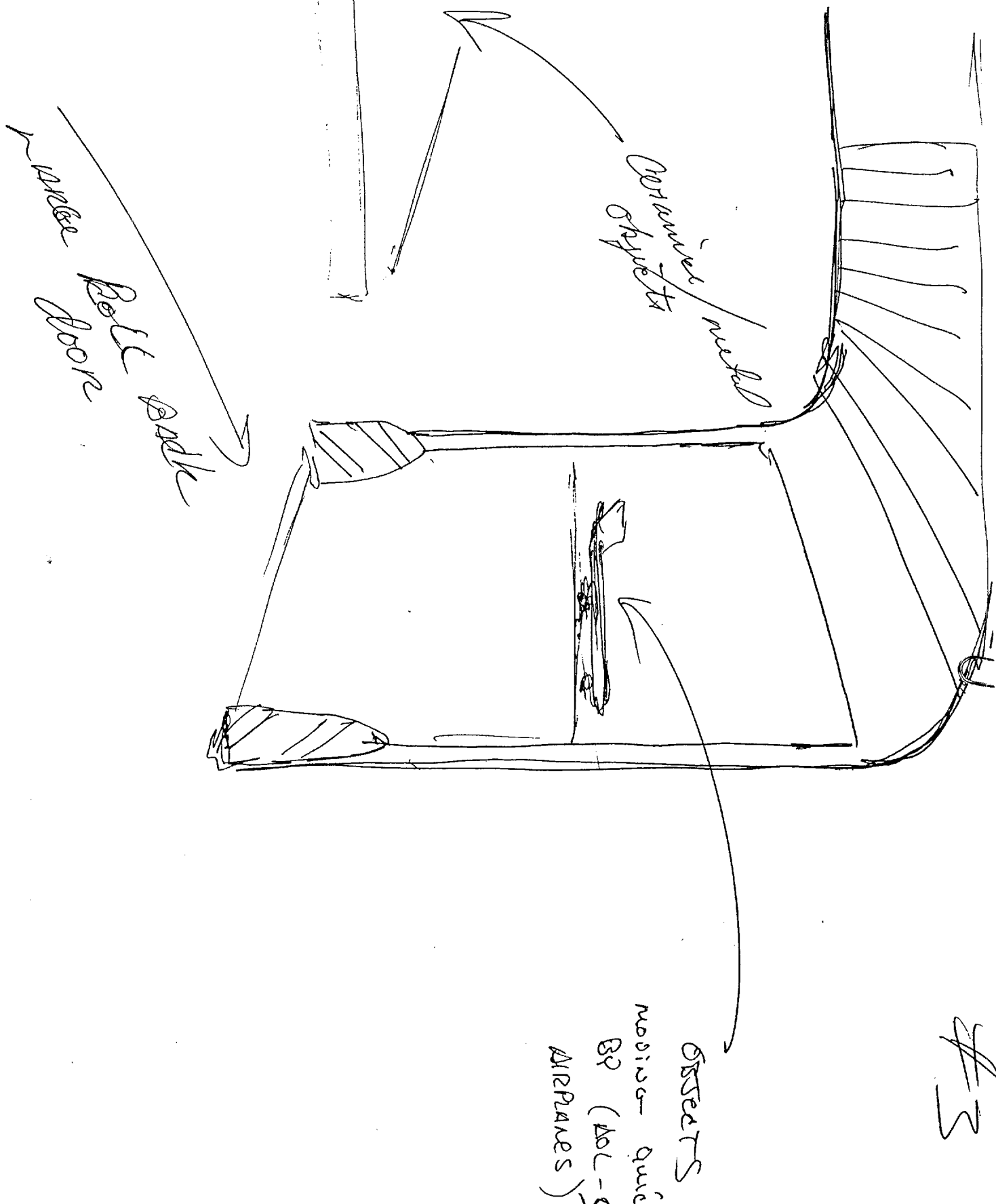

#3

Assets
radio - quidey
BP (KOL-5
AIPRARES)

~~SECRET~~

HDR E

(7)

WIDE
NARROW
BOX
more work
carrying

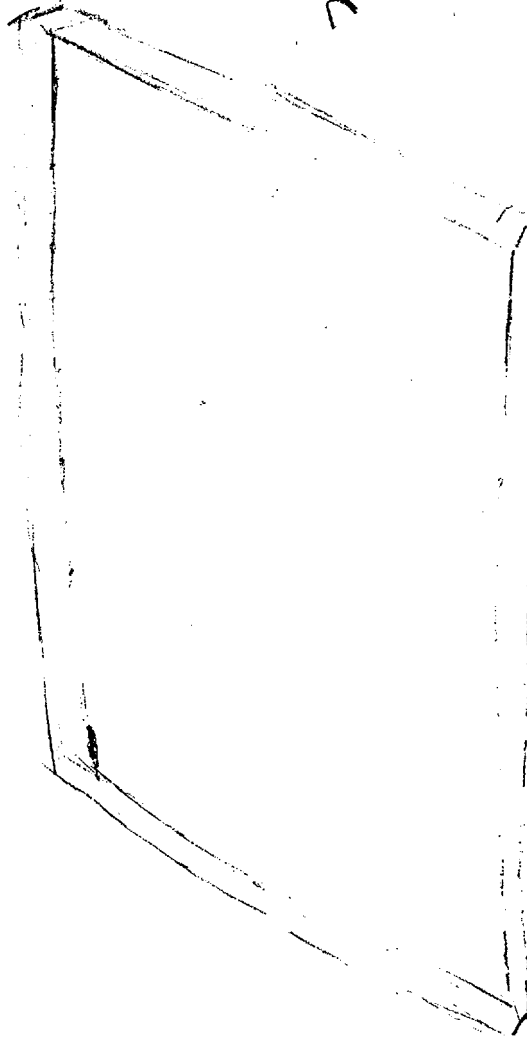

e

~~SECRET~~

T A R E

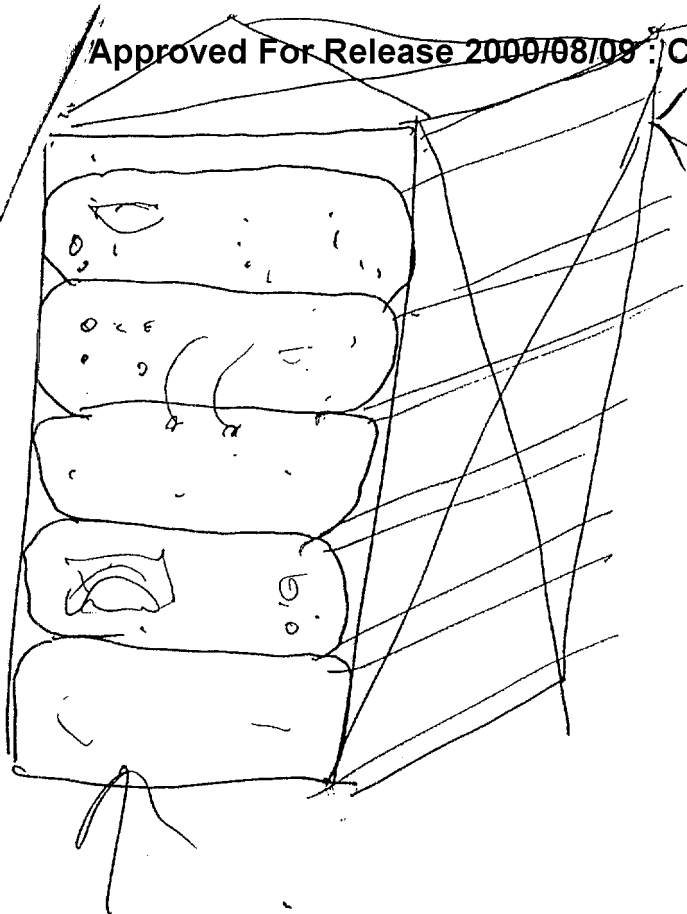

front
 (ALUMINUM
 COLORED
 FRAME)

electronic
 equipment

machine
 generated
 graph
 paper has "starlike" pattern
 on it.

(MACHINE-6
 GRAPH-6
 SPECIAL
 PATTERNS)

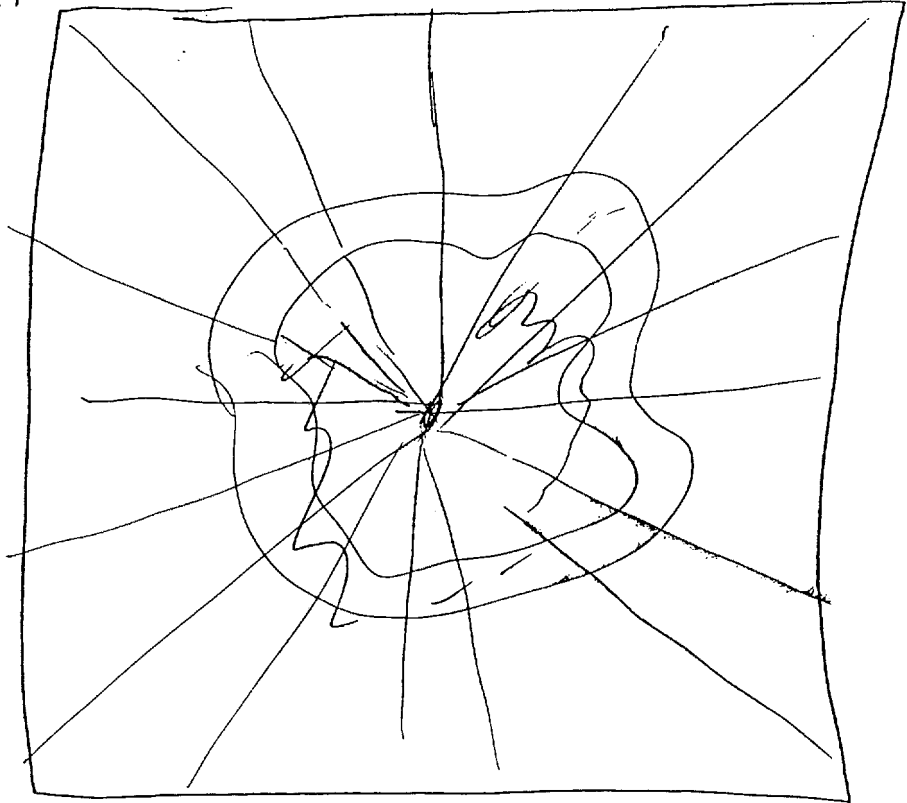

~~SECRET~~

TAB G