

~~CONFIDENTIAL~~

1

SUMMARY*Subject 1 = S1*

The remote-viewing experiment of URDF-3 by [REDACTED] proved to be unsuccessful. This conclusion was reached only after a careful review of the tape recordings, tape transcripts, and sketches that were generated during the four-day experiment.

S1

During the first day's session, [REDACTED]:

- 1) accurately described the location and type of target (that information had been given to him by the experimenters) but failed on the layout and types of buildings,
- 2) saw a gantry crane for heavy lifting,
- 3) tended to spend too much time on specifics only to say, "I'll come back to that," but seldom did, and
- 4) successfully evaded drawing a perimeter of the area even though he was asked to do this twice.

Therefore, nothing positive to validate remote viewing resulted from the first day's session.

S1

[REDACTED] was contacted by phone that evening by one of the experimenters and was told to concentrate on the crane and its relationship to the dominant three-story building (Building 1) that he had seen during that day's session. He was also told that they wanted a drawing of the perimeter fence.

S1

On the second day, [REDACTED] supplied the most positive evidence yet for the remote-viewing experiment with his sketch of the rail-mounted gantry crane. It seems inconceivable to imagine how he could have drawn such a likeness to the actual crane at URDF-3 unless:

- 1) he actually saw it through remote viewing, or
- 2) he was informed of what to draw by someone knowledgeable of URDF-3.

~~CONFIDENTIAL~~

~~CONFIDENTIAL~~

The second possibility is mentioned only because the experiment was not controlled to discount the possibility that ██████ could talk to other people.

S1

S1

█████ commented that he was seeing a lot of things this second day that he hadn't seen the previous day. In fact, he mentioned seeing several landmark-type objects that simply did not exist at URDF-3. One explanation of this discrepancy could be that if he mentioned enough specific objects, he would surely hit on one object that is actually present. This could explain the inconsistency between:

- 1) his most positive evidence of the experiment - a sketch of a rail-mounted gantry crane, and
- 2) the large number of objects he sees that, in reality, are simply not present at URDF-3.

S1

This discrepancy between what ██████ sees and what is really there certainly would make it difficult for the eventual user of his remote-viewing data since he would not know how to differentiate the fact from the fiction. At this stage of the experiment, the data is inconclusive to validate Price's capability of remote viewing.

S1

█████ was shown a sketch of a perspective of the Operations Area at URDF-3 on the third day and was told that this was a sketch of the actual target. ██████ said he recognized the area but claimed that only one of the four headframes was present now. That was wrong, but his most damaging statements had to do with his interpretation of Building 1 (the underground building) at URDF-3. With the sketch as a reference, he "saw" the four main surface protrusions of Building 1 as four separate above-ground buildings sitting atop a concrete apron. He was asked specifically whether these four buildings he saw might really be the surface elements of an underground building. He failed either to pick up the lead or to remotely view correctly because he said, "No, that's a concrete apron, and there's nothing subterranean right in that particular area." This statement was his most negative evidence yet and tends to discredit his ability to remotely view URDF-3.

~~CONFIDENTIAL~~

~~CONFIDENTIAL~~

3

S1
[REDACTED]'s comments on the fourth day were very specific regarding his concept of the overall operation at URDF-3, however no new evidence (that could be checked) was disclosed toward establishing validity for his remote-viewing capability.

S1
[REDACTED] After careful analysis of all the data presented, I have concluded that [REDACTED]'s remote-viewing experiment of URDF-3 was unsuccessful.

~~CONFIDENTIAL~~

~~CONFIDENTIAL~~

4

INTRODUCTION

I was asked to analyze and then judge the validity of the remote-viewing experiment performed on URDF-3 by [REDACTED]^{S1}. The data to be analyzed included two cassette tapes covering the first two days, 79 pages of transcribed tapes regarding the third and fourth days, and 30 sketches; I also reviewed the July 5, 1974 of URDF-3.

I am quite familiar with the chronology and layout of URDF-3, as well as the surrounding terrain and technical areas within 40 miles. I tried to keep an open mind while performing this analysis, but if I had any bias at all, it was that I wanted to believe remote viewing could help us establish the true purpose of URDF-3.

Throughout this analysis, I paid particular attention to all information about URDF-3 that was supplied to [REDACTED]. This was necessary in order to evaluate his originality in remote viewing.^{S1} This study was done in four segments corresponding to the four days of the experiment. Judgment of the progress and validity of the experiment was evaluated at the end of each day.

FIRST DAY

The experiment started at 11 a.m. on July 9, 1974 at Stanford Research Institute (SRI). The experimenters (Russ Targ and Hal Puthoff) told [REDACTED]^{S1} that the target was a geographical target selected from the Times of London World Atlas. The coordinates of the target were given as 50°9'59"N and 78°22'22"E; ^{S1} [REDACTED] wrote these coordinates down. It was emphasized that this was a "real target" as opposed to a sample target. Using several maps, the experimenters showed [REDACTED]^{S1} the target location at 60 miles WSW of Semipalatinsk. The target was described as a scientific military research and test area. To help orient ^{S1} [REDACTED], he was told that the target was 25 to 30 miles SW of "this river," presumably labeled correctly on the maps as the Irtys River. [REDACTED]^{S1} was told to start with a view of the general area as seen from 50,000 ft. and get the layout of any complexes or buildings, or whatever.

~~CONFIDENTIAL~~

~~CONFIDENTIAL~~

5

When the coordinates were given, ^{S1} [REDACTED] said he was getting a picture that they (the Soviets) have done a lot of rocket launching and recovery out of that area. As he starts viewing, he says it's dark over there at the present time, quite a cloud cover, and a full moon. He immediately sees the river and heads SW from the river to the institute (as he calls it). He says the area he's looking at has low one-story buildings that are partially dug into the ground giving the effect (as seen at ground level) of very short, squatty buildings, whereas they are actually fairly roomy on the inside. This description could very well describe a first look at the Operations Area at URDF-3.

He then finds that he is looking at "a guy in a very peculiar type of helmet." He tends to get bogged down in the specifics of the purpose of this helmet and shifts his attention to look at the cosmonauts (that were currently in orbit) to compare helmets. He says they (the Soviets) are running some tests on some equipment that currently has to do with their space program. Then he backs off from this specific subject and says, "I'll look around and come back to that" - but he never does.

^{S1} [REDACTED] was then asked to describe the general terrain and perhaps the building layout. He drew a sketch (Fig. 1) in which he correctly identifies the complex as being about 30 miles south of the Irtysh River (this information had been given to him earlier). However, he incorrectly says the road from the river passes through a gorge. The layout of the buildings and area they cover as shown in his sketch are incorrect for URDF-3. Although there are some antennas at URDF-3, none are as tall as the 500-ft. antenna he described.

He pondered over the dimensions of the outdoor pool he saw because "that's in meters - they have it." He then translates it to feet (60' x 150'). He said they use the pool for underwater testing and orientation studies but in reality there is no outdoor pool at URDF-3.

In Fig. 2, he drew a military complex three-eighths of a mile NE of the scientific complex shown in Fig. 1. Actually there is a military complex at URDF-3, located about 2 1/2 miles NW of the Operations Area, but this data was

~~CONFIDENTIAL~~

~~CONFIDENTIAL~~

JUL 9 1971
Moore
K

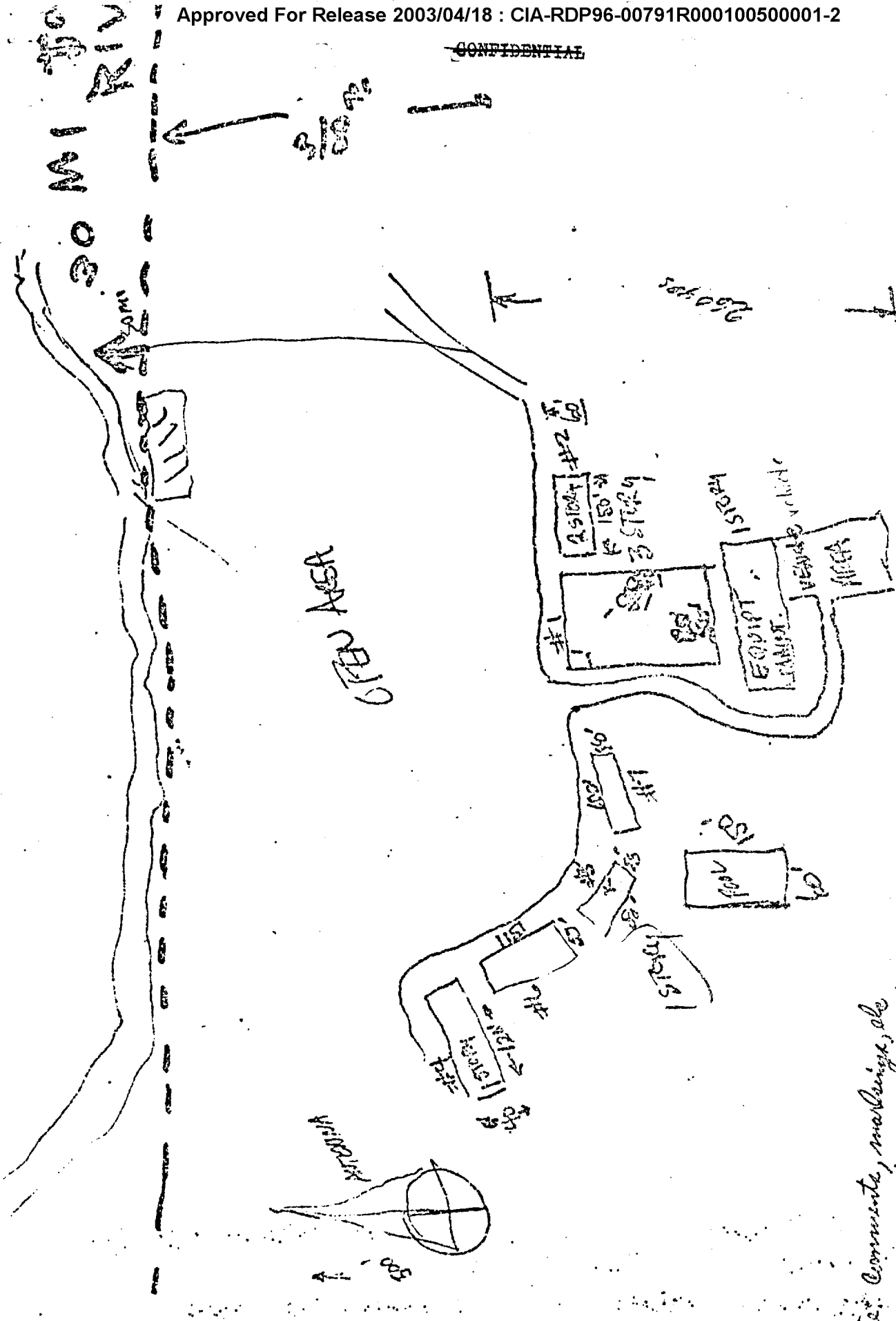

Notes: Comments, markings, etc
in RED have been added
by K. Kline

5
6000 YDS

~~CONFIDENTIAL~~

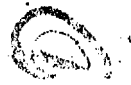

~~CONFIDENTIAL~~

MIL COMPLEX

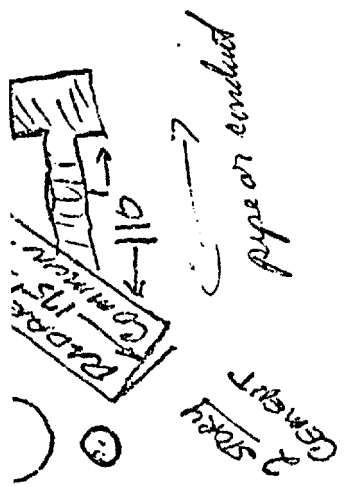

Communication building

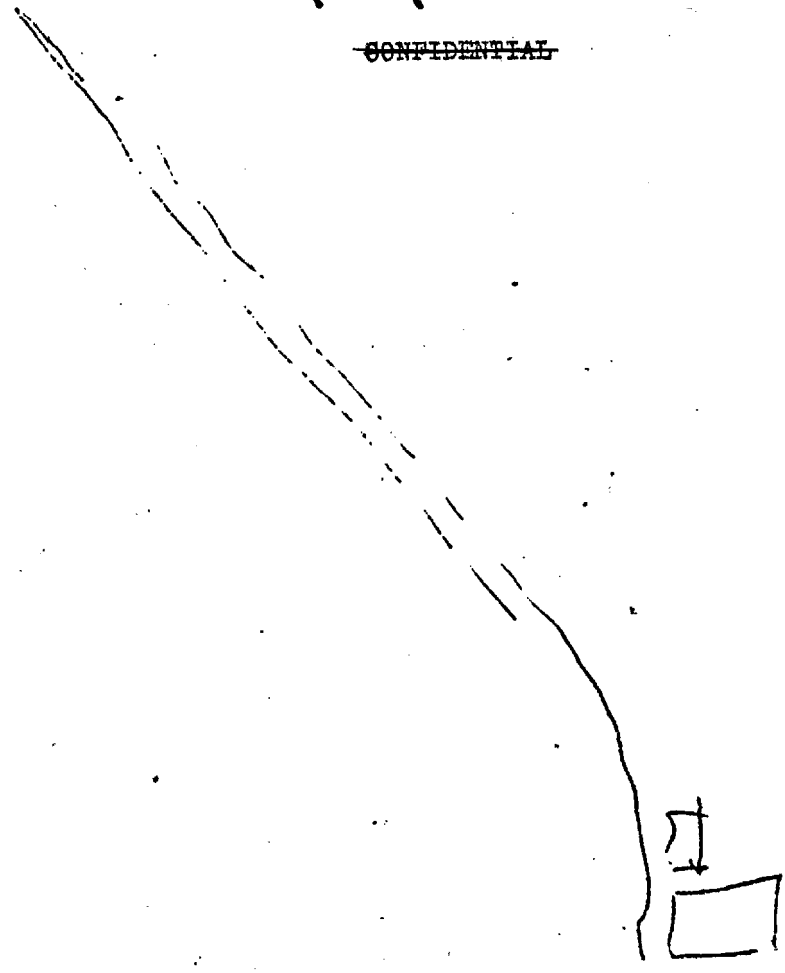

stubs

stubs

TELEPHONE Poles

40' high

JUL 9 1974
A M
A K

Figure 2

(2)

~~CONFIDENTIAL~~

8

given to him earlier when the target was described as a scientific military research and test area. He said the military complex looked like it had been there for two to three years, when in fact it's been there for over a decade.

Also in Fig. 2, he described a radar/communications building north of the scientific complex. The description of the building and its location relative to the military complex fits the description of the probable laboratory-administration building located about 2 1/2 miles northwest of the Operations Area at URDF-3. When he is specific about what he sees inside the building, one of the experimenters asks whether one of the specifics he mentioned might well be something else. He takes another look and changes his mind saying, "You may be right," giving the impression that he could be led to see what the experimenter suggests. The experimenter quickly informed [redacted]^{S1} that "we really don't know what this thing is," and [redacted] replies with, "I'll come back to that," but again never does. S1

[redacted]^{S1} saw an array of telephone poles about 400 yards SE of the scientific complex (see Fig. 2), but there is no such array of poles at or near URDF-3.

He was then asked to go up to 50,000 ft. to look again and describe the layout. Centering himself over the scientific complex, he scanned in a clockwise direction; the view he saw is sketched in Fig. 3. Nothing in this figure is correct except that the area is arid and has low hills to the south. Specifically, he is incorrect in his locations of a small village, an airstrip, a cluster of pine trees, and a city 60 miles to the SW. There is, however, an airfield at the Main Support Complex 30 miles north of URDF-3.

[redacted]^{S1} was asked if he saw a railroad anywhere. The closest railroad to the target that he could see was about 60 miles north running roughly NW and SE and he didn't see any spur tracks in a direction toward the target. In reality, there is a railway in the Main Support Complex (about 30 miles north of URDF-3) with a railway spur under construction down to URDF-3. There is also grading for a railway spur near the military complex at URDF-3.

~~CONFIDENTIAL~~

~~CONFIDENTIAL~~

JUL 9 1974
11M
K2

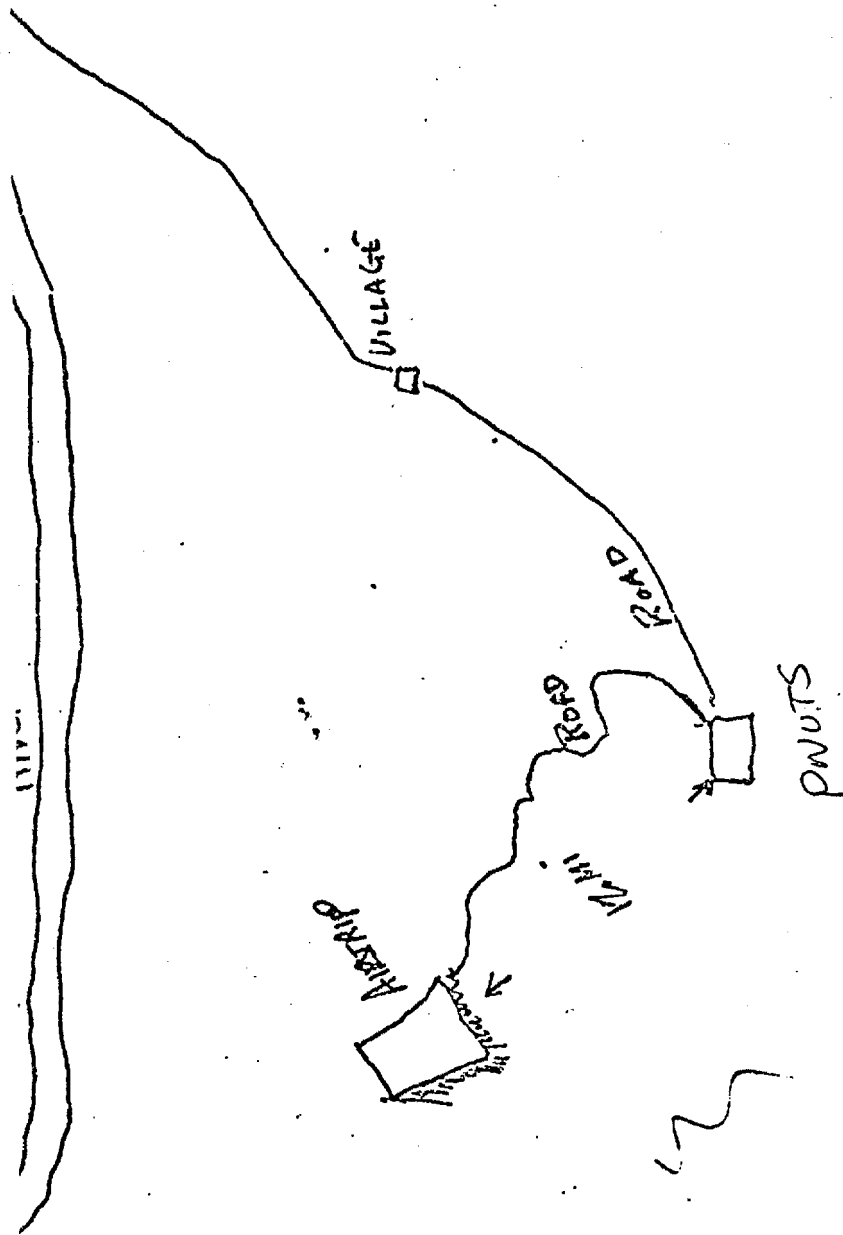

low hills

(ARID)

TINB

COM
CITY

3

Figure 3.

~~CONFIDENTIAL~~

^{S1} [redacted] became specific in looking at a scope trace at the airstrip and claimed it made him nauseated. At this time the experimenters and ^{S1} [redacted] decided to have lunch so ^{S1} [redacted] said he would come back to this later, but as he randomly elevated himself, he noted the area was under high security and had a cyclone fence. He could read the troop markings and buttons on a Colonel and then said he could come back to the security and military designations. In reality, the Operations Area of URDF-3 has 4 security fences, not just one cyclone fence. They stopped for lunch at about 12:14 p.m.

After lunch, at 2:22 p.m., ^{S1} [redacted] picks up with the scope trace at the airstrip. He concludes that the trace indicates the pulse of someone who is nauseated - that's why it caused nausea in him.

He was asked to indicate again where the telephone poles were and to map out the perimeter of the area. He drew in the telephone-pole grid with a circle of trees around the grid (see Fig. 2). There is no telephone-pole grid like this at or near URDF-3.

Upon spotting several low-boy trucks and a gantry crane (for very heavy lifting) in the vehicle area (Fig. 1), ^{S1} [redacted] was asked if he could tell where they took the heavy things from the low-boy trucks. This question led him to a look at the area near Building 1 in Fig. 1. He saw a sign in front of the building that said something to do with Zone 4. He said he would get back to that but never did.

When describing Building 1, he said it had three stories above-ground plus a basement with meteorological equipment on the flat roof and then looked inside the building at the top floor. He started to get too specific as to what he saw inside the building and was reminded that the type of thing the experimenters could best check him on was the outside appearance of the buildings. They asked him the dimensions of Building 1 and he had a very difficult time establishing them when he finally settled on 80' x 160'. He then described the other buildings in the scientific complex. He said Building 1 was the dominant building due to its height and central location; everything seemed to pivot off of it. There is no building at URDF-3 that matches the above description of Building 1.

~~CONFIDENTIAL~~

~~CONFIDENTIAL~~

11

They decided to stop the experiment for the day but asked ^{S1} [redacted] to look at the target at different intervals that evening. (Due to the difference in time, all of his viewing during this formalized part of the experiment - on this first day - had been at nighttime locally at URDF-3).

^{S1} [redacted] said he was beginning to labor anyway and, "if you start laboring at it, you start mocking-up things." He was then reminded that he was going to draw a perimeter, or would he rather save that for tomorrow. He said he would rather save that since he's starting to labor a bit. It was unfortunate that they didn't pursue the perimeter earlier in the day because it certainly has a unique shape. They quit at 3 p.m.

Summary of the First Day

The controlled session taped at SRI lasted a total of about 1 hour and 52 minutes. It consisted of the experimenters defining the target as a "real target" as opposed to a sample target. With the use of several maps, ^{S1} [redacted] was given coordinates of the target and told that it was a scientific military research and test area about 25 to 30 miles SW of the Irtysh River.

When the coordinates were given, ^{S1} [redacted] immediately biased his thinking that this area was related to the Soviets' space-launching and recovery areas. Since this is not true, he may have inadvertently and unknowingly biased himself into an incorrect target relationship.

^{S1} [redacted] described the target as a military and scientific complex about 30 miles SW of the Irtysh River but there is nothing in this description that wasn't already given to him. He then gives what is almost a perfect description of someone's first look at the Operations Area of URDF-3. He describes it as low one-story buildings that are partially dug into the ground giving the effect (as seen at ground level) of very short, squatty buildings, whereas they are actually fairly roomy on the inside. Unfortunately, as he later describes the specifics of buildings in the scientific complex, he never again mentions earth-covering of partially-buried buildings. It seemed he had the perfect description of URDF-3, but never came back to that again. In fact, his later

~~CONFIDENTIAL~~

~~CONFIDENTIAL~~

12

description of the most dominant building (a large three-story building) doesn't match any building at URDF-3.

S1

[REDACTED] tends to get bogged down in specifics and then says something like, "I'll come back to that," but seldom does. He said the military complex looks like it's been there for two to three years when in fact it's been there for over a decade. At one point when describing the specifics of the "radar/communications building," he demonstrates that he could possibly be led to see what the experimenter wants him to see.

He sees some landmark-type items that simply don't appear at or near URDF-3. They are:

- 1) the road from the river to the target area passes through a gorge,
- 2) a 500-ft. tall antenna,
- 3) an outdoor pool (60' x 150'),
- 4) an array of telephone poles surrounded by trees about 500 yards SE of the scientific complex,
- 5) an airstrip on a plateau 12 miles NW of URDF-3,
- 6) a small village NE of URDF-3,
- 7) a city 60 miles SW of URDF-3,
- 8) a cluster of pine trees west of URDF-3, and
- 9) a three-story building (with a basement) as the dominant building in the scientific complex.

It doesn't seem fair to grade him on landmark-type objects he failed to see at the target because his attention may not have been directed on them. However, it does seem fair to question the existence of those objects he claims to have seen.

The most positive evidence of valid remote viewing for the first day (1 hour and 52 minutes) was his initial view of the target as "low one-story buildings that are partially dug into the ground..." Unfortunately, he never considered that description again. The only other piece of positive evidence that day was his view of a gantry crane for heavy lifting.

~~CONFIDENTIAL~~

~~CONFIDENTIAL~~

13

To summarize the first day's session, [REDACTED]^{SI} accurately described the location and type of target (but that was given) but failed on the layout and type of buildings. He tended to spend too much time on specifics only to say, "I'll come back to that," but seldom did. He successfully evaded drawing a perimeter of the area even though he was asked to do this twice. This was unfortunate because the shape of the perimeter is unique. My conclusion is that nothing positive to validate remote viewing resulted from this first day's session.

Additional Contact on the First Day SI

Hal Puthoff talked to [REDACTED] by telephone that evening at 5:25 p.m. to give him further instructions for his scanning that night. He was told that there were some specific areas he had mentioned that the experimenters were most interested in. Specifically he was asked "for an exact, as possible, drawing of the crane (that was in the rear of Building 1) and exactly what its relationship is to Building 1." Further, they wanted to know "anything about Building 1 in relation to the surrounding buildings, like whatever forms of connection or communication or transportation that exists between Building 1 (the main building) and the ones that are nearby." They especially wanted "as much detail as possible on the gantry crane and its relation to Building 1."

He was told that the second thing they were most interested in was the security fence around the perimeter. They wanted any detail on that - even a drawing of exactly what the fence looked like. It was emphasized that the crane was really top priority, especially what it looked like in relation to the main building (Building 1).

SECOND DAY

The remote-viewing experiment resumed at 11 a.m. on July 10, 1974. It was mentioned that the previous night [REDACTED]^{SI} had turned in drawings of a fence and a crane. [REDACTED]^{SI}'s first comments had to do with an observation of the immense size of the gantry crane. He said he didn't realize how large the gantry crane was until he saw a man walking by one of the crane wheels. Assuming the height of the man as 6 ft., he realized that the dimensional data he had derived the day before was underestimated by at least a factor of 3.

~~CONFIDENTIAL~~

~~CONFIDENTIAL~~

14

He commented on the security fence as being electrified, but never mentioned the unique shape of the perimeter fence or the fact that there are really four perimeter fences at URDF-3. Figure 4 is his sketch of a small section of the fence.

^{SI} [REDACTED] was again told that the experimenters wanted more information on exactly what the relationship was between the crane and the major building (Building 1); specifically, how did the crane interact with Building 1 or anything surrounding the building. ^{SI} [REDACTED] said the gantry crane interacted with Building 1, the outdoor pool and the telephone pole array. He drew a sketch showing the relative locations of buildings as he saw them that day (Fig. 5). He said the crane was so heavy that it left tracks in the ground and that, "the crane tracks go to the building and where this sunken building is." Unfortunately, the experimenters did not ask him to identify the "sunken building." This was important because in reality the gantry crane at URDF-3 operates on rails over a sunken building (designated as Building 1 by NPIC).

^{SI} As [REDACTED] continued to look at the area, he said, "I'm seeing a lot of things today I didn't see yesterday... I can see some very heavy... looks like railroad track, but they're spread much too wide so it looks like a riding gantry." That description compares quite closely with one of the most distinctive observables at URDF-3 - the gantry crane that operates on rails over the three-story underground building (Building 1 at URDF-3).

However, his description of the interaction between the crane and Building 1 is incorrect. He describes two gantry cranes that enter into his above-ground Building 1 whereas the single gantry crane at URDF-3 operates on rails above the underground Building 1. His description of this building is also wrong in several respects as compared to the actual Building 1 at URDF-3. The major difference is that Building 1 at URDF-3 is an underground building rather than above ground as ^{SI} [REDACTED] described it. He was asked, "Are there any windows in the building at all?" At this time, he realizes for the first time that the building is actually five-stories tall rather than three-stories as he had originally thought. He saw windows on the second, third and fourth stories on the north side of the building and said there were no windows on the other three sides. The session

~~CONFIDENTIAL~~

9

CONFIDENTIAL

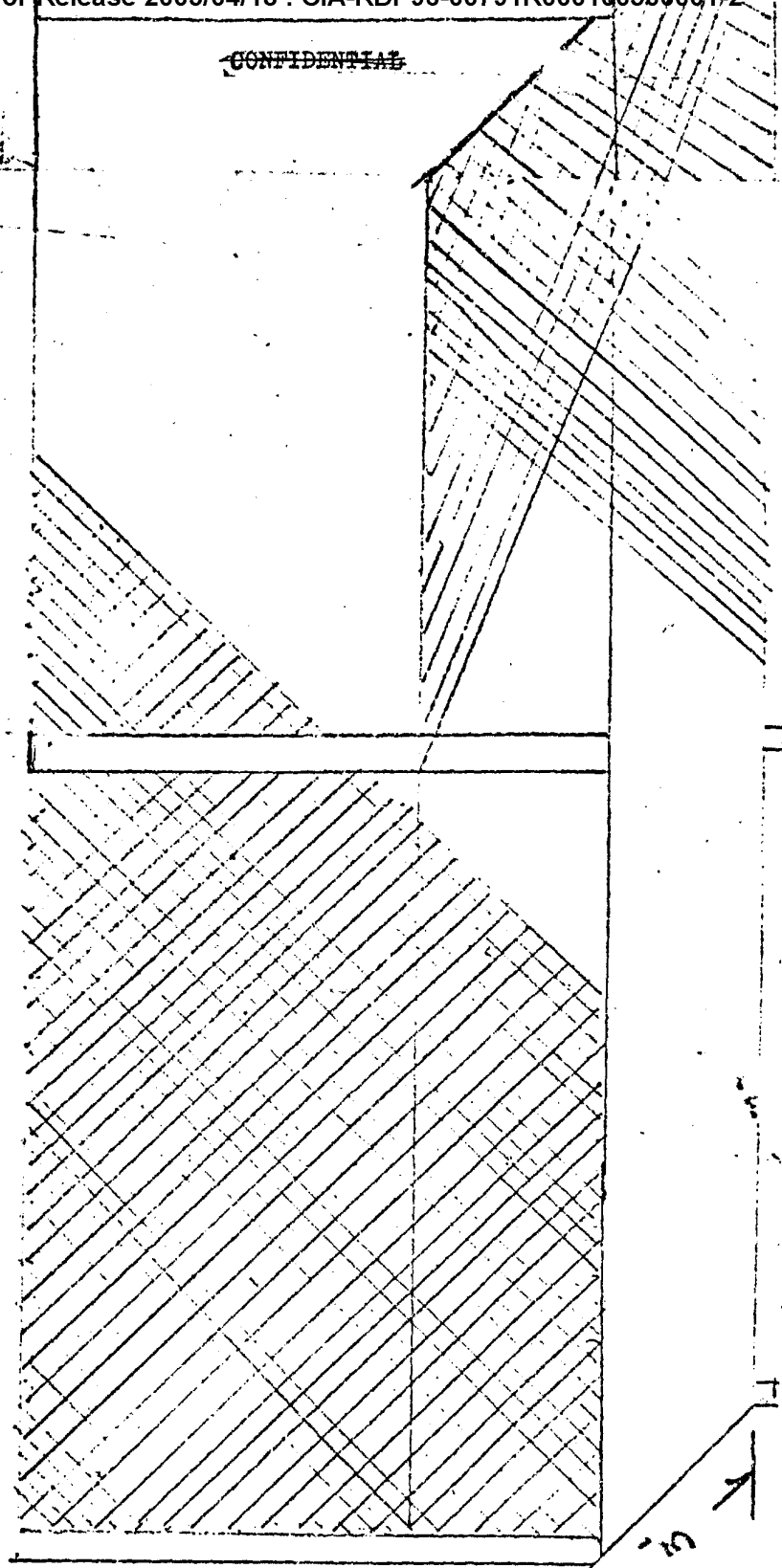

Round

OUTSIDE

*of security
of round side*

~~CONFIDENTIAL~~

JUL 10 1954

DAY
KE

4

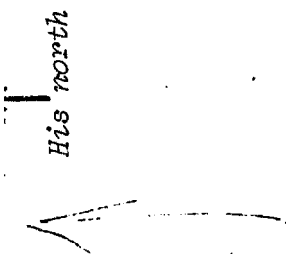

Military Complex



Communications Center

PNUTS

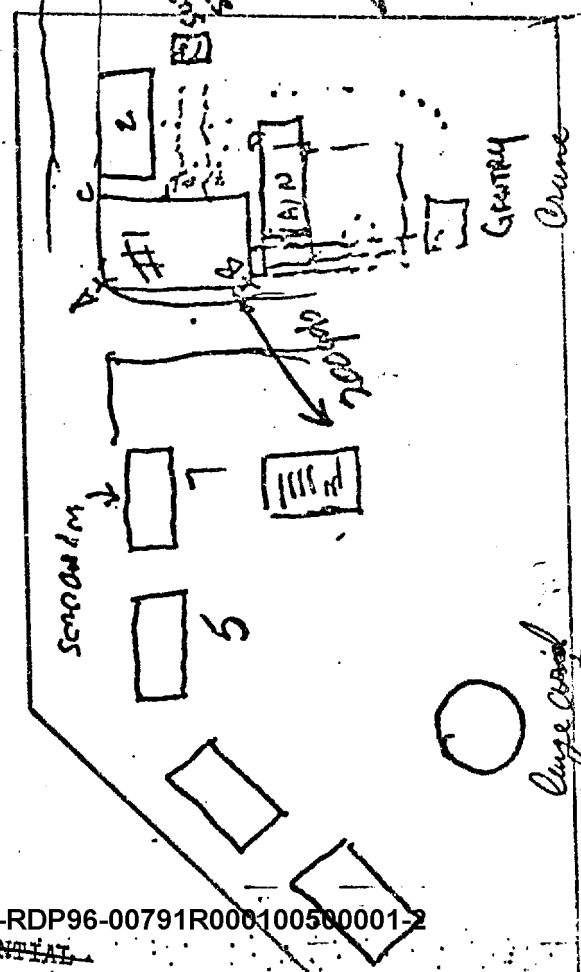

Telephone pole grid

Possible fence for scientific complex

Large aerial antenna

Refined drawing of area

~~CONFIDENTIAL~~

~~CONFIDENTIAL~~

17

continued with discussions of the length of the gantry rails. ^{S1} saw welding operations taking place south of Building 1 and also saw an electrical substation east of the building (see Fig. 5). In reality there is no substation near the gantry crane or Building 1 at URDF-3. The session ended at noon.

The session resumed at 3:01 p.m. with what appears to be a telephone conversation between ^{S1} and one of the experimenters. Although it's possible to hear only the experimenter's side of the conversation, the discussion appeared to be related to the dimensions of the gantry crane. ^{S1} had said earlier that day that:

- 1) the distance between the rails was about 50 ft.,
- 2) the height of Building 1 was about 50 ft.,
- 3) the height of the gantry crane was about 150 ft.,
and
- 4) the crane ran on the rails that entered into Building 1.

The above dimensions lead to a discrepancy in dimensions because the gantry crane is too tall (150 ft.) to enter the 50 ft.-tall Building 1. This discrepancy is resolved by ^{S1} telling the experimenters that the tall gantry crane does not enter Building 1 but that there are two shorter gantry cranes inside Building 1 that also run on the 50 ft.-wide rails - one running east-west on rails and one running north-south to meet the tall gantry crane outside the building on the same rail. This complicated relationship of three gantry cranes does not exist at URDF-3.

^{S1} is then contacted by phone again and asked to scan the area across the road west of Building 1 (see Fig. 5). He is told that in that region there's something else which is on the order of being as large or as unique as the crane. (The experimenter is obviously trying to see if ^{S1} can see the four headframes that exist at URDF-3). Note: there is an azimuthal shift of 90° in comparing the north-south motion of ^{S1}'s tall rail-mounted gantry crane as opposed to the actual east-west motion of the rail-mounted gantry crane at URDF-3. For the time being, if one accepts this rotation of 90°, the

~~CONFIDENTIAL~~

~~CONFIDENTIAL~~

18

SI
 experimenter was correct in asking [REDACTED] to look in the region west of Building 1 as shown in Fig. 5. Price was also reminded at the end of this phone conversation to continue working on a picture (sketch) of the tall rail-mounted crane that runs up to Building 1.

The tape resumes with yet another telephone conversation between Russ Targ and ^{SI}[REDACTED] with only the voice of Russ Targ being heard. [REDACTED] ^{SI} apparently reported that he saw a dome-shaped building (about 55' tall x 160' diameter) with its center located about 200 ft. west of the SW corner of Building 1. He also saw a 65-to-75 ft.-tall cement silo-like building south of the dome-shaped building that consisted of three 25 ft.-diameter vertical silos tangent to each other (see Fig. 6 for their relative locations). He confirmed that the swimming pool was west of both Building 1 and the silo-like building.

Russ Targ then concluded the phone conversation with a request for a sketch of the crane that runs on rails; specifically, "What does the crane look like when it's outside of Building 1?" Since [REDACTED] ^{SI} had seen two types of gantry cranes (one about 150 ft. tall and the other about 50 ft. tall), he sketched both of them (see Figs. 7 and 8).

Discussion of Sketches Drawn by Pat Price on the Second Day

The detail shown in Fig. 7, the sketch of the taller gantry crane, is remarkably close in detail to the actual gantry crane at URDF-3. This sketch provides the most positive evidence yet to support the validity of [REDACTED]'s remote viewing of URDF-3. SI

Figures 9 and 10 illustrate the cement silo-like building and the dome-shaped building. Figure 6 shows their relative locations to Building 1; however, there is nothing at URDF-3 that looks like the dome-shaped building or the silo-like building. In Fig. 6, these buildings are shown in the general location where, at URDF-3, a partially earth-covered tank and tall cylindrical-shaped tanks or towers appear. The swimming pool (in Fig. 6) is in the general location of the headframes at URDF-3.

~~CONFIDENTIAL~~

APR 10 1974
PM
1973

~~CONFIDENTIAL~~

North
N →

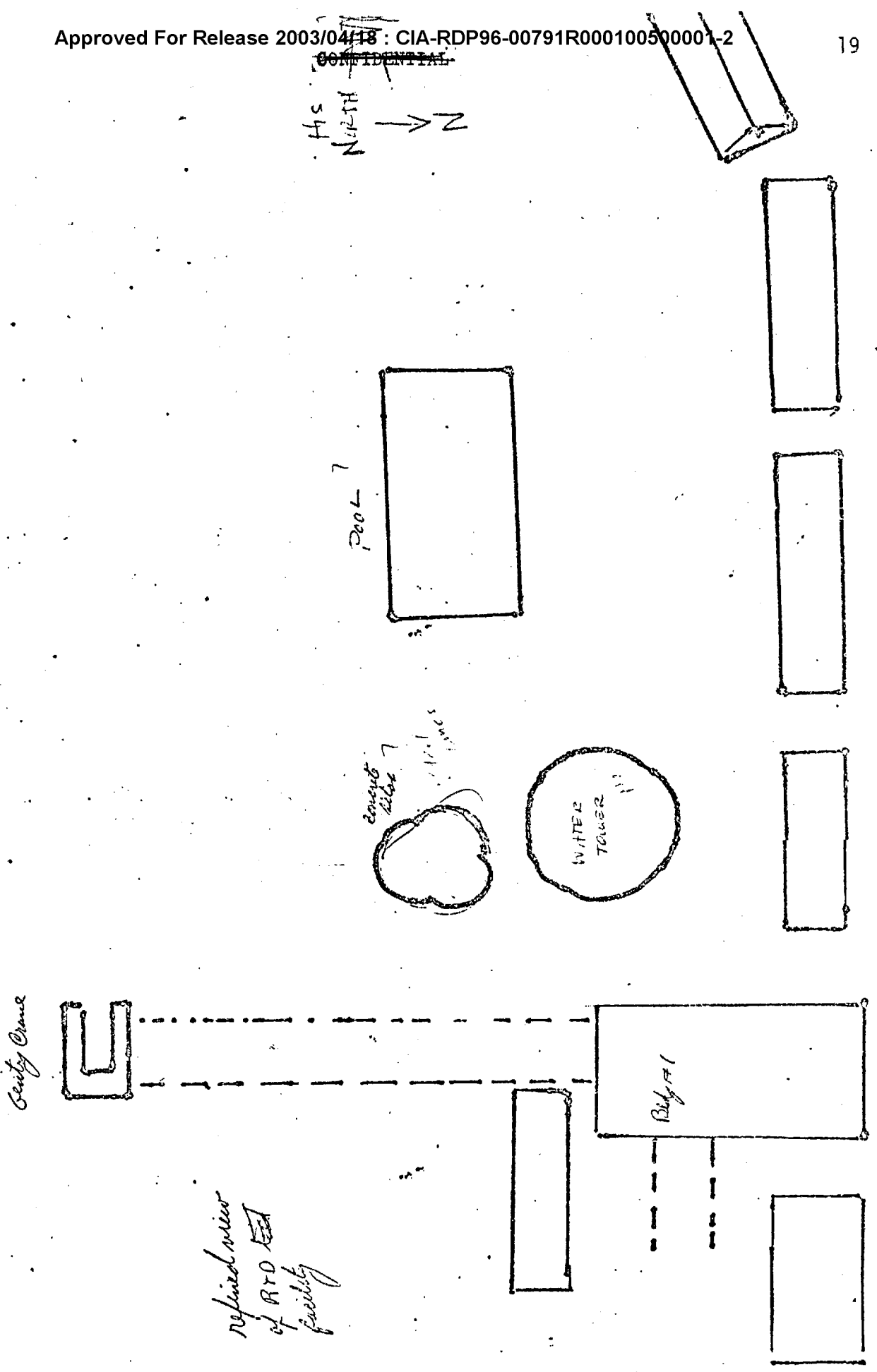

Refined view
of RTO facility

Figure 6.

~~CONFIDENTIAL~~

JUL 10 1974
7PM

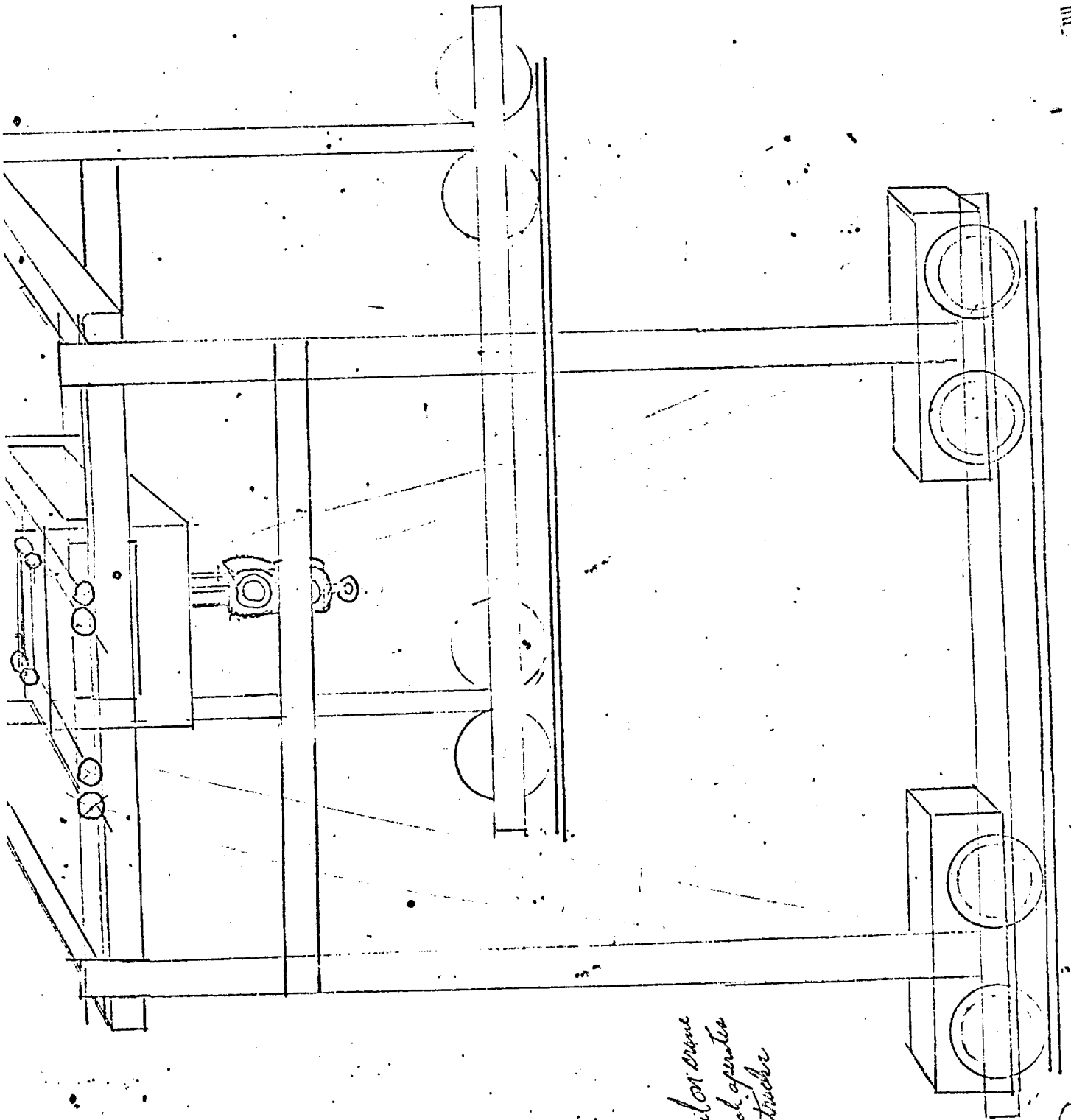

*detail on same
wheel operates
on truck*

(13)

~~CONFIDENTIAL~~

JUL 10 1974
PM K

~~CONFIDENTIAL~~

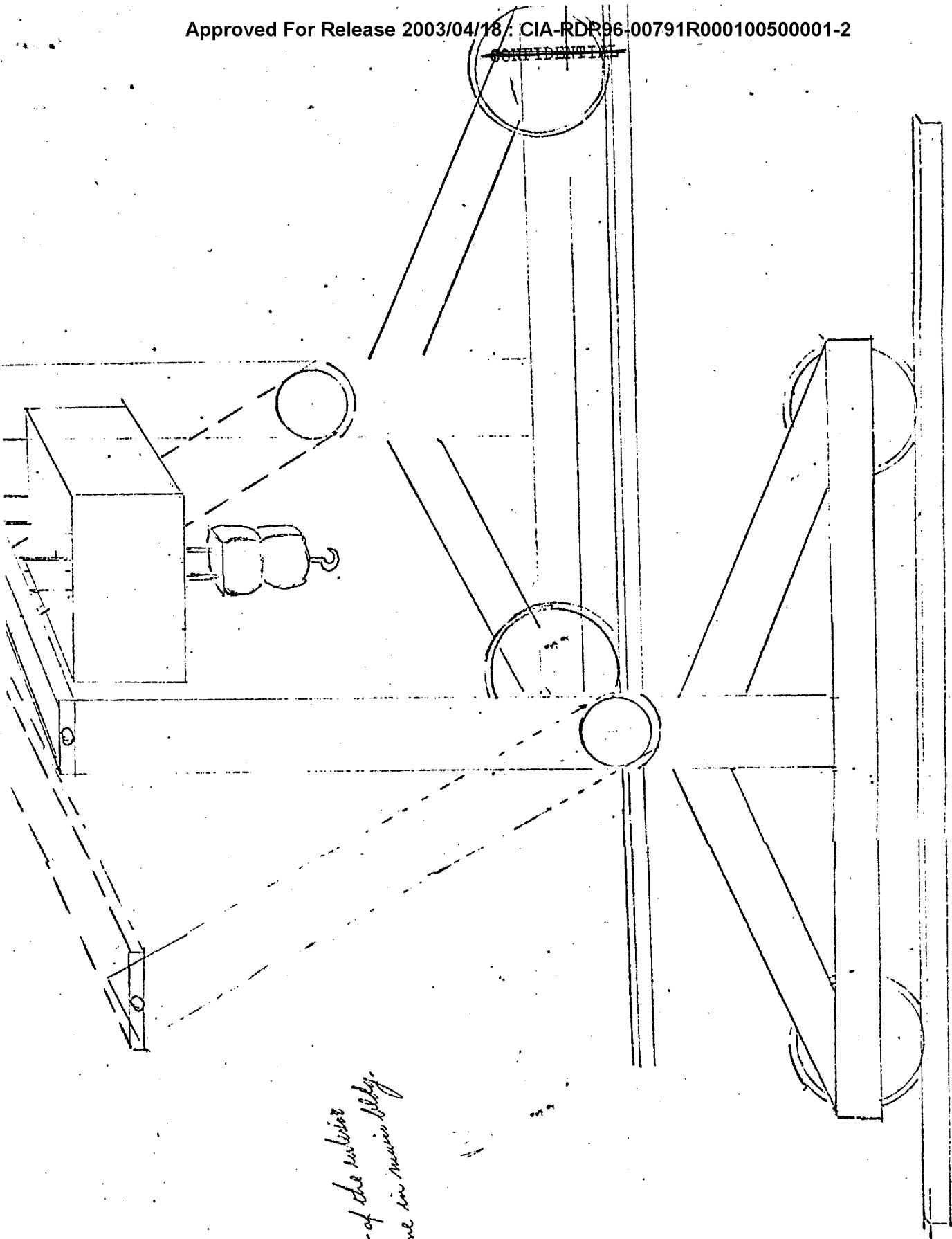

*most of the rollers
come in main body.*

(17)

~~CONFIDENTIAL~~

51

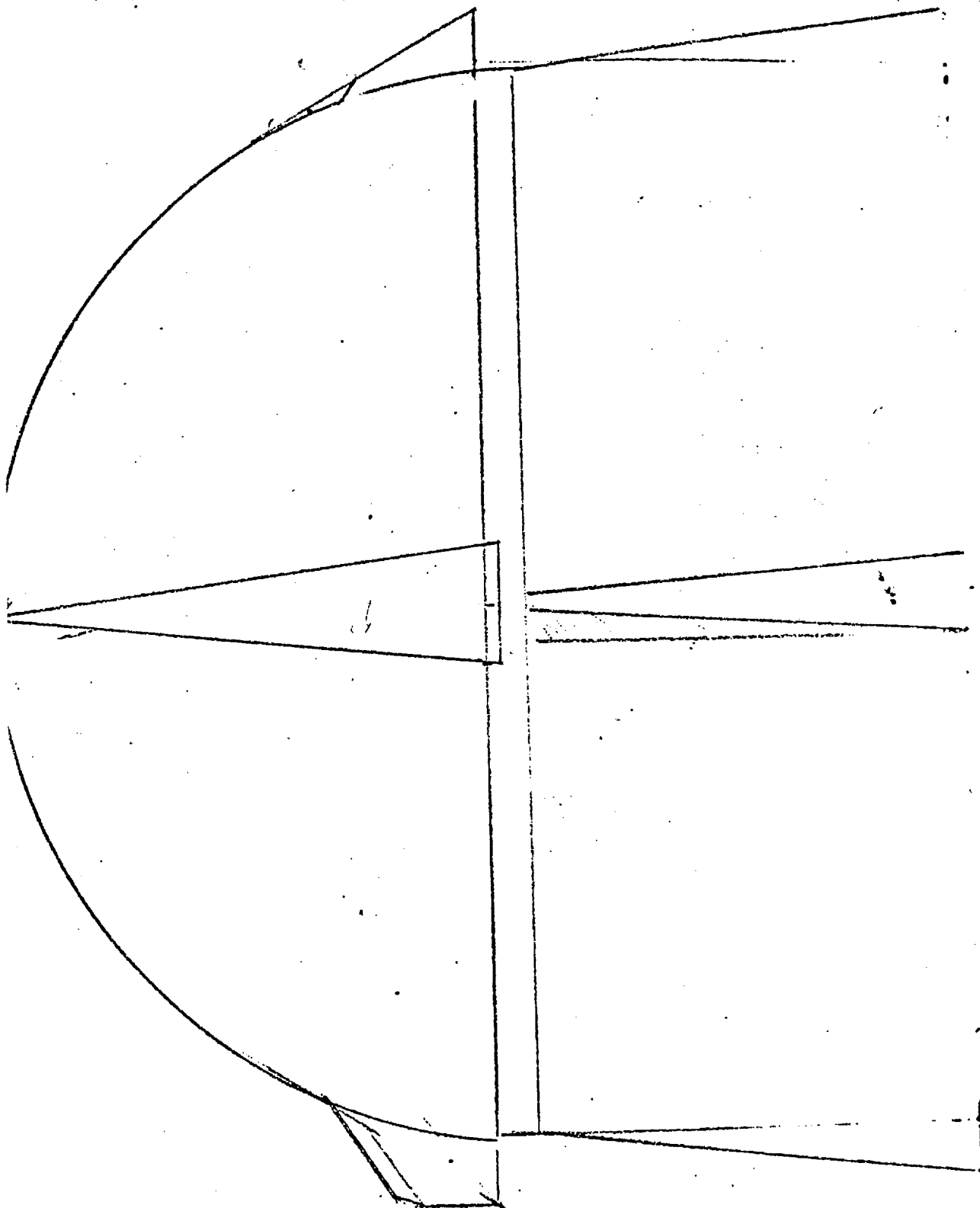

160

Figure 10.

~~CONFIDENTIAL~~

51

~~CONFIDENTIAL~~

22
JUL 10 1974
PM X

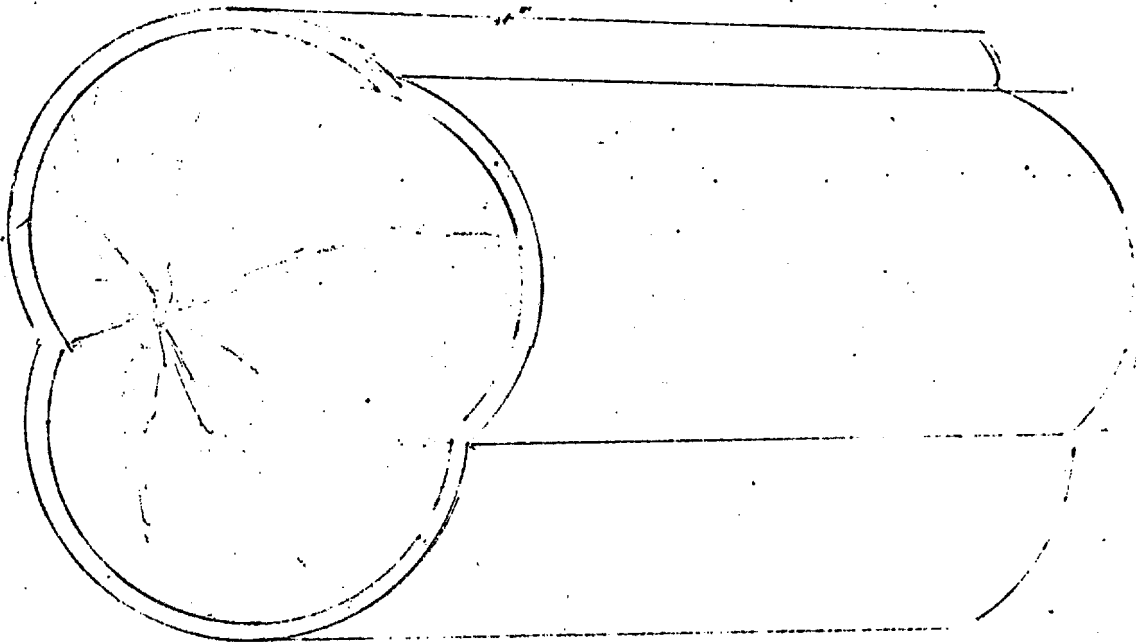
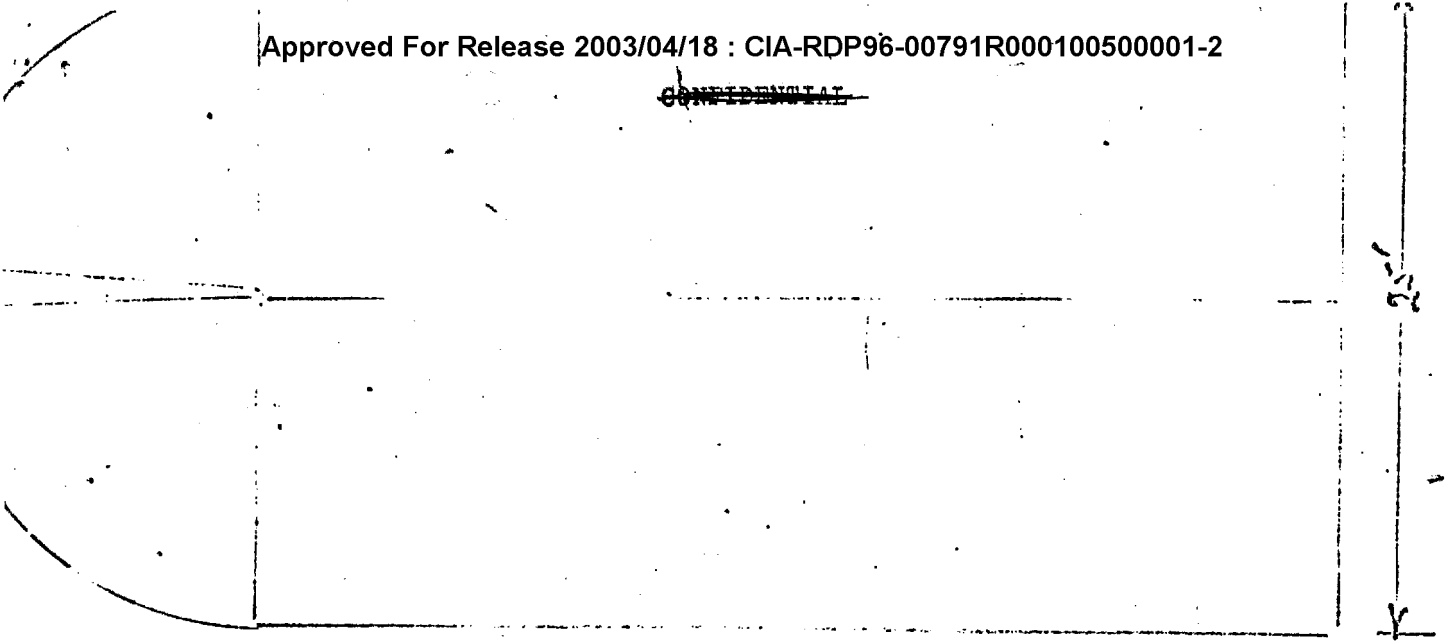

Handwritten note: detail of inner structure created on # 16

Handwritten mark: (P)

LASL-ERDA-OFFICIAL

~~CONFIDENTIAL~~

Figure 2

~~CONFIDENTIAL~~

Assuming the relationship of the gantry crane to Building 1 in Fig. 6 is the same as the relationship of the gantry crane to Building 1 at URDF-3, it must be concluded that ██████^{S1} is oriented 90° in error in the scientific complex. His north direction for the scientific complex only would correspond to what is actually east at URDF-3. His relationship of scientific complex to military complex to the Irtysh River is still correct though.

Unfortunately, the experimenters failed again to get a drawing of the perimeter fence for the scientific complex. In Fig. 5, I have taken the liberty of drawing a perimeter fence around the scientific complex and come very close to the actual shape of the perimeter fence of the Operations Area (scientific complex) at URDF-3. ██████^{S1} had been asked twice the day before to draw a perimeter of the area, but it wasn't followed up by the experimenters.

Summary of the Second Day

The controlled session at SRI lasted for one hour (11 a.m. until noon). The rest of the session was conducted over the telephone with only the voice of the experimenter recorded on tape. ██████^{S1} commented that he was seeing a lot of things that he hadn't seen the previous day and supplied the most positive evidence yet for remote viewing with his sketch of the rail-mounted gantry crane. It seems inconceivable to imagine how he could draw such a likeness to the actual crane at URDF-3 unless:

- 1) he actually saw it through remote viewing, or
- 2) he was informed of what to draw by someone knowledgeable of URDF-3.

I only mention this second possibility because the experiment was not controlled to discount the possibility that ██████^{S1} could talk to other people - such as the Disinformation Section of the KGB. That may sound ridiculous to the reader, but I have to consider all possibilities in the spectrum from his being capable to view remotely to his being supplied data for disinformation purposes by the KGB.

Discounting item 2 for the time being, because it seems distasteful and unpopular, ██████^{S1} did much better the second day toward establishing his

~~CONFIDENTIAL~~

~~CONFIDENTIAL~~

credibility in remote viewing. Unfortunately, the experimenters did not follow up on a couple of key items - a sketch of the perimeter of the scientific complex, and pursuing the "sunken building" comment that ██████^{S1} made. After studying only his sketch of the gantry crane, it's easy to believe that he can view remotely. I can understand how he might not see some landmark-type objects (like the four headframes) but I find it difficult to understand the other landmark-type objects he sees that simply do not exist at URDF-3, like his incorrect description of Building 1. One explanation could be that if ██████^{S1} mentions enough specific objects (such as three different types of gantry cranes when there is really only one), he will surely hit on one object that is actually present. If the user of S1 ██████'s remote-viewing talents had no way of checking, how could he differentiate the fact from the fiction? At this stage of the experiment, the data is inconclusive to validate ██████'s capability of remote viewing.

S1

THIRD DAYSummary

The experiment began again at 11:43 a.m. on July 11, 1974. The data included 67 pages of transcribed tapes along with 6 sketches drawn that day by ██████^{S1}. It was difficult to follow the discussion of ██████^{S1} and the experimenters when they were obviously looking at a sketch and saying things like, "What about this object over here?" I had no way of guessing which object and at which location and on which sketch.

The experiment started with ██████^{S1} describing the specifics of the pool. At one time during this discussion I thought the pool he was looking at might well be the underground building (Building 1) at URDF-3.

He incorrectly recalled the nearest railroad as being 300 miles to the north even though on the first day, he had said the closest railroad was about 60 miles north.

During the early afternoon, the experimenters showed ██████^{S1} a sketch of a perspective of the southern part of the Operations Area at URDF-3 (see Fig. 11). The sketch included the rail-mounted gantry crane, the underground building (Building 1), the partially earth-covered tank, Building 4, and the four headframes.

~~CONFIDENTIAL~~

~~CONFIDENTIAL~~

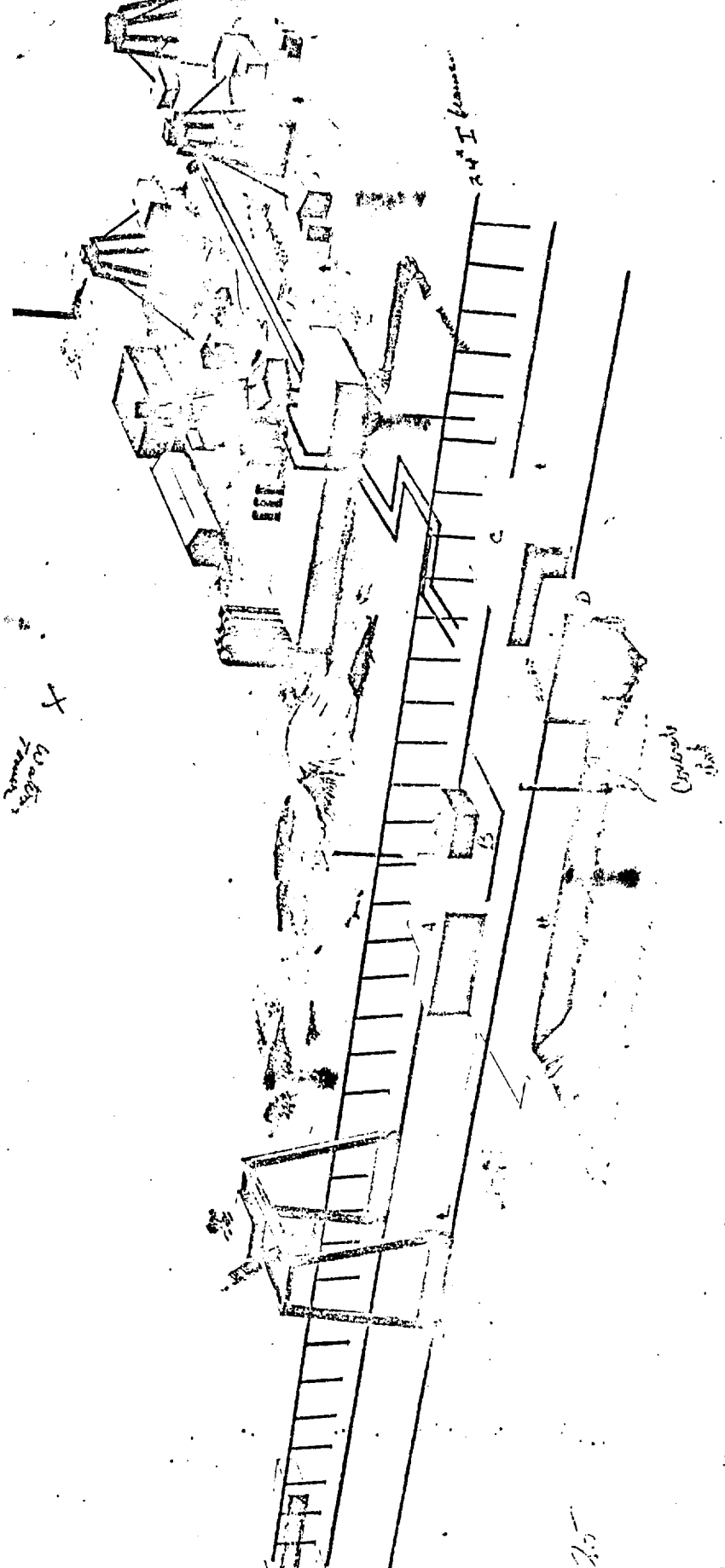

~~CONFIDENTIAL~~

WASH. FIELD OFFICE

~~CONFIDENTIAL~~

They told him that this was a sketch of a perspective of the actual place and asked him whether he could now "see" the four headframes as shown in the sketch. He said he recognized the area as the one he had been seeing but claimed that only one of the four headframes was present now. That proved to be untrue, since all four headframes are still there.

As seen in Fig. 11, the sketch of Building 1 is deceiving in that it looks like there are really four buildings (A, B, C, and D as marked in Fig. 11) sitting atop a concrete slab rather than there being a 50-ft. deep underground building with four sections (A, B, C, and D) extending above the ground. S1 [REDACTED] "looked" into the four "separate" buildings (A, B, C, and D) and described their contents in great detail but never suggested that this was all one large underground building. Finally, much later in the afternoon, it was requested that he investigate whether "Buildings A, B, C, and D" were really the surface elements of an underground building. He looked underground and said, "No, that's a concrete apron, and there's nothing subterranean right in that particular area." This description is the most negative evidence yet and tends to discredit [REDACTED]'s ability to remotely view URDF-3. S1

FOURTH DAY

Summary

S1 The discussion on the fourth day (July 15, 1974) involved only Hal Puthoff and [REDACTED]. S1 [REDACTED] was very specific regarding his concept of the overall operation at URDF-3. He recognized that from the beginning, he had been trying to force-fit a space-oriented situation to the target location, but now realized this "feeling" was incorrect.

This day, the discussions did nothing toward supplying any new evidence (that could be checked) to establish validity for [REDACTED]'s remote-viewing capability. S1

CONCLUSIONS AND RECOMMENDATIONS

S1 The experiment to determine the validity of [REDACTED]'s remote viewing of URDF-3 appears to be a failure. He described a scientific and military complex about 30 miles SW of the Irtysh River, but this information

~~CONFIDENTIAL~~

~~CONFIDENTIAL~~

had been given to him earlier. He got very specific about details only to summarize with a comment like "I'll come back to that," but seldom did he ever "come back to that." He successfully evaded drawing a perimeter of the area even though he was asked to do this several times throughout the experiment; this was unfortunate because the shape of the perimeter is unique.

I can understand how he might not have seen some of the landmark-type objects at URDF-3, but it's difficult to understand how he "saw" the other landmark-type objects that simply do not exist at URDF-3. One explanation could be that if he mentioned enough specific items, he would surely hit on one object that is present which could explain the most positive evidence to support remote viewing for this experiment - a sketch of a rail-mounted gantry crane.

He was completely wrong in his description of how this crane was related to any building. Even after he was shown an actual sketch of the scientific complex, he failed to see the underground building (Building 1 at URDF-3) but "saw it" as four separate above-ground buildings sitting atop a concrete apron.

In trying to determine the validity of this remote-viewing experiment, the worth of the data to the eventual user has to be considered. If the user had no way of checking, how could he differentiate the fact from the fiction? In the case of URDF-3, the only positive evidence of the rail-mounted gantry crane was far outweighed by the large amount of negative evidence noted in the body of this analysis.

It's unfortunate that so much of the experiment was done over the phone. If this should happen in the future, both sides of the phone conversation should be recorded rather than just the experimenter's voice, as was done during this experiment. Also, the experimenters did not pursue some important details when they had a chance. This may have been a result of their unfamiliarity with the target. This was obvious when the experimenters didn't know which direction was north in the actual perspective of URDF-3. I suggest that in the future, at least one of the experimenters be totally familiar with the target. I also suggest that future experiments be more tightly controlled to discount the possibility of the subject discussing the material with people not involved in the experiment.

~~CONFIDENTIAL~~

~~CONFIDENTIAL~~

After careful analysis of the data presented to me, I consider ^{S1} [REDACTED]'s remote-viewing experiment of URDF-3 to be unsuccessful. I recommend that the tapes be considered for use with the psychological stress evaluator (PSE) described in Appendix I; I am not competent to judge the reliability of the PSE as an aid to lie detection, but I think the tapes should be subjected to such a test.

~~CONFIDENTIAL~~